



OFFICE SPACE FOR SUBLEASE

2121 ALTON PKWY
Irvine, California

for more information, visit www.lee-associates.com



Exclusively listed by:

Dave Smith

Senior Vice President

License ID# 01195186

949.790.3134

dsmith@leeirvine.com

Adam Wicker

Senior Vice President

License ID# 01225873

949.790.3135

awicker@leeirvine.com

Lee & Associates - Irvine, Inc.

9838 Research Drive

Irvine, California 92618

PROPERTY FEATURES

- Suite 112: ±1,065 sq. ft.
- \$2.40 FSG
- Sublease term expires Dec 31, 2017
- Strong credit sublessor
- Private exterior entrance
- Close to the district entertainment center

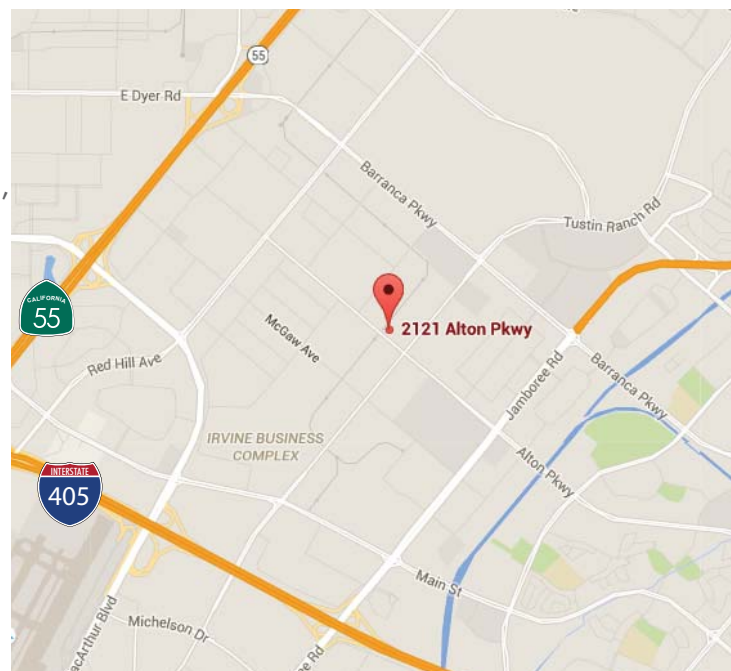

COMMERCIAL REAL ESTATE SERVICES

No warranty or representation is made to the accuracy of the foregoing information. Terms of sale or lease and availability are subject to change or withdrawal without notice.



OFFICE SPACE FOR SUBLEASE

2121 ALTON PKWY
Irvine , California



Exclusively listed by:

Dave Smith
Senior Vice President
License ID# 01195186
949.790.3134
dsmith@leeirvine.com

Adam Wicker
Senior Vice President
License ID# 01225873
949.790.3135
awicker@leeirvine.com

Lee & Associates - Irvine, Inc.
9838 Research Drive
Irvine, California 92618

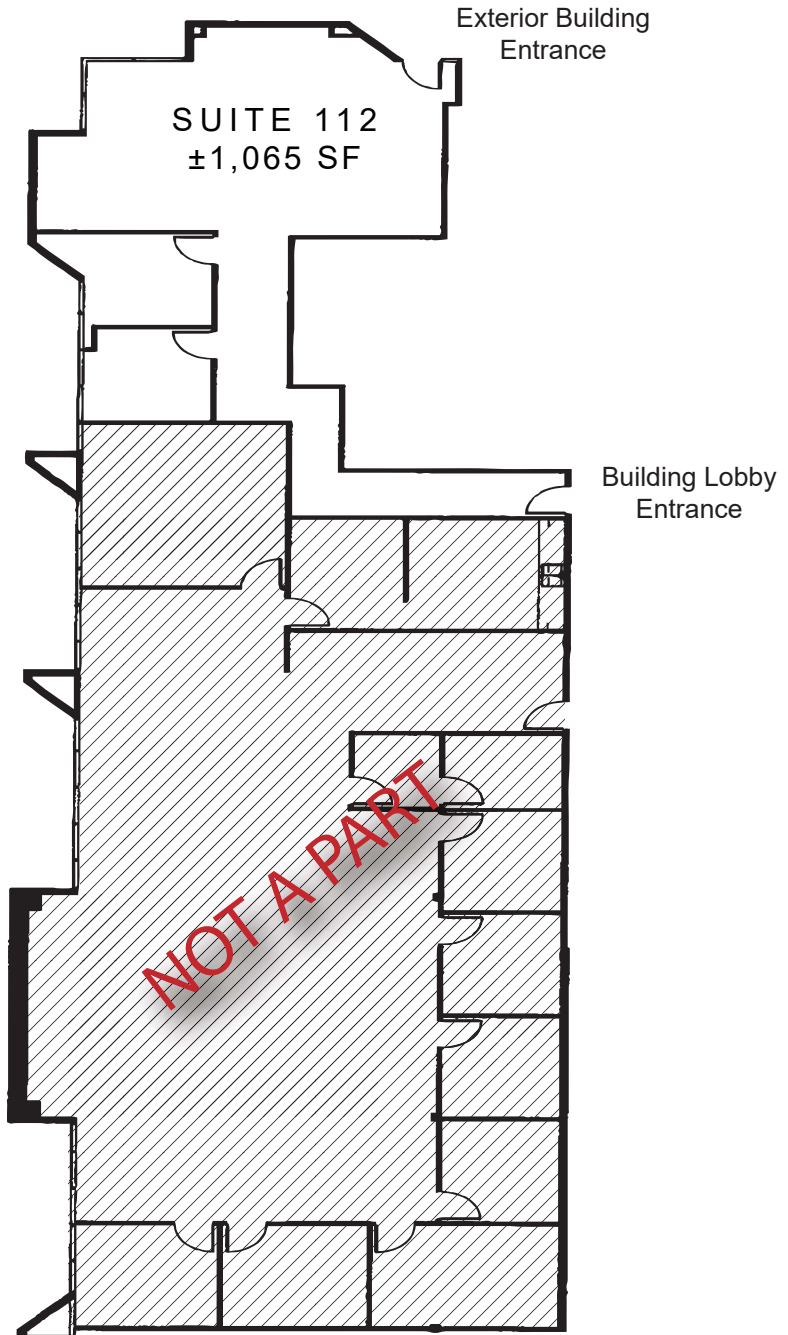

Building A, First Floor