

±8,204 SF OF OFFICE SPACE FOR SUBLEASE

2101 E 4TH STREET, SANTA ANA



\$1.20 PSF FSG
LOWEST LEASE RATE ON MARKET!

LISTING DATA

- Suite 110: ±1,310
- Suite 220: ±3,600
- Suite 240: ±3,294
- Can Sublease Individually or Combined
- Located in ±28,086 SF Office Building
- Clean Plug in Play Office Space
- Offices, Open Areas With Cubicles, & Kitchen
- Large Conference Room
- Furniture Available
- Immediate Access to 55 Hwy
- Parking Ration 4:1,000

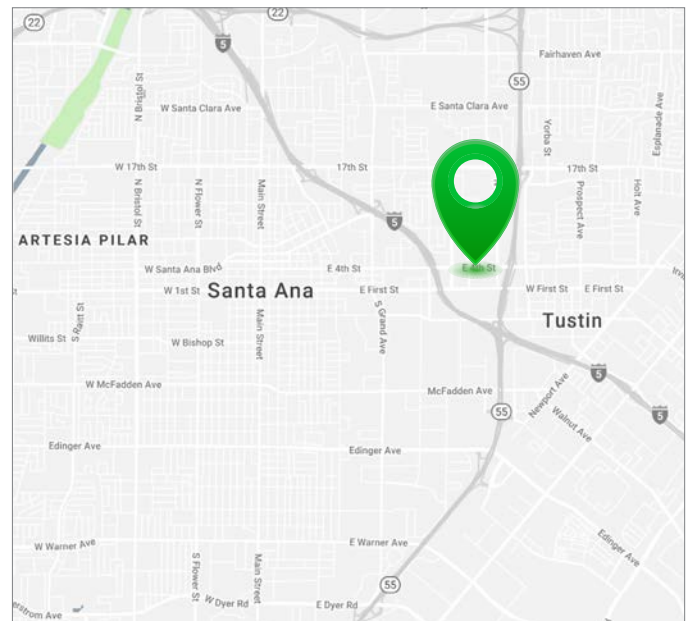

Mark Jerue
Senior Vice President
CalBRE 01073399
949.790.3121
mjerue@leeirvine.com

Craig Fitterer
Senior Vice President
CalBRE 01246929
949.790.3123
cfitterer@leeirvine.com

BJ Fell
Vice President
CalBRE 01929179
949.790.3144
bfell@leeirvine.com

Brandon Howe
Associate
CalBRE 02007676
949.790.3190
bhowe@leeirvine.com

All information furnished regarding property for sale, rental or financing is from sources deemed reliable, but no warranty or representation is made to the accuracy thereof and same is submitted to errors, omissions, change of price, rental or other conditions prior to sale, lease or financing or withdrawal without notice. No liability of any kind is to be imposed on the broker herein.

±8,204 SF OF OFFICE SPACE FOR SUBLEASE

2101 E 4TH STREET, SANTA ANA

FIRST FLOOR

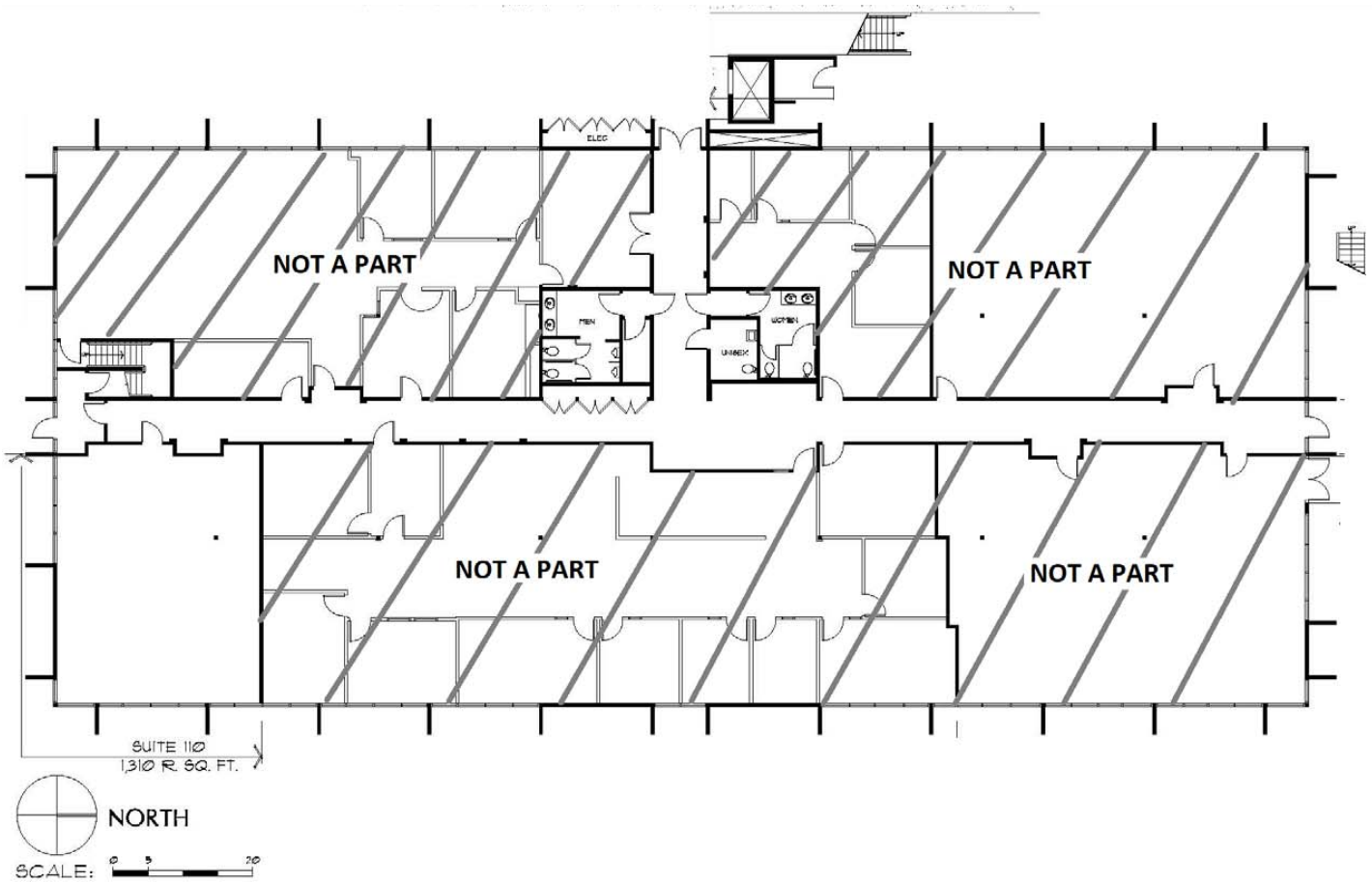

Mark Jerue
Senior Vice President
CalBRE 01073399
949.790.3121
mjerue@leeirvine.com

Craig Fitterer
Senior Vice President
CalBRE 01246929
949.790.3123
cfitterer@leeirvine.com

BJ Fell
Vice President
CalBRE 01929179
949.790.3144
bfell@leeirvine.com

Brandon Howe
Associate
CalBRE 02007676
949.790.3190
bhowe@leeirvine.com

All information furnished regarding property for sale, rental or financing is from sources deemed reliable, but no warranty or representation is made to the accuracy thereof and same is submitted to errors, omissions, change of price, rental or other conditions prior to sale, lease or financing or withdrawal without notice. No liability of any kind is to be imposed on the broker herein.

±8,204 SF OF OFFICE SPACE FOR SUBLEASE

2101 E 4TH STREET, SANTA ANA

SECOND FLOOR

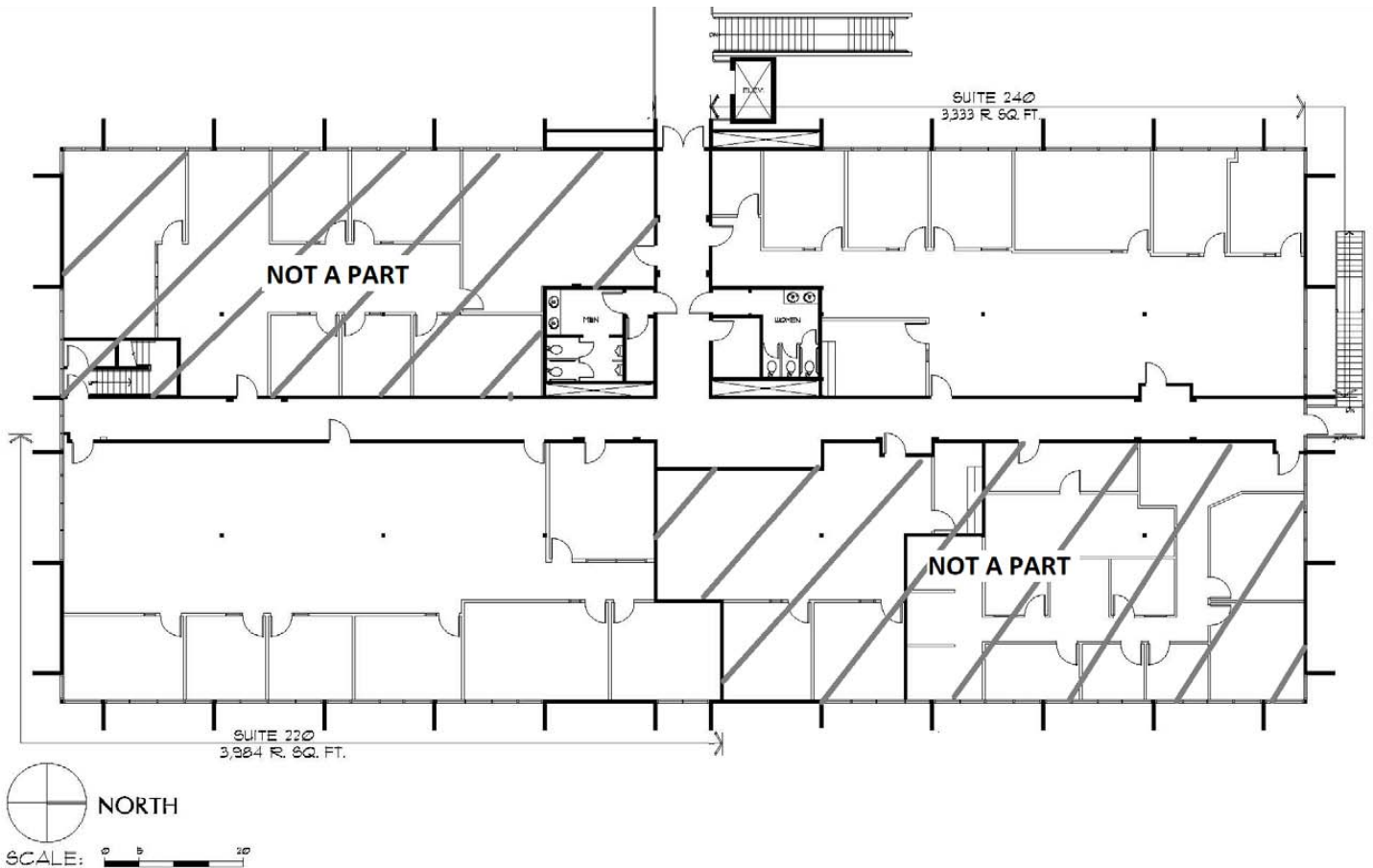

Mark Jerue
Senior Vice President
CalBRE 01073399
949.790.3121
mjerue@leeirvine.com

Craig Fitterer
Senior Vice President
CalBRE 01246929
949.790.3123
cfitterer@leeirvine.com

BJ Fell
Vice President
CalBRE 01929179
949.790.3144
bfell@leeirvine.com

Brandon Howe
Associate
CalBRE 02007676
949.790.3190
bhowe@leeirvine.com

All information furnished regarding property for sale, rental or financing is from sources deemed reliable, but no warranty or representation is made to the accuracy thereof and same is submitted to errors, omissions, change of price, rental or other conditions prior to sale, lease or financing or withdrawal without notice. No liability of any kind is to be imposed on the broker herein.

±8,204 SF OF OFFICE SPACE FOR SUBLEASE

2101 E 4TH STREET, SANTA ANA



Mark Jerue
Senior Vice President
CalBRE 01073399
949.790.3121
mjerue@leeirvine.com

Craig Fitterer
Senior Vice President
CalBRE 01246929
949.790.3123
cfitterer@leeirvine.com

BJ Fell
Vice President
CalBRE 01929179
949.790.3144
bfell@leeirvine.com

Brandon Howe
Associate
CalBRE 02007676
949.790.3190
bhowe@leeirvine.com

All information furnished regarding property for sale, rental or financing is from sources deemed reliable, but no warranty or representation is made to the accuracy thereof and same is submitted to errors, omissions, change of price, rental or other conditions prior to sale, lease or financing or withdrawal without notice. No liability of any kind is to be imposed on the broker herein.