

# ±25,000 SF INDUSTRIAL BUILDING FOR LEASE

950 W 12<sup>TH</sup> STREET | LONG BEACH, CALIFORNIA 90813

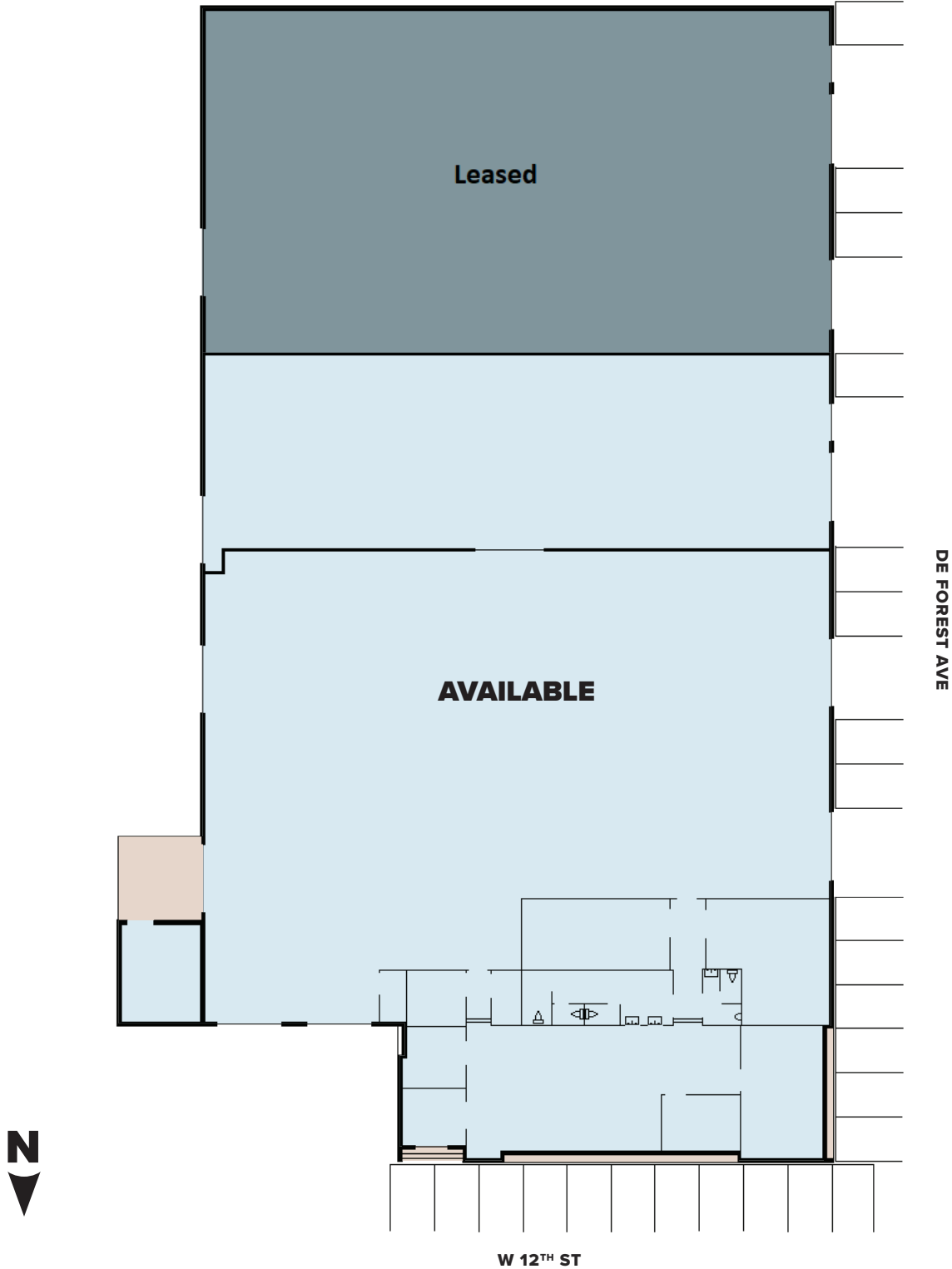

**NOTE:** Drawing not to scale. All measurements and sizes are approximate.

FOR MORE INFORMATION, PLEASE CONTACT ►

**PETER D. BACCI, SIOR**  
Executive Vice President, Principal | LIC ID 00946253  
pbacci@lee-associates.com  
323.767.2022

**MICHAEL H. TSAPARIAN, CCIM**  
Executive Vice President, Principal | LIC ID 00901326  
mtsaparin@lee-associates.com  
323.767.2111