



11645

1168 S.
barrington ave
LOS ANGELES



OVER

VIEW

FEATURES

- + Existing Clean Restaurant Space
- + No Key Money - FF&E Included
- + Current Type 47 License (Full Liquor)
- + Anchor Restaurant in 78 Luxury Unit Mixed Use Complex
- + Situated in One of the Most Dense and Affluent Areas of Los Angeles
- + Strong Combination of Office Towers, Multifamily Towers/Communities, and Single Family Homes
- + Pandemic Proof Clientele from Abundant Medical Office nearby.
- + Excellent Frontage on Wilshire Boulevard
- + Extremely High Traffic Count upwards of +/-40,000 cars daily
- + Ideal Delivery Hub 0.7 miles from Ingress & Egress of 405 freeway
- + Nearby Valet Parking

ADDRESS

1168 S. Barrington Avenue #101
Los Angeles, CA 90049

PREMISES

± 2,827.sf w/ additional expansion for patio

RATE

Negotiable

TERM

Negotiable

OCCUPANCY

Immediate

Los Angeles



No warranty or representation is made to the accuracy of the foregoing information. Terms of sale or lease are subject to change or withdrawal without notice.

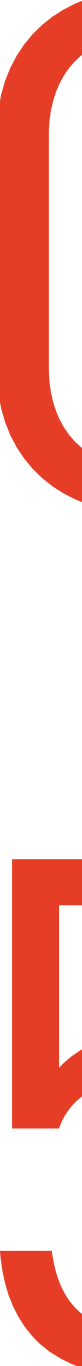

PLAN

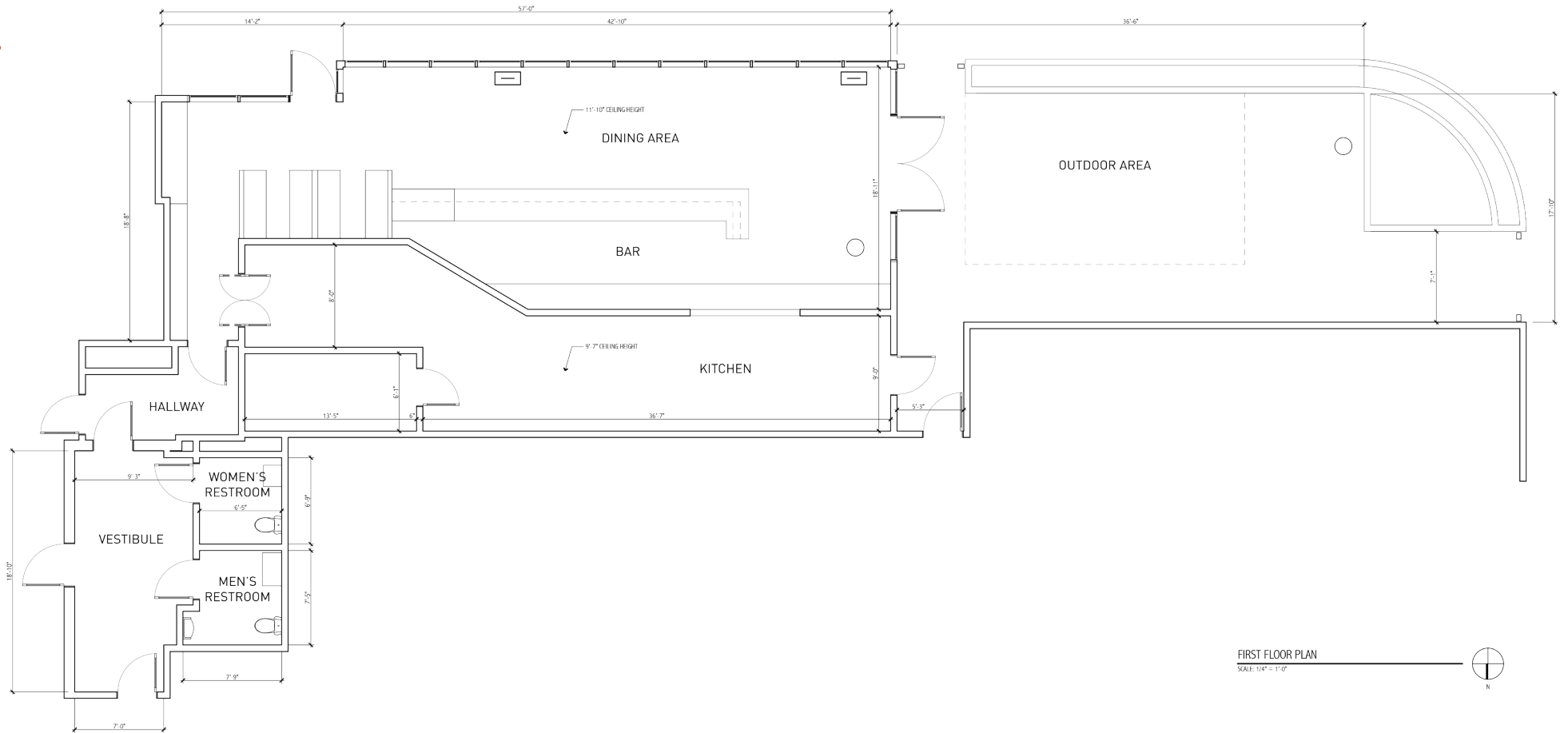

COMMUNITY

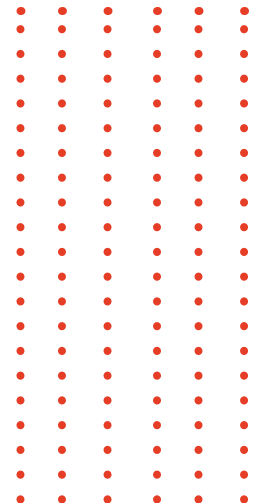
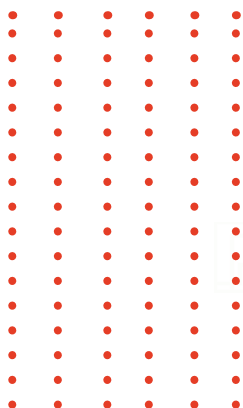
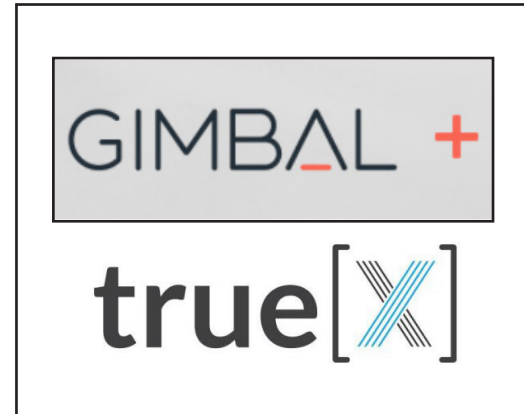

demographics



Walk Score

86

Walker's Paradise via Walkscore.com



Traffic

40,000+

2019 Daily Traffic Volume



Population

144,345

2019 Total Population (1 mile radius)



Housing

\$1,011,736

2019 Median Home Value



Population Growth

0.9%

2010 - 2019



Households

\$122,724

2019 Average Household Income

AREA



Los Angeles



1508 17th Street, Santa Monica, CA
310.899.2700
WWW.LEEWESTLA.COM | BRE 01222000

Christie Abbott
424.272.0826
cabbott@leewestla.com
AGT DRE# 01985617

No warranty or representation is made to the accuracy of the foregoing information. Terms of sale or lease are subject to change or withdrawal without notice.