

GARDEN TECH INDUSTRIAL CENTER

OFFICE / WAREHOUSE — 100% LEASED

870, 880, 890 ELKTON DRIVE
 COLORADO SPRINGS, CO 80907



PROPERTY INFORMATION

LEASE RATE:	\$7.50/SF NNN
AVAILABLE SPACE:	100% LEASED
PROJECT SIZE:	91,600 SF
LOT SIZE:	9.68 Acres
ZONING:	PIP-2 (Planned Industrial Park)
PARKING:	Ample
CEILING HEIGHT:	18' Clear
DOORS:	Drive-In & Dock-High Loading
SPRINKLERED:	Yes

COMMENTS

Garden Tech Industrial Center is comprised of three (3) 30,000 SF high quality industrial-flex buildings located in the prestigious Garden of the Gods industrial corridor in Colorado Springs, Colorado. The superior location and flexible project design support a wide array of Office/Light Manufacturing and Warehouse/Distribution uses.

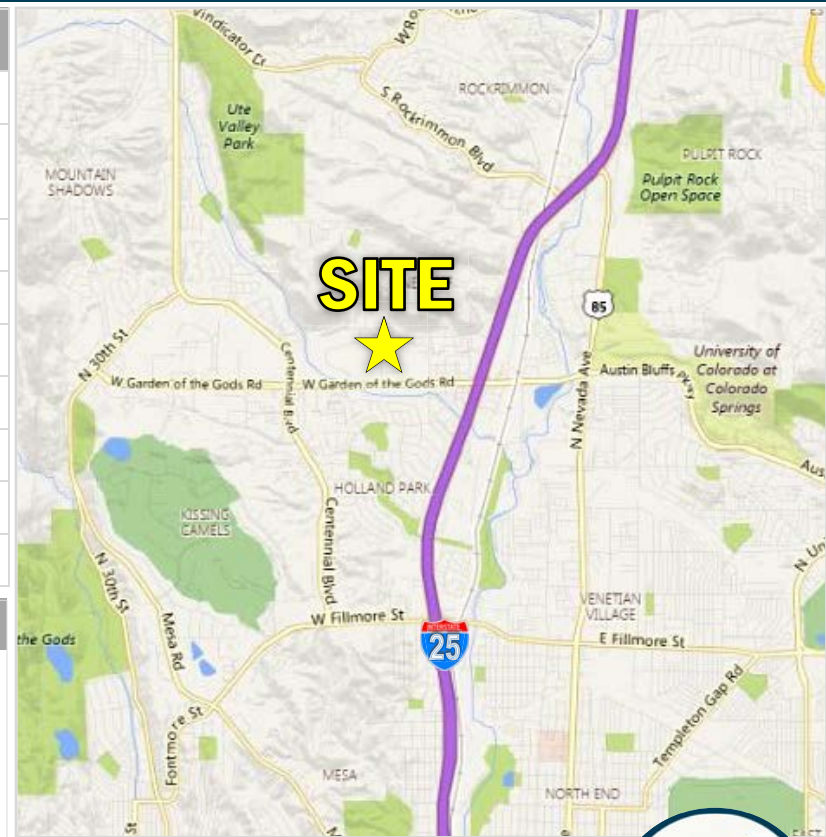

OLIVE REAL ESTATE GROUP, INC

102 N CASCADE AVE, SUITE 250, COLORADO SPRINGS, CO 80903
 t. 719.598.3000 f.719.578-0089 www.oliverreg.com

CHARLEY F. CONRAD, CCIM
 cfconrad@oliverreg.com





880 ELKTON DRIVE

Suite A
15,800 SF
LEASED

Suite B
7,500 SF
LEASED

Suite C
8,100 SF
LEASED

890 ELKTON DRIVE

Suite 107/109
14,900 SF
LEASED

Suite 103
5,100 SF
LEASED

Suite 101
10,000 SF
LEASED

870 ELKTON DRIVE

Suite 108
5,100 SF
LEASED

Suite 104/106
10,000 SF
LEASED

Suite 102
5,000 SF
LEASED

Suite 100
10,000 SF
LEASED



CHARLEY F. CONRAD, CCIM
cfconrad@olivereg.com