

Available SF 45,780 SF

Industrial For Sale

Building Size

45,780 SF



Address: 2311 Pullman St., Santa Ana, CA 92705

Cross Streets: Pullman / Warner

Irvine Business Complex , Short-Term Leaseback Opportunity
 2 Buildings On One Parcel, 31% Coverage
 Great Freeway Access, Distributed Power, H Occupancy
 Fenced Yard, Cannabis Zone

Sale Price: \$14,533,200
Sale Price/SF: \$317.45
Available SF: 45,780 SF
Prop Lot Size: 3.40 Ac / 148,104 SF
Taxes: \$88,433 / 2020
Yard: Fenced / Paved
Zoning: M1

Sprinklered: Yes
Clear Height: 22'
GL Doors/Dim: 3 / 2-18x14, 1-18x12
DH Doors/Dim: 0
A: 2500 **V:** 277/480 **O:** 3 **W:** 4
Construction Type: Tilt-wall
Const Status/Year Bit: Existing / 1968

Whse HVAC: No
Parking Spaces: 85 / **Ratio:** 1.82:1,000
Rail Service: No
Specific Use: Office/Manufacturing

Office SF / #: 13,135 SF
Restrooms: 9
Office HVAC: Heat & AC
Finished Ofc Mezz: 1,734 SF
Include In Available: Yes
Unfinished Mezz: 600 SF
Include In Available: No
Possession: Close of Escrow
Vacant: No
To Show: Call Broker
Market/Submarket: Orange County
APN#: 430-021-04

Listing Company: Lee & Associates - Commerce

Agents: Tim Cronin 323.767.2088, Brad Schneider 949.724.4708, Jakob Arellano 562.568.2088

Listing #: AIR CRE Use Only

Listing Date: AIR CRE Use Only

FTCF: CB000N000S000 / A0AA

Notes: Building 1 - 25,734 SF is 18' Clear. Bldg 2 - 20,046 SF is 22'. Building 1 400 Amps, Building 2 2,500 Amps, Building 1 is Sprinklered, Building 2 Doesn't Have Sprinklers, Buyer to Verify The Office Size, Building Square Footage, Power and All Information Above.

±45,780 SF OF BUILDINGS ON ±148,104 SF OF LAND FOR SALE

2311 PULLMAN STREET | SANTA ANA, CALIFORNIA 92705

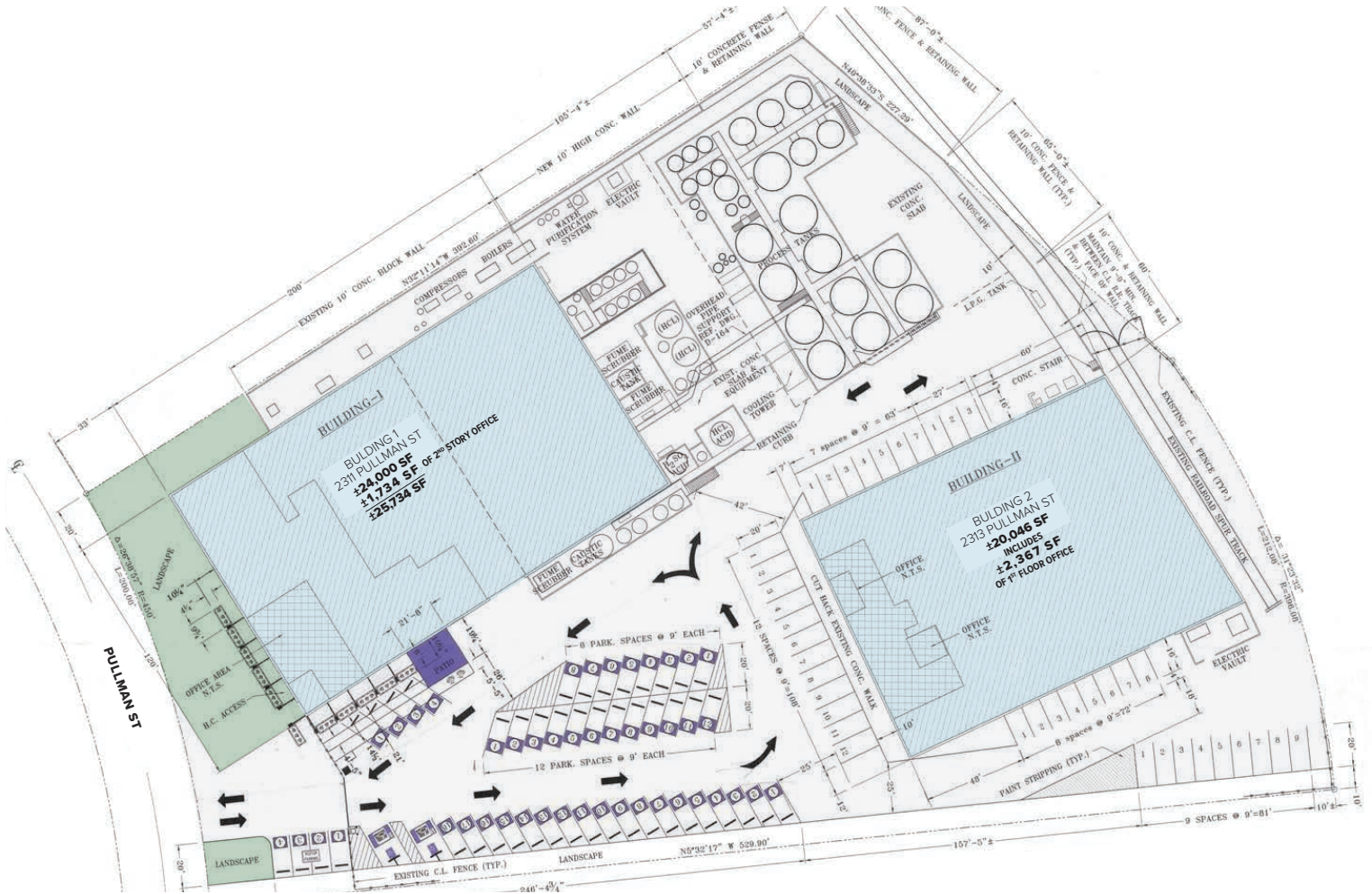

NOTE: Drawing not to scale. All measurements and sizes are approximate.

PROPERTY AERIAL



LOCATOR MAP

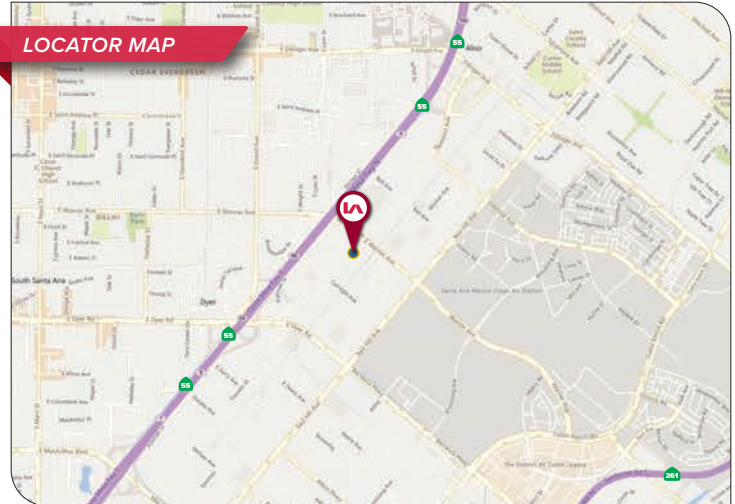

FOR MORE INFORMATION, PLEASE CONTACT ►

TIM CRONIN Sior
Senior Vice President | LIC ID 01001571
tcronin@lee-associates.com
323.767.2088

JAKE ARELLANO
LIC ID 02113094
jarellano@lee-associates.com
562.568.2088

NICK KRAKOWER
Associate | LIC ID 02113094
nkrakower@lee-associates.com
949.724.4720

BRAD SCHNEIDER
Senior Vice President | LIC ID 02113094
bschneider@lee-associates.com
949.724.4708



LOCAL EXPERTISE. INTERNATIONAL REACH. WORLD CLASS.

Lee & Associates® - Commerce, Inc. | 500 Citadel Dr, Ste 140, Commerce, CA 90040
CORP ID 01125429 | P. 323.720.8484 | F. 323.720.8474

LEE-ASSOCIATES.COM • CAP-RE.NET

The information has been furnished from sources which we deem reliable, but for which we assume no liability. Any projections, opinions, assumptions or estimates used are for example only and do not represent the current or future performance of the property. Buyers should consult with their independent advisors to determine if the property is suitable for their needs.