

RETAIL



LOCATION

OFFERED BY



(843) 856-4600
www.belklucy.com

Morrow Boggs
morrow.boggs@belklucy.com
(843) 606-5460 — direct office
(843) 998-5234 — mobile

AND

Trey Lucy
trey.lucy@belklucy.com
(843) 606-5455 — direct office
(843) 566-2867 — mobile



PROPERTY INFORMATION

PROPERTY DESCRIPTION

Belk | Lucy is pleased to present the exclusive listing of Kingstree Plaza in Kingstree, SC. This IGA-anchored shopping center is located near the intersection of Highway 261 (E. Main Street), Highway 377, and Highway 577. This property offers excellent visibility and is in close proximity to the Kingstree Historic District as well as the Kingstree Senior High School. Nearby amenities include IGA, Anderson Brothers Bank, Fred's, and Williamsburg Regional Hospital.

AREA DESCRIPTION

Kingstree is a charming small town in eastern South Carolina located approximately 75 miles from the state's major cities of Charleston, Columbia, and Myrtle Beach. A rich history, access to the Black River, and an abundance of hunting land are just a few reasons why over 3,300 residents call this picturesque city home.

TERMS AND CONDITIONS

Suite B	1,200 sf	\$ 12.00/sf NNN
CAM, Taxes, and Ins. (est)		\$ 1.67/sf
Outparcel		1.02 acres
Asking Price		\$ 169,000

DEMOGRAPHICS (5-MILE)

Population	10,539
Households	4,096
Avg. HH Income	\$ 41,393

OFFERED BY



(843) 856-4600
www.belklucy.com

Morrow Boggs
morrow.boggs@belklucy.com
(843) 606-5460 — direct office
(843) 998-5234 — mobile

AND

Trey Lucy
trey.lucy@belklucy.com
(843) 606-5455 — direct office
(843) 566-2867 — mobile

SITE PLAN

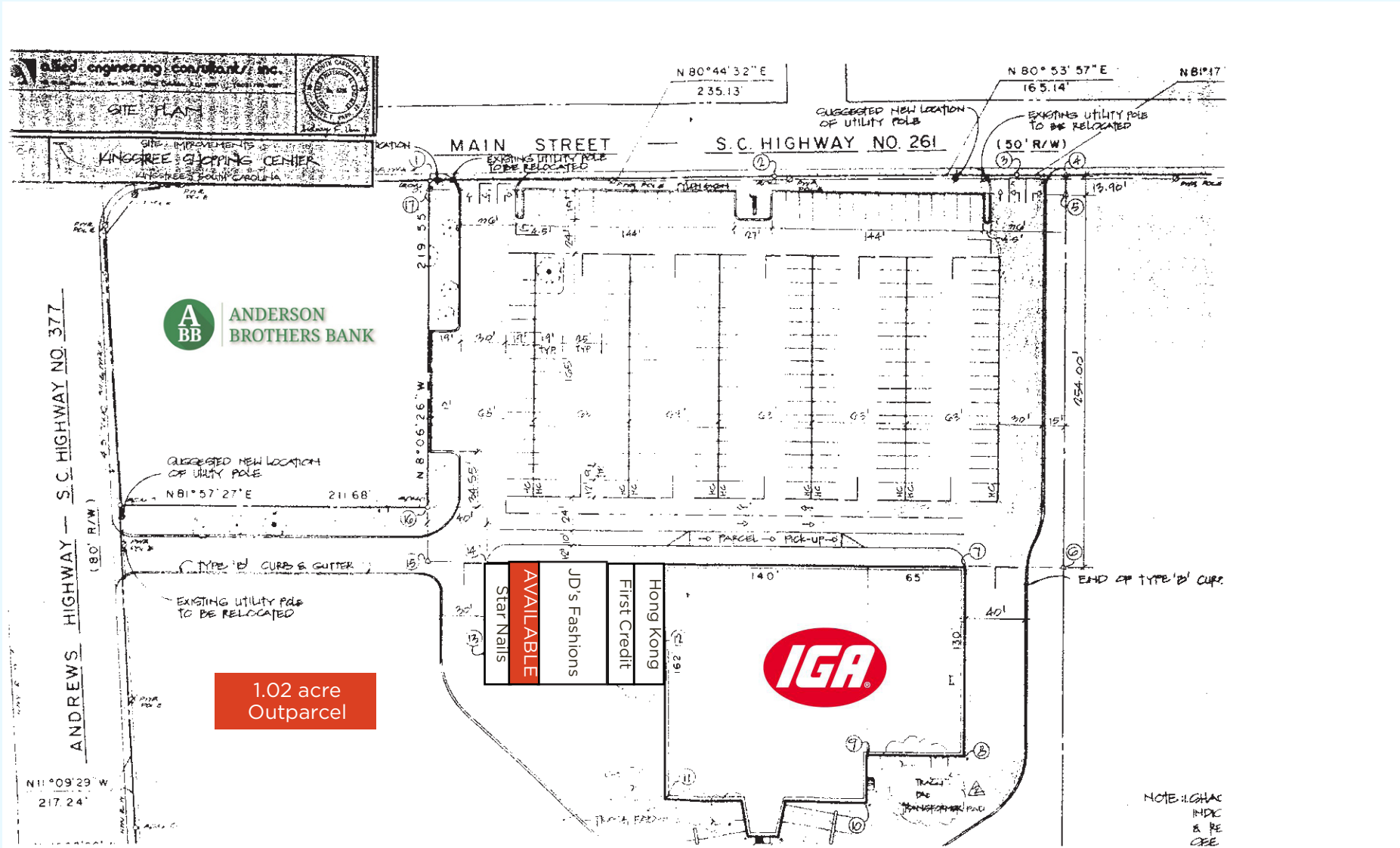

OFFERED BY



(843) 856-4600
www.belklucy.com

Morrow Boggs
morrow.boggs@belklucy.com
(843) 606-5460 — direct office
(843) 998-5234 — mobile

AND

Trey Lucy
trey.lucy@belklucy.com
(843) 606-5455 — direct office
(843) 566-2867 — mobile



OFFERED BY



(843) 856-4600
www.belklucy.com

Morrow Boggs
morrow.boggs@belklucy.com
(843) 606-5460 — direct office
(843) 998-5234 — mobile

AND

Trey Lucy
trey.lucy@belklucy.com
(843) 606-5455 — direct office
(843) 566-2867 — mobile