

OUTPARCEL



**AVAILABLE:
OP 3: 1.65 AC**

Other Shops include



Edward Jones



OFFERED BY



(843) 856-4600
www.belklucy.com

Trey Lucy
trey.lucy@belklucy.com
(843) 606-5455 — direct office
(843) 566-2867 — mobile

AND

Blair Belk, CCIM
blair.belk@belklucy.com
(843) 606-5449 — direct office
(843) 709-9292 — mobile



PROPERTY DESCRIPTION



THE MARKET AT CANE BAY

Belk | Lucy is pleased to present the exclusive listing of the outparcel located at The Market at Cane Bay, a Publix-anchored shopping center positioned at the intersection of Highway 176 and Cane Bay Boulevard at the entrance to Cane Bay Plantation in Summerville, SC. The available parcel can accommodate up to a maximum of a 5,000 square foot free-standing building. The 45,600 square foot Publix opened in October 2011 and features approximately 40,000 square feet of retail shop space. This shopping center is directly across from Cane Bay High School, one of the largest high school campuses in the state.

Cane Bay Plantation was the 14th best-selling master-planned community in the US in 2019 with an impressive 628 homes sold. It also earned its ranking as #1 top-selling community for the last five years in the tri-country area as well as in the state of South Carolina. At capacity, this community will house roughly 13,000 homes. Offering convenience, top-rated schools, and numerous amenities, this well-established and fast-growing community is an excellent opportunity to join other successful area businesses.

© Max square footage is 5,000

TERMS AND CONDITIONS		
Outparcel 3	1.65 Gross Acres	1.16 Net Acres
Ground Lease:	\$150,000/yr	

OFFERED BY



(843) 856-4600
www.belklucy.com

Trey Lucy
trey.lucy@belklucy.com
(843) 606-5455 — direct office
(843) 566-2867 — mobile

AND

Blair Belk, CCIM
blair.belk@belklucy.com
(843) 606-5449 — direct office
(843) 709-9292 — mobile

SITE PLAN

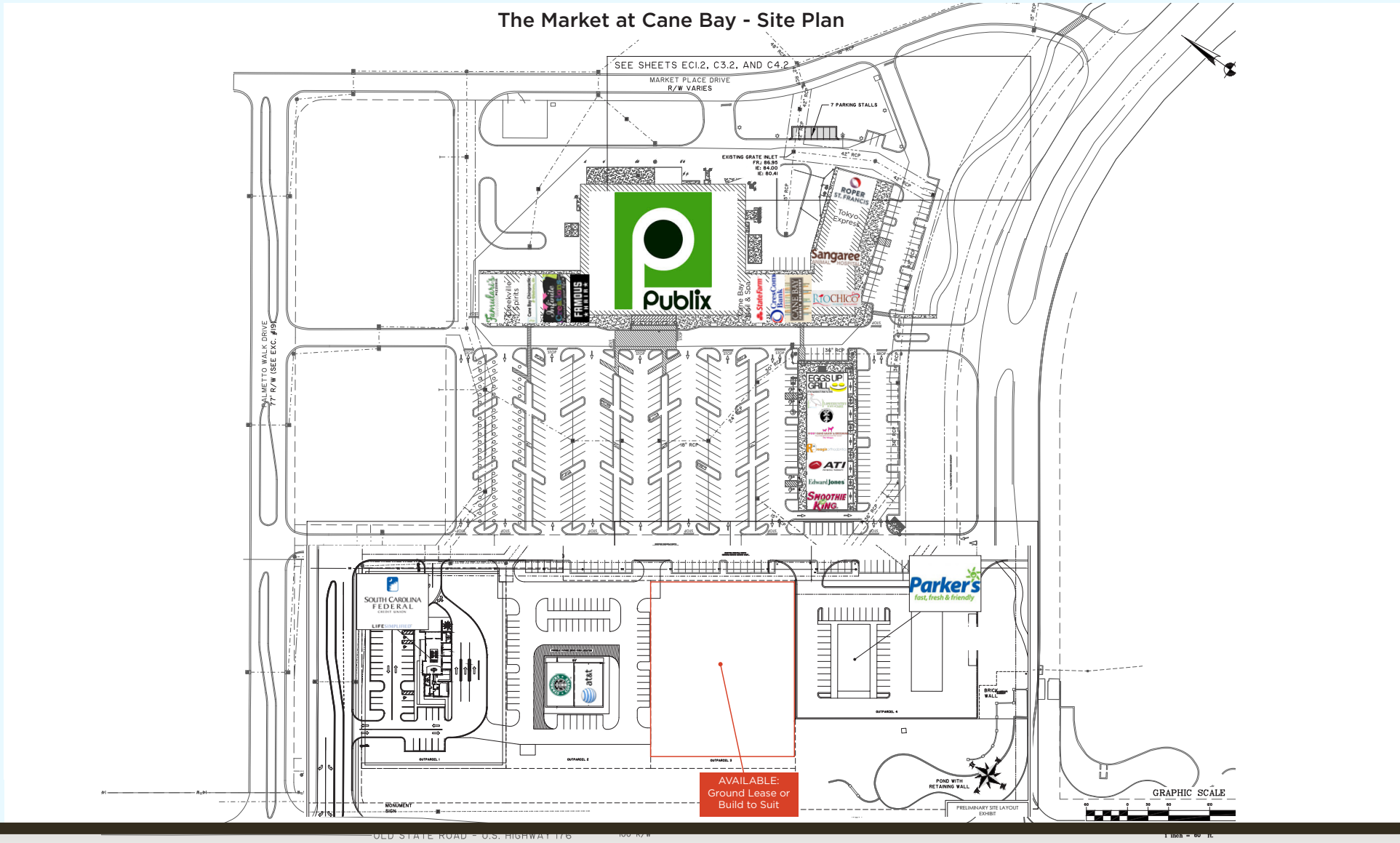

OFFERED BY



(843) 856-4600
www.belklucy.com

Trey Lucy
trey.lucy@belklucy.com
(843) 606-5455 — direct office
(843) 566-2867 — mobile

AND

Blair Belk, CCIM
blair.belk@belklucy.com
(843) 606-5449 — direct office
(843) 709-9292 — mobile



OFFERED BY



(843) 856-4600
www.belklucy.com

Trey Lucy
trey.lucy@belklucy.com
(843) 606-5455 — direct office
(843) 566-2867 — mobile

AND

Blair Belk, CCIM
blair.belk@belklucy.com
(843) 606-5449 — direct office
(843) 709-9292 — mobile

MASTER PLAN



**Cane Bay
PLANTATION**

CANE BAY PLANTATION HOME SALES

2019	628
2018	475
2017	584
2016	569
2015	520
2014	385
2013	341

- LEGEND**
- 1 THE MARKET AT CANE BAY
 - 2 CANE BAY HIGH SCHOOL
 - 3 CANE BAY MIDDLE SCHOOL
 - 4 CANE BAY ELEMENTARY SCHOOL
 - 5 PALMETTO WALK
 - 6 OLD RICE RETREAT
 - 7 MAGNOLIA
 - 8 SANCTUARY COVE
 - 9 THE OAKS
 - 10 LINDERA PRESERVE
 - 11 CHARLESTON ATLANTIC PRESBYTERY
 - 12 THE HAMMOCKS
 - 13 YMCA
 - 14 DEL WEBB
 - 15 PALMICO HOMES
 - 16 THE COVES AT LAKES OF CANE BAY
 - 17 K. HOVNANIAN'S FOUR SEASONS

GRAMLING BROTHERS REAL ESTATE & DEVELOPMENT, INC.



MASTER PLAN
CANE BAY PLANTATION

February 18, 2015

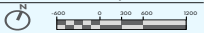

This map illustrates a general plan of the development which is for discussion purposes only, does not limit or bind the owner/developer, and is subject to change and revision without prior written notice to the holder. Dimensions, boundaries, and position locations are for illustrative purposes only and are subject to an accurate survey and property description.

OFFERED BY



(843) 856-4600
www.belklucy.com

Trey Lucy
trey.lucy@belklucy.com
(843) 606-5455 — direct office
(843) 566-2867 — mobile

AND

Blair Belk, CCIM
blair.belk@belklucy.com
(843) 606-5449 — direct office
(843) 709-9292 — mobile