

Office Condo For Sale Or Lease

1425 Hand Avenue, Suite B
Ormond Beach, FL 32174



OFFERING SUMMARY

AVAILABLE SF: Suite B: 1,142 SF

SALE PRICE: \$159,880

LEASE RATE: \$12.00 NNN "SHELL"

PARCEL NO: 4229-13-00-0020

YEAR BUILT: 2006

ZONING: PBD 'Planned Business
Development'

PROPERTY OVERVIEW

1,142 SF Office Condo For Sale or Lease.
Great Hand Avenue location between Clyde Morris Boulevard and Nova Road.

Building and Monument Signage available.
Approximately 2.8 miles to AdventHealth Daytona Beach.
Estimated CAM, Real Estate Taxes, and Insurance \$5.25 per SF.
SELLER FINANCING AVAILABLE AT 5%.

No survey or appraisal needed. No origination fees.

LOCATION OVERVIEW

Located on the north side of Hand Avenue between Clyde Morris Boulevard and Nova Road.

DEMOGRAPHICS

	1 MILE	5 MILES	10 MILES
Total Households	2,780	38,876	77,094
Total Population	8,420	102,969	181,899
Average HH Income	\$45,240	\$56,548	\$52,940

John W. Trost, CCIM
Principal | Senior Advisor
386.301.4581
john.trost@svn.com



The information presented here is deemed to be accurate, but it has not been independently verified. We make no guarantee, warranty or representation. It is your responsibility to independently confirm accuracy and completeness. All SVN® offices are independently owned and operated.

Additional Photos



John W. Trost, CCIM
Principal | Senior Advisor
386.301.4581
john.trost@svn.com



The information presented here is deemed to be accurate, but it has not been independently verified. We make no guarantee, warranty or representation. It is your responsibility to independently confirm accuracy and completeness. All SVN® offices are independently owned and operated.

Floor Plan

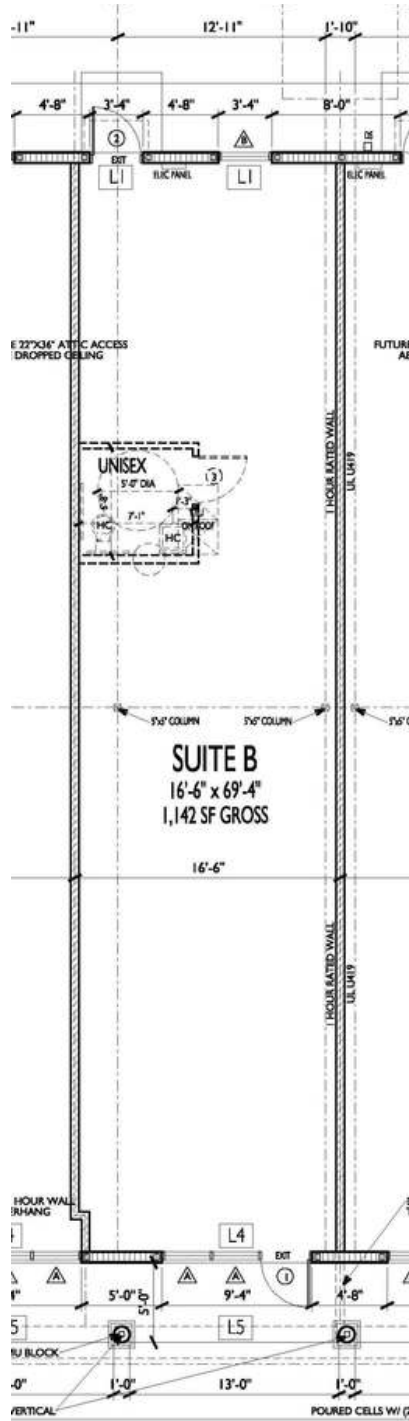

John W. Trost, CCIM
 Principal | Senior Advisor
 386.301.4581
 john.trost@svn.com



The information presented here is deemed to be accurate, but it has not been independently verified. We make no guarantee, warranty or representation. It is your responsibility to independently confirm accuracy and completeness. All SVN® offices are independently owned and operated.

Location Maps

Hand Avenue Professional Center

1425 Hand Avenue, Ormond Beach, FL 32174

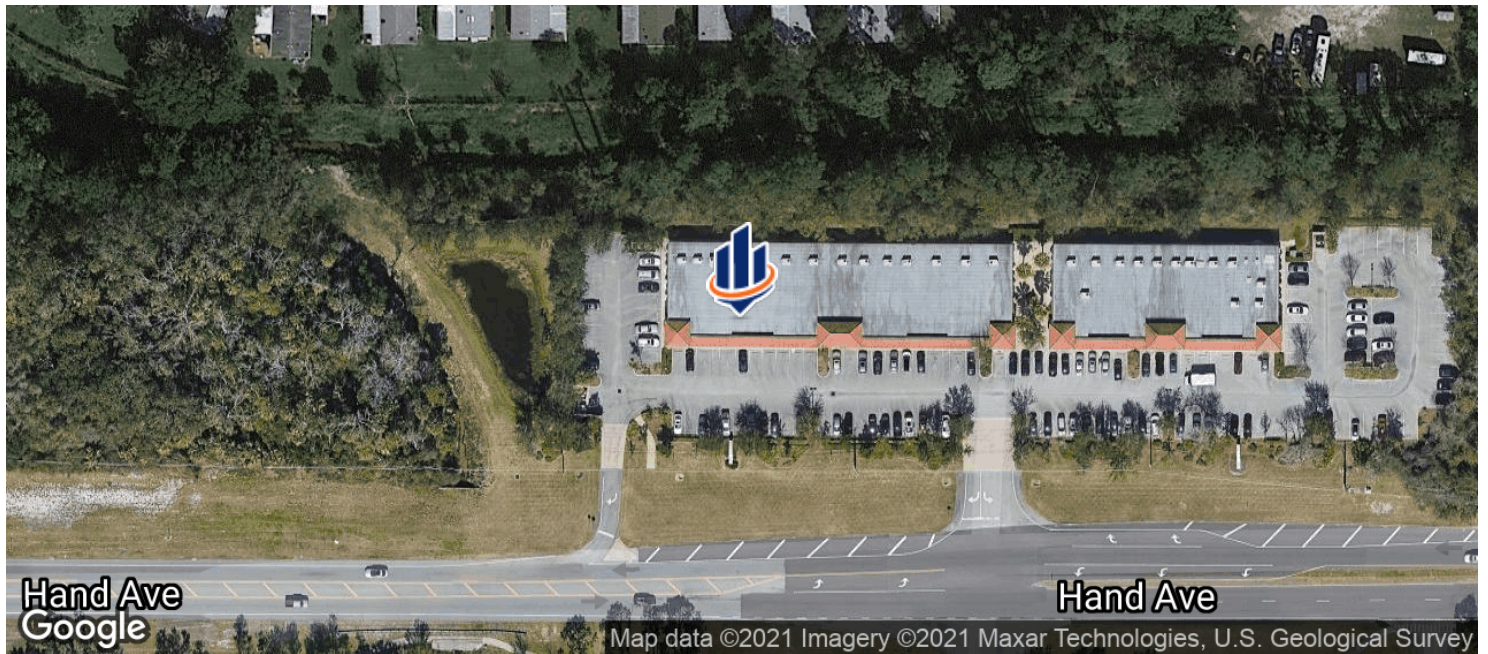

John W. Trost, CCIM
Principal | Senior Advisor
386.301.4581
john.trost@svn.com



The information presented here is deemed to be accurate, but it has not been independently verified. We make no guarantee, warranty or representation. It is your responsibility to independently confirm accuracy and completeness. All SVN® offices are independently owned and operated.