

FOR LEASE: 4,025 - 8,050 SQUARE FEET  
118 - 122 PARKHOUSE ST, DALLAS, TX 75207

INDUSTRIAL REAL ESTATE BROKERAGE

WWW.MERCER-COMPANY.COM

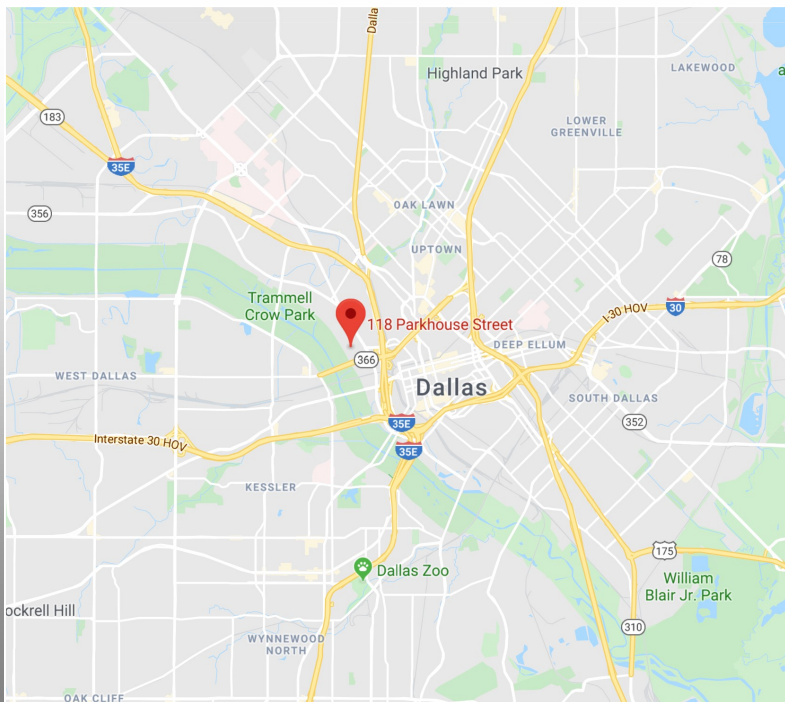

## DETAILS

### AVAILABLE FOR LEASE

- ◆ TOTAL SF: 4,025 - 8,050
- ◆ CLEAR HEIGHT: 14'
- ◆ DOCK DOORS: 2 INTERIOR (1 PER SUITE)
- ◆ 100% HVAC
- ◆ ±1,000 SF OFFICE IN EACH SUITE
- ◆ KITCHENETTE & BREAKROOM
- ◆ CLOSE TO MAJOR THOROUGHFARES

JEREMY MERCER

CELL 214.682.3447

JEREMY@MERCER-COMPANY.COM

DAVID GUINN

CELL 940.550.8618

DGUINN@MERCER-COMPANY.COM

FOR LEASE: 4,025 - 8,050 SQUARE FEET  
118 - 122 PARKHOUSE ST, DALLAS, TX 75207

INDUSTRIAL REAL ESTATE BROKERAGE

WWW.MERCER-COMPANY.COM

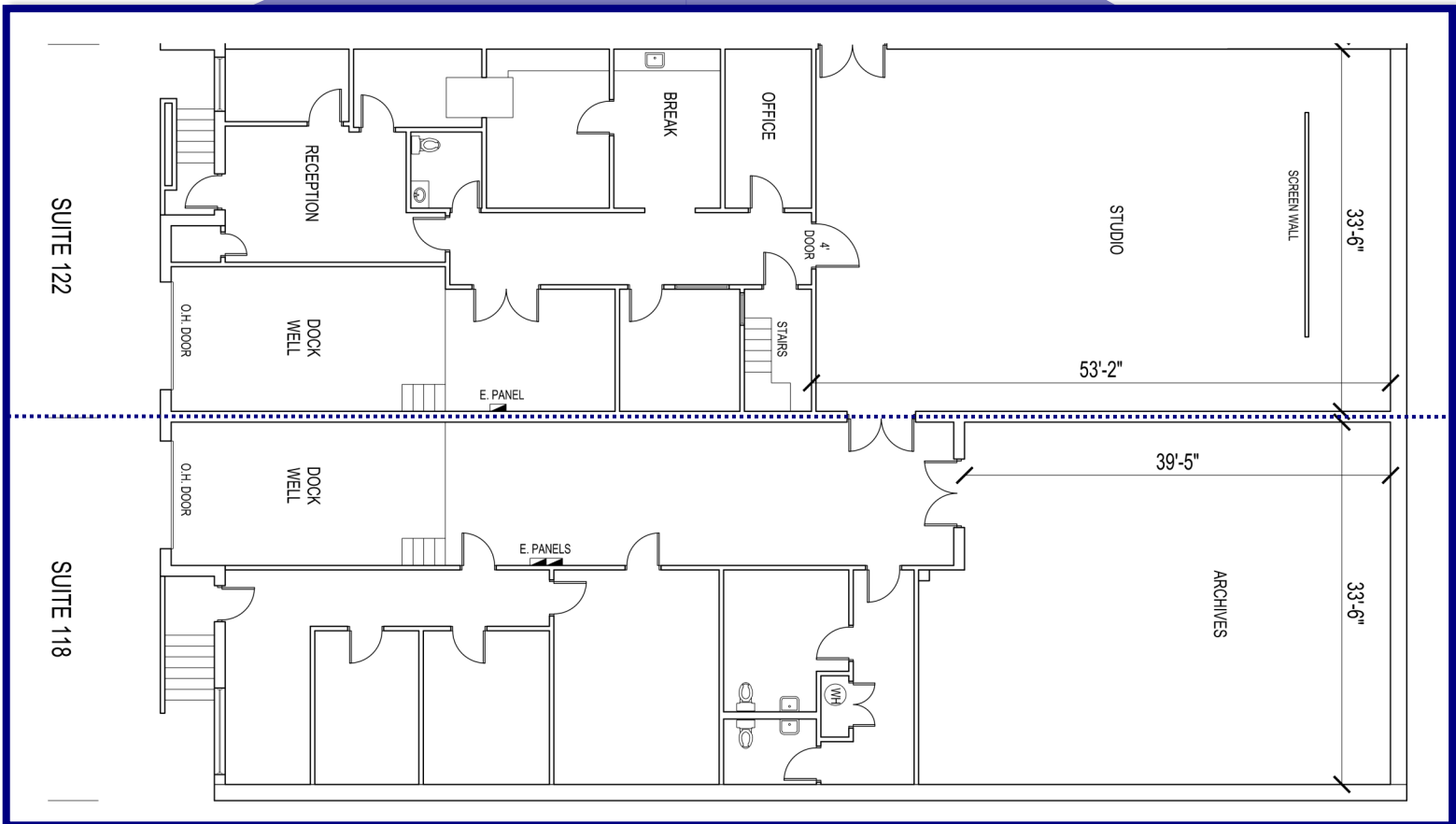
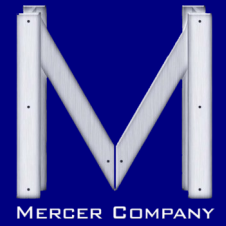

The information contained herein has been given to us by the owner of the property or other sources we deem reliable. We have no reason to doubt its accuracy, but we do not guarantee it. All information should be verified before purchase or lease.