

FOR SALE

23735 JACKSON AVENUE
MURRIETA, CA 92562



Join CVS Drug Store in this rare infill location. Located in a highly dense residential area with over 158,000 residents in a 5-mile radius with an average household income of more than \$102,000.

The open floor plan is an excellent opportunity for a variety of uses. New construction provides an attractive store front and 68 parking spaces for ample customer parking.

Located within 2 miles of Inland Valley Hospital, Southwest Healthcare System and Kaiser Permanente. The building has great amenities with extra high ceilings and dock-high loading. It is in a great location!

PROPERTY HIGHLIGHTS:

- ±13,989 SF FREESTANDING BUILDING
LOCATED ON ±1.41 ACRES
- IDEAL OWNER/USER OPPORTUNITY
- ZONED: COMMUNITY COMMERCIAL (CC)
- BUILT IN 2011

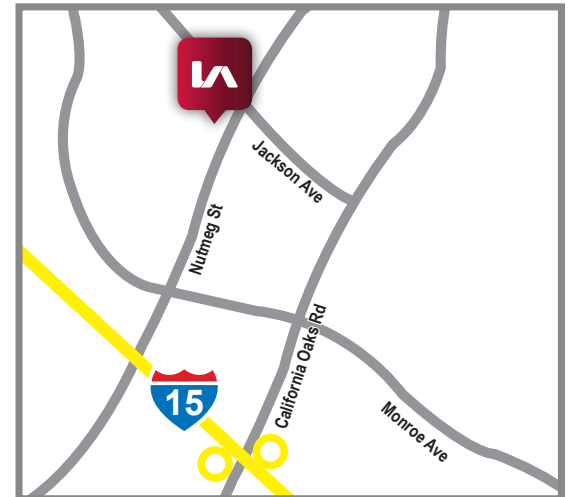

SALE PRICE:
\$2,995,000

ALISA LOVAS-HOPSITER

951.445.4524
alovas@leetemecula.com
DRE #01200336

FRANK VORA, CCIM

951.276.3645
fvora@lee-associates.com
DRE #01793683

DEMOGRAPHICS	1 mile	3 mile	5 mile
Average Income	\$92,079	\$98,597	\$102,187
Population	16,809	87,415	158,368
Daytime Population	6,892	46,945	83,415

No warranty or representation has been made to the accuracy of the foregoing information. Terms of sale or lease and availability are subject to change or withdrawal without notice. Lee & Associates Commercial Real Estate Services, Inc. - Riverside. 25240 Hancock Avenue, Suite 100 - Murrieta, CA 92562 | Corporate ID# 01048055

FOR SALE

23735 JACKSON AVENUE
MURRIETA, CA 92562

FLOOR PLAN

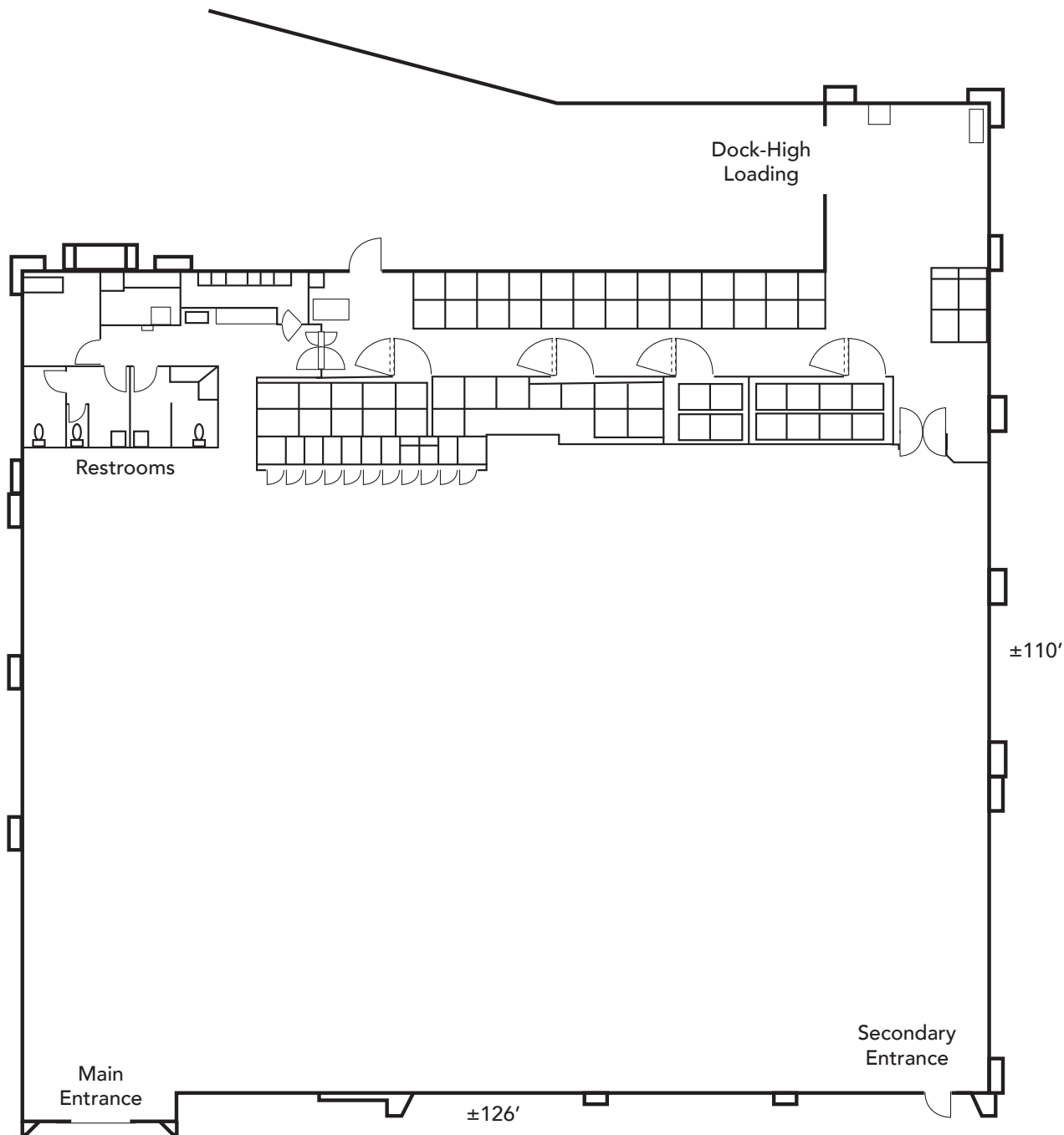

ALISA LOVAS-HOPSITER

951.445.4524

alovas@leetemecula.com

DRE #01200336

FRANK VORA, CCIM

951.276.3645

fvora@lee-associates.com

DRE #01793683

No warranty or representation has been made to the accuracy of the foregoing information. Terms of sale or lease and availability are subject to change or withdrawal without notice. Lee & Associates Commercial Real Estate Services, Inc. - Riverside. 25240 Hancock Avenue, Suite 100 - Murrieta, CA 92562 | Corporate ID# 01048055

FOR SALE

23735 JACKSON AVENUE
MURRIETA, CA 92562



ALISA LOVAS-HOPSITER
951.445.4524
alovas@leetemecula.com
DRE #01200336

FRANK VORA, CCIM
951.276.3645
fvora@lee-associates.com
DRE #01793683

No warranty or representation has been made to the accuracy of the foregoing information. Terms of sale or lease and availability are subject to change or withdrawal without notice. Lee & Associates Commercial Real Estate Services, Inc. - Riverside. 25240 Hancock Avenue, Suite 100 - Murrieta, CA 92562 | Corporate ID# 01048055