

M & J OF JACKSONVILLE INC 
 5959 YOUNGERMAN CIR E
 JACKSONVILLE, FL 32244

Primary Site Address
 0 CAGLE RD
 Jacksonville FL 32216

Official Record Book/Page
 13289-01689

Title #
 7505

0 CAGLE RD

Property Detail

RE #	153066-0100
Tax District	GS
Property Use	2891 Parking Lot
# of Buildings	0
Legal Desc.	For full legal description see Land & Legal section below
Subdivision	02831 BOWDEN FARMS S/D
Total Area	8790

Value Summary

Value Description	2018 Certified	2019 In Progress
Value Method	CAMA	CAMA
Total Building Value	\$0.00	\$0.00
Extra Feature Value	\$8,229.00	\$8,237.00
Land Value (Market)	\$13,068.00	\$13,068.00
Land Value (Agric.)	\$0.00	\$0.00
Just (Market) Value	\$21,297.00	\$21,305.00
Assessed Value	\$21,297.00	\$21,305.00
Cap Diff/Portability Amt	\$0.00 / \$0.00	\$0.00 / \$0.00
Exemptions	\$0.00	See below
Taxable Value	\$21,297.00	See below

The sale of this property may result in higher property taxes. For more information go to [Save Our Homes](#) and our [Property Tax Estimator](#). 'In Progress' property values, exemptions and other supporting information on this page are part of the working tax roll and are subject to change. Certified values listed in the Value Summary are those certified in October, but may include any official changes made after certification [Learn how the Property Appraiser's Office values property.](#)

Taxable Values and Exemptions – In Progress 

If there are no exemptions applicable to a taxing authority, the Taxable Value is the same as the Assessed Value listed above in the Value Summary box.

County/Municipal Taxable Value
 No applicable exemptions

SJRWMD/FIND Taxable Value
 No applicable exemptions

School Taxable Value
 No applicable exemptions

Sales History 

Book/Page	Sale Date	Sale Price	Deed Instrument Type Code	Qualified/Unqualified	Vacant/Improved
13289-01689	5/17/2006	\$100.00	WD - Warranty Deed	Unqualified	Vacant

Extra Features 

LN	Feature Code	Feature Description	Bldg.	Length	Width	Total Units	Value
1	PVAC1	Paving Asphalt	0	0	0	6,894.00	\$4,915.00
2	FCLC1	Fence Chain Link	0	0	0	274.00	\$3,322.00

Land & Legal 

Land										Legal	
LN	Code	Use Description	Zoning	Front	Depth	Category	Land Units	Land Type	Land Value	LN	Legal Description
1	1000	COMMERCIAL	CCG-1	0.00	0.00	Common	8,712.00	Square Footage	\$13,068.00	1	6-91 56-3S-27E .2
										2	BOWDEN FARMS S/D
										3	PT FARM 29 RECD O/R 13289-1689

Buildings 

No data found for this section

2019 Notice of Proposed Property Taxes Notice (TRIM Notice)

Taxing District	Assessed Value	Exemptions	Taxable Value	Last Year	Proposed	Rolled-back
Gen Govt Ex B&B	\$21,305.00	\$0.00	\$21,305.00	\$243.68	\$243.77	\$230.32
Public Schools: By State Law	\$21,305.00	\$0.00	\$21,305.00	\$86.15	\$83.13	\$80.87
By Local Board	\$21,305.00	\$0.00	\$21,305.00	\$47.88	\$47.89	\$44.95
FL Inland Navigation Dist.	\$21,305.00	\$0.00	\$21,305.00	\$0.68	\$0.68	\$0.65
Water Mgmt Dist. SJRWMD	\$21,305.00	\$0.00	\$21,305.00	\$5.46	\$5.14	\$5.14
Gen Gov Voted	\$21,305.00	\$0.00	\$21,305.00	\$0.00	\$0.00	\$0.00
School Board Voted	\$21,305.00	\$0.00	\$21,305.00	\$0.00	\$0.00	\$0.00
			Totals	\$383.85	\$380.61	\$361.93

Description	Just Value	Assessed Value	Exemptions	Taxable Value
Last Year	\$21,297.00	\$21,297.00	\$0.00	\$21,297.00
Current Year	\$21,305.00	\$21,305.00	\$0.00	\$21,305.00

2019 TRIM Property Record Card (PRC)

This PRC reflects property details and values at the time of the original mailing of the Notices of Proposed Property Taxes (TRIM Notices) in August.

Property Record Card (PRC)

The PRC accessed below reflects property details and values at the time of Tax Roll Certification in October of the year listed.

2018

2017

2016

2015

2014

- To obtain a historic Property Record Card (PRC) from the Property Appraiser's Office, submit your request here: 

More Information

[Contact Us](#) | [Parcel Tax Record](#) | [GIS Map](#) | [Map this property on Google Maps](#) | [City Fees Record](#)

M & J OF JACKSONVILLE INC 
 5959 YOUNGERMAN CIR E
 JACKSONVILLE, FL 32244

Primary Site Address
 5308 W UNIVERSITY BLVD
 Jacksonville FL 32216

Official Record Book/Page
 13160-01290

Tile #
 7505

5308 W UNIVERSITY BLVD

Property Detail

RE #	153076-0000
Tax District	GS
Property Use	2794 Vehicle Used Sales/Rental
# of Buildings	1
Legal Desc.	For full legal description see Land & Legal section below
Subdivision	02831 BOWDEN FARMS S/D
Total Area	22436

Value Summary

Value Description	2018 Certified	2019 In Progress
Value Method	CAMA	CAMA
Total Building Value	\$41,753.00	\$43,160.00
Extra Feature Value	\$9,621.00	\$9,540.00
Land Value (Market)	\$224,770.00	\$224,770.00
Land Value (Agric.)	\$0.00	\$0.00
Just (Market) Value	\$276,144.00	\$277,470.00
Assessed Value	\$195,200.00	\$214,720.00
Cap Diff/Portability Amt	\$80,944.00 / \$0.00	\$62,750.00 / \$0.00
Exemptions	\$0.00	See below
Taxable Value	\$195,200.00	See below

The sale of this property may result in higher property taxes. For more information go to [Save Our Homes](#) and our [Property Tax Estimator](#). 'In Progress' property values, exemptions and other supporting information on this page are part of the working tax roll and are subject to change. Certified values listed in the Value Summary are those certified in October, but may include any official changes made after certification. [Learn how the Property Appraiser's Office values property.](#)

Taxable Values and Exemptions – In Progress 

If there are no exemptions applicable to a taxing authority, the Taxable Value is the same as the Assessed Value listed above in the Value Summary box.

County/Municipal Taxable Value
 No applicable exemptions

SJRWMD/FIND Taxable Value
 No applicable exemptions

School Taxable Value
 No applicable exemptions

Sales History 

Book/Page	Sale Date	Sale Price	Deed Instrument Type Code	Qualified/Unqualified	Vacant/Improved
13160-01290	3/20/2006	\$340,000.00	MS - Miscellaneous	Qualified	Improved
08230-01215	11/27/1995	\$100,000.00	SW - Special Warranty	Qualified	Improved

Extra Features 

LN	Feature Code	Feature Description	Bldg.	Length	Width	Total Units	Value
1	PVCC1	Paving Concrete	1	0	0	590.00	\$800.00
2	PVAC1	Paving Asphalt	1	0	0	5,760.00	\$4,107.00
3	FCLC1	Fence Chain Link	1	0	0	212.00	\$791.00
4	FCLC1	Fence Chain Link	1	0	0	412.00	\$3,842.00

Land & Legal 

Land

LN	Code	Use Description	Zoning	Front	Depth	Category	Land Units	Land Type	Land Value
1	1000	COMMERCIAL	CCG-1	0.00	0.00	Common	22,477.00	Square Footage	\$224,770.00

Legal

LN	Legal Description
1	6-91 05-3S-27E .516
2	BOWDEN FARMS S/D
3	PT FARM 29 RECD O/R 13160-1290

Buildings 

Building 1

Building 1 Site Address
 5308 W UNIVERSITY BLVD Unit
 Jacksonville FL 32216

Building Type	2601 - SERVICE STATION
Year Built	1966
Building Value	\$43,160.00

Type	Gross Area	Heated Area	Effective Area
Canopy Detached	576	0	202
Canopy	274	0	82
Base Area	1400	1400	1400
Canopy	105	0	32
Canopy Detached	576	0	202
Canopy	120	0	36
Total	3051	1400	1954

Element	Code	Detail
Exterior Wall	20	20 Face Brick
Roof Struct	10	10 Steel Fr/Trs
Roofing Cover	4	4 Built Up/T&G
Interior Wall	1	1 Masonry Min
Int Flooring	3	3 Concrete Fin
Heating Fuel	1	1 None
Heating Type	1	1 None
Air Cond	1	1 None
Ceiling Wall Finish	4	4 NS Ceil Min Wall
Comm Htg & AC	0	0 None
Comm Frame	3	3 C-Masonry

Element	Code	Detail
Baths	8.000	
Stories	1.000	
Rooms / Units	5.000	
Avg Story Height	8.000	
Restrooms	2.000	

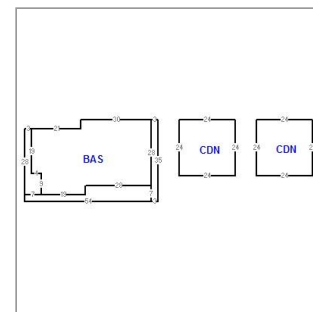

2019 Notice of Proposed Property Taxes Notice (TRIM Notice)

Taxing District	Assessed Value	Exemptions	Taxable Value	Last Year	Proposed	Rolled-back
Gen Govt Ex B&B	\$214,720.00	\$0.00	\$214,720.00	\$2,233.46	\$2,456.80	\$2,321.29
Public Schools: By State Law	\$214,720.00	\$0.00	\$277,470.00	\$1,117.00	\$1,082.69	\$1,053.28
By Local Board	\$214,720.00	\$0.00	\$277,470.00	\$620.77	\$623.75	\$585.35
FL Inland Navigation Dist.	\$214,720.00	\$0.00	\$214,720.00	\$6.25	\$6.87	\$6.53
Water Mgmt Dist. SJRWMD	\$214,720.00	\$0.00	\$214,720.00	\$50.01	\$51.83	\$51.83
Gen Gov Voted	\$214,720.00	\$0.00	\$214,720.00	\$0.00	\$0.00	\$0.00
School Board Voted	\$214,720.00	\$0.00	\$277,470.00	\$0.00	\$0.00	\$0.00
			Totals	\$4,027.49	\$4,221.94	\$4,018.28

Description	Just Value	Assessed Value	Exemptions	Taxable Value
Last Year	\$276,144.00	\$195,200.00	\$0.00	\$195,200.00
Current Year	\$277,470.00	\$214,720.00	\$0.00	\$214,720.00

2019 TRIM Property Record Card (PRC)

This PRC reflects property details and values at the time of the original mailing of the Notices of Proposed Property Taxes (TRIM Notices) in August.

Property Record Card (PRC)

The PRC accessed below reflects property details and values at the time of Tax Roll Certification in October of the year listed.

2018

2017

2016

2015

2014

- To obtain a historic Property Record Card (PRC) from the Property Appraiser's Office, submit your request here: 

More Information

[Contact Us](#) | [Parcel Tax Record](#) | [GIS Map](#) | [Map this property on Google Maps](#) | [City Fees Record](#)