



# 1702 CUMING STREET

OMAHA, NE 68102

**4,000 SF Available For Lease**



# PROPERTY HIGHLIGHTS

Downtown retail opportunity for lease at 17th and Cuming Street, with designated off-street parking perfect for a boutique, service user or a light flex user. The space is equipped with a garage door for convenient deliveries.



## PROPERTY DETAILS

Lease Rate:	\$17.00 PSF NNN	Year Built/Renovated:	1906/2015
Total Building Size:	6,400 SF	Clearance Height:	18'
Available SF:	4,000 SF	HVAC	14 Ton (Rooftop Unit)
Operating Expenses:	\$7.50 PSF	Total Site Area:	0.21 AC (9,148 SF)
Date Available:	8/1/2025	Zoning:	DS-ACI-1 (PL)

# FLOOR PLAN

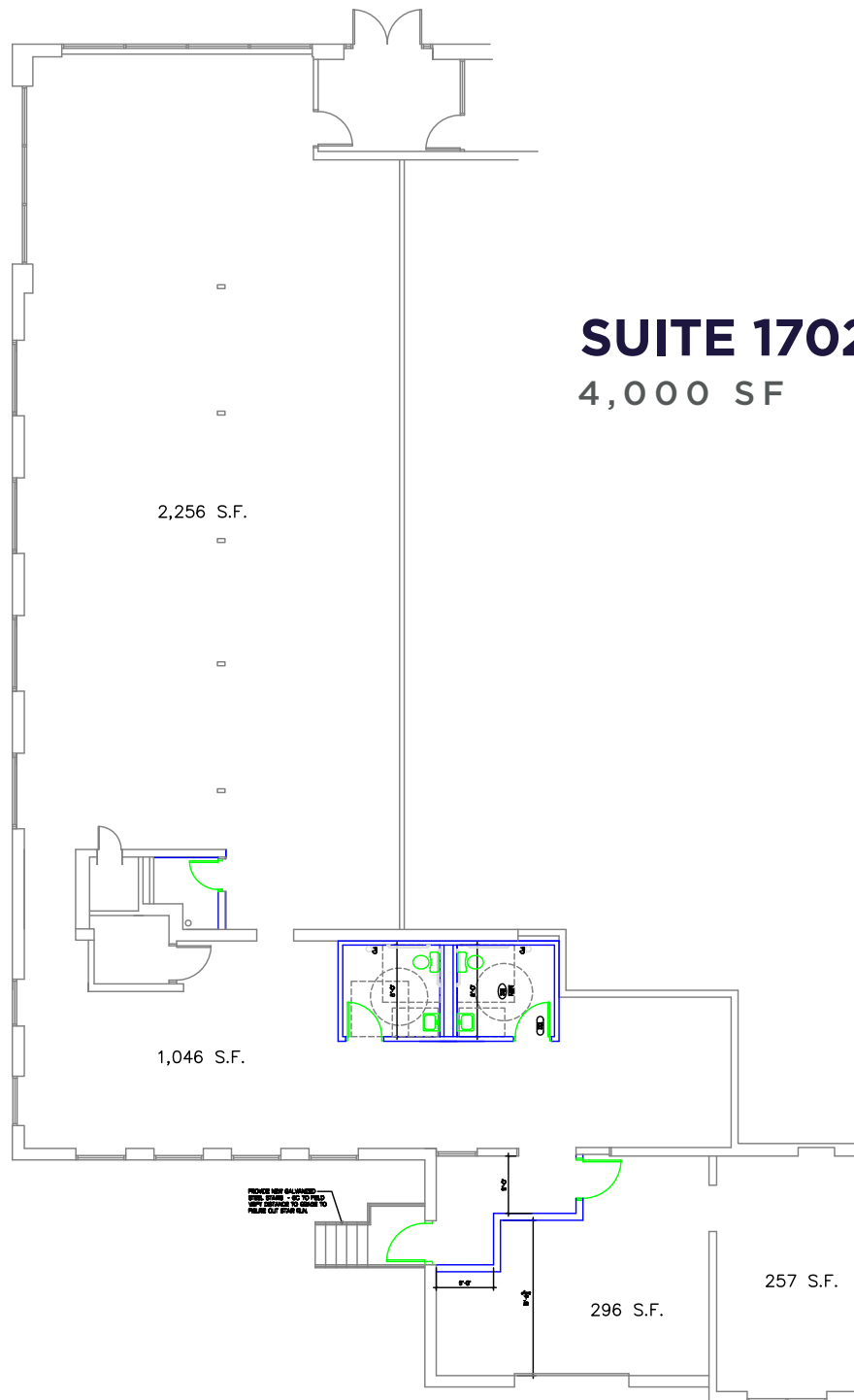

\*\* Floor plan measurements are approximate and are for illustration purposes only.

EXTERIOR PHOTOS



# INTERIOR PHOTO



# PARKING



16 OFF STREET  
PARKING STALLS

8 STREET  
PARKING STALLS

17TH STREET

CUMING STREET

25,026 EADT

# AERIAL MAP



BOYS & GIRLS CLUBS



metro



MILLWORK  
COMMONS



OMAHA  
Public Schools

CUMMING STREET

24TH STREET

17TH STREET

13TH STREET

ABBOTT DRIVE



charles SCHWAB field  
OMAHA



Kiewit



MIDTOWN  
CROSSING



Creighton  
UNIVERSITY



CHI Health Center  
OMAHA

30TH STREET

DODGE STREET



480



480

FARNAM STREET



Omaha World-Herald



THE  
CAPITOL  
DISTRICT



For more information, please contact:

**Holly Jones**

Director of Retail Services  
+1 402 548 4038  
[holly.jones@lundco.com](mailto:holly.jones@lundco.com)

**Trey MacKnight**

Associate  
+1 402 548 4079  
[trey.macknight@lundco.com](mailto:trey.macknight@lundco.com)

450 Regency Parkway, Suite 200  
Omaha, NE 68114  
+1 402 393 8811  
[lundco.com](http://lundco.com)

*Independently Owned and Operated / A Member of the Cushman & Wakefield Alliance*

©2024 Cushman & Wakefield. All rights reserved. The information contained in this communication is strictly confidential. This information has been obtained from sources believed to be reliable but has not been verified. NO WARRANTY OR REPRESENTATION, EXPRESS OR IMPLIED, IS MADE AS TO THE CONDITION OF THE PROPERTY (OR PROPERTIES) REFERENCED HEREIN OR AS TO THE ACCURACY OR COMPLETENESS OF THE INFORMATION CONTAINED HEREIN, AND SAME IS SUBMITTED SUBJECT TO ERRORS, OMISSIONS, CHANGE OF PRICE, RENTAL OR OTHER CONDITIONS, WITHDRAWAL WITHOUT NOTICE, AND TO ANY SPECIAL LISTING CONDITIONS IMPOSED BY THE PROPERTY OWNER(S). ANY PROJECTIONS, OPINIONS OR ESTIMATES ARE SUBJECT TO UNCERTAINTY AND DO NOT SIGNIFY CURRENT OR FUTURE PROPERTY PERFORMANCE.