

1760 MARKET STREET

PHILADELPHIA, PA

17
60
MKT

SUITE 1400 | 9,152 RSF

CUSTOMIZABLE, FULL FLOOR AVAILABLE



COLUMN-FREE, OPEN FLOOR



BUILD-TO-SUIT

SPACE HIGHLIGHTS



Full-Floor Availability: Exclusive, full-floor tenancy for enhanced privacy and branding opportunities.



Flexible Layout Options: Floor plan can be customized to accommodate various office configurations, from open workspaces to private offices and conference rooms.



Natural Light and Views: 14th floor provides ample natural light and impressive views toward City Hall and Rittenhouse Square.

SUITE 1400
VIRTUAL TOUR

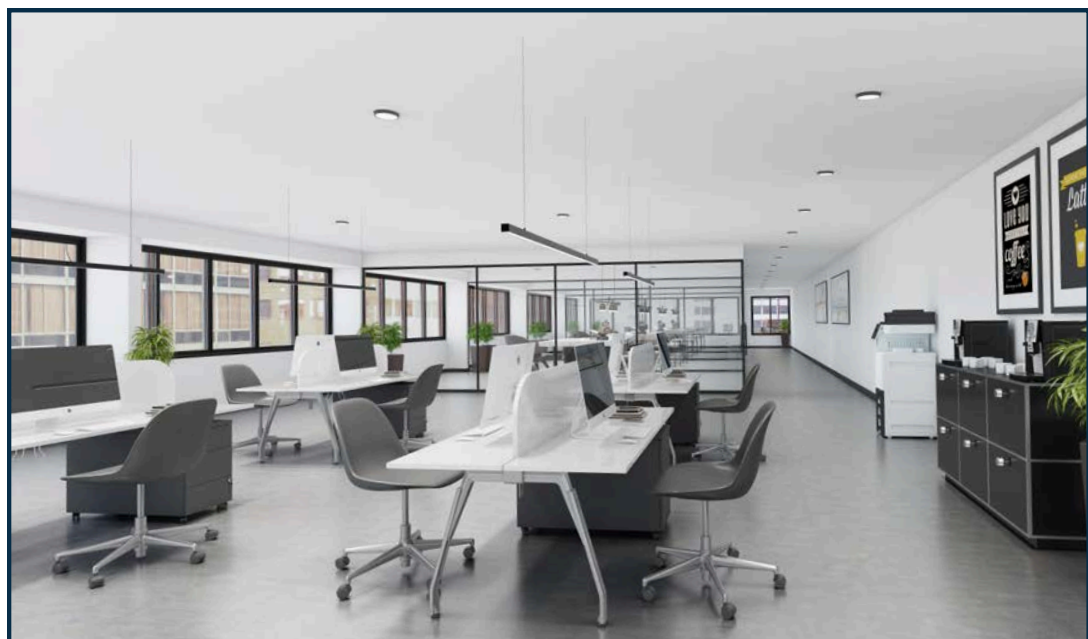

FURNISHED RENDERING



STOCKTON
REAL ESTATE ADVISORS

PRIME MARKET STREET LOCATION AT THE LOWEST MARKET (STREET) RATE!

- Column-free floor plates providing maximum efficiency and flexible open floor plans.
- Unparalleled connectivity with easy access to Suburban Station, I-676, I-76, and I-95. Conveniently located minutes from PATCO Speedline and 30th Street Station.



TENANT LOUNGE & CONFERENCE ROOM

BUILDING AMENITIES

- Conference Center
- Bike Storage
- On-Site Management
- Tenant Lounge
- On-Site Banking
- 24/7 Security

Prime corner office building located directly on Philadelphia's "Pedestrian Highway"

RETAIL
NEW & COMING SOON

- EQUINOX
- Levain
- GLOWBAR
- WORLD OF FLIGHT
- ARITZIA
- FIGS
- SKIN LAUNDRY
- FLIGHT CLUB
- ayat
- Lucy's
- Reformation



WALK SCORE
100

TRANSIT SCORE
100

BIKE SCORE
82

Nearby Amenities

- Parking
- Hotels
- Gyms

Jacklyn Hadzor
609.760.9985
jhadzor@StocktonREA.com

Stockton Real Estate Advisors, LLC
1760 Market Street, Suite 900, Philadelphia, PA
215.636.4444 | www.StocktonREA.com

