



**21100 Southgate Park Blvd.  
Maple Hts., OH**

## Property Features

- Full Build-out Required
- Below-Market Rent
- Abundant Parking
- Private Entrance
- Immediate Access to I-480 and I-271 Interchange.



### LEASE RATES

Suite 200B	5,264 SF	\$11.00 SF	MG
------------	----------	------------	----

**Joe Hauman**  
+1 440 591 3723  
joe.hauman@naipvc.com

**Noah Broadbent**  
+1 440 708 8578  
noah.broadbent@naipvc.com

# FOR LEASE

Suite 200B Photos



**Joe Hauman**  
+1 440 591 3723  
joe.hauman@naipvc.com

**Noah Broadbent**  
+1 440 708 8578  
noah.broadbent@naipvc.com

# FOR LEASE

## Floorplan

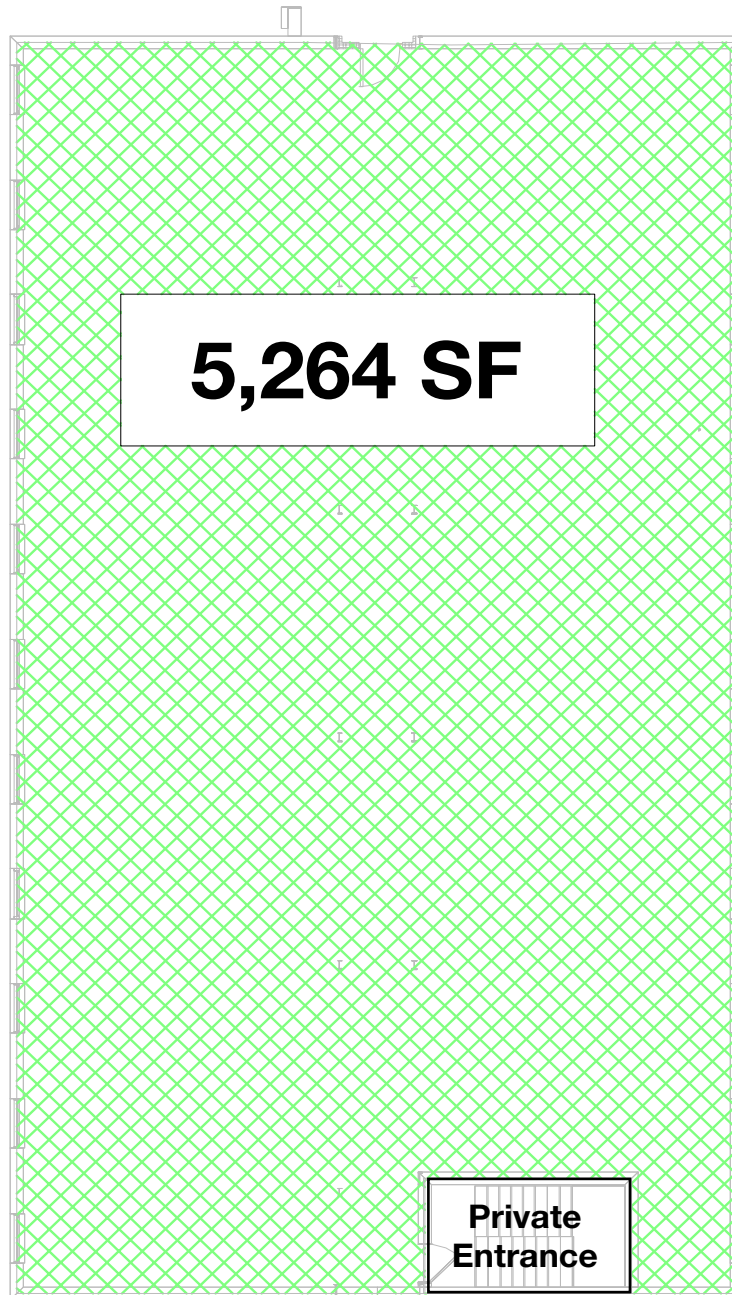

### SECOND LEVEL

1' = 30'-0"

01.04.2018

NORTH



**Joe Hauman**

+1 440 591 3723

joe.hauman@naipvc.com

**Noah Broadbent**

+1 440 708 8578

noah.broadbent@naipvc.com

# FOR SALE

## Location

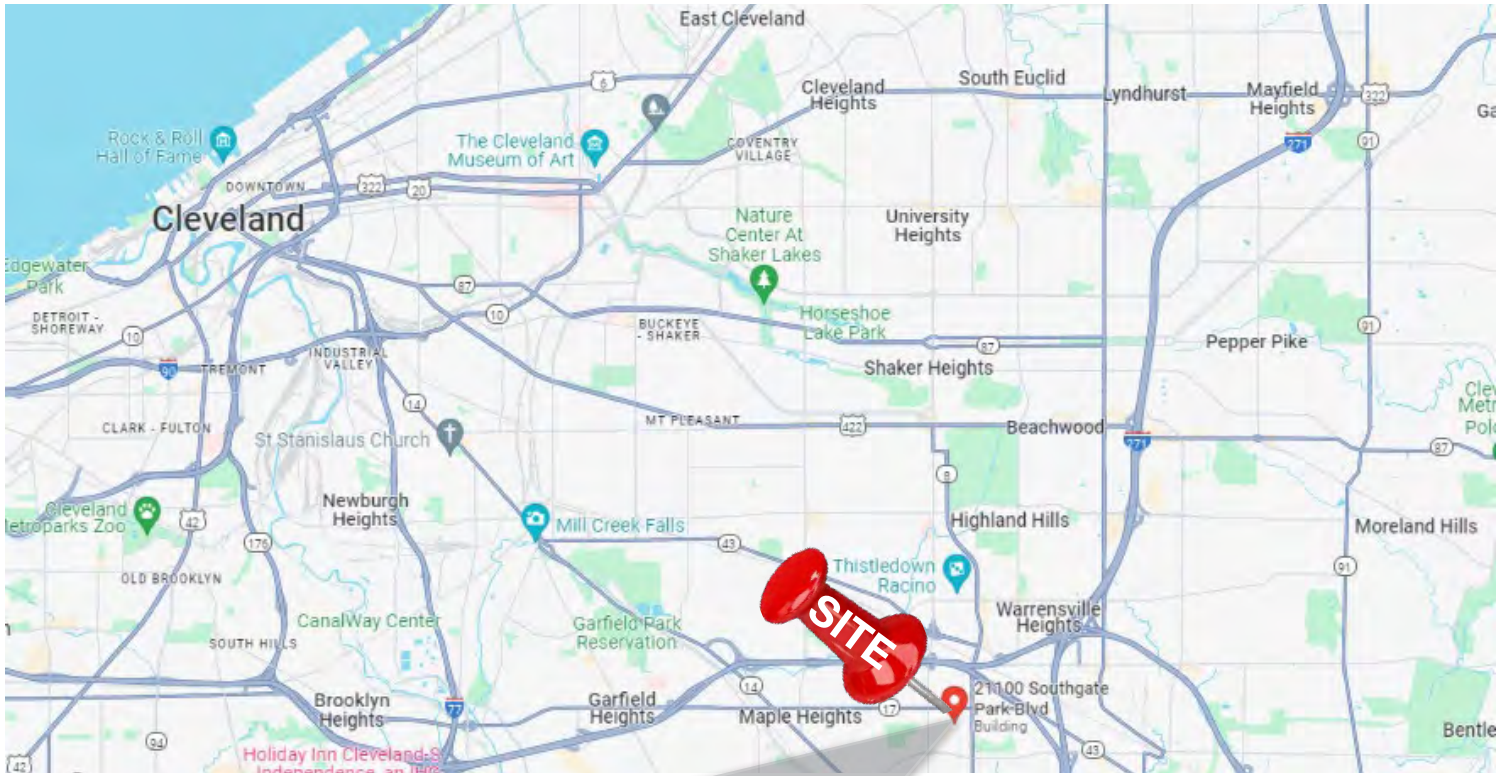

21100 Southgate Park Blvd.  
Maple Hts., OH

**Joe Hauman**  
+1 440 591 3723  
joe.hauman@naipvc.com

**Noah Broadbent**  
+1 440 708 8578  
noah.broadbent@naipvc.com

# DEMOGRAPHS

## 1 Mile Radius

### KEY FACTS

11,685

Population



2.2

Average Household Size

43.1

Median Age

\$47,658

Median Household Income

### EDUCATION

9%

No High School Diploma



41%

High School Graduate



35%

Some College



16%

Bachelor's/Grad/Pr of Degree

### BUSINESS



456

Total Businesses



5,540

Total Employees

### EMPLOYMENT



54.8%

White Collar



23.9%

Blue Collar



21.4%

Services

5.9%

Unemployment Rate

### INCOME



\$47,658

Median Household Income



\$26,849

Per Capita Income



\$48,137

Median Net Worth

### 2023 Households by income (Esri)

The largest group: \$50,000 - \$74,999 (22.8%)

The smallest group: \$200,000+ (0.6%)

Indicator ▲	Value	Diff	
<\$15,000	13.4%	+0.2%	
\$15,000 - \$24,999	10.3%	+1.6%	
\$25,000 - \$34,999	10.7%	+1.6%	
\$35,000 - \$49,999	17.6%	+5.0%	
\$50,000 - \$74,999	22.8%	+5.8%	
\$75,000 - \$99,999	12.6%	+0.2%	
\$100,000 - \$149,999	8.6%	-5.1%	
\$150,000 - \$199,999	3.3%	-2.9%	
\$200,000+	0.6%	-6.5%	

Bars show deviation from Cuyahoga County

This infographic contains data provided by Esri, Esri and Data Axle. The vintage of the data is 2023, 2028.

© 2024 Esri

Joe Hauman

+1 440 591 3723

joe.hauman@naipvc.com

Noah Broadbent

+1 440 708 8578

noah.broadbent@naipvc.com

# DEMOGRAPHS

## 5 Mile Radius

### KEY FACTS

181,124

Population



2.3

Average Household Size

44.0

Median Age

\$53,009

Median Household Income

### EDUCATION

7%

No High School Diploma



31%

High School Graduate



31%

Some College



31%

Bachelor's/Grad/Pr of Degree

### BUSINESS



8,206

Total Businesses



128,196

Total Employees

### EMPLOYMENT



60.3%

White Collar



21.5%

Blue Collar



18.2%

Services

7.4%

Unemployment Rate

### INCOME



\$53,009

Median Household Income



\$37,611

Per Capita Income



\$92,651

Median Net Worth

### 2023 Households by income (Esri)

The largest group: \$50,000 - \$74,999 (18.1%)

The smallest group: \$150,000 - \$199,999 (4.6%)

Indicator ▲	Value	Diff	
<\$15,000	13.5%	+0.3%	
\$15,000 - \$24,999	9.3%	+0.6%	
\$25,000 - \$34,999	9.7%	+0.6%	
\$35,000 - \$49,999	14.4%	+1.8%	
\$50,000 - \$74,999	18.1%	+1.1%	
\$75,000 - \$99,999	11.4%	-1.0%	
\$100,000 - \$149,999	11.8%	-1.9%	
\$150,000 - \$199,999	4.6%	-1.6%	
\$200,000+	7.1%	0	

Bars show deviation from Cuyahoga County

This infographic contains data provided by Esri, Esri and Data Axle. The vintage of the data is 2023, 2028.

© 2024 Esri

Joe Hauman

+1 440 591 3723

joe.hauman@naipvc.com

Noah Broadbent

+1 440 708 8578

noah.broadbent@naipvc.com