

For Lease
Retail Space

NAIBlack



6302 N Division Street

Spokane, Washington 99208

Property Description

Space Available:

- Suite A: 1,500 SF +/-
- Suite B: 1,500 SF +/-
- Suite C: 1,500 SF +/-
- Suite D: 1,600 SF +/-
- Suite E: 6,000 SF +/-

**Can Divide to Any Desired Size

Building Size: 12,000 SF +/-

Best Retail Location in Spokane

On-Site Parking

Located on the High Traffic Corner of E Francis Ave & N Division St

Traffic Count: 41,000 ADT at E Francis Ave & N Division St

Disclaimer: Owner is a licensed Real Estate Agent



2021 Demographics

	1 Mile	2 Miles	3 Miles
Total Households	8,386	49,273	8,477
Total Population	18,909	121,815	206,852
Average HH Income	\$54,860	\$62,877	\$64,289

Lease Rate: \$27.50 SF/yr (NNN)

For more information

Dave Black, SIOR CCIM

O: 509 622 3535

dblack@naiblack.com

Jesse Clark

O: 509 622 3534

jesse.clark@naiblack.com

No warranty or representation, expression or implied, is made as to the accuracy of the information contained herein, and the same is submitted subject to errors, omissions, change or price, rental or other conditions, prior to sale, lease, financing, or withdrawal without notice, and of special listing conditions imposed by our principals no warranties or representations are made as to the condition of the property or any hazards contained therein or any to be implied.

801 W. Riverside Avenue, Suite 300
Spokane, WA 99201
509 623 1000 tel
naiblack.com

For Lease
Retail Space

NAIBlack



Option 1 - N Francis Avenue Retail Rendering



Option 2 - N Francis Avenue Retail Rendering

NAI Black respects the intellectual property rights of others. If you believe that your intellectual property rights have been violated by NAI Black or by a third party who has uploaded Content on our Site, please provide the following information to the NAI Black designated copyright agent as addressed below: a. A description of the copyrighted work or other intellectual property that you claim has been infringed; b. A specific description of where the material that you claim is infringing is located on the Site so the agent is able to locate it; c. An address, telephone number, and e-mail address where NAI Black can contact you and, if different, an e-mail address where the alleged infringing party, if not NAI Black, can contact you; d. A signed statement that you have a good-faith belief that the material use is not authorized by the copyright owner or other intellectual property rights owner, by its agent, or by law. E. A signed statement by you under penalty of perjury that the information in your notice is accurate and that you are the copyright or intellectual property owner or are authorized to act on the owner's behalf. After reviewing the complaint and determining if the complaint is valid, NAI Black will work to quickly remove the infringing material or disable access to it. Note: There are substantial penalties for false claims. NAI Black may request additional information before removing any infringing material. NAI Black may provide the alleged infringing party with your e-mail address so that that person can respond to your allegations. NAI Black has registered a designated agent with the Copyright Office pursuant to 17 U.S.C. 512(c). If you believe your copyright material is being used on this Site without permission, please notify the designated agent as follows:
By e-mail: mary@commercialnais.com | Subject Line: Copyright Concern
By mail: Commercial Brokers Association | Attn: DMCA Designated Agent | 12131 113th Ave NE Suite 101 | Kirkland, WA 98034

If e-mailing your copyright infringement notice, then NAI Black must receive the signed statement(s) mentioned above by mail, or attached to the e-mail, before we are required to take action.

For Lease
Retail Space

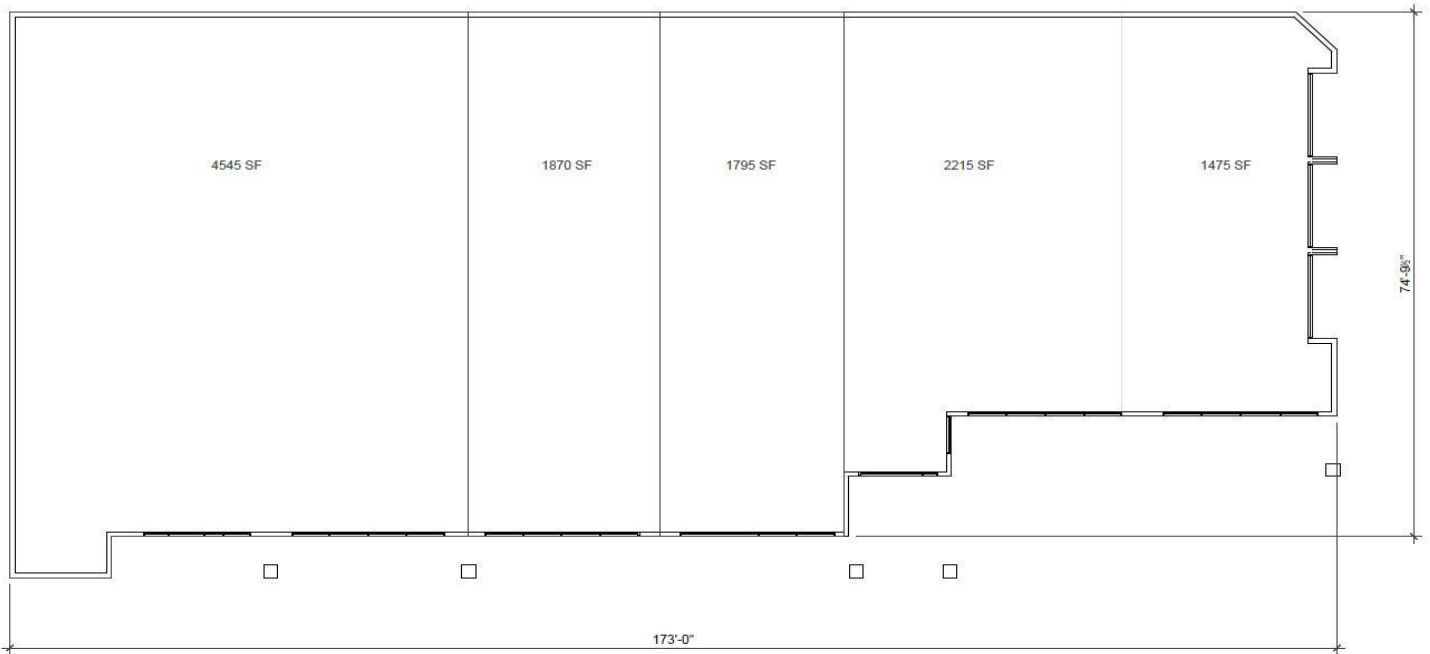

Current Floor Plan

NAI Black respects the intellectual property rights of others. If you believe that your intellectual property rights have been violated by NAI Black or by a third party who has uploaded Content on our Site, please provide the following information to the NAI Black designated copyright agent as addressed below: a. A description of the copyrighted work or other intellectual property that you claim has been infringed; b. A specific description of where the material that you claim is infringing is located on the Site so the agent is able to locate it; c. An address, telephone number, and e-mail address where NAI Black can contact you and, if different, an e-mail address where the alleged infringing party, if not NAI Black, can contact you; d. A signed statement that you have a good-faith belief that the material use is not authorized by the copyright owner or other intellectual property rights owner, by its agent, or by law. E. A signed statement by you under penalty of perjury that the information in your notice is accurate and that you are the copyright or intellectual property owner or are authorized to act on the owner's behalf. After reviewing the complaint and determining if the complaint is valid, NAI Black will work to quickly remove the infringing material or disable access to it. Note: There are substantial penalties for false claims. NAI Black may request additional information before removing any infringing material. NAI Black may provide the alleged infringing party with your e-mail address so that that person can respond to your allegations. NAI Black has registered a designated agent with the Copyright Office pursuant to 17 U.S.C. 512(c). If you believe your copyright material is being used on this Site without permission, please notify the designated agent as follows:
By e-mail: mary@commercialmls.com | Subject Line: Copyright Concern
By mail: Commercial Brokers Association! Attn: DMCA Designated Agent | 12131 113th Ave NE Suite 101 | Kirkland, WA 98034

If e-mailing your copyright infringement notice, then NAI Black must receive the signed statement(s) mentioned above by mail, or attached to the e-mail, before we are required to take action.

For Lease
Retail Space

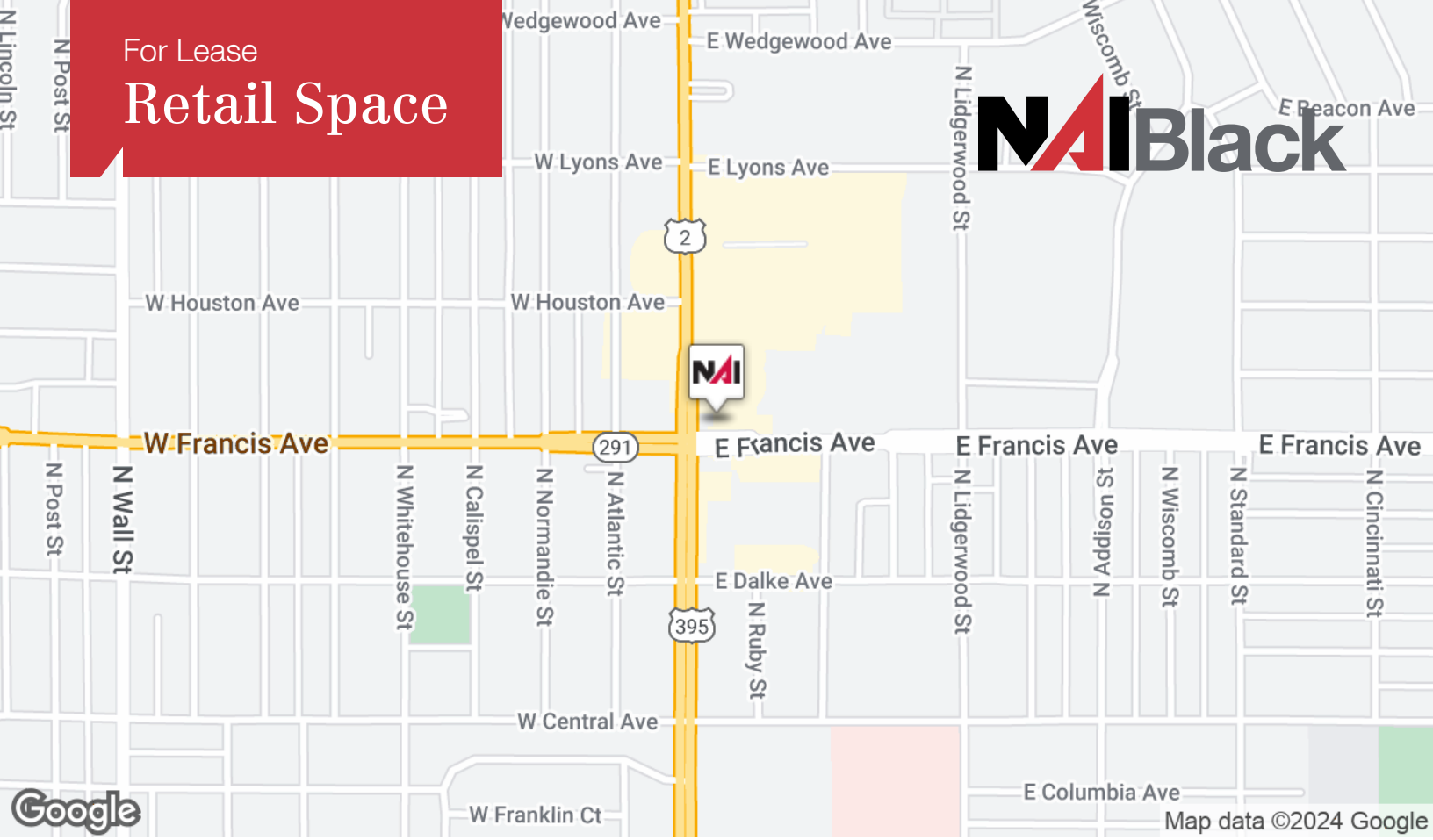

Map data ©2022 Google Imagery ©2022, Landsat / Copernicus, Maxar Technologies, U.S. Geological Survey, USDA Farm Service Agency

NAI Black respects the intellectual property rights of others. If you believe that your intellectual property rights have been violated by NAI Black or by a third party who has uploaded Content on our Site, please provide the following information to the NAI Black designated copyright agent as addressed below: a. A description of the copyrighted work or other intellectual property that you claim has been infringed; b. A specific description of where the material that you claim is infringing is located on the Site so the agent is able to locate it; c. An address, telephone number, and e-mail address where NAI Black can contact you and, if different, an e-mail address where the alleged infringing party, if not NAI Black, can contact you; d. A signed statement that you have a good-faith belief that the material use is not authorized by the copyright owner or other intellectual property rights owner, by its agent, or by law. E. A signed statement by you under penalty of perjury that the information in your notice is accurate and that you are the copyright or intellectual property owner or are authorized to act on the owner's behalf. After reviewing the complaint and determining if the complaint is valid, NAI Black will work to quickly remove the infringing material or disable access to it. Note: There are substantial penalties for false claims. NAI Black may request additional information before removing any infringing material. NAI Black may provide the alleged infringing party with your e-mail address so that that person can respond to your allegations. NAI Black has registered a designated agent with the Copyright Office pursuant to 17 U.S.C. 512(c). If you believe your copyright material is being used on this Site without permission, please notify the designated agent as follows:
By e-mail: mary@commercialnais.com | Subject Line: Copyright Concern
By mail: Commercial Brokers Association! Attn: DMCA Designated Agent | 12131 113th Ave NE Suite 101 | Kirkland, WA 98034

If e-mailing your copyright infringement notice, then NAI Black must receive the signed statement(s) mentioned above by mail, or attached to the e-mail, before we are required to take action.