



FOR LEASE LOGAN SQUARE RETAIL

2787 N Milwaukee Avenue
Chicago, IL 60647



HIGHLIGHTS

Property Type: Retail
Lease Type: NNN
Size: 2,670 Sq Ft
Zoning: B3-3
Ceiling Height: 11' 9"
Alderman: Ramirez-Rosa

SNAPSHOT



- 2,670 Sq Ft space on the corner of Milwaukee / Diversey / Kimball
- Light-filled space features floor to ceiling windows, high ceilings, ADA bathroom and mechanical room with mop sink
- High-visibility location with over 13,100 vehicles per day and situated in a dense retail corridor with heavy foot traffic
- Former AT&T Store

TRANSIT



0.2 miles to CTA
Blue Line Logan Square
Station



On CTA #56
Milwaukee and #76
Diversey Routes



0.1 miles to CTA #82
Kimball / Homan Route

FLOOR PLANS

2787 N Milwaukee Avenue, Chicago, IL 60647
Retail Floor Plans

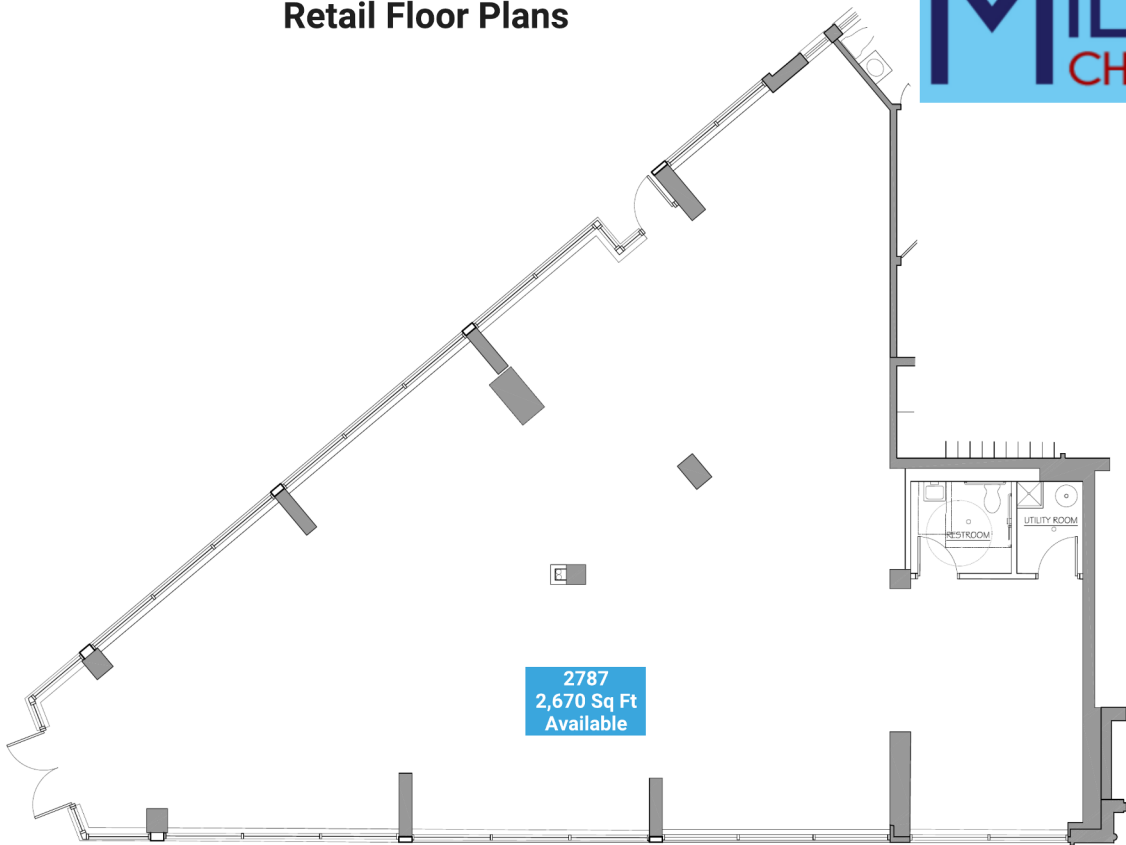

PARTIAL 1ST FLOOR PLAN
SCALE: 1/4" = 1'-0"