

# 227 W. MONROE

SUBLEASE

## CLASS A PROFESSIONAL SERVICES SPACE WITH GREAT EXISTING CONDITIONS

Delivery: Immediate

Asking Rate: Negotiable

Term: May 31, 2028



Fully amenitized building including premium fitness center, conferencing center, bike room, zo studio, and multiple tenant-only lounges



Large food hall with a variety of cuisines and additional food and coffee operators in the building including Starbucks, Sopraffina, Rustle & Roux, and Hannah's Bretzel



Close proximity to Ogilve, Union Station, and CTA train and bus lines



Stationed security at all entrance points of the building

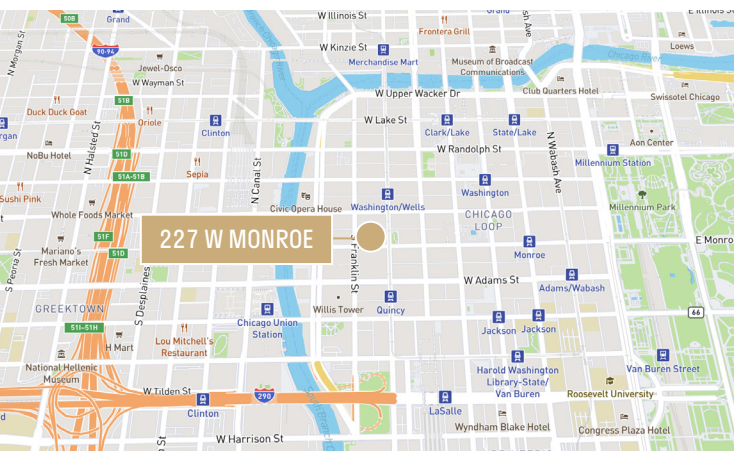

Exclusive Agent

**BA** BRADFORD ALLEN

BEN AZULAY  
312 994 5774  
BAZULAY@BRADFORDALLEN.COM

NATHAN MEISNER  
312 994 2357  
NMEISNER@BRADFORDALLEN.COM

LAURYN SUSSMAN  
312 994 5704  
LSUSSMAN@BRADFORDALLEN.COM

The information contained herein was obtained from sources deemed reliable; however, it has not been independently verified, and no warranties, express or implied, are made as to the accuracy thereof. Any interested parties should have the experts of their choice inspect the property and verify all information.

# 227 W. MONROE

SUITE 500 | 13,947 RSF

17

Private Offices

3

Conference Rooms

60

Workstations

3

Small Call Rooms

## INCREDIBLY EFFICIENT FLOORPLAN

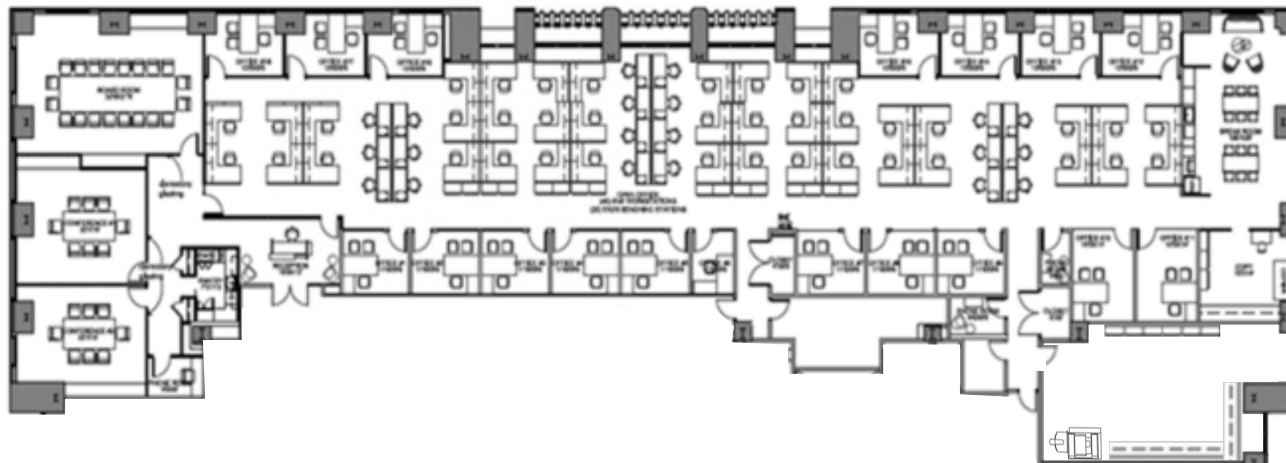

**Great existing conditions** with mix of private offices and workstations

Furniture in **high-quality condition**

Elevator ID with **inviting reception area**

**Multiple conference rooms** and smaller **storage rooms** plus dedicated storage & **HVAC room**

Large kitchen & **café breakroom area**



Exclusive Agent

**BA** BRADFORD  
ALLEN

For more information or to arrange a tour, please contact:

BEN AZULAY

312 994 5774

BAZULAY@BRADFORDALLEN.COM

NATHAN MEISNER

312 994 2357

NMEISNER@BRADFORDALLEN.COM

LAURYN SUSSMAN

312 994 5704

LSUSSMAN@BRADFORDALLEN.COM