



Specifications

Property Highlights

- Total Bldg Size: ±154,527 SF
- Total Office: ±31,492 SF
- Available Space: ±2,184 SF (Suite E)
- Elevator: One (1st – 2nd Floors)
- Parking: 116 Spaces at 3.6 / 1,000 SF

Comments

- Newly Renovated
- Institutional Ownership
- Professional Management
- Restaurants Within Walking Distance and Surrounding Areas

Accessibility

- 0.5 MI to US Highway 1 & 9
- 1 MI to I-95, Exit 13A
- 3.9 MI to Newark Liberty Int'l Airport
- 6.1 MI to Ports Newark & Elizabeth

For additional property information or to arrange an inspection, please contact the exclusive brokers:

Jason M. Crimmins, CCIM, SIOR
President
 973.568.6611
 jmcrimmins@blauberg.com

Alessandro (Alex) Conte, CCIM, SIOR
Executive Vice President
 973.432.1648
 acont@blauberg.com

Peter J. Murano, Jr., SIOR
Managing Executive Director
 973.214.9375
 pjmurano@blauberg.com

FOR LEASE | 620 DIVISION STREET | ELIZABETH, NJ



For additional property information or to arrange an inspection, please contact the exclusive brokers:

Jason M. Crimmins, CCIM, SIOR
President
973.568.6611
jmcrimmins@blauberg.com

Alessandro (Alex) Conte, CCIM, SIOR
Executive Vice President
973.432.1648
aconte@blauberg.com

Peter J. Murano, Jr., SIOR
Managing Executive Director
973.214.9375
pjmurano@blauberg.com

The information contained herein has been obtained from sources considered to be reliable, but no guarantee of its accuracy is made by this company. In addition, no representation is made respecting zoning, condition of title, dimensions, or any matters of a legal or environmental nature. Such matters should be referred to legal counsel for determination. Terms and conditions are subject to change without prior notice. Subject to errors and omissions.



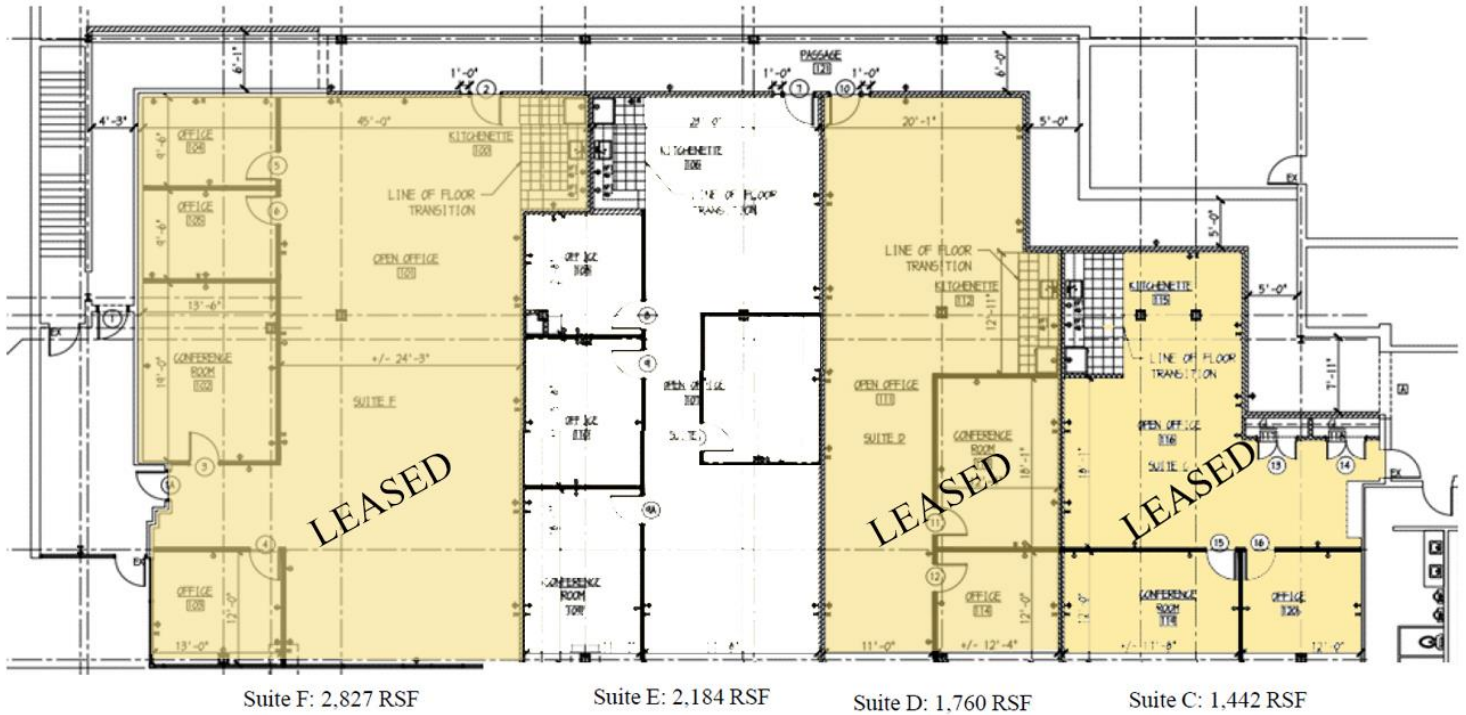

A PART GROUND FLOOR PLAN
 A-100 SCALE: 1/8" = 1'-0"



SUITE E - ±2,184 SF

For additional property information or to arrange an inspection, please contact the exclusive brokers:

Jason M. Crimmins, CCIM, SIOR
 President
 973.568.6611
 jmcrimmins@blauberg.com

Alessandro (Alex) Conte, CCIM, SIOR
 Executive Vice President
 973.432.1648
 acont@blauberg.com

Peter J. Murano, Jr., SIOR
 Managing Executive Director
 973.214.9375
 pjmurano@blauberg.com

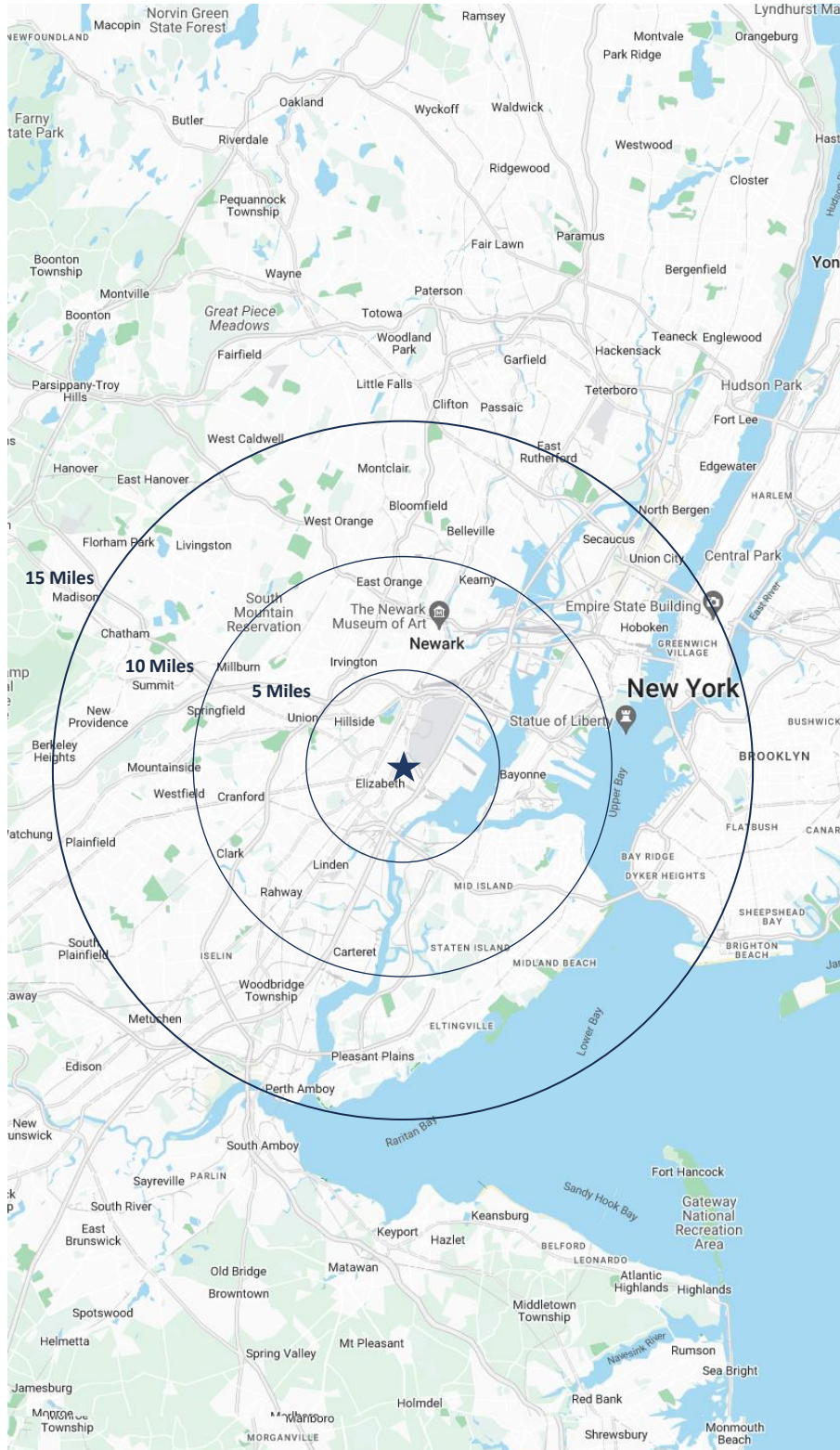

5 MILES

- Total Population: 692,515
- Households: 244,273
- Median Household Income: \$73,471
- Average Household Size: 2.8
- Transportation to Work: 341,971
- Labor Force: 546,502

10 MILES

- Total Population: 2.44M
- Households: 907,435
- Median Household Income: \$98,747
- Average Household Size: 2.6
- Transportation to Work: 1.24M
- Labor Force: 1.95M

15 MILES

- Total Population: 6.79M
- Households: 2.7M
- Median Household Income: \$107,382
- Average Household Size: 2.5
- Transportation to Work: 3.52M
- Labor Force: 5.52M

For additional property information or to arrange an inspection, please contact the exclusive brokers:

Jason M. Crimmins, CCIM, SIOR
President
 973.568.6611
 jmcrimmins@blauberg.com

Alessandro (Alex) Conte, CCIM, SIOR
Executive Vice President
 973.432.1648
 acont@blauberg.com

Peter J. Murano, Jr., SIOR
Managing Executive Director
 973.214.9375
 pjmurano@blauberg.com

The information contained herein has been obtained from sources considered to be reliable, but no guarantee of its accuracy is made by this company. In addition, no representation is made respecting zoning, condition of title, dimensions, or any matters of a legal or environmental nature. Such matters should be referred to legal counsel for determination. Terms and conditions are subject to change without prior notice. Subject to errors and omissions.

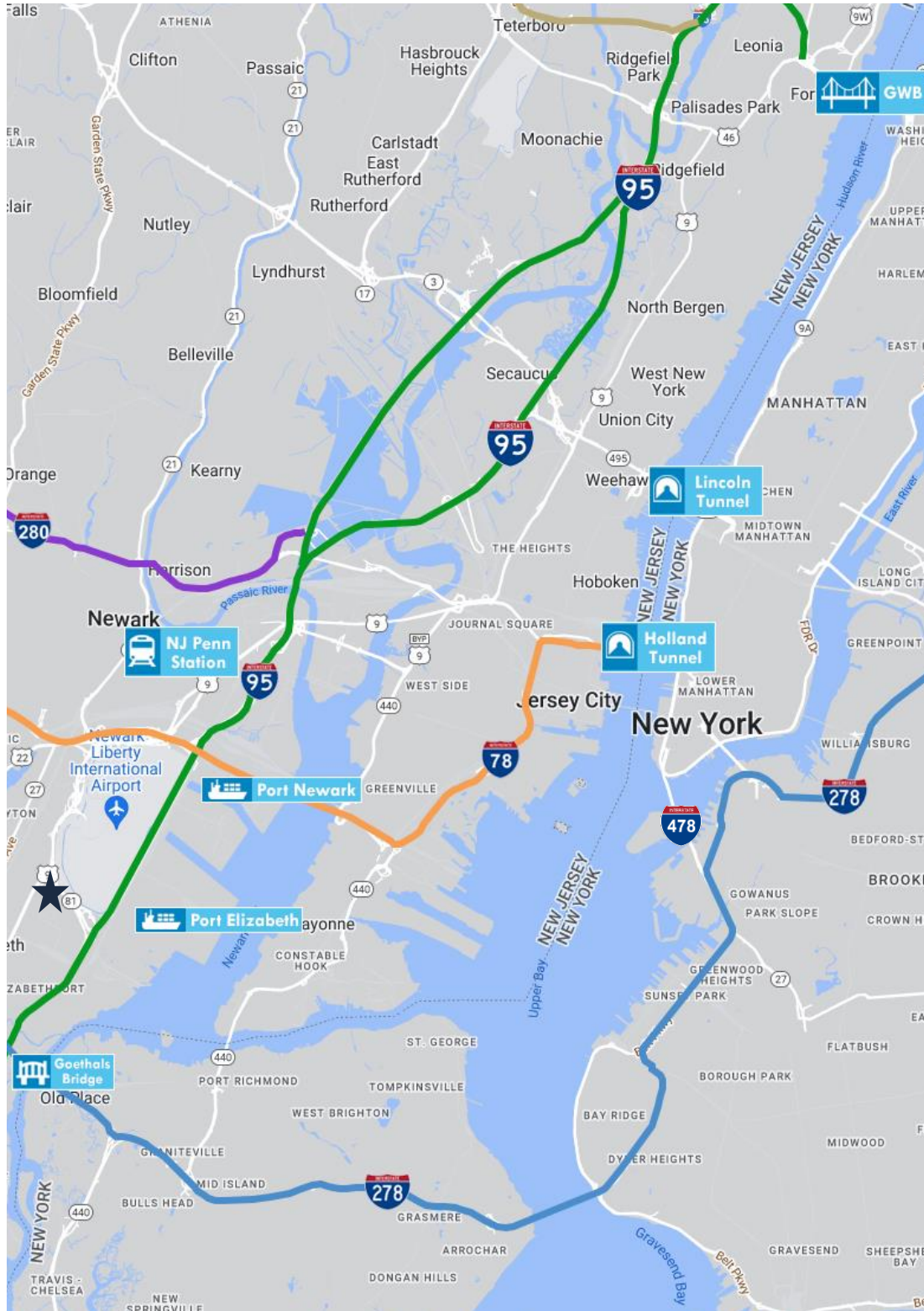

ACCESSIBILITY



0.5 MI
US Hwy 1 & 9



1.0 MI
I-95 Exit 13A



3.4 MI
I-278



3.9 MI
Newark Airport



5.5 MI
Penn Station



6.1 MI
Ports Newark
And Elizabeth



9.2 MI
Goethals Bridge



11.1 MI
I-78



12.3 MI
Holland Tunnel



15.5 MI
Lincoln Tunnel

For additional property information or to arrange an inspection, please contact the exclusive brokers:

Jason M. Crimmins, CCIM, SIOR
President
973.568.6611
jmcrimmins@blauberg.com

Alessandro (Alex) Conte, CCIM, SIOR
Executive Vice President
973.432.1648
aconte@blauberg.com

Peter J. Murano, Jr., SIOR
Managing Executive Director
973.214.9375
pjmurano@blauberg.com