

INDUSTRIAL FOR LEASE

±32,680 ft²

DISTRIBUTION/MANUFACTURING PROPERTY

602 N Cypress St, Orange, CA



N Cypress St

Walnut Ave



Property Highlights



5 GL doors -
DH possible



6 Private offices,
conference room,
lunch room &
kitchen



±6,964 ft² of
Highly Improved
Offices



±32,680 ft²
Distribution/
Manufacturing
Facility



18' OH
Warehouse



M-2 Industrial
Zoning



Central Orange
Location



400 Amp
Electrical



0.896 Acres
Lot Size

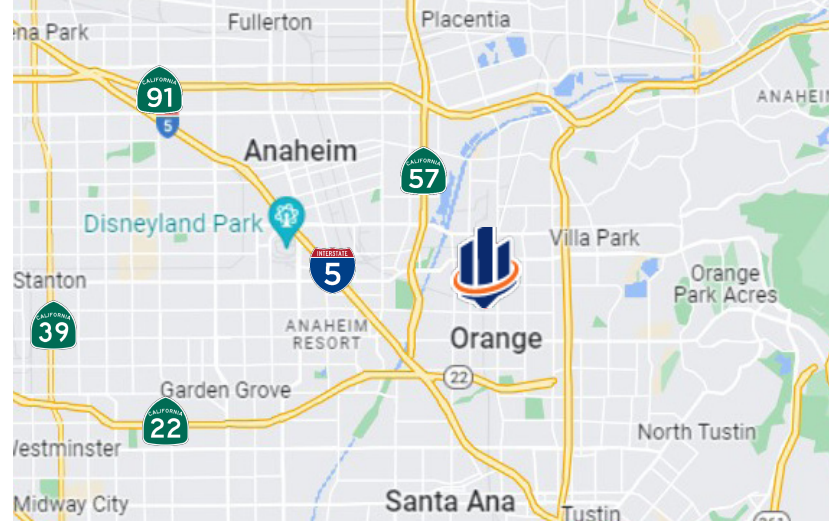

We have obtained the information above from sources we believe to be reliable. However, we have not verified its accuracy and make no guarantee, warranty or representation about it. It is submitted subject to the possibility of errors, omissions, change of price, rental or other conditions, prior sale, lease or financing or withdrawal without notice. We include projections, opinions, assumptions or estimates for example only, and they may not represent current or future performance of the property. Floor plan not to scale.



CAMERON JONES SIOR
SVN | Vanguard
Industrial
cameron.jones@svn.com
714.240.7078 Call/Text
DRE 01770606
CorpDRE 01840569



BROCK SMITH
SVN | Vanguard
Industrial
brock.smith@svn.com
949.338.1292 Call/Text
DRE 02087199



Collective Strength. Accelerated Growth.

**INDUSTRIAL
FOR LEASE**

±32,680 FT²

DISTRIBUTION/MANUFACTURING PROPERTY

602 N Cypress St, Orange, CA

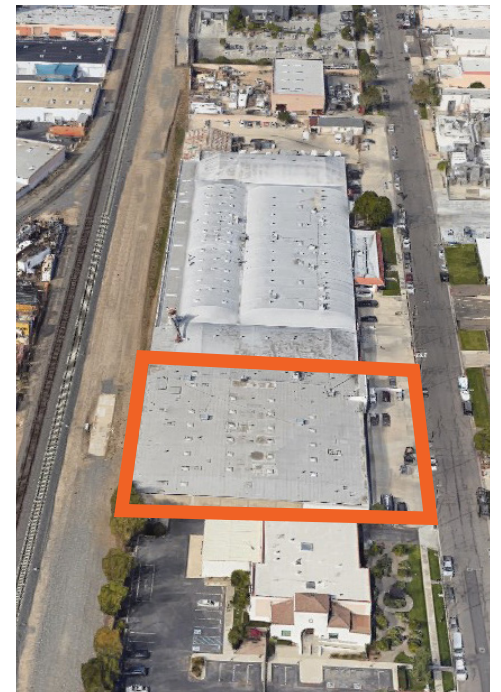

We have obtained the information above from sources we believe to be reliable. However, we have not verified its accuracy and make no guarantee, warranty or representation about it. It is submitted subject to the possibility of errors, omissions, change of price, rental or other conditions, prior sale, lease or financing or withdrawal without notice. We include projections, opinions, assumptions or estimates for example only, and they may not represent current or future performance of the property. Floor plan not to scale.



**INDUSTRIAL
FOR LEASE**

±32,680 FT²

DISTRIBUTION/MANUFACTURING PROPERTY

602 N Cypress St, Orange, CA



We have obtained the information above from sources we believe to be reliable. However, we have not verified its accuracy and make no guarantee, warranty or representation about it. It is submitted subject to the possibility of errors, omissions, change of price, rental or other conditions, prior sale, lease or financing or withdrawal without notice. We include projections, opinions, assumptions or estimates for example only, and they may not represent current or future performance of the property. Floor plan not to scale.

**INDUSTRIAL
FOR LEASE**

±32,680 FT²

DISTRIBUTION/MANUFACTURING PROPERTY

602 N Cypress St, Orange, CA



We have obtained the information above from sources we believe to be reliable. However, we have not verified its accuracy and make no guarantee, warranty or representation about it. It is submitted subject to the possibility of errors, omissions, change of price, rental or other conditions, prior sale, lease or financing or withdrawal without notice. We include projections, opinions, assumptions or estimates for example only, and they may not represent current or future performance of the property. Floor plan not to scale.



INDUSTRIAL FOR LEASE

±32,680 FT²

DISTRIBUTION/MANUFACTURING PROPERTY

602 N Cypress St, Orange, CA



Floor Plan

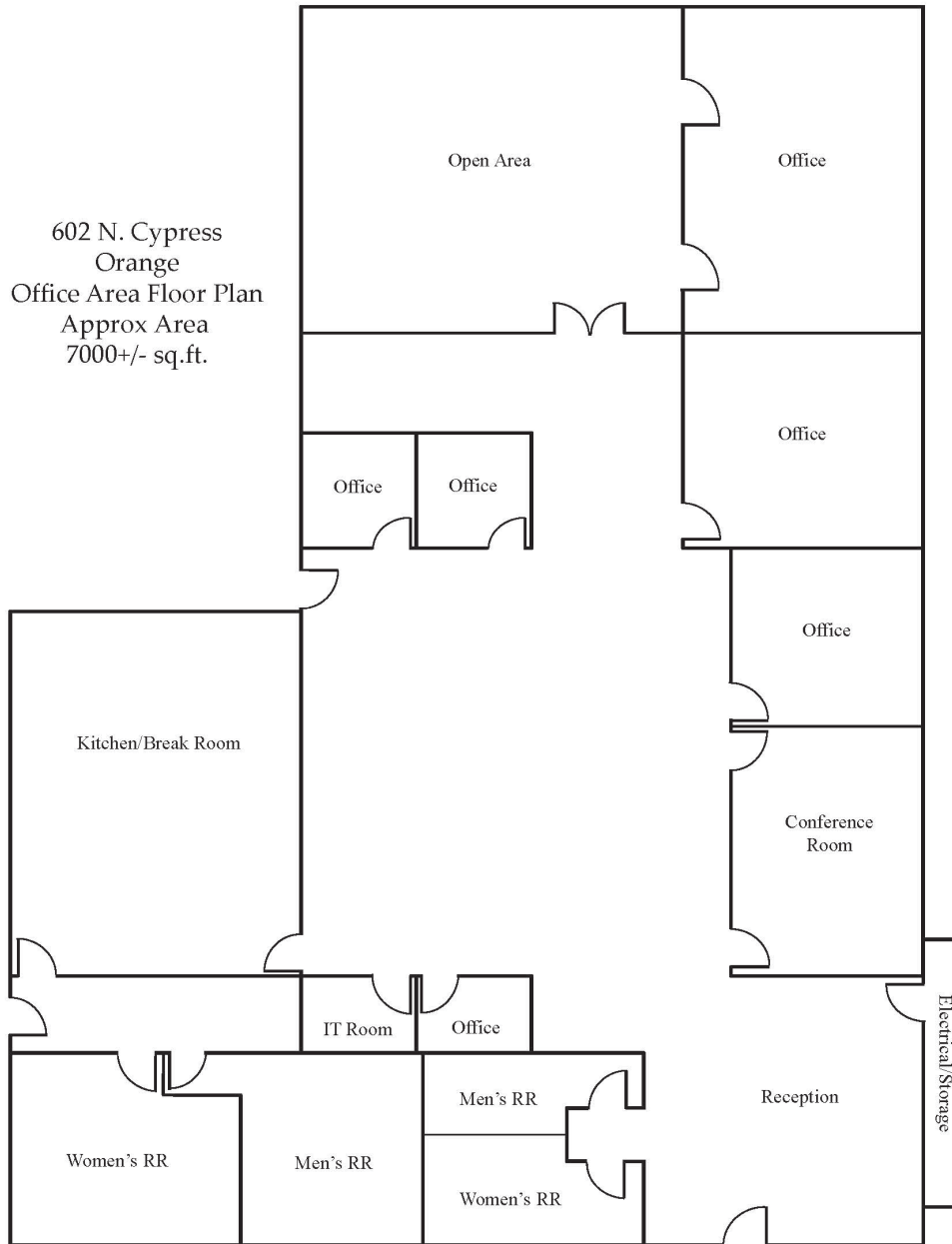

* Not to Scale

We have obtained the information above from sources we believe to be reliable. However, we have not verified its accuracy and make no guarantee, warranty or representation about it. It is submitted subject to the possibility of errors, omissions, change of price, rental or other conditions, prior sale, lease or financing or withdrawal without notice. We include projections, opinions, assumptions or estimates for example only, and they may not represent current or future performance of the property. Floor plan not to scale.



CAMERON JONES SIOR
SVN | Vanguard
Industrial
cameron.jones@svn.com
714.240.7078 Call/Text
DRE 01770606
CorpDRE 01840569



BROCK SMITH
SVN | Vanguard
Industrial
brock.smith@svn.com
949.338.1292 Call/Text
DRE 02087199



Collective Strength. Accelerated Growth.