



2901 W. 11th Street

Sioux Falls, SD 57104

PROPERTY HIGHLIGHTS

- 2 level building
- Office and storage: 21,866 sq. ft.
- Warehouse: 2,074 sq. ft.
- Lot size: 1.29 acres (56,164 sq. ft.)
- Year built: 1980
- Paved parking lot with 52 spaces
- 1 loading dock
- Potential two tenant set up
- 2 reception areas, 2 conference rooms, 2 breakrooms, 7 bathrooms
- Elevator
- Warehouse with a dock door and double doors
- Sale includes tower lease income of \$42,000+ per year
- Seller would consider a short-term leaseback

LOCATION DESCRIPTION

Located west of I-29 and just north of 12th Street. Area neighbors include Wells Fargo Bank, Subway, Harbor Freight Tools, Stan Houston Equipment Co, Billion Auto, Walgreens, USS South Dakota Battleship Memorial

Sale Price	\$2,650,000
2021 Real Estate Taxes	\$29,681.36
Tower Lease Income	\$42,000+ PER YEAR
Building Size	23,950 SF



STACEY SIEVERDING
Broker Associate
ssieverding@naisiouxfalls.com
605.728.1390



TROY FAWCETT, CCIM, SIOR
President/Principal Broker
tfawcett@naisiouxfalls.com
605.444.7120

2500 W. 49th St. Suite 100
Sioux Falls, SD 57105
605.357.7100
naisiouxfalls.com

PHOTOS

2901 W. 11TH STREET

FOR SALE

Office/Warehouse Building



PHOTOS

2901 W. 11TH STREET

FOR SALE

Office/Warehouse Building



FLOOR PLANS

2901 W. 11TH STREET

FOR SALE
Office/Warehouse Building

VIDEO TOUR

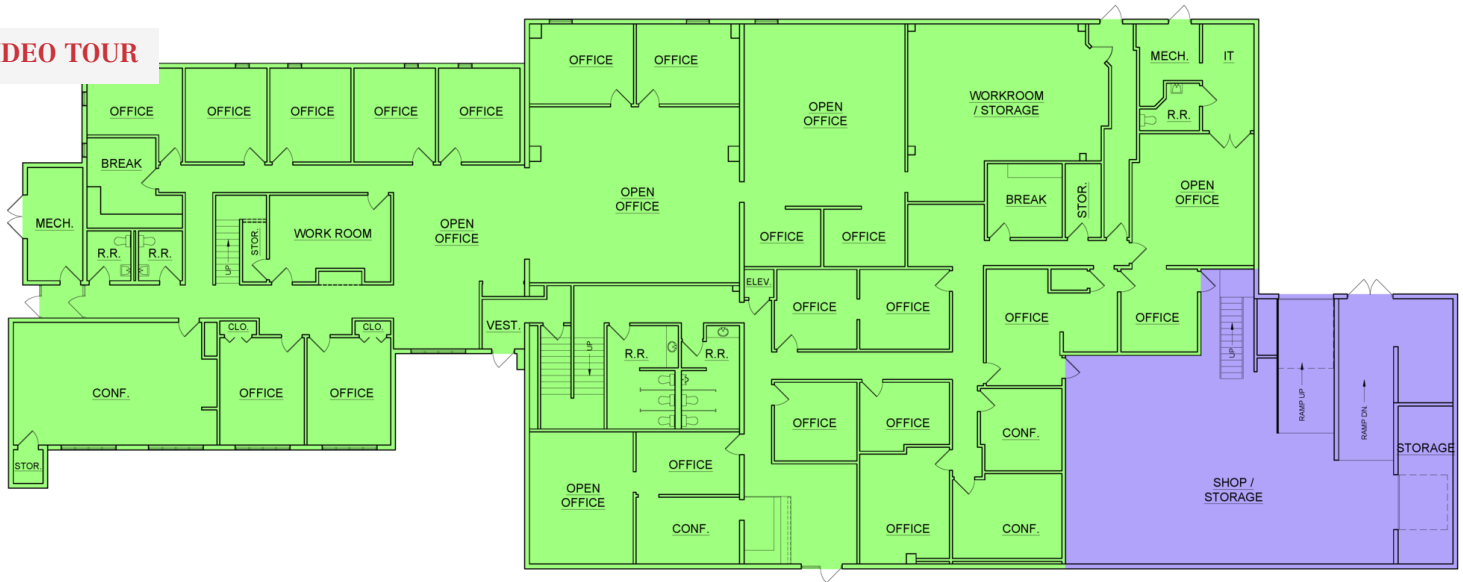

1 MAIN LEVEL PLAN

SCALE: 1/8" = 1'-0" (22x34)
SCALE: 1/16" = 1'-0" (11x17)

MAIN LEVEL GROSS:
13,511 SQFT

OFFICE SPACE:
11,437 SQFT

WAREHOUSE SPACE:
2,074 SQFT

ELMEN ENTERPRISE

2901 W. 11th Street
SIOUX FALLS, SD

Dakota
DRAFTING & DESIGN

2700 WEST 3RD
SUITE 2
SIOUX FALLS, SD
PHONE: 605-666-
WWW.Dakota3D

VIDEO TOUR



1 UPPER LEVEL PLAN

SCALE: 1/8" = 1'-0" (22x34)
SCALE: 1/16" = 1'-0" (11x17)

UPPER LEVEL GROSS:
10,439 SQFT

ELMEN ENTERPRISE

2901 W. 11th Street
SIOUX FALLS, SD

NA Sioux Falls

2500 W. 49th St. Suite 100
Sioux Falls, SD 57105
605.357.7100
naisiouxfalls.com

AERIAL

2901 W. 11TH STREET

FOR SALE

Office/Warehouse Building



NAI Sioux Falls

2500 W. 49th St. Suite 100
Sioux Falls, SD 57105
605.357.7100
naisiouxfalls.com