

# LAND / LEASE / BUILD TO SUIT FOR SALE SUNSET COMMONS - COMMERCIAL

Seaside Road & Chatham Drive, Ocean Isle Beach, NC 28469



COMMERCIAL REAL ESTATE SERVICES  
RALEIGH DURHAM



## PROPERTY DESCRIPTION

Three retail pads totaling 5.95 acres available for sale in Ocean Isle Beach, NC. Surrounded by 13 established or under development residential neighborhoods and within close proximity to Lowes Foods, Publix, Odell Williamson Municipal Airport, and the waterfront.

## PROPERTY HIGHLIGHTS

- Lots 1 & 2: PIN 2270002321 (4.04 acres)
- Lot 3: PIN 2270002322 (1.91 acres)
- Residential Property: <https://buildout.com/website/sunset-commons-residential>

## LOCATION DESCRIPTION

Sunset Commons is located at the northeast corner of Seaside Road SW and Chatham Drive NW in Ocean Isle Beach, North Carolina. The property is 32 miles from Myrtle Beach, South Carolina, and 150 miles from Downtown Raleigh.

## OFFERING SUMMARY

Sale Price:	\$150,000 / acre
Lot 1:	2.12 acres
Lot 2:	1.92 acres
Lot 3:	1.91 acres

Dan Koeller  
dkoeller@lee-associates.com  
O: 919.591.2274  
C: 919.349.7857

Cole Pennell  
cpennell@lee-associates.com  
O: 919.591.2270  
C: 704.975.0164

All information furnished regarding property for sale, rental or financing is from sources deemed reliable, but no warranty or representation is made to the accuracy thereof and same is submitted to errors, omissions, change of price, rental or other conditions prior to sale, lease or financing or withdrawal without notice. No liability of any kind is to be imposed on the broker herein.

# LAND / LEASE / BUILD TO SUIT FOR SALE SUNSET COMMONS - COMMERCIAL

Seaside Road & Chatham Drive, Ocean Isle Beach, NC 28469



COMMERCIAL REAL ESTATE SERVICES  
RALEIGH DURHAM

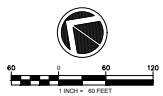
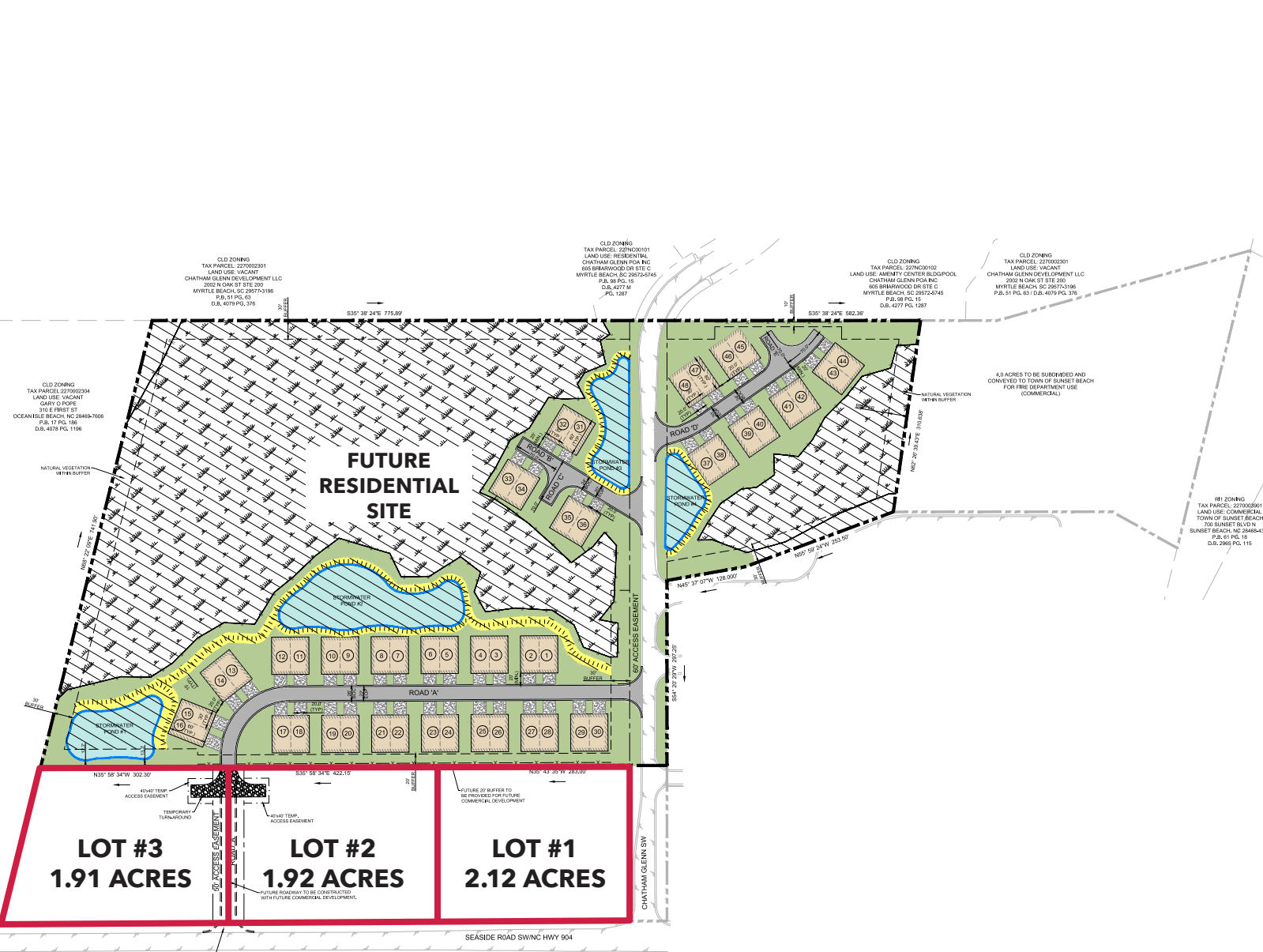

Dan Koeller  
dkoeller@lee-associates.com  
O: 919.591.2274  
C: 919.349.7857

Cole Pennell  
cpennell@lee-associates.com  
O: 919.591.2270  
C: 704.975.0164

All information furnished regarding property for sale, rental or financing is from sources deemed reliable, but no warranty or representation is made to the accuracy thereof and same is submitted to errors, omissions, change of price, rental or other conditions prior to sale, lease or financing or withdrawal without notice. No liability of any kind is to be imposed on the broker herein.





# LAND / LEASE / BUILD TO SUIT FOR SALE SUNSET COMMONS - COMMERCIAL

Seaside Road & Chatham Drive, Ocean Isle Beach, NC 28469



COMMERCIAL REAL ESTATE SERVICES  
RALEIGH DURHAM



Dan Koeller  
dkoeller@lee-associates.com  
O: 919.591.2274  
C: 919.349.7857

Cole Pennell  
cpennell@lee-associates.com  
O: 919.591.2270  
C: 704.975.0164

All information furnished regarding property for sale, rental or financing is from sources deemed reliable, but no warranty or representation is made to the accuracy thereof and same is submitted to errors, omissions, change of price, rental or other conditions prior to sale, lease or financing or withdrawal without notice. No liability of any kind is to be imposed on the broker herein.



# LAND / LEASE / BUILD TO SUIT FOR SALE SUNSET COMMONS - COMMERCIAL

Seaside Road & Chatham Drive, Ocean Isle Beach, NC 28469



COMMERCIAL REAL ESTATE SERVICES  
RALEIGH DURHAM

MYRTLE BEACH  
WILMINGTON  
RALEIGH

32 MILES  
46 MILES  
155 MILES



Dan Koeller  
dkoeller@lee-associates.com  
O: 919.591.2274  
C: 919.349.7857

Cole Pennell  
cpennell@lee-associates.com  
O: 919.591.2270  
C: 704.975.0164

All information furnished regarding property for sale, rental or financing is from sources deemed reliable, but no warranty or representation is made to the accuracy thereof and same is submitted to errors, omissions, change of price, rental or other conditions prior to sale, lease or financing or withdrawal without notice. No liability of any kind is to be imposed on the broker herein.



# LAND / LEASE / BUILD TO SUIT FOR SALE SUNSET COMMONS - COMMERCIAL

Seaside Road & Chatham Drive, Ocean Isle Beach, NC 28469

## People

The total population of Brunswick County is 146,064. The median age is 54.69

**146,064**

Total Population

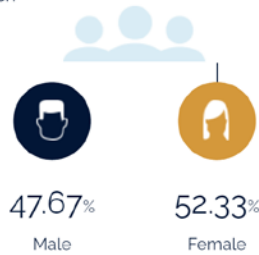

### Age Distribution

2021 2020 2019 2018 2017

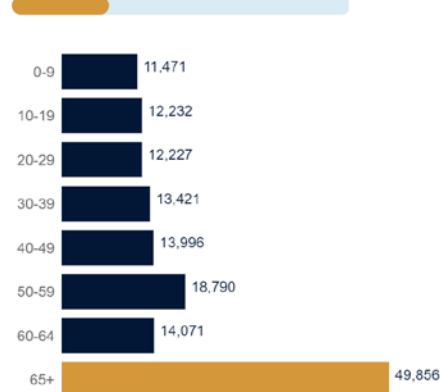

### Median Age

**55**

### Population Growth (in thousands)

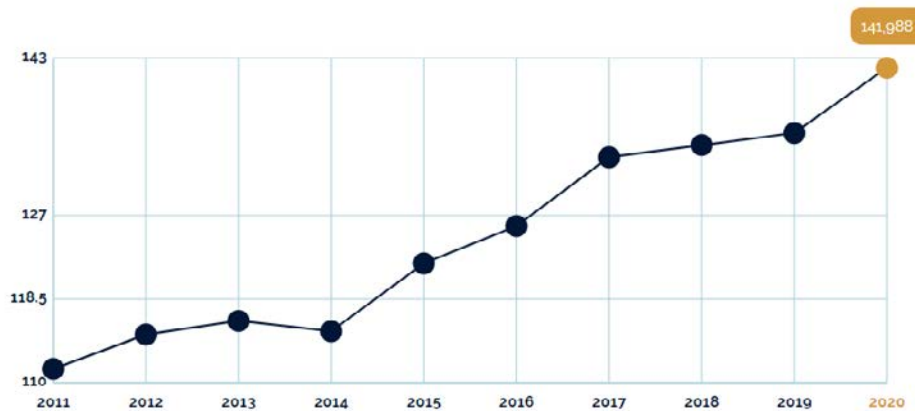

## Educational Attainment

42.45% of the population in Brunswick County have an Associate's degree or higher. 92.01% have a high school degree or higher.

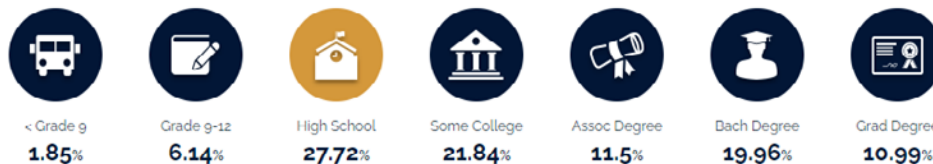

Dan Koeller  
dkoeller@lee-associates.com  
O: 919.591.2274  
C: 919.349.7857

Cole Pennell  
cpennell@lee-associates.com  
O: 919.591.2270  
C: 704.975.0164

All information furnished regarding property for sale, rental or financing is from sources deemed reliable, but no warranty or representation is made to the accuracy thereof and same is submitted to errors, omissions, change of price, rental or other conditions prior to sale, lease or financing or withdrawal without notice. No liability of any kind is to be imposed on the broker herein.