866 East 29th Street

FLATBUSH
BROOKLYN, NEW YORK



NEWMARK

866 EAST 29TH STREET

Property Details

Location

West block between Avenue I and Brooklyn College

Approximate Size

Ground Floor 16,000 SF

Frontage

160 FT on East 29th Street

Ceiling Height

12- 20 FT

Term

Negotiable

Possession

Arranged

Site Status

Currently JCCA Office

Comments

Column free single story school, medical or community facility space with existing infrastructure

Currently use group 6 with 120 person occupancy

Additional 36,039 RSF of office in adjacent building

Ability to lease a combined 52,039 RSF

Ground Floor

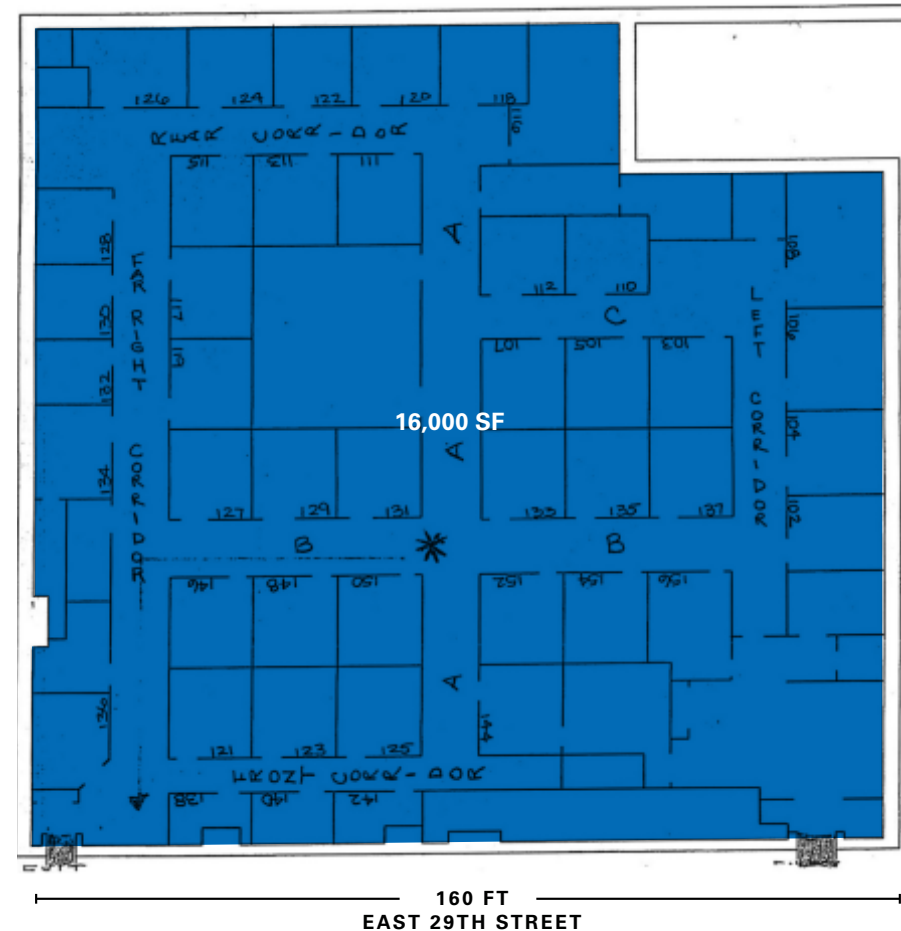

CONTACT

Aric Trakhtenberg

t 212-916-3386

aric.trakhtenberg@nrmk.com

Marc Shapes

t 212-326-8678

mshapes@savills.us

nrmk.com

866 EAST 29TH STREET

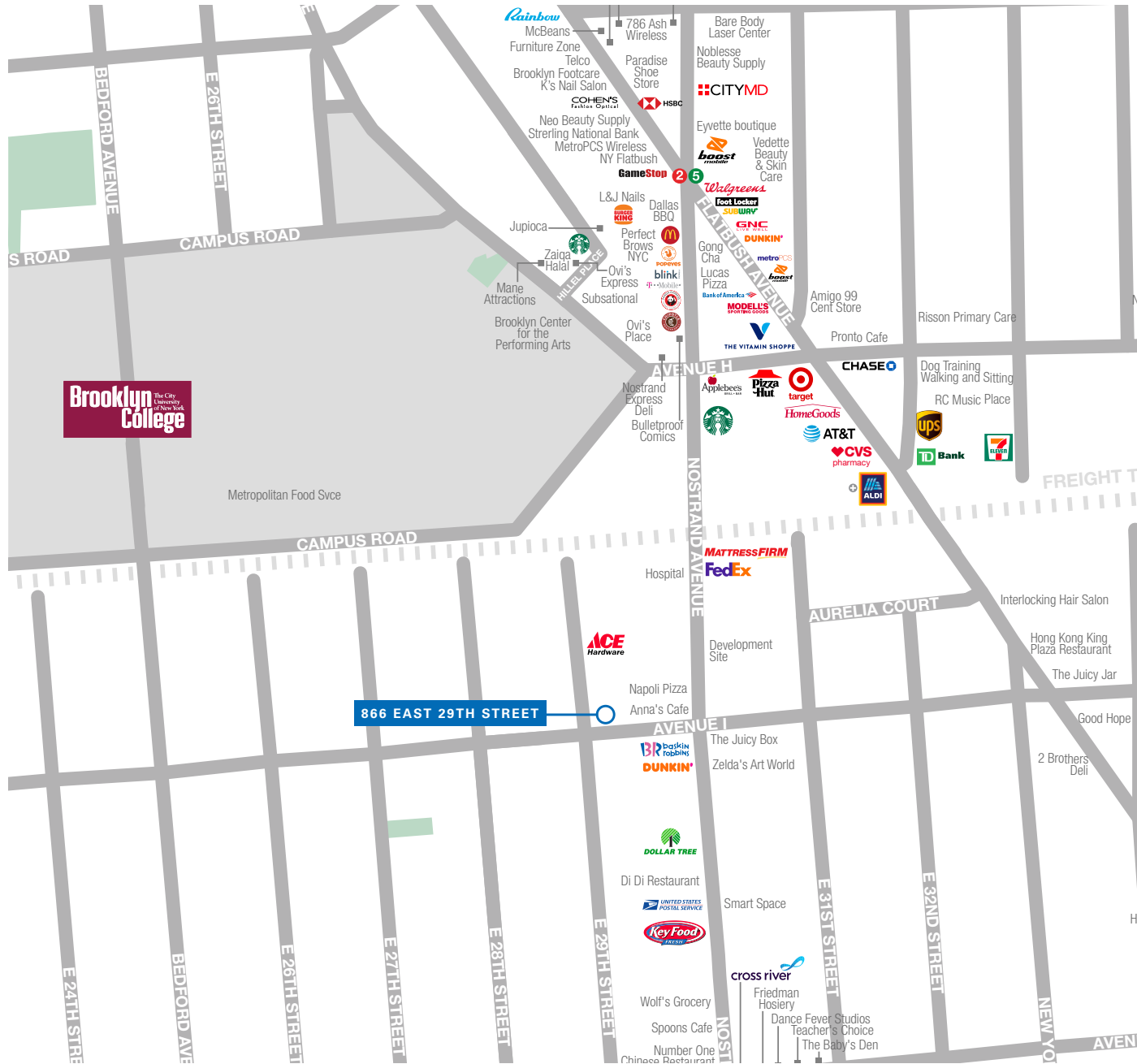

CONTACT

Aric Trakhtenberg
 t 212-916-3386
 aric.trakhtenberg@nmrk.com

Marc Shapes
 t 212-326-8678
 mshapes@savills.us

nmrk.com

+ COMING SOON