



FOR SUBLEASE

507 Plum Street

Syracuse, New York 13204



23,816± RSF Class A Office Space (Sublet)

Property Highlights

- Franklin Square location at below market rent
- Full floor with reduced loss factor
- Free on-site parking (5/1,000 SF) – some reserved
- Exterior signage
- Open floor plan with Executive Offices for 100 employees
- Multiple Conference Rooms, Board Room (for 20)
- Includes all Class A office furnishings
- Large Lunchroom to service employees
- On-site Exercise Room and shower
- Space Offering includes a roof top Gas Generator
- Flexible lease term (Sublease or Fixed Term)
- Near the Central Business District and Destiny USA
- Easily accessible location near Interstate 81, Route 690 and NYS Thruway



For more information, please contact:

Michael Kalet
Associate Real Estate Broker
+1 315.445.8534
mkalet@pyramidbrokerage.com

5845 Widewaters Pkwy, Suite 200
East Syracuse, New York 13057
phone: +1 315.445.1030
pyramidbrokerage.com



Tenant Reception

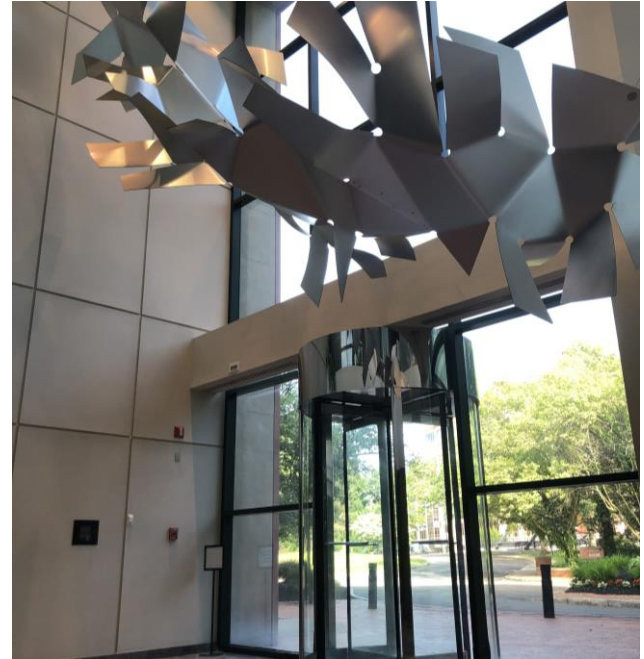

Building Primary Entry



Corporate Board Room

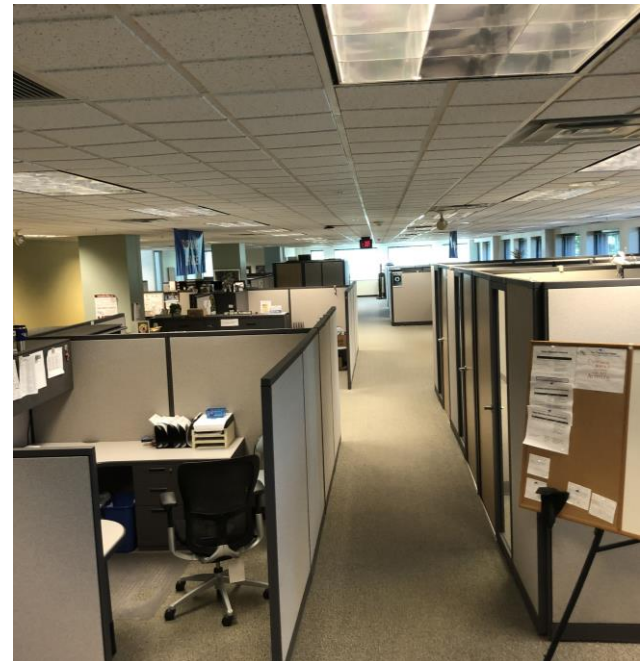

Bull Pen for 88 Employees (some open/some private)



Cafeteria Kitchen



Private Executive Office



Full-Service Cafeteria

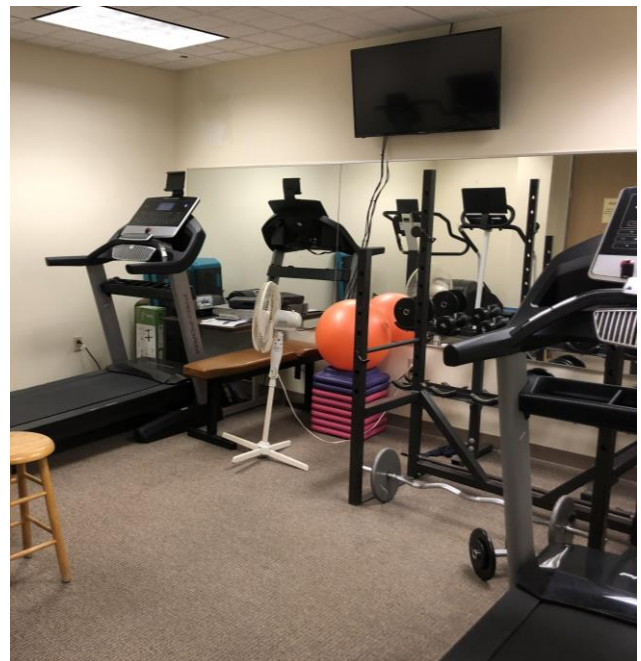

Fitness Room (w/ Shower)

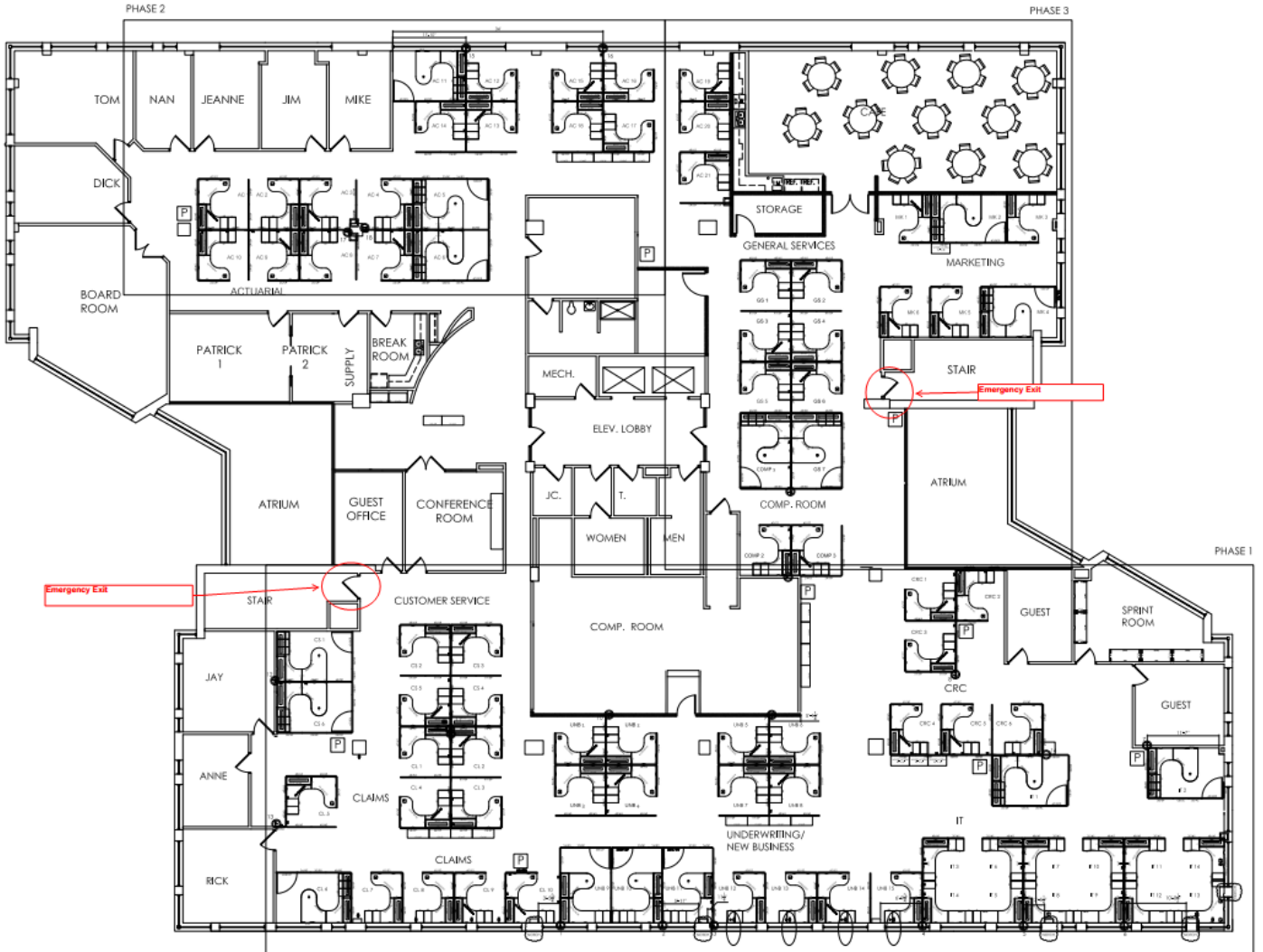

Floor Plan

[360°](#) Click to view Virtual Walkthrough

FOR SUBLEASE

507 Plum Street

Syracuse, New York 13204



Approximate plot lines subject to verification of survey.

