

CORNER TRAFFIC LIGHT PARCEL

2516 E McMillan Street @ Victory Parkway, Cincinnati, OH 44206



John Thompson
johnt@lee-associates.com
D 513.588.1842

**LEE &
ASSOCIATES**
COMMERCIAL REAL ESTATE SERVICES

All information furnished regarding property for sale, rental or financing is from sources deemed reliable, but no warranty or representation is made to the accuracy thereof and same is submitted to errors, omissions, change of price, rental or other conditions prior to sale, lease or financing or withdrawal without notice. No liability of any kind is to be imposed on the broker herein.



CORNER TRAFFIC LIGHT PARCEL

2516 E McMillan Street @ Victory Parkway, Cincinnati, OH 44206

AVAILABLE: 0.388 Acre Up To 1.67 Acres Total
LEASE RATE: \$65,000 1 Year Ground Lease
Possible Build-to-Suite for Qualified Tenant

- Corner traffic light access to both Victory Parkway and McMillan Street
- Perfect for restaurant or retail including coffee, bakery, fast-casual, dry cleaners, hair salons and banks
- Very dense urban population with lots of local traffic generators from St. Ursula High School, Eden Park, Mt. Adams, hospitals, and many more
- Skyline parcel of 1.28 acres may also be available for a total of 1.67 acres
- Existing buildings to be torn down



VICTORY PKWY

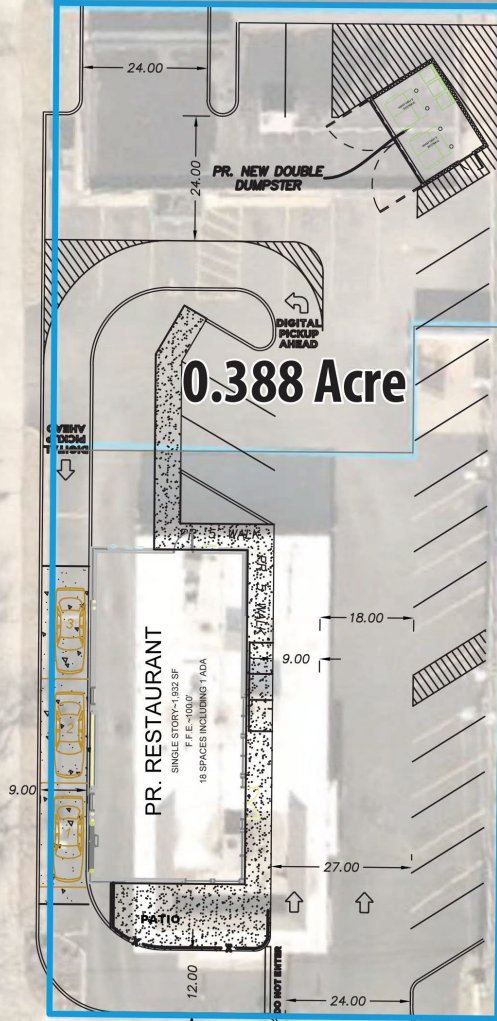

1.28 Acres



E. MCMILLAN ST.

Total: 1.67 Acres

GRAPHIC SCALE

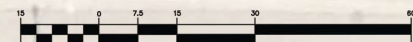

(IN FEET)
1 inch = 15 ft.

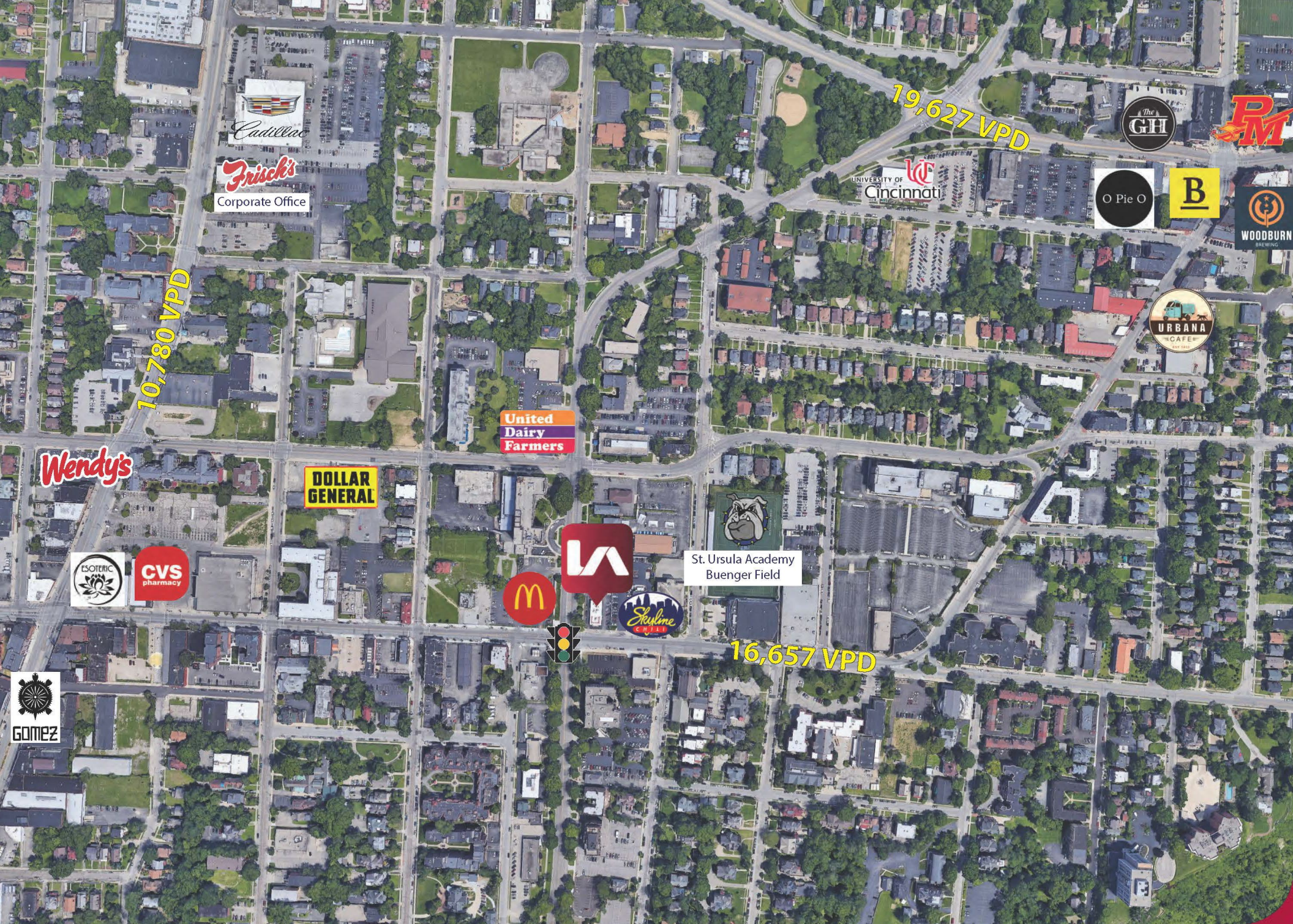

UNIVERSITY OF
Cincinnati

Cincinnati
Children's

- Opened in 1823 as the nations first teaching hospital
- Has claims to many firsts, including the development of the polio vaccine
- Cincinnati Childrens is currently ranked 3rd for best childrens hospital in the nation

UNIVERSITY OF
Cincinnati

- Founded in 1819
- 46,790+ Students Enrolled
- 414 Degree Programs
- 2020 #1 U.S. News Best Public College Co-op Internship Program

INTERSTATE
71

New Digital Futures
Complex Development

19,627 VPD

124,918 VPD

16,657 VPD

THE
41
WELLINGTON

New Apartment
Development

The Christ Hospital

| | 1 mi radius | 3 mi radius | 5 mi radius |
|--|-------------|-------------|-------------|
| Population | | | |
| 2021 Estimated Population | 14,854 | 158,406 | 306,856 |
| 2026 Projected Population | 14,794 | 158,435 | 305,180 |
| 2010 Census Population | 13,447 | 147,145 | 293,808 |
| 2000 Census Population | 15,957 | 162,502 | 327,480 |
| Projected Annual Growth 2021 to 2026 | - | - | -0.1% |
| Historical Annual Growth 2000 to 2021 | -0.3% | -0.1% | -0.3% |
| Households | | | |
| 2021 Estimated Households | 7,647 | 70,748 | 136,740 |
| 2026 Projected Households | 7,611 | 71,230 | 136,788 |
| 2010 Census Households | 6,855 | 65,520 | 129,931 |
| 2000 Census Households | 7,696 | 72,286 | 143,445 |
| Projected Annual Growth 2021 to 2026 | - | 0.1% | - |
| Historical Annual Growth 2000 to 2021 | - | -0.1% | -0.2% |
| Age | | | |
| 2021 Est. Population Under 10 Years | 11.8% | 10.3% | 12.1% |
| 2021 Est. Population 10 to 19 Years | 10.7% | 13.8% | 12.8% |
| 2021 Est. Population 20 to 29 Years | 17.5% | 21.8% | 18.9% |
| 2021 Est. Population 30 to 44 Years | 19.8% | 19.7% | 20.5% |
| 2021 Est. Population 45 to 59 Years | 17.7% | 15.7% | 16.3% |
| 2021 Est. Population 60 to 74 Years | 15.5% | 13.4% | 14.0% |
| 2021 Est. Population 75 Years or Over | 7.1% | 5.3% | 5.4% |
| 2021 Est. Median Age | 36.3 | 33.3 | 34.1 |
| Marital Status & Gender | | | |
| 2021 Est. Male Population | 47.1% | 50.6% | 49.4% |
| 2021 Est. Female Population | 52.9% | 49.4% | 50.6% |
| 2021 Est. Never Married | 53.3% | 57.2% | 51.9% |
| 2021 Est. Now Married | 24.1% | 24.1% | 27.1% |
| 2021 Est. Separated or Divorced | 17.5% | 14.1% | 16.0% |
| 2021 Est. Widowed | 5.1% | 4.6% | 4.9% |
| Income | | | |
| 2021 Est. HH Income \$200,000 or More | 7.0% | 8.1% | 6.5% |
| 2021 Est. HH Income \$150,000 to \$199,999 | 2.9% | 4.8% | 4.3% |
| 2021 Est. HH Income \$100,000 to \$149,999 | 10.1% | 10.8% | 11.2% |
| 2021 Est. HH Income \$75,000 to \$99,999 | 9.8% | 9.1% | 9.7% |
| 2021 Est. HH Income \$50,000 to \$74,999 | 15.8% | 16.1% | 17.0% |
| 2021 Est. HH Income \$35,000 to \$49,999 | 8.8% | 10.8% | 11.5% |
| 2021 Est. HH Income \$25,000 to \$34,999 | 9.0% | 9.5% | 9.8% |
| 2021 Est. HH Income \$15,000 to \$24,999 | 10.1% | 10.3% | 10.4% |
| 2021 Est. HH Income Under \$15,000 | 26.6% | 20.5% | 19.6% |
| 2021 Est. Average Household Income | \$74,641 | \$81,976 | \$77,664 |
| 2021 Est. Median Household Income | \$49,354 | \$54,244 | \$53,721 |
| 2021 Est. Per Capita Income | \$38,703 | \$37,409 | \$35,105 |
| 2021 Est. Total Businesses | 839 | 8,758 | 14,191 |
| 2021 Est. Total Employees | 12,661 | 134,605 | 217,292 |

