



LAND

FOR LEASE

±0.72-ACRE INDUSTRIAL LAND

964-978 Frelinghuysen Avenue, Newark, NJ 07114

For More Information, Contact the Exclusive Brokers

JASON M. CRIMMINS, CCIM, SIOR | *President* | jmcrimmins@blauberg.com | 973.379.6644 x122

ALESSANDRO (ALEX) CONTE, CCIM, SIOR | *Executive Vice President* | aconte@blauberg.com | 973.379.6644 x131

PETER J. MURANO, JR., SIOR | *Managing Executive Director* | pjmurano@blauberg.com | 973.379.6644 x114

MICHAEL F. SCHIPPER, SIOR | *Senior Executive Director* | mschipper@blauberg.com | 973.379.6644 x146



830 Morris Turnpike, Suite 201, Short Hills, NJ 07078

www.blauberg.com

±0.72-ACRE INDUSTRIAL LAND

964-978 Frelinghuysen Avenue, Newark, NJ 07114



LOCATION DESCRIPTION

Approx. 2 Miles to Newark Liberty International Airport

Approx. 2 Miles to NJ Turnpike, Interchange 13A

Approx. 10 Miles to New York City

OFFERING SUMMARY

Lease Rate:	\$40,000 per month (Per Acre NNN)
Available SF:	77,500 SF
Lot Size:	0.72 Acres

PROPERTY HIGHLIGHTS

- Total Acreage: ±0.72 Acres (Block 3773, Lot 7)
- Dimensions: ±208' x 150'
- Zoned: EWR
- Taxes: \$31,081 Per Annum (2022)
- Comments: Fenced-In Area

DEMOGRAPHICS	0.25 MILES	0.5 MILES	1 MILE
Total Households	823	3,400	10,448
Total Population	1,538	7,200	25,803
Average HH Income	\$34,889	\$48,976	\$59,018

For More Information, Contact the Exclusive Brokers

JASON M. CRIMMINS, CCIM, SIOR | *President* | jmcrimmins@blauberg.com | 973.379.6644 x122

ALESSANDRO (ALEX) CONTE, CCIM, SIOR | *Executive Vice President* | acont@blauberg.com | 973.379.6644 x131

PETER J. MURANO, JR., SIOR | *Managing Executive Director* | pjmurano@blauberg.com | 973.379.6644 x114

MICHAEL F. SCHIPPER, SIOR | *Senior Executive Director* | mschipper@blauberg.com | 973.379.6644 x146

830 Morris Turnpike
Suite 201
Short Hills, NJ 07078

www.blauberg.com



The information contained herein has been obtained from sources considered to be reliable, but no guarantee of its accuracy is made by this company. In addition, no representation is made respecting zoning, condition of title, dimensions, or any matters of a legal or environmental nature. Such matters should be referred to legal counsel for determination. Terms and conditions are subject to change without prior notice. Subject to errors and omissions.

±0.72-ACRE INDUSTRIAL LAND

964-978 Frelinghuysen Avenue, Newark, NJ 07114

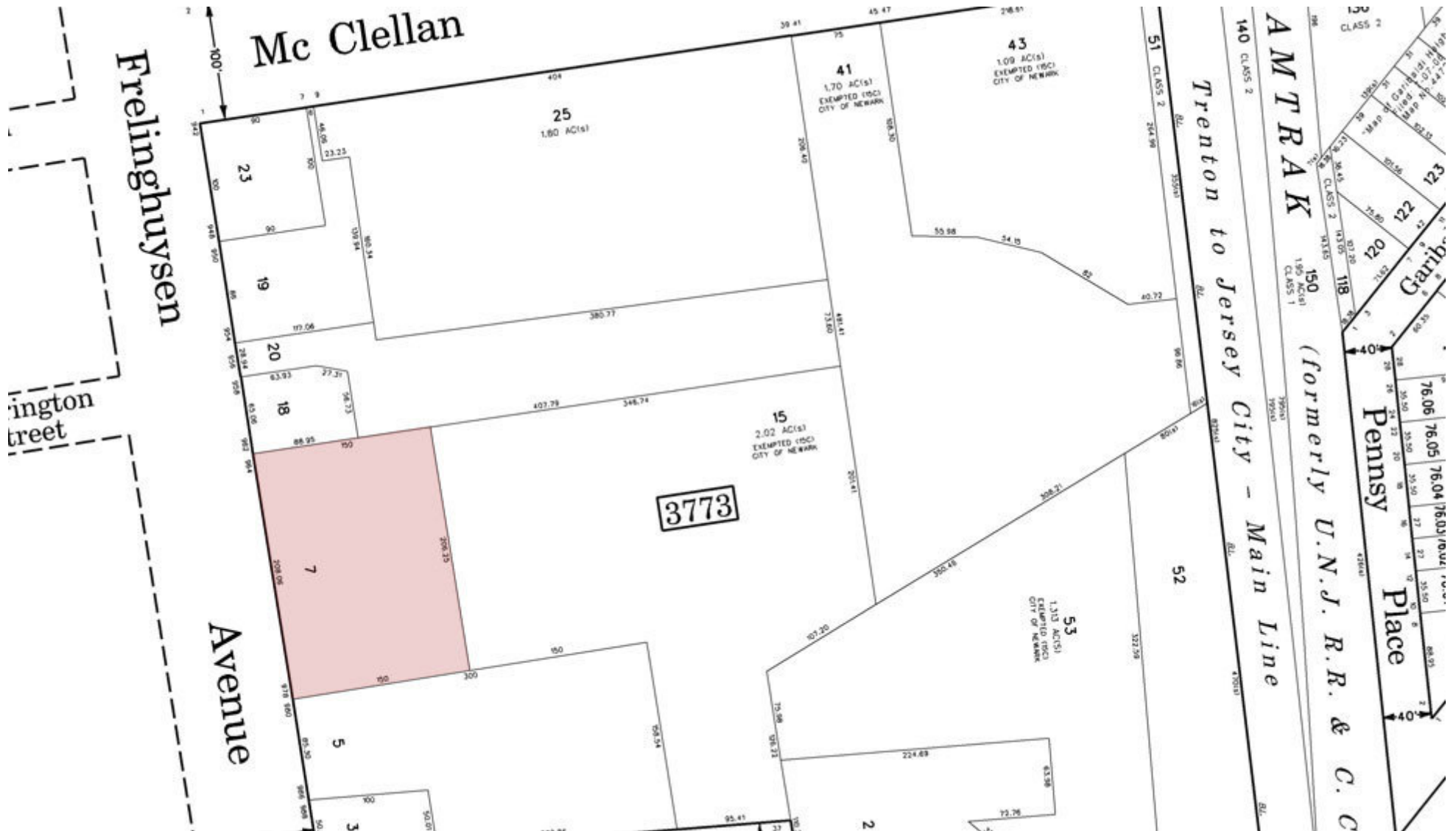

For More Information, Contact the Exclusive Brokers

- JASON M. CRIMMINS, CCIM, SIOR | *President* | jmcrimmins@blauberg.com | 973.379.6644 x122
- ALESSANDRO (ALEX) CONTE, CCIM, SIOR | *Executive Vice President* | acont@blauberg.com | 973.379.6644 x131
- PETER J. MURANO, JR., SIOR | *Managing Executive Director* | pjmurano@blauberg.com | 973.379.6644 x114
- MICHAEL F. SCHIPPER, SIOR | *Senior Executive Director* | mschipper@blauberg.com | 973.379.6644 x146

830 Morris Turnpike
Suite 201
Short Hills, NJ 07078

www.blauberg.com



The information contained herein has been obtained from sources considered to be reliable, but no guarantee of its accuracy is made by this company. In addition, no representation is made respecting zoning, condition of title, dimensions, or any matters of a legal or environmental nature. Such matters should be referred to legal counsel for determination. Terms and conditions are subject to change without prior notice. Subject to errors and omissions.

±0.72-ACRE INDUSTRIAL LAND

964-978 Frelinghuysen Avenue, Newark, NJ 07114

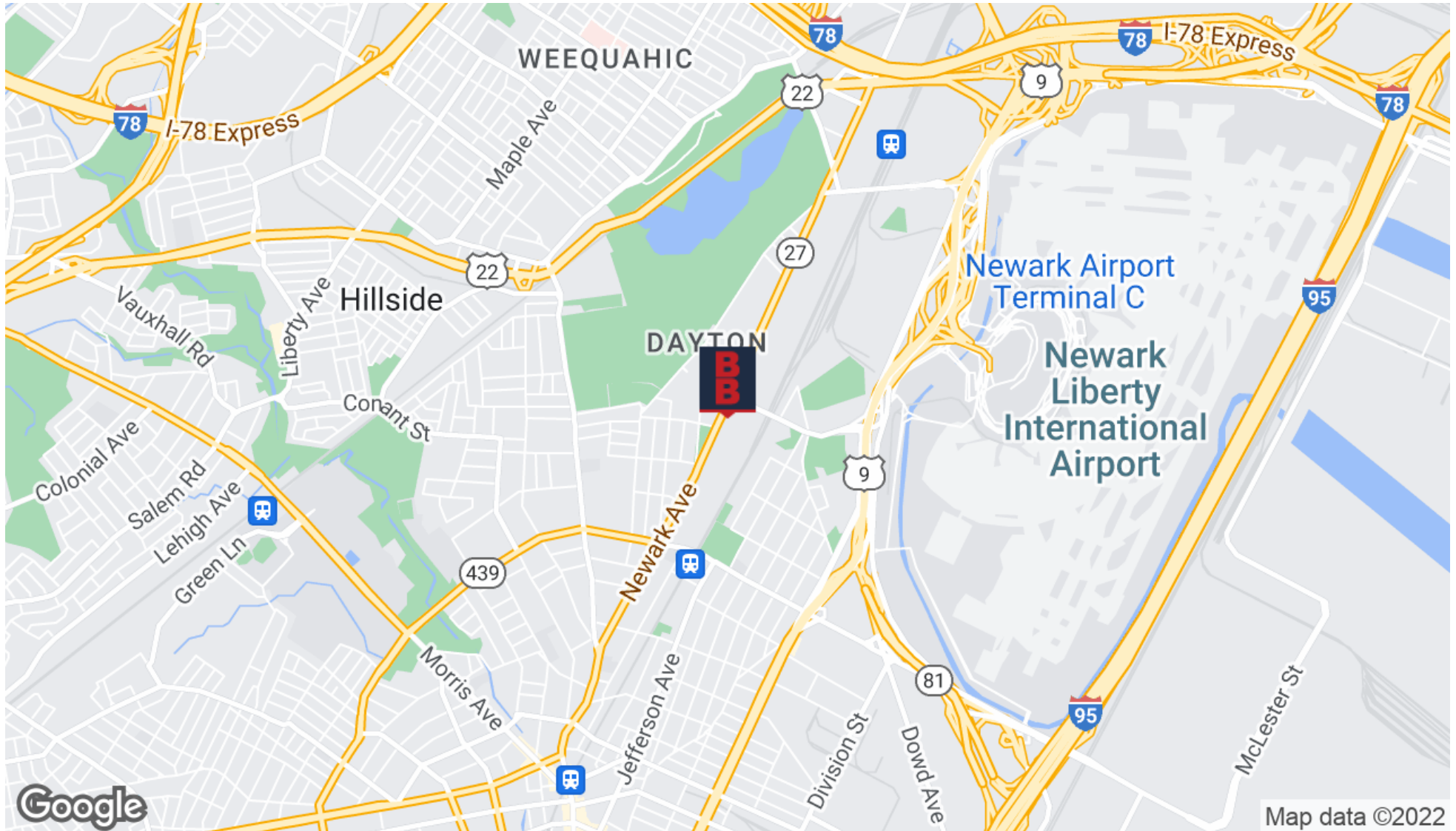

For More Information, Contact the Exclusive Brokers

JASON M. CRIMMINS, CCIM, SIOR | *President* | jmcrimmins@blauberg.com | 973.379.6644 x122
ALESSANDRO (ALEX) CONTE, CCIM, SIOR | *Executive Vice President* | aconte@blauberg.com | 973.379.6644 x131
PETER J. MURANO, JR., SIOR | *Managing Executive Director* | pjmurano@blauberg.com | 973.379.6644 x114
MICHAEL F. SCHIPPER, SIOR | *Senior Executive Director* | mschipper@blauberg.com | 973.379.6644 x146

830 Morris Turnpike
 Suite 201
 Short Hills, NJ 07078

www.blauberg.com

The information contained herein has been obtained from sources considered to be reliable, but no guarantee of its accuracy is made by this company. In addition, no representation is made respecting zoning, condition of title, dimensions, or any matters of a legal or environmental nature. Such matters should be referred to legal counsel for determination. Terms and conditions are subject to change without prior notice. Subject to errors and omissions.



±0.72-ACRE INDUSTRIAL LAND

964-978 Frelinghuysen Avenue, Newark, NJ 07114

POPULATION	0.25 MILES	0.5 MILES	1 MILE
Total Population	1,538	7,200	25,803
Average Age	40.4	35.2	36.3
Average Age (Male)	38.6	35.1	36.1
Average Age (Female)	42.2	36.2	37.4
HOUSEHOLDS & INCOME	0.25 MILES	0.5 MILES	1 MILE
Total Households	823	3,400	10,448
# of Persons per HH	1.9	2.1	2.5
Average HH Income	\$34,889	\$48,976	\$59,018
Average House Value	\$125,362	\$237,709	\$232,559

* Demographic data derived from 2020 ACS - US Census

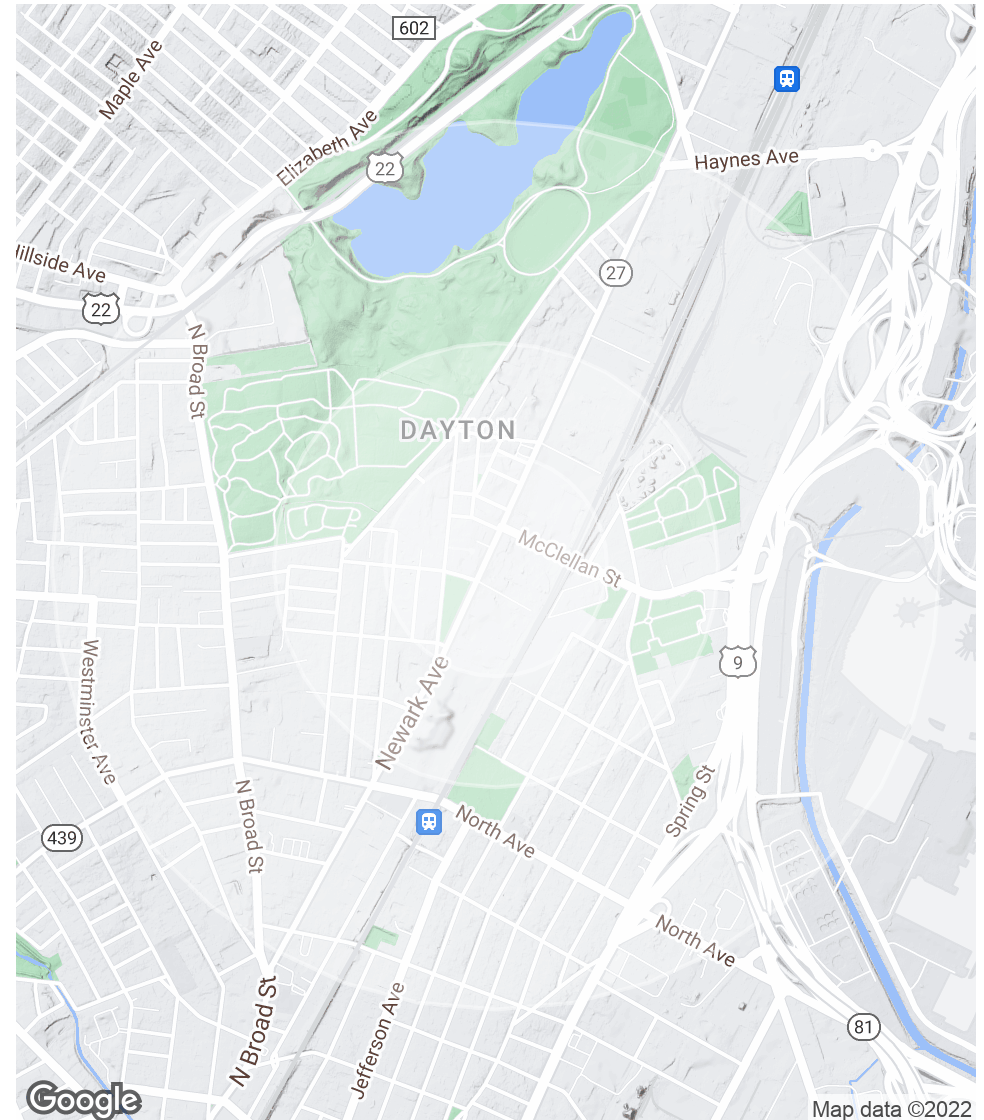

For More Information, Contact the Exclusive Brokers

JASON M. CRIMMINS, CCIM, SIOR | *President* | jmcrimmins@blauberg.com | 973.379.6644 x122

ALESSANDRO (ALEX) CONTE, CCIM, SIOR | *Executive Vice President* | aconte@blauberg.com | 973.379.6644 x131

PETER J. MURANO, JR., SIOR | *Managing Executive Director* | pjmurano@blauberg.com | 973.379.6644 x114

MICHAEL F. SCHIPPER, SIOR | *Senior Executive Director* | mschipper@blauberg.com | 973.379.6644 x146

830 Morris Turnpike
Suite 201
Short Hills, NJ 07078

www.blauberg.com



The information contained herein has been obtained from sources considered to be reliable, but no guarantee of its accuracy is made by this company. In addition, no representation is made respecting zoning, condition of title, dimensions, or any matters of a legal or environmental nature. Such matters should be referred to legal counsel for determination. Terms and conditions are subject to change without prior notice. Subject to errors and omissions.

±0.72-ACRE INDUSTRIAL LAND

964-978 Frelinghuysen Avenue, Newark, NJ 07114



JASON M. CRIMMINS, CCIM, SIOR

President

C: 973.568.6611

jmcrimmins@blauberg.com



ALESSANDRO (ALEX) CONTE, CCIM, SIOR

Executive Vice President

C: 973.432.1648

aconte@blauberg.com



PETER J. MURANO, JR., SIOR

Managing Executive Director

C: 973.214.9375

pjmurano@blauberg.com



MICHAEL F. SCHIPPER, SIOR

Senior Executive Director

C: 973.936.4173

mschipper@blauberg.com

For More Information, Contact the Exclusive Brokers

JASON M. CRIMMINS, CCIM, SIOR | *President* | jmcrimmins@blauberg.com | 973.379.6644 x122

ALESSANDRO (ALEX) CONTE, CCIM, SIOR | *Executive Vice President* | aconte@blauberg.com | 973.379.6644 x131

PETER J. MURANO, JR., SIOR | *Managing Executive Director* | pjmurano@blauberg.com | 973.379.6644 x114

MICHAEL F. SCHIPPER, SIOR | *Senior Executive Director* | mschipper@blauberg.com | 973.379.6644 x146

830 Morris Turnpike
Suite 201
Short Hills, NJ 07078

www.blauberg.com



The information contained herein has been obtained from sources considered to be reliable, but no guarantee of its accuracy is made by this company. In addition, no representation is made respecting zoning, condition of title, dimensions, or any matters of a legal or environmental nature. Such matters should be referred to legal counsel for determination. Terms and conditions are subject to change without prior notice. Subject to errors and omissions.