

# 2410 SCHOFIELD AVE

WESTON, WI 54476

## PROPERTY SUMMARY



### PROPERTY DESCRIPTION

Strong visibility on the northeast corner of Schofield Ave and Cutoff Rd with up to 5800 Sq Ft available

### PROPERTY HIGHLIGHTS

### OFFERING SUMMARY

Lease Rate:	Negotiable
Available SF:	5,826 SF
Building Size:	8,500 SF

DEMOGRAPHICS	1 MILE	3 MILES	5 MILES
Total Households	1,621	11,398	24,986
Total Population	4,031	27,521	60,870
Average HH Income	\$61,835	\$62,241	\$58,472

Presented By:

Legacy Commercial Property

847.904.9200

info@legacypro.com



**LEGACY**  
COMMERCIAL PROPERTY

2500 Lehigh Ave  
Glenview, IL 60026  
<http://legacypro.com>

# 2410 SCHOFIELD AVE

WESTON, WI 54476

ADDITIONAL PHOTOS



Presented By:

Legacy Commercial Property

847.904.9200

info@legacypro.com



**LEGACY**  
COMMERCIAL PROPERTY

2500 Lehigh Ave  
Glenview, IL 60026  
<http://legacypro.com>

# 2410 SCHOFIELD AVE

WESTON, WI 54476

PLANS



## LEGEND

Available

Unavailable

## LEASE INFORMATION

Lease Type:	NNN	Lease Term:	Negotiable
Total Space:	5,826 SF	Lease Rate:	Negotiable

## AVAILABLE SPACES

SUITE	TENANT	SIZE	TYPE	RATE	DESCRIPTION
2410 Schofield Ave	Papa Murphy's	1,473 SF	NNN	Negotiable	-
2410 Schofield Ave	Great Clips	1,206 SF	NNN	-	-
2410 Schofield Ave	Available	5,826 SF	NNN	Negotiable	-

Presented By:

Legacy Commercial Property

847.904.9200

info@legacypro.com



**LEGACY**  
COMMERCIAL PROPERTY

2500 Lehigh Ave  
Glenview, IL 60026  
<http://legacypro.com>

# 2410 SCHOFIELD AVE

WESTON, WI 54476

FLOOR PLANS

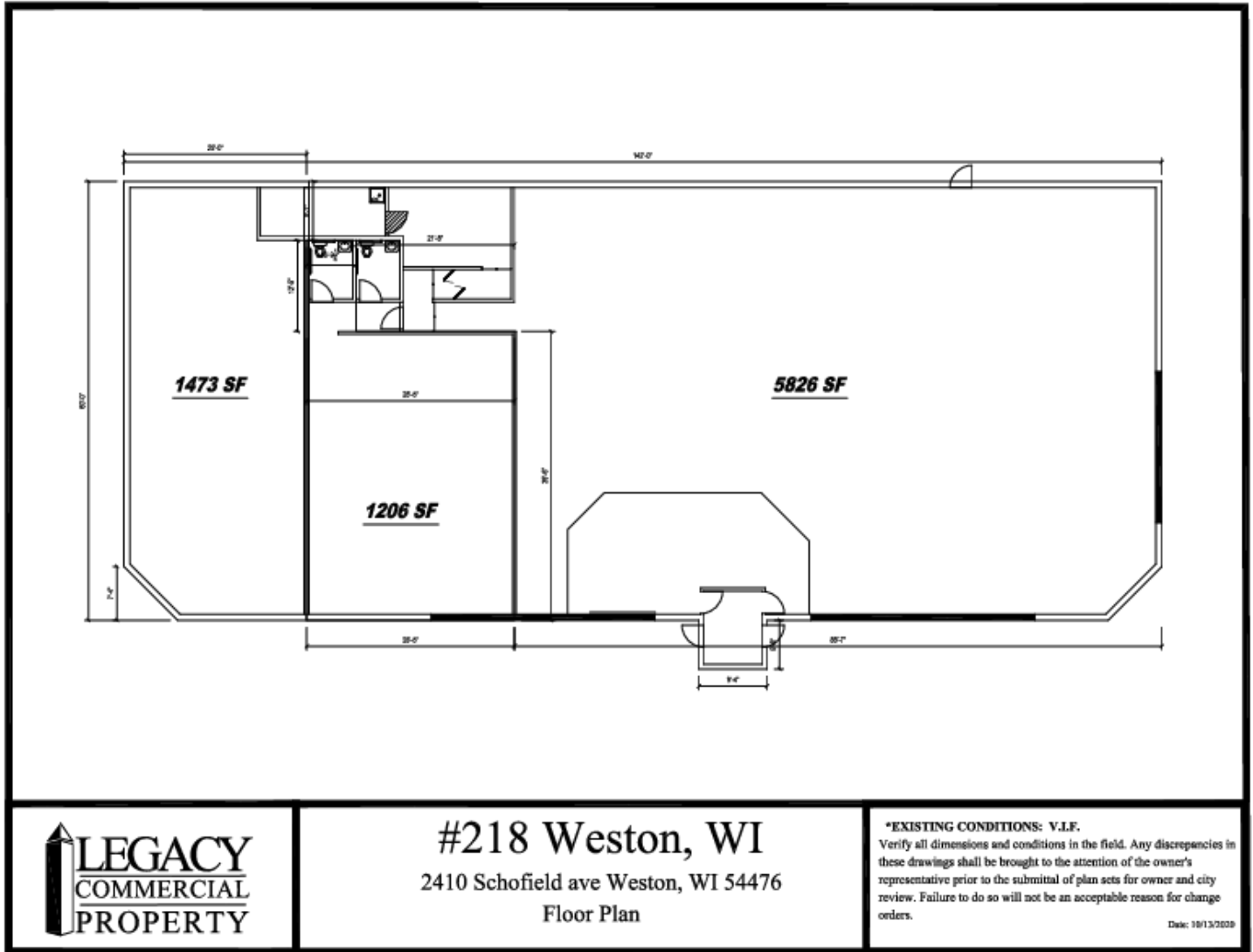

#218 Weston, WI  
2410 Schofield ave Weston, WI 54476  
Floor Plan

\*EXISTING CONDITIONS: V.L.F.  
Verify all dimensions and conditions in the field. Any discrepancies in these drawings shall be brought to the attention of the owner's representative prior to the submittal of plan sets for owner and city review. Failure to do so will not be an acceptable reason for change orders.  
Date: 10/13/2020

Presented By:

Legacy Commercial Property

847.904.9200

info@legacypro.com



LEGACY  
COMMERCIAL PROPERTY

2500 Lehigh Ave  
Glenview, IL 60026  
http://legacypro.com