

6683 SOUTHERN BOULEVARD

West Palm Beach, FL

WAREHOUSE/OFFICE: $\pm 102,769$ SF ON ± 7 ACRES IN WEST PALM BEACH, FL



PROPERTY HIGHLIGHTS

- » New Class A Industrial Development
- » $\pm 102,769$ SF and Building
- » LEED® certified
- » Direct Access & Frontage to Southern Boulevard

FOR LEASE

$\pm 102,769$ SF
on
 ± 7 Acres

NEW CONSTRUCTION

ROBERT SMITH

Executive Vice President
+1 561 707 5558
robert.c.smith@cbre.com

KIRK NELSON

Senior Vice President
+1 561 716 9936
kirk.nelson@cbre.com

DAVID LOUDENSLAGER

Vice President, Leasing & Development
+1 954 453 5683
david.loudenslager@dukerealty.com

CBRE

DukeREALTY

6683 SOUTHERN BOULEVARD

West Palm Beach, FL



Conceptual Rendering

FOR LEASE

BUILDING SPECIFICATIONS



TOTAL BUILDING SF:

±102,769 SF on 7 Acres
Built to suit - Flexibility for multi-tenant



OVERHEAD DOORS:

28 - 9' x 10' Manual Overhead Doors
2 - 12' x 14' Motorized Drive-in Doors



BUILDING FOOTPRINT

±102,769 SF



CLEAR HEIGHT:

32'



BUILDING SAFETY:

ESFR Fire Sprinklers
Impact Glass



BAY SIZING:

Dock bays - 54' x 60'
Interior bays - 54' x 50'



BUILDING CONSTRUCTION:

60' Concrete Apron
7" Slab on Grade



CAR PARKING:

100 Spaces

CBRE © 2022 All Rights Reserved. All information included in this letter/proposal pertaining to CBRE—including but not limited to its operations, employees, technology and clients—is proprietary and confidential and supplied with the understanding that such information will be held in confidence and not disclosed to any third party without CBRE's prior written consent. This letter/proposal is intended solely as a preliminary expression of general intentions, is for discussion purposes only, and does not create any agreement or obligation by CBRE to negotiate or continue negotiations. CBRE shall have no contractual obligations with respect to the matters referred to herein unless and until a definitive, fully executed agreement has been delivered by the parties. Prior to delivery of a definitive executed agreement, and without any liability to the other party, either party may (1) propose different terms from those summarized herein, (2) enter into negotiations with other parties and/or (3) unilaterally terminate all negotiations with the other party hereto.

CBRE

DukeREALTY

BUILDING PLANS

SITE PLAN

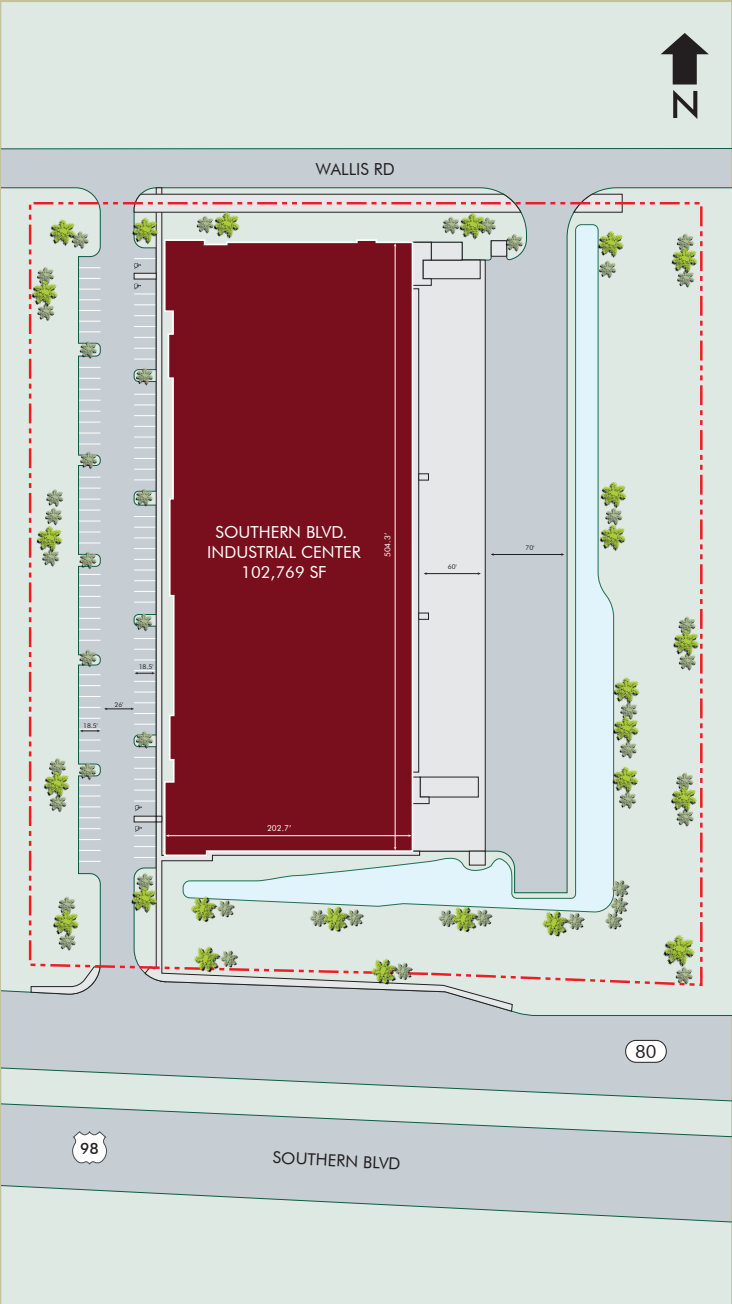

FLOOR PLAN

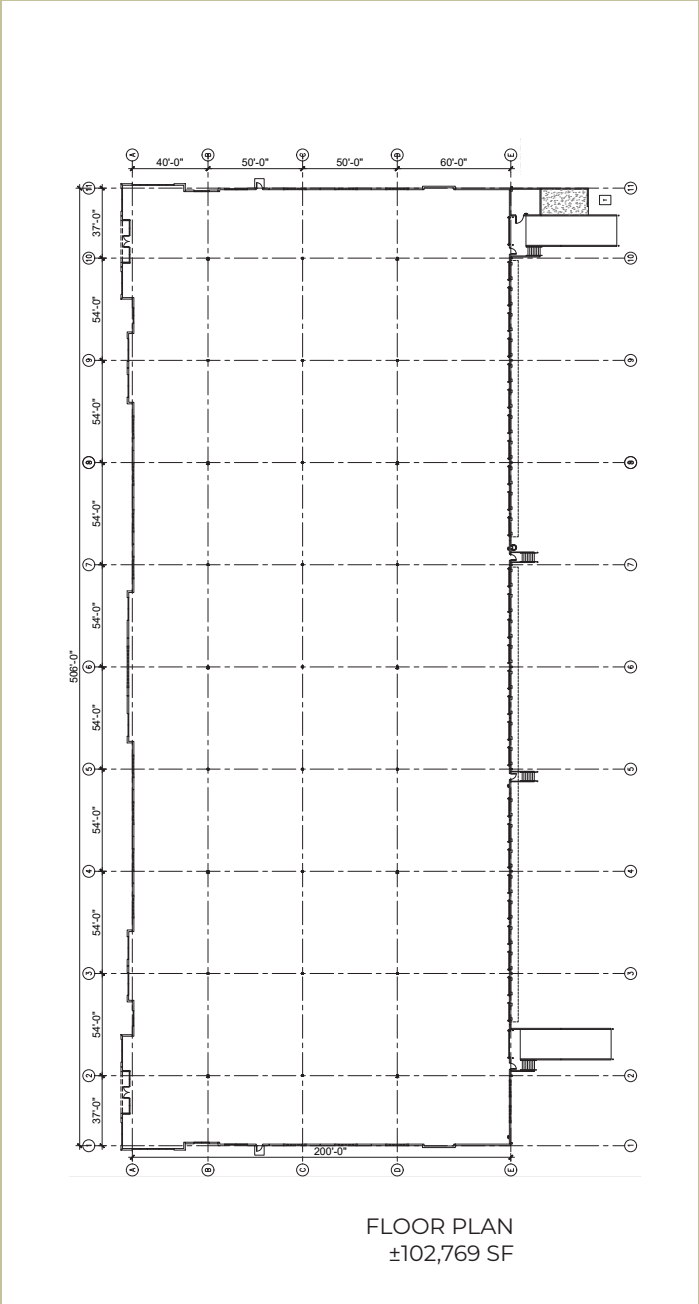

6683 SOUTHERN BOULEVARD

West Palm Beach, FL



Conceptual Rendering

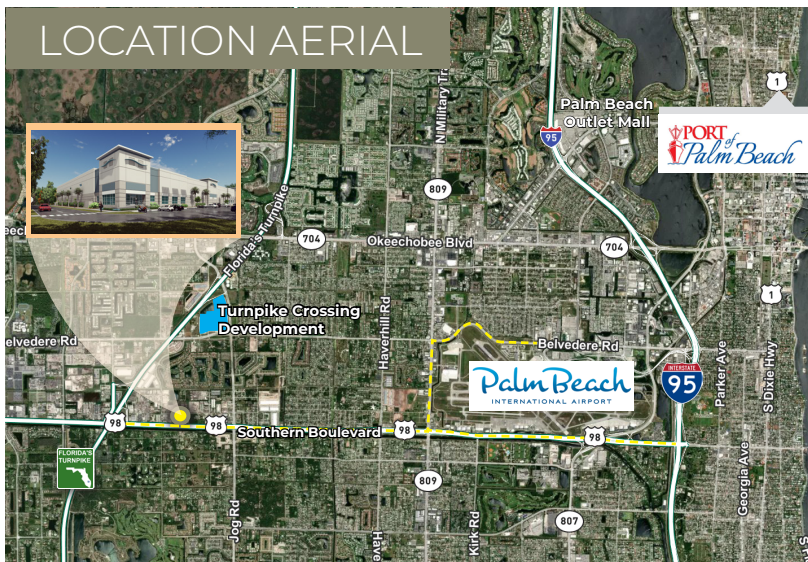

AREA DRIVE TIMES

DESTINATION	DISTANCE	TIME
Palm Beach International Airport	6 Miles	10 Minutes
Port of Palm Beach	13 Miles	31 Minutes
Florida's Turnpike	Less than 1 Mile	1 Minute
I-95	7 Miles	12 Minutes

ROBERT SMITH

Executive Vice President
+1 561 707 5558
robert.c.smith@cbre.com

KIRK NELSON

Senior Vice President
+1 561 716 9936
kirk.nelson@cbre.com

DAVID LOUDENSLAGER

Vice President, Leasing & Development
+1 954 453 5683
david.loudenslager@dukerealty.com

CBRE

DukeREALTY