

SCOTTSDALE AIRPARK SUBMARKET

# ±55,422 SF OFFICE / RETAIL / SHOWROOM FOR SALE

15001 N HAYDEN ROAD • SCOTTSDALE, AZ 85260

**C-3 ZONING**

EXCLUSIVELY OFFERED BY



**Randy Shell**  
Designated Broker  
C 480.694.4100  
randy@shellcommercial.com



**Amanda Wright**  
Associate  
C 480.236.0037  
amanda@shellcommercial.com



O 480 443 3992  
www.shellcommercial.com  
16410 N 91st Street | Suite 112  
Scottsdale, AZ 85260

The above is subject to prior sales and leasing. This information has been secured from sources we believe to be reliable, but we make no representation or warranties, expressed or implied as to the accuracy of this information.



**15001 N HAYDEN ROAD • SCOTTSDALE, AZ 85260**

**Purchase Price:** • \$16,705,000

**Proforma NOI:** • \$842,832.63 (9/1/22-8/31/23)

**Size:** • ±55,422 sf two story office/retail/showroom building  
- First floor: ±38,590 sf    - Second floor: ±16,832 sf

**Land:** • ±3.42 Acre Lot (±149,083 sf) (Maricopa County Assessor)

**Zoning:** • C-3 (Commercial), City of Scottsdale

**Features:** • Built in 1985

- Prime location on major intersection (Hayden/Raintree)
- One (1) mile from Loop 101 Freeway access
- New Exterior Paint 2022
- Great second floor views!
- Second floor renovations in progress to accommodate 1-5 tenants
- Rare C-3 zoning which allows for automotive & retail use

**Parcel#:** • 215-55-010A / 215-55-011

**2021 Taxes:** • \$83,562.80 (\$1.52/sf)





15001 N HAYDEN ROAD • SCOTTSDALE, AZ 85260



Perfectly situated on the northeast corner of Hayden Road and Raintree Drive, 15001 N Hayden has become a familiar landmark in the Scottsdale Airpark.

First floor suites feature showroom, retail, & warehouse, with option for second floor offices. Independent second floor office suites currently available offering excellent views and floor plan flexibility.





15001 N HAYDEN ROAD • SCOTTSDALE, AZ 85260

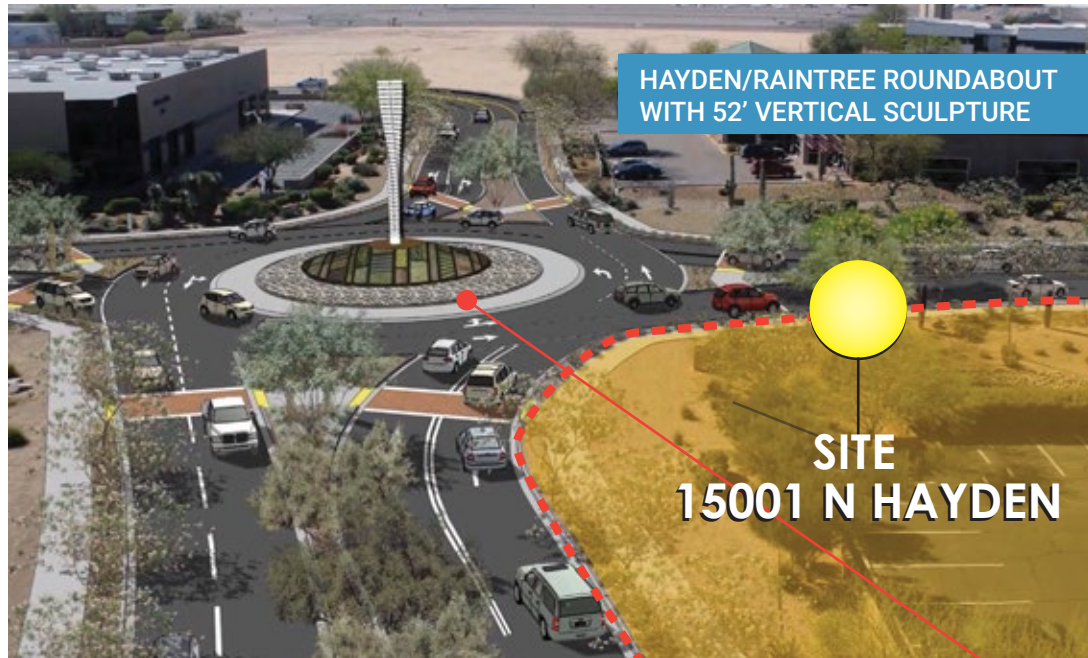

"The Scottsdale Airpark is the preeminent employment center in Scottsdale and the third largest in the Phoenix metro area after Phoenix Sky Harbor Airport and Downtown Phoenix." - City of Scottsdale -

With this in mind, the City of Scottsdale's purpose for the Raintree Drive Extension is to create a smooth thoroughfare between Hayden Road and Scottsdale Road.

One of the five roundabouts along the project is adjacent to 15001 N Hayden, on Raintree Drive. This artfully designed feature will be graced with a 52' vertical sculpture.



The roundabout will lend two main advantages to the subject property: more traffic exposure, and quicker access to the Loop 101 Freeway.

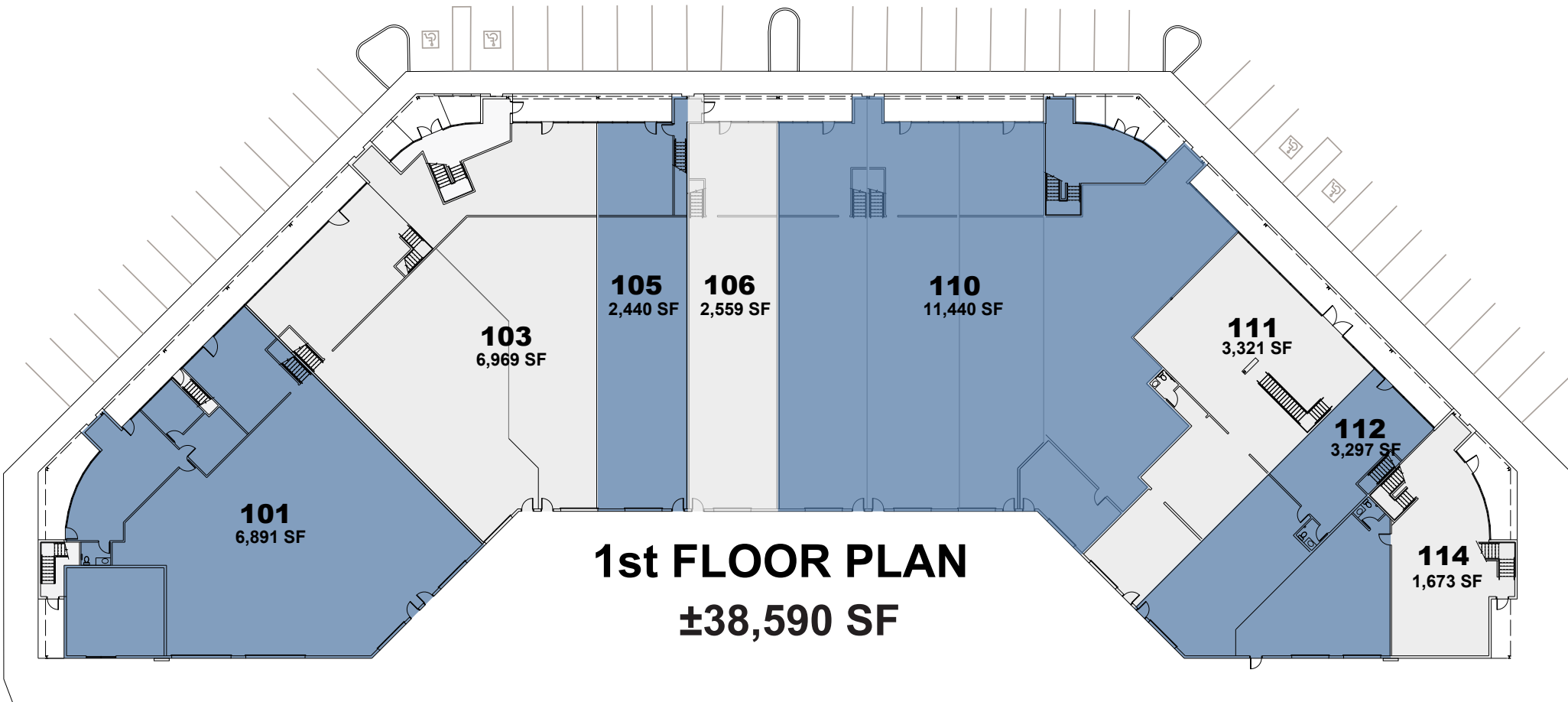

15001 N HAYDEN ROAD • SCOTTSDALE, AZ 85260

**NOT TO SCALE**

All information furnished regarding property for sale, rental or financing is from sources deemed reliable, but no warranty or representation is made to the accuracy thereof and same is submitted to errors, omissions, change of price, rental or other conditions, prior to sale, lease or financing or withdrawal without notice. No liability of any kind is to be imposed on the broker herein. This information has been secured from sources deemed reliable, however, we make no warranties as to its accuracy.

15001 N HAYDEN ROAD • SCOTTSDALE, AZ 85260

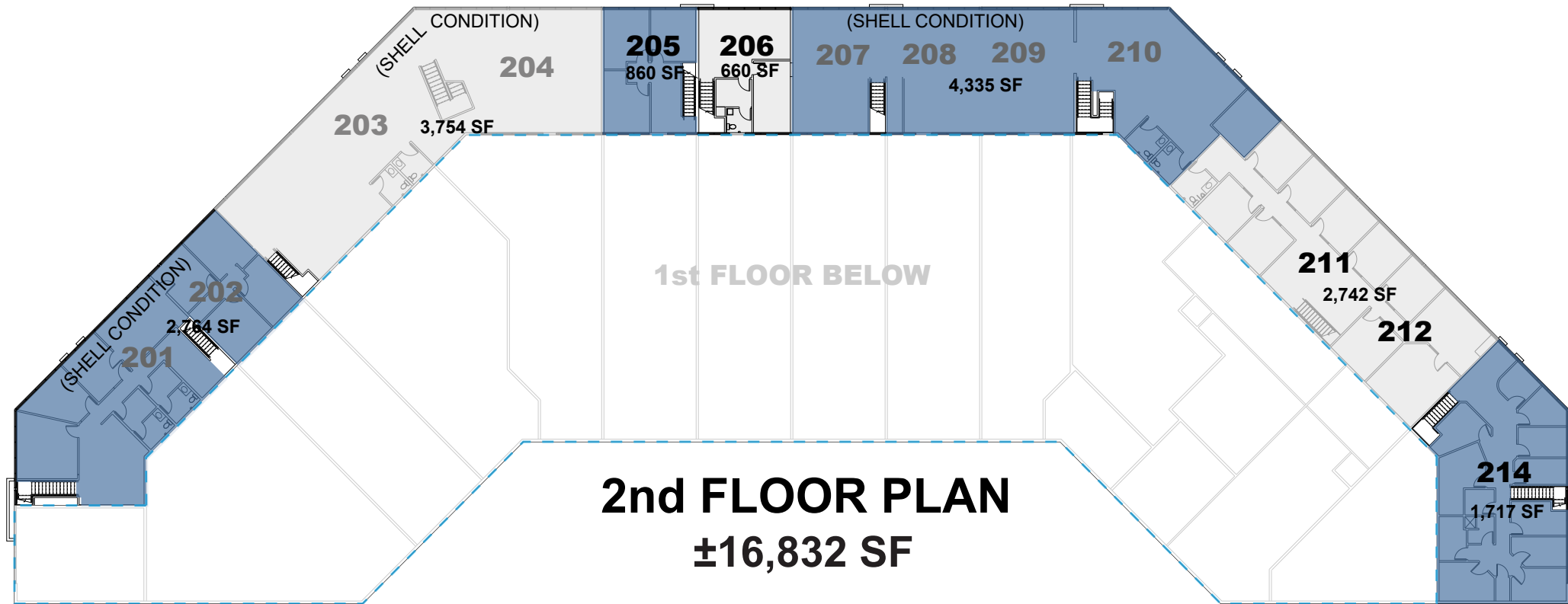
**NOT TO SCALE**

All information furnished regarding property for sale, rental or financing is from sources deemed reliable, but no warranty or representation is made to the accuracy thereof and same is submitted to errors, omissions, change of price, rental or other conditions, prior to sale, lease or financing or withdrawal without notice. No liability of any kind is to be imposed on the broker herein. This information has been secured from sources deemed reliable, however, we make no warranties as to its accuracy.

15001 N HAYDEN ROAD • SCOTTSDALE, AZ 85260

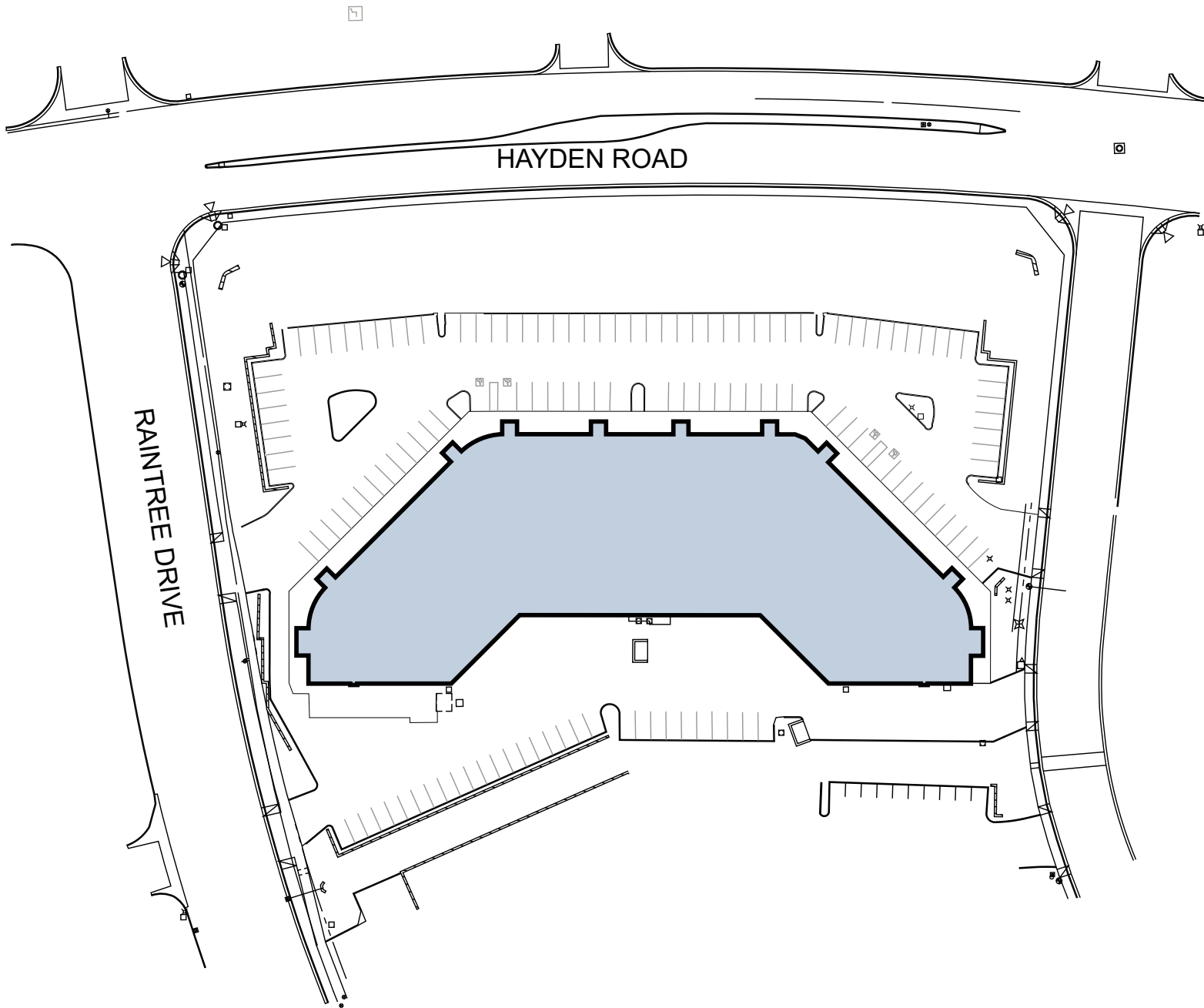



15001 N HAYDEN ROAD • SCOTTSDALE, AZ 85260



KIERLAND COMMONS



SCOTTSDALE MUNICIPAL AIRPORT



SCOTTSDALE QUARTER

