

# FOR LEASE

## MEDICAL OFFICE CONDOS



3100-3132 CAPITAL WAY, FORT WORTH, TX 76244



### PROPERTY HIGHLIGHTS

- 8 buildings ranging from ±3,147 to 9,742 SF
- Medical/Office Condos
- Sale/Lease Options
- Owner/User or Investment Buildings
- Shell / Turn-Key Delivery
- Explosive Growth & Strong Demographics
- Adjacent to Texas Health Resources Hospital
- Excellent Visibility to Golden Triangle Blvd and I-35
- Part of Hillwood's Alliance Town Center - Master Development
- Located at Golden Triangle & I35W

LEASE RATE \$29.00 SF/YR | NNN



### CONTACT INFORMATION

#### JIM KELLEY

Office: 817.488.4333  
Cell: 817.909.7875  
jim@championsdfw.com

#### ERIC GOODWIN

Office: 817.488.4333  
Cell: 214.642.8928  
eric@championsdfw.com

#### LON LLOYD, CCIM

Office: 817.488.4333  
Cell: 817.528.0377  
lon@championsdfw.com

#### Champions DFW Commercial Realty

1725 E Southlake Blvd, Suite 100, Southlake, TX 76092

©2020 Champions DFW Commercial Realty LLC.

All rights reserved. The information contained herein was obtained from sources believed to be reliable. It is subject to verification. The presentation of this property is submitted subject to errors, omissions, change of price or conditions, prior to sale or lease, or withdrawal without notice.

# FOR LEASE MEDICAL OFFICE CONDOS



3100-3132 CAPITAL WAY, FORT WORTH, TX 76244

## SITE PLANS

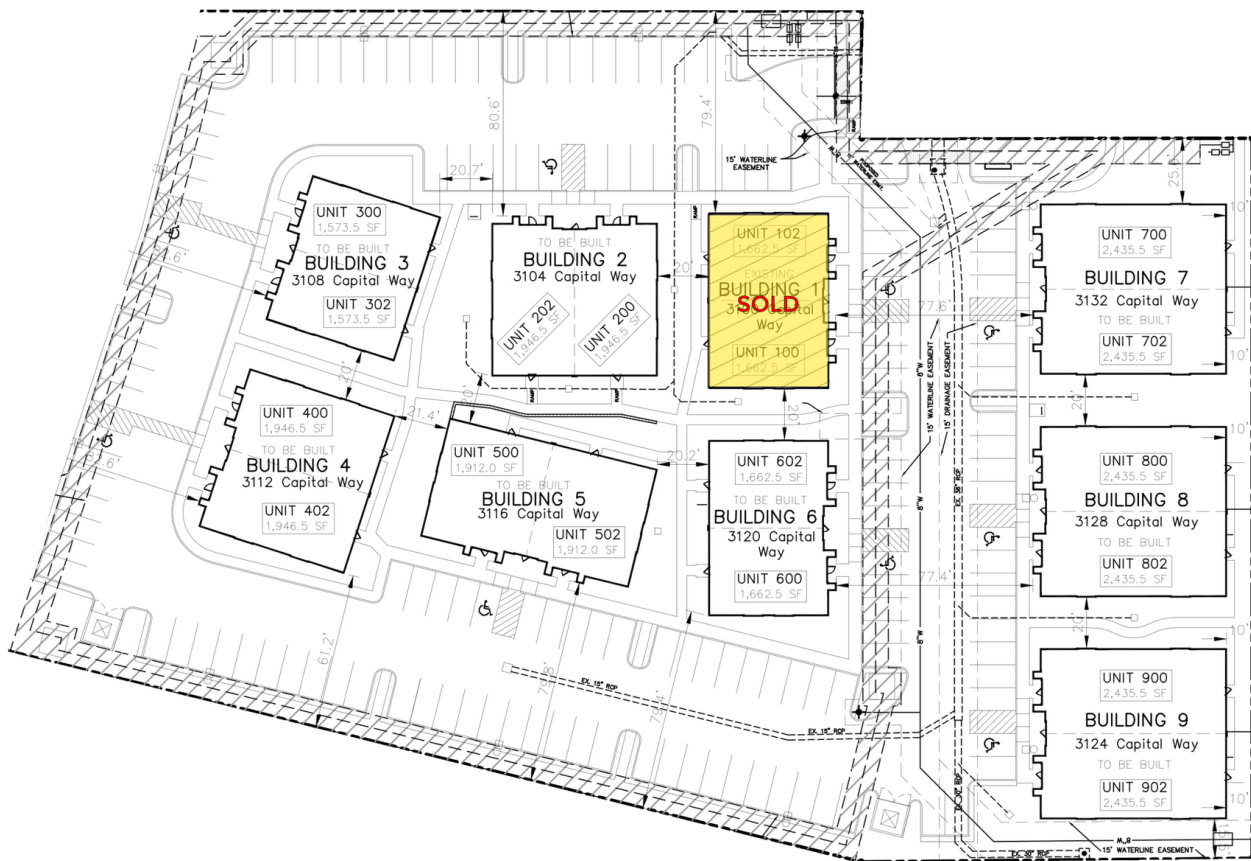

**Champions DFW Commercial Realty**

1725 E Southlake Blvd, Suite 100, Southlake, TX 76092

©2020 Champions DFW Commercial Realty LLC.

All rights reserved. The information contained herein was obtained from sources believed to be reliable. It is subject to verification. The presentation of this property is submitted subject to errors, omissions, change of price or conditions, prior to sale or lease, or withdrawal without notice.



# FOR LEASE MEDICAL OFFICE CONDOS



3100-3132 CAPITAL WAY, FORT WORTH, TX 76244

## EXTERIOR PHOTOS



**Champions DFW Commercial Realty**

1725 E Southlake Blvd, Suite 100, Southlake, TX 76092

©2020 Champions DFW Commercial Realty LLC.

All rights reserved. The information contained herein was obtained from sources believed to be reliable. It is subject to verification. The presentation of this property is submitted subject to errors, omissions, change of price or conditions, prior to sale or lease, or withdrawal without notice.



# FOR LEASE MEDICAL OFFICE CONDOS



3100-3132 CAPITAL WAY, FORT WORTH, TX 76244

## RETAILER MAP



**Champions DFW Commercial Realty**

1725 E Southlake Blvd, Suite 100, Southlake, TX 76092

©2020 Champions DFW Commercial Realty LLC.

All rights reserved. The information contained herein was obtained from sources believed to be reliable. It is subject to verification. The presentation of this property is submitted subject to errors, omissions, change of price or conditions, prior to sale or lease, or withdrawal without notice.



# FOR LEASE

## MEDICAL OFFICE CONDOS



3100-3132 CAPITAL WAY, FORT WORTH, TX 76244

### LEASE SPACES

### LEASE INFORMATION

Lease Type:	NNN	Lease Term:	60 to 120 months
Total Space:	3,147 - 3,893 SF	Lease Rate:	\$29.00 SF/yr

### AVAILABLE SPACES

SUITE	TENANT	SIZE (SF)	LEASE TYPE	LEASE RATE	
3108 Capital Way Building 3	Available	3,147 SF	NNN	\$29.00 SF/yr	-
3112 Capital Way Building 4	Available	3,893 SF	NNN	\$29.00 SF/yr	-
3120 Capital Way Building 6	Available	3,325 SF	NNN	\$29.00 SF/yr	-

**Champions DFW Commercial Realty**

1725 E Southlake Blvd, Suite 100, Southlake, TX 76092

©2020 Champions DFW Commercial Realty LLC.

All rights reserved. The information contained herein was obtained from sources believed to be reliable. It is subject to verification. The presentation of this property is submitted subject to errors, omissions, change of price or conditions, prior to sale or lease, or withdrawal without notice.

# FOR LEASE MEDICAL OFFICE CONDOS



3100-3132 CAPITAL WAY, FORT WORTH, TX 76244

## DEMOGRAPHICS MAP & REPORT

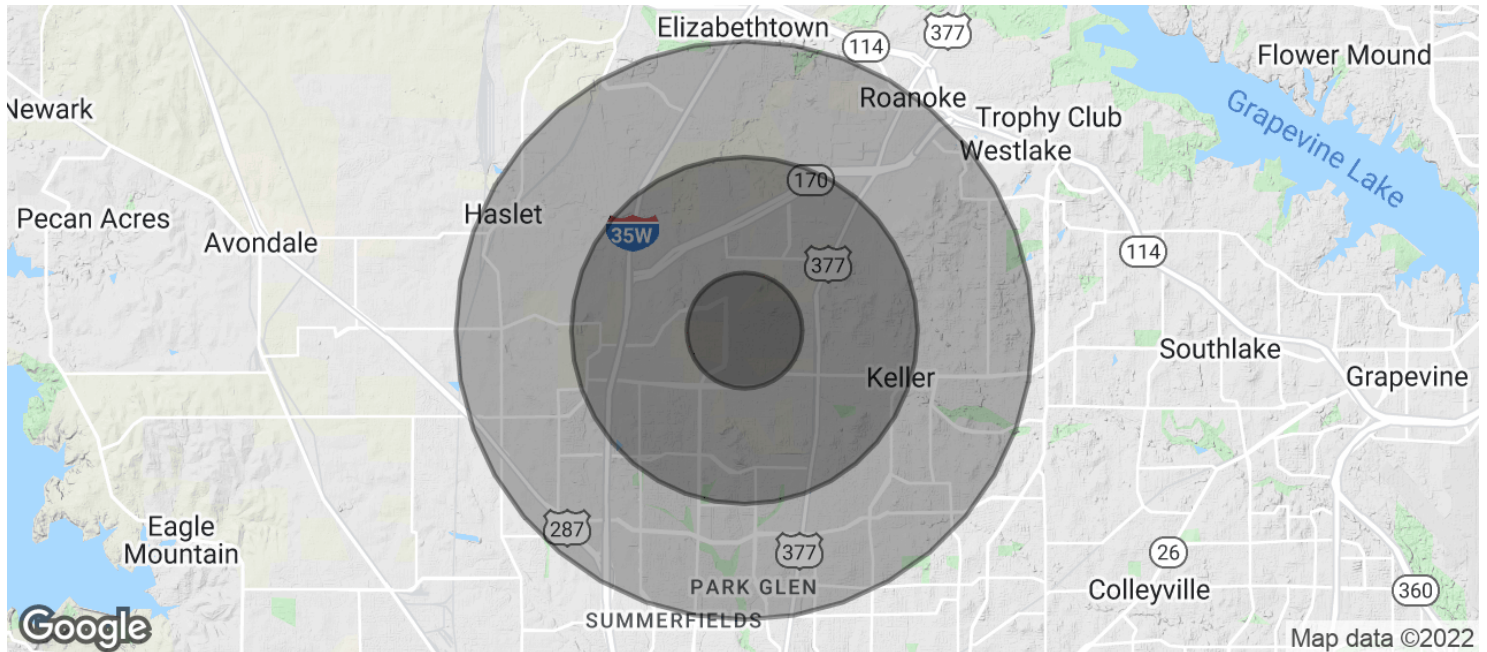

### POPULATION

	1 MILE	3 MILES	5 MILES
Total Population	5,352	42,675	134,951
Average Age	30.5	30.7	31.8
Average Age (Male)	30.2	30.6	30.9
Average Age (Female)	31.0	30.9	32.1

### HOUSEHOLDS & INCOME

	1 MILE	3 MILES	5 MILES
Total Households	1,718	13,645	43,527
# of Persons per HH	3.1	3.1	3.1
Average HH Income	\$91,020	\$91,142	\$91,630
Average House Value	\$179,776	\$182,971	\$186,527

*\* Demographic data derived from 2010 US Census*

### Champions DFW Commercial Realty

1725 E Southlake Blvd, Suite 100, Southlake, TX 76092

©2020 Champions DFW Commercial Realty LLC.

All rights reserved. The information contained herein was obtained from sources believed to be reliable. It is subject to verification. The presentation of this property is submitted subject to errors, omissions, change of price or conditions, prior to sale or lease, or withdrawal without notice.



# FOR LEASE

## MEDICAL OFFICE CONDOS



3100-3132 CAPITAL WAY, FORT WORTH, TX 76244

### BROKER CONTACTS



#### JIM KELLEY

Principal/Broker

C: 817.909.7875

jim@championsdfw.com



#### ERIC GOODWIN

Director of Office & Industrial Services

C: 214.642.8928

eric@championsdfw.com



#### LON LLOYD, CCIM

Director of Investment Services

C: 817.528.0377

lon@championsdfw.com



#### TRINA ZAIS, AICP, MPA

Senior Associate

C: 817.304.3263

trina@championsdfw.com

#### Champions DFW Commercial Realty

1725 E Southlake Blvd, Suite 100, Southlake, TX 76092

©2020 Champions DFW Commercial Realty LLC.

All rights reserved. The information contained herein was obtained from sources believed to be reliable. It is subject to verification. The presentation of this property is submitted subject to errors, omissions, change of price or conditions, prior to sale or lease, or withdrawal without notice.



**CHAMPIONS™**  
DFW COMMERCIAL REALTY

**Champions DFW Commercial Realty**

1725 E Southlake Blvd, Suite 100, Southlake, TX 76092

©2020 Champions DFW Commercial Realty LLC.

All rights reserved. The information contained herein was obtained from sources believed to be reliable. It is subject to verification. The presentation of this property is submitted subject to errors, omissions, change of price or conditions, prior to sale or lease, or withdrawal without notice