



**Southwestern Plaza**  
**6002-6072 S. Western Avenue**

Oklahoma City, Oklahoma 73139

**PROPERTY HIGHLIGHTS**

- Prominent Location on the Corner of Western Avenue and S.W. 59<sup>th</sup> Street
- Below Market Rents Across the Center
- Stabilized
- 95% Occupancy
- Cap Rate: 7.2%

TOTAL SF	122,527 SF
TOTAL ACRES	14.09 Acres
YEAR BUILT / RENOVATED	1965 / 2003
ZONED	C-3

NO WARRANTY OR REPRESENTATION, EXPRESS OR IMPLIED, IS MADE AS TO THE ACCURACY OF THE INFORMATION CONTAINED HEREIN, AND THE SAME IS SUBMITTED SUBJECT TO ERRORS, OMISSIONS, CHANGE OF PRICE, RENTAL OR OTHER CONDITIONS, PRIOR SALE, LEASE OR FINANCING, OR WITHDRAWAL WITHOUT NOTICE, AND OF ANY SPECIAL LISTING CONDITIONS IMPOSED BY OUR PRINCIPALS NO WARRANTIES OR REPRESENTATIONS ARE MADE AS TO THE CONDITION OF THE PROPERTY OR ANY HAZARDS CONTAINED THEREIN ARE ANY TO BE IMPLIED.

**David Hartnack**  
+1 405 761 8955  
davidh@naisullivangroup.com

**Sam Swanson**  
+1 405 208 2046  
sam@naisullivangroup.com

**Samuel Dunham**  
+1 405 207 7286  
samuel@naisullivangroup.com

4045 N.W. 64<sup>th</sup> Street, Suite 340  
Oklahoma City, OK 73116  
[www.naisullivangroup.com](http://www.naisullivangroup.com)

+1 405 840 0600 OFFICE  
+1 405 840 0610 FAX

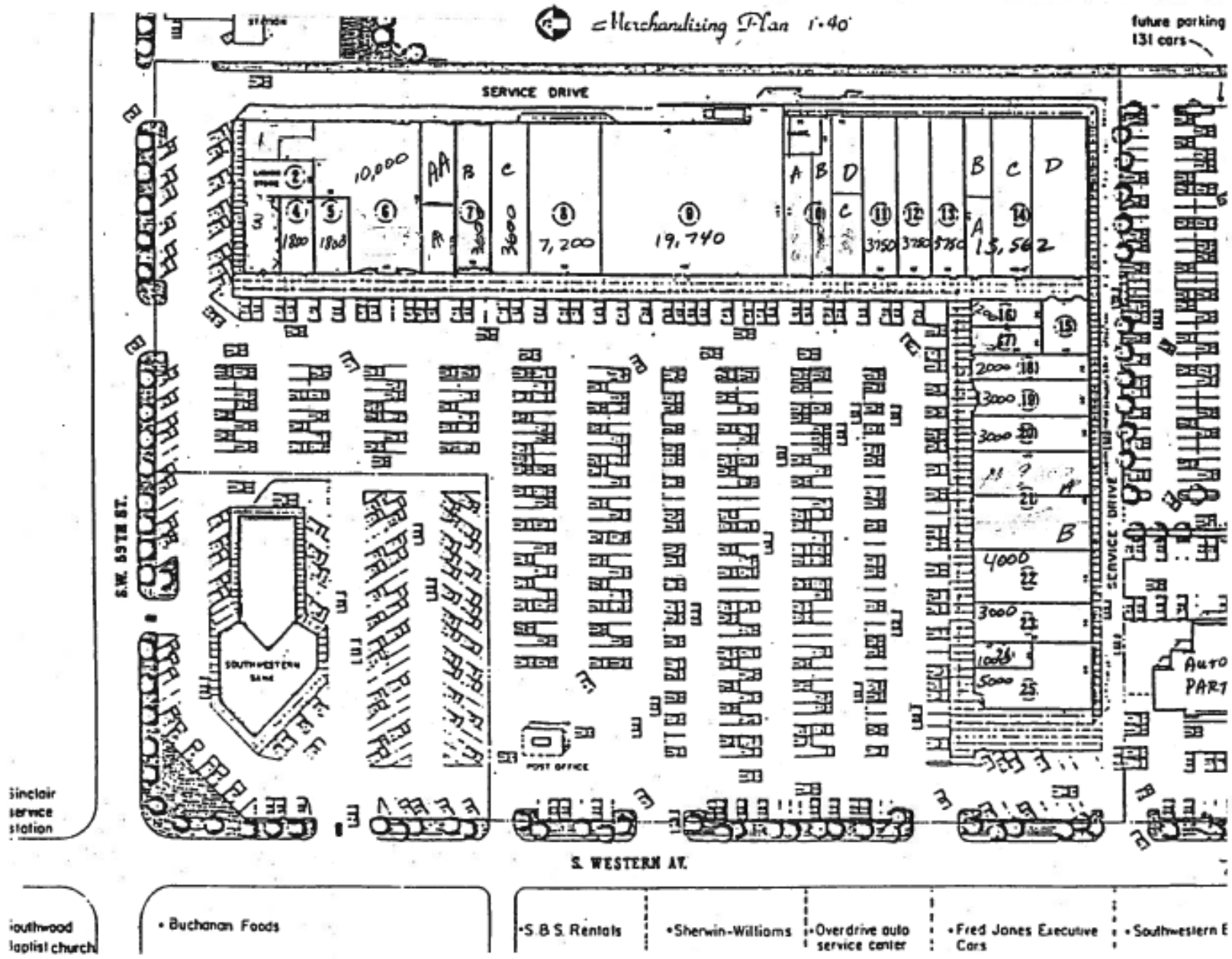

NO WARRANTY OR REPRESENTATION, EXPRESS OR IMPLIED, IS MADE AS TO THE ACCURACY OF THE INFORMATION CONTAINED HEREIN, AND THE SAME IS SUBMITTED SUBJECT TO ERRORS, OMISSIONS, CHANGE OF PRICE, RENTAL OR OTHER CONDITIONS, PRIOR SALE, LEASE OR FINANCING, OR WITHDRAWAL WITHOUT NOTICE, AND OF ANY SPECIAL LISTING CONDITIONS IMPOSED BY OUR PRINCIPALS NO WARRANTIES OR REPRESENTATIONS ARE MADE AS TO THE CONDITION OF THE PROPERTY OR ANY HAZARDS CONTAINED THEREIN ARE ANY TO BE IMPLIED.

**David Hartnack**  
+1 405 761 8955  
davidh@naisullivangroup.com

**Sam Swanson**  
+1 405 208 2046  
sam@naisullivangroup.com

**Samuel Dunham**  
+1 405 207 7286  
samuel@naisullivangroup.com

4045 N.W. 64<sup>th</sup> Street, Suite 340  
Oklahoma City, OK 73116  
[www.naisullivangroup.com](http://www.naisullivangroup.com)

+1 405 840 0600 OFFICE  
+1 405 840 0610 FAX



NO WARRANTY OR REPRESENTATION, EXPRESS OR IMPLIED, IS MADE AS TO THE ACCURACY OF THE INFORMATION CONTAINED HEREIN, AND THE SAME IS SUBMITTED SUBJECT TO ERRORS, OMISSIONS, CHANGE OF PRICE, RENTAL OR OTHER CONDITIONS, PRIOR SALE, LEASE OR FINANCING, OR WITHDRAWAL WITHOUT NOTICE, AND OF ANY SPECIAL LISTING CONDITIONS IMPOSED BY OUR PRINCIPALS NO WARRANTIES OR REPRESENTATIONS ARE MADE AS TO THE CONDITION OF THE PROPERTY OR ANY HAZARDS CONTAINED THEREIN ARE ANY TO BE IMPLIED.

**David Hartnack**  
+1 405 761 8955  
davidh@naisullivangroup.com

**Sam Swanson**  
+1 405 208 2046  
sam@naisullivangroup.com

**Samuel Dunham**  
+1 405 207 7286  
samuel@naisullivangroup.com

4045 N.W. 64<sup>th</sup> Street, Suite 340  
Oklahoma City, OK 73116  
[www.naisullivangroup.com](http://www.naisullivangroup.com)

+1 405 840 0600 OFFICE  
+1 405 840 0610 FAX

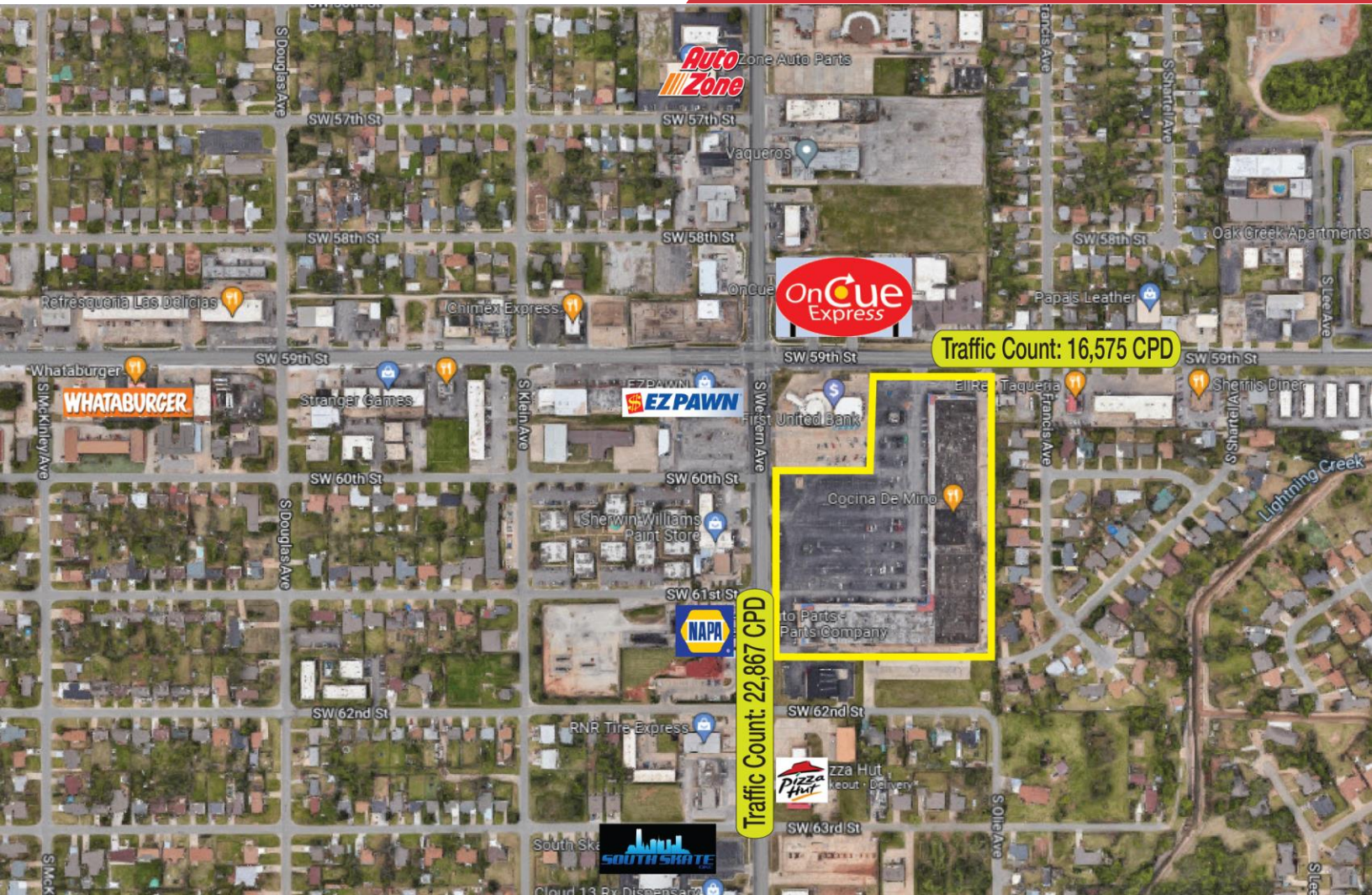

### LOCATION HIGHLIGHTS

- Dense Suburban Trade Area
- Heavy Traffic Intersection

Population	1 Mile: 15,171	3 Miles: 114,876	5 Miles: 216,559
Average Household Income	1 Mile: \$46,417	3 Miles: \$51,073	5 Miles: \$61,191
Total Households	1 Mile: 5,902	3 Miles: 42,544	5 Miles: 79,890

NO WARRANTY OR REPRESENTATION, EXPRESS OR IMPLIED, IS MADE AS TO THE ACCURACY OF THE INFORMATION CONTAINED HEREIN, AND THE SAME IS SUBMITTED SUBJECT TO ERRORS, OMISSIONS, CHANGE OF PRICE, RENTAL OR OTHER CONDITIONS, PRIOR SALE, LEASE OR FINANCING, OR WITHDRAWAL WITHOUT NOTICE, AND OF ANY SPECIAL LISTING CONDITIONS IMPOSED BY OUR PRINCIPALS NO WARRANTIES OR REPRESENTATIONS ARE MADE AS TO THE CONDITION OF THE PROPERTY OR ANY HAZARDS CONTAINED THEREIN ARE ANY TO BE IMPLIED.

**David Hartnack**  
+1 405 761 8955  
davidh@naisullivangroup.com

**Sam Swanson**  
+1 405 208 2046  
sam@naisullivangroup.com

**Samuel Dunham**  
+1 405 207 7286  
samuel@naisullivangroup.com

4045 N.W. 64<sup>th</sup> Street, Suite 340  
Oklahoma City, OK 73116  
[www.naisullivangroup.com](http://www.naisullivangroup.com)

+1 405 840 0600 OFFICE  
+1 405 840 0610 FAX