



15,045 SF Industrial Warehouse Sale Price: \$2,100,000

Just over 15,000 SF of industrial warehouse space for sale. Property offers three dock doors and one drive-in door. Located just south of 72nd and L Street, with great visibility to 46,800 cars per day! Property does have billboard that is leased and generates \$850/month income. Available October 2022.

Michael P. Earl
Principal
(402) 548 4005
michael.earl@lundco.com

450 Regency Parkway, Suite 200
Omaha, NE 68114
+1 402 393 8811
lundco.com

Independently Owned and Operated / A Member of the Cushman & Wakefield Alliance

Cushman & Wakefield Copyright 2018. No warranty or representation, express or implied, is made to the accuracy or completeness of the information contained herein, and same is submitted subject to errors, omissions, change of price, rental or other conditions, withdrawal without notice, and to any special listing conditions imposed by the property owner(s). As applicable, we make no representation as to the condition of the property (or properties) in question.



Availability

Sale Price	\$2,100,000
Price PSF	\$139.58
Total Available	15,045 SF
Building Size	15,045 SF
Year Built	2002
Zoning	General Industrial (GI)
Total Site Area	0.7 AC
Date Available	October 2022

Property Highlights

Building Construction	Pre-engineered
Roof	Metal
Clearance Height	31'
Heat	Gas forced air
Drive-In Doors	1
Dock High Doors	3
Sprinkler System	No
Traffic Counts	46,800 EADT
Real Estate Taxes	\$16,725/year
Operating Expenses Total (Owner is self-insured)	\$2.05 NNN
Utilities	MUD: \$534/month OPPD: \$280/month

Independently Owned and Operated / A Member of the Cushman & Wakefield Alliance

Cushman & Wakefield Copyright 2018. No warranty or representation, express or implied, is made to the accuracy or completeness of the information contained herein, and same is submitted subject to errors, omissions, change of price, rental or other conditions, withdrawal without notice, and to any special listing conditions imposed by the property owner(s). As applicable, we make no representation as to the condition of the property (or properties) in question.

Floor Plan

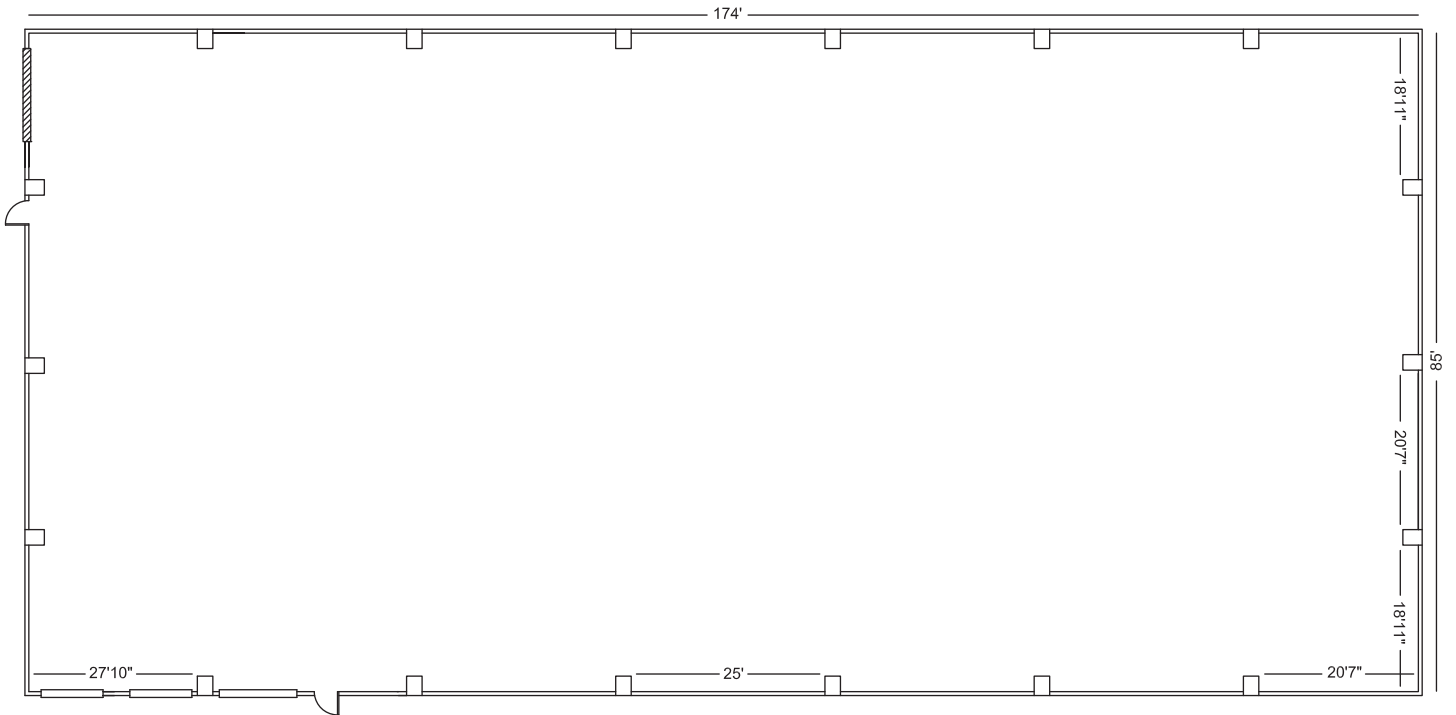

** Floor plan measurements are approximate and are for illustration purposes only.

