

## Industrial Space For Lease

58785 Executive Drive  
Mishawaka, Indiana 46544



**1 Suite Left! Available for Lease**



### Snapshot

Total Building:	30,720 SF
Available:	Suite 3 - 9,920 SF
Land:	2.25 Acres
Zoning:	I-Industrial
OH Door:	1 - 12' high
Dock:	1
Ceiling Height:	14' to 20'
Power:	480 Volt/3-Phase
Utilities:	Well & Septic
Lease Rate:	\$3.25 PSF NNN

### Property Details

Owner-occupied 30,720 SF multi-tenant industrial building located on the south side of Mishawaka has one suite available for lease. Area has one 12 FT overhead door, one dock, 480 Volt/3-Phase power, suspended gas heat, two restrooms, 14 FT ceilings in the warehouse area and 20 FT ceilings in the cold storage area. Warehouse is clear span. There is ample on-site parking, well and septic and it is zoned I-Industrial in the county. Rate includes CAM; tenant responsible only for janitorial and utilities.



4100 Edison Lakes Parkway, Suite 350  
Mishawaka, Indiana  
574.271.4060  
574.271.4292 Fax  
www.cressy.com

Global Brokerage Division of Cressy Commercial Real Estate

**TONY DAVEY**  
Senior Broker  
574.485.1536  
tdavey@cressy.com

Information furnished regarding property for sale, rental or financing is from sources deemed reliable. But no warranty or representation is made as to the accuracy thereof and same is submitted subject to errors, omissions, change of price, rental or other conditions, prior sale, leased, financing or withdrawal without notice. No liability of any kind is to be imposed on the broker herein.

# Industrial Space For Lease

58785 Executive Drive  
Mishawaka, Indiana 46544

## Floor Plan

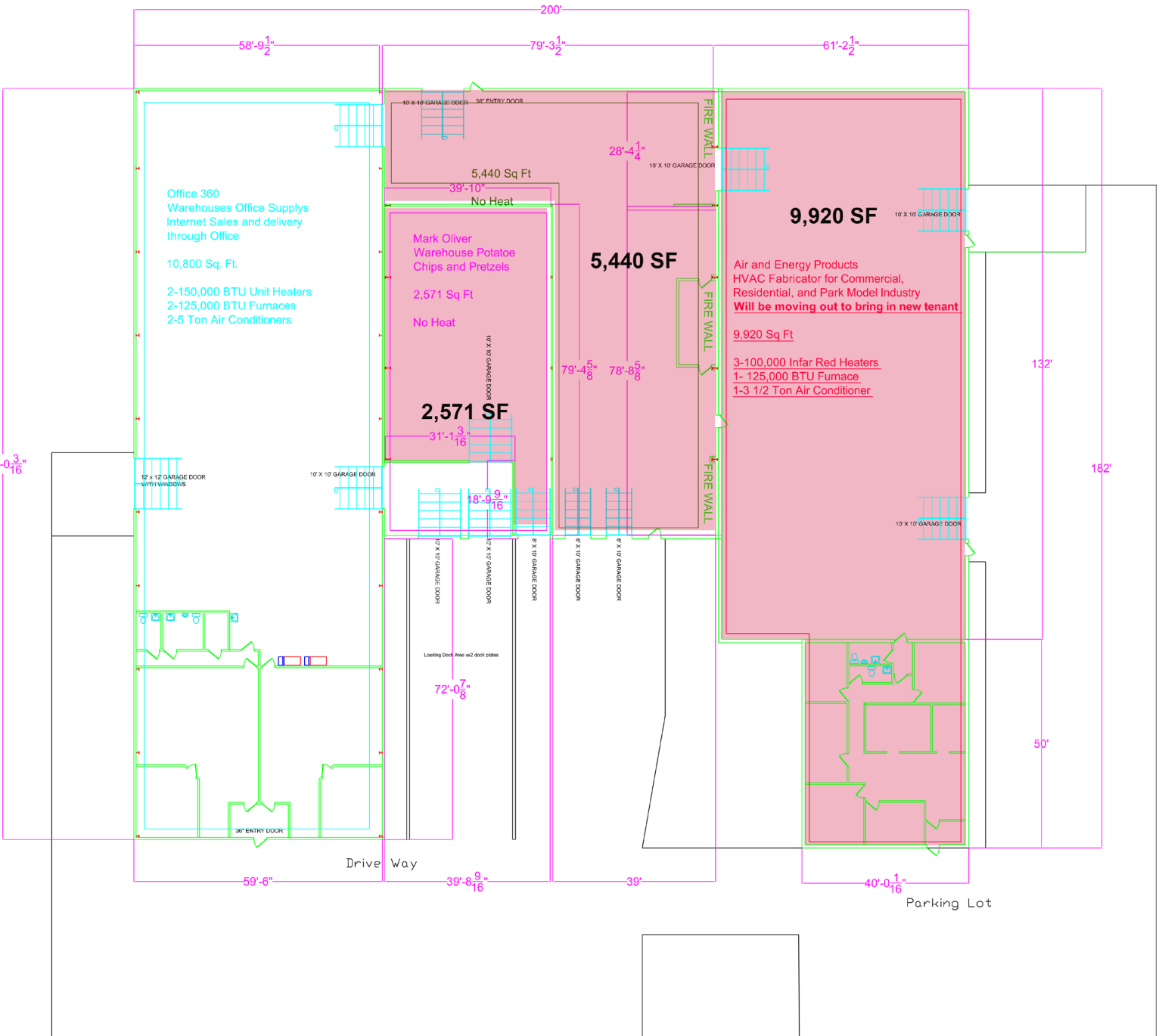

4100 Edison Lakes Parkway, Suite 350  
Mishawaka, Indiana  
574.271.4060  
574.271.4292 Fax  
www.cressy.com

**TONY DAVEY**  
Senior Broker  
574.485.1536  
tdavey@cressy.com

Global Brokerage Division of Cressy Commercial Real Estate

Information furnished regarding property for sale, rental or financing is from sources deemed reliable. But no warranty or representation is made as to the accuracy thereof and same is submitted subject to errors, omissions, change of price, rental or other conditions, prior sale, leased, financing or withdrawal without notice. No liability of any kind is to be imposed on the broker herein.

## Industrial Space For Lease

58785 Executive Drive

Mishawaka, Indiana 46544



COMMERCIAL REAL ESTATE SERVICES, WORLDWIDE

**Located Minutes From US 20/31 Bypass**

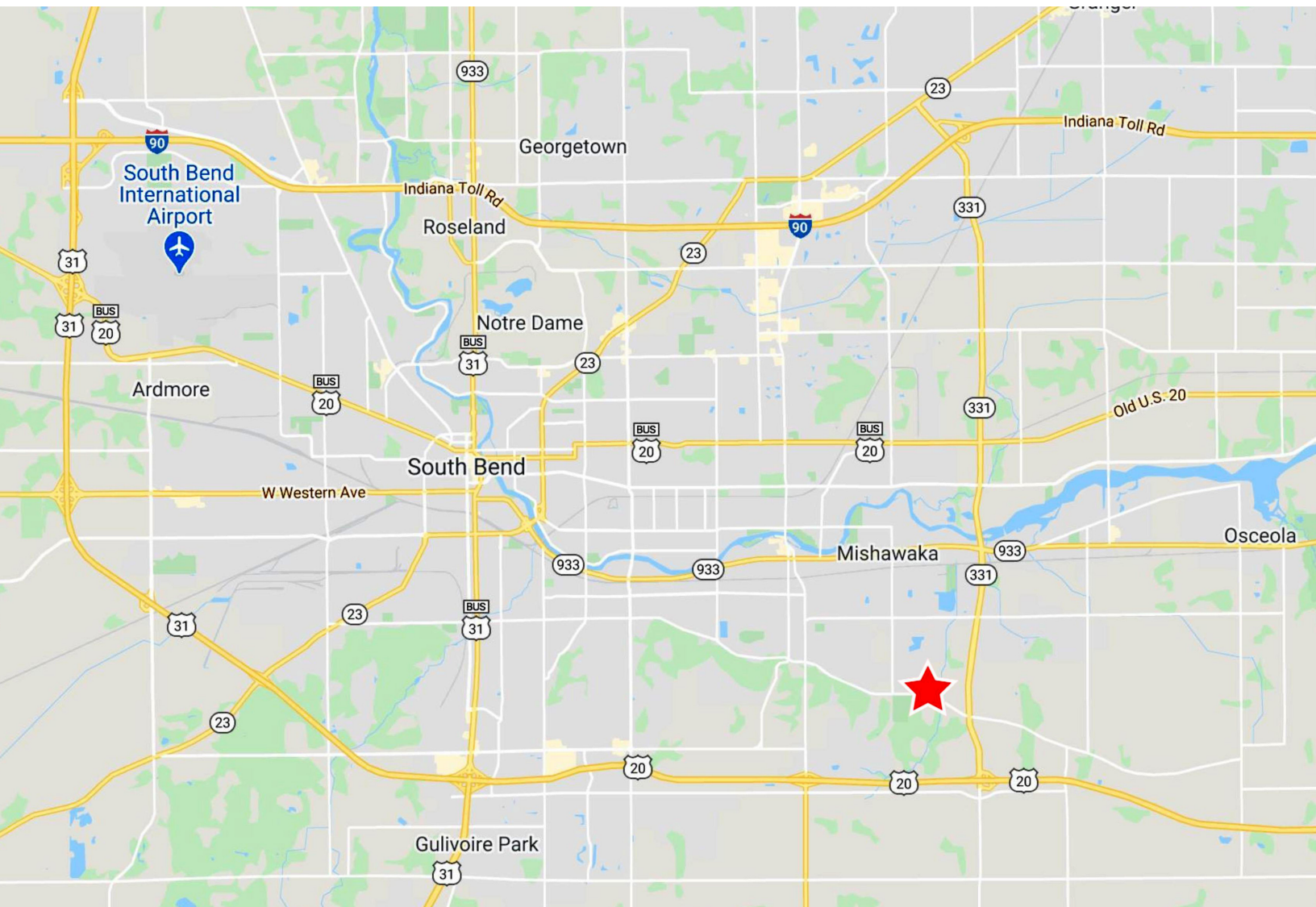

### Location

The property is located on the south side of Mishawaka minutes from the St. Joseph Valley Parkway (US 20/31 Bypass) and Capital Avenue that connects to the I-80/90 Toll Road on the North. It is located in the Traders Industrial Park, just north of Dragoon Trail.

4100 Edison Lakes Parkway, Suite 350  
Mishawaka, Indiana  
574.271.4060  
574.271.4292 Fax  
www.cressy.com

Global Brokerage Division of Cressy Commercial Real Estate

**TONY DAVEY**  
Senior Broker  
574.485.1536  
tdavey@cressy.com

Information furnished regarding property for sale, rental or financing is from sources deemed reliable. But no warranty or representation is made as to the accuracy thereof and same is submitted subject to errors, omissions, change of price, rental or other conditions, prior sale, leased, financing or withdrawal without notice. No liability of any kind is to be imposed on the broker herein.