

3321

BEE CAVES ROAD



OFFICE SPACE FOR LEASE

Jeff Henley | 512.413.5601 | jeffhenley@kuceraco.com

Jeffrey Henley, Jr. | 512.415.4066 | jhenley@kuceraco.com

7200 N. MOPAC EXPRESSWAY | AUSTIN, TX 78731 | (512) 346-0025 | **See all of our listings at WWW.KUCERACO.COM.**

All information contained herein, while based on information deemed reliable, has been gathered from various third-party sources, is not in any way warranted by The Kucera Companies, may not be entirely complete or accurate, and is subject to corrections, errors and/or omissions. This listing is subject to prior sale, lease, change in price and/or removal from the market without notice. The user of any information contained herein should conduct his/her own independent research including, without limitation, obtaining its own counsel and the advice of a real estate professional.

OFFICE SPACE FOR LEASE

- ▶ Downtown views
- ▶ Shared conference room, kitchen, and reception area
- ▶ Covered parking available

SUITE 200 | 3,138 RSF
\$8,000/MO FULL SERVICE

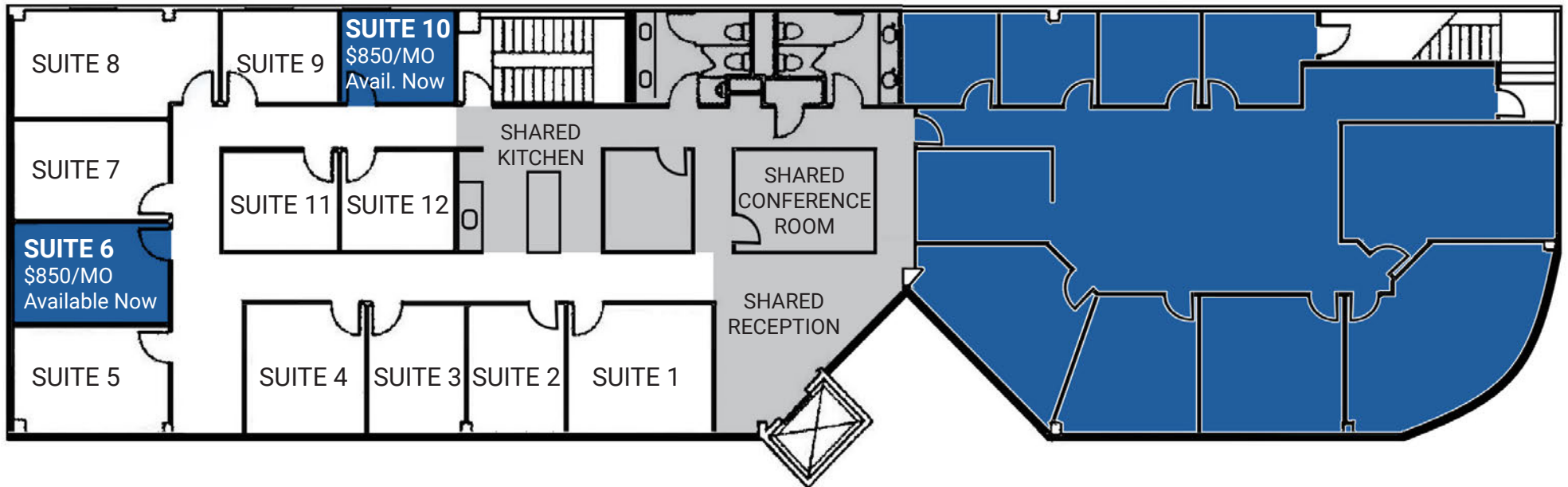

3321 BEE CAVES ROAD • AUSTIN, TX 78746

Jeff Henley | 512.413.5601 | jeffhenley@kuceraco.com

Jeffrey Henley, Jr. | 512.415.4066 | jhenley@kuceraco.com

7200 N. MOPAC EXPRESSWAY | AUSTIN, TX 78731 | (512) 346-0025 | See all of our listings at WWW.KUCERACO.COM.

All information contained herein, while based on information deemed reliable, has been gathered from various third-party sources, is not in any way warranted by The Kucera Companies, may not be entirely complete or accurate, and is subject to corrections, errors and/or omissions. This listing is subject to prior sale, lease, change in price and/or removal from the market without notice. The user of any information contained herein should conduct his/her own independent research including, without limitation, obtaining its own counsel and the advice of a real estate professional.

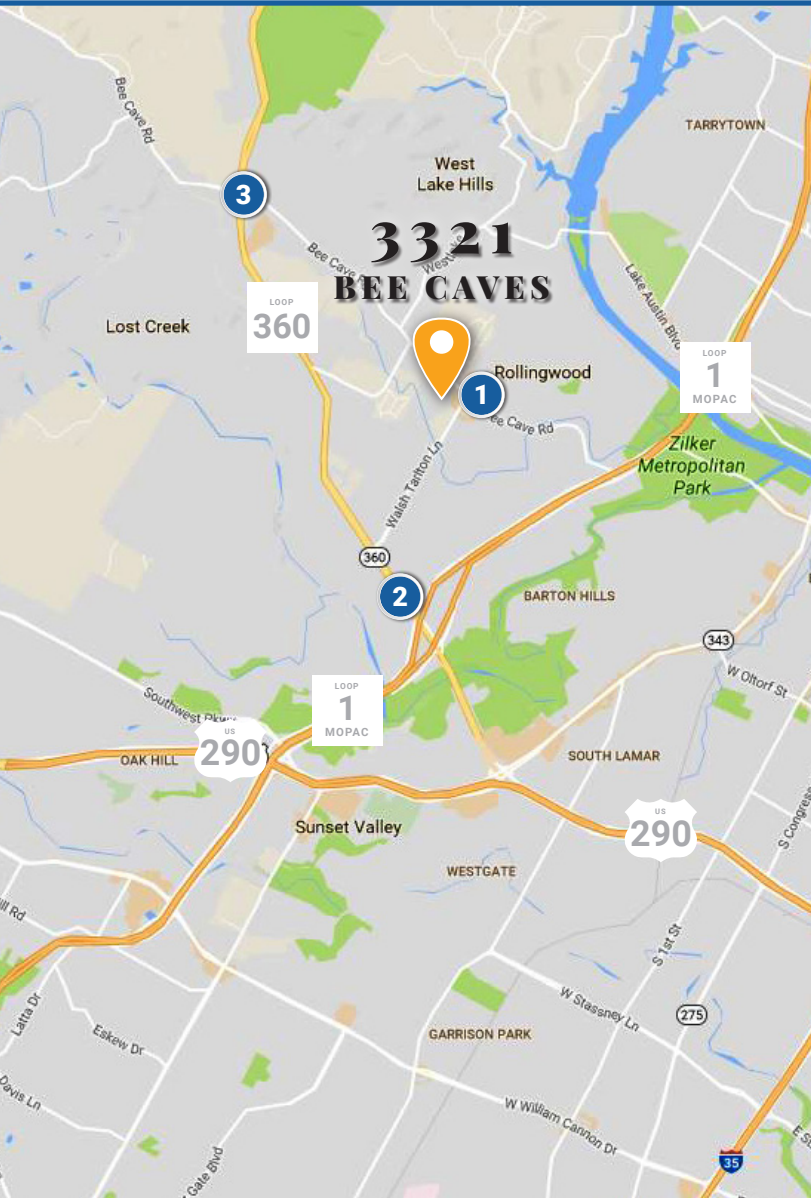

1 BEE CAVE & WALSH TARLETON

- STARBUCKS
- JASON'S DELI
- BRUEGGER'S BAGELS
- TACO BELL
- RAISING CANE'S
- TRIANON COFFEE
- THUNDERCLOUD SUBS
- CHIPOTLE MEXICAN GRILL
- PINKBERRY
- MCDONALD'S
- LAS PALOMAS
- BLUE DAHLIA BISTRO
- RANDALL'S
- FEDEX OFFICE
- BEEHIVE
- FRANCESCA'S
- TOMLINSON'S FEED
- AMERICAN BANK
- BB&T
- CHASE BANK
- BANK OF AMERICA
- R BANK
- 7-ELEVEN
- POST OFFICE
- ARISE AUSTIN MEDICAL CENTER

2 HWY. 360 & MOPAC

- MIDWAY FOOD PARK
- RUDY'S BBQ
- ABUELO'S
- SMOOTHIE'S PARADISE
- STARBUCKS
- EBAR
- BARTON CREEK FARMERS MARKET
- UNITED HERITAGE CREDIT UNION
- CHASE BANK
- SHELL
- BEE CAVE PEDIATRICS
- YOGA YOGA WESTLAKE
- AVIS CAR RENTAL
- BUDGET CAR RENTAL
- AMC BARTON CREEK SQUARE 14
- NORDSTROM
- MACY'S
- APPLE
- T-MOBILE
- SPRINT
- DILLARDS
- OLD NAVY

3 HWY. 360 & BEE CAVE ROAD

- COUNTY LINE BBQ
- THE GROVE WINE BAR & KITCHEN
- JIMMY JOHN'S
- STRANGE LAND BREWERY
- HAT CREEK BURGER COMPANY
- KERBEY LANE CAFE
- CHICK-FIL-A
- STARBUCKS
- LUPE TORTILLA
- TACO DELI
- P. TERRY'S BURGER STAND
- HEB GROCERY
- THE HOSPITAL AT WESTLAKE MEDICAL CTR.
- WELLS FARGO BANK
- CHASE BANK
- FROST BANK
- UFCU WESTLAKE
- CHEVRON
- TEXACO
- AT&T
- JOS. A. BANK

3321 BEE CAVES ROAD • AUSTIN, TX 78746

Jeff Henley | 512.413.5601 | jeffhenley@kuceraco.com

Jeffrey Henley, Jr. | 512.415.4066 | jhenley@kuceraco.com

7200 N. MOPAC EXPRESSWAY | AUSTIN, TX 78731 | (512) 346-0025 | See all of our listings at WWW.KUCERACO.COM.

All information contained herein, while based on information deemed reliable, has been gathered from various third-party sources, is not in any way warranted by The Kucera Companies, may not be entirely complete or accurate, and is subject to corrections, errors and/or omissions. This listing is subject to prior sale, lease, change in price and/or removal from the market without notice. The user of any information contained herein should conduct his/her own independent research including, without limitation, obtaining its own counsel and the advice of a real estate professional.