

40 LUXURY CONDOS

138 HOTEL UNITS



HOTEL INDIGO RETAIL

AT

THE
WATERFRONT
VANCOUVER • WASHINGTON

A QUALITY DEVELOPMENT BY:



1,026 - 3,477 SF RETAIL SPACE

SITUATED ON THE EAST SIDE OF THE NEW WATERFRONT VANCOUVER DEVELOPMENT:
138 HOTEL UNITS, 40 CONDOS AND SPACE FOR RETAIL • RESTAURANT • BAKERY/COFFEE

REAL ESTATE
INVESTMENT GROUP

2839 SW 2nd Avenue, Portland OR, 97201
503.222.1655 - www.REIG.com

George N. Diamond
503.222.2178
gdiamond@reig.com

Michelle D. Rozakis
503.222.1655
mrozakis@reig.com

Nicholas G. Diamond
503.222.2655
ndiamond@reig.com

Licensed in the
State of Washington
03.18.2019

Ground-Floor Retail Space for Lease

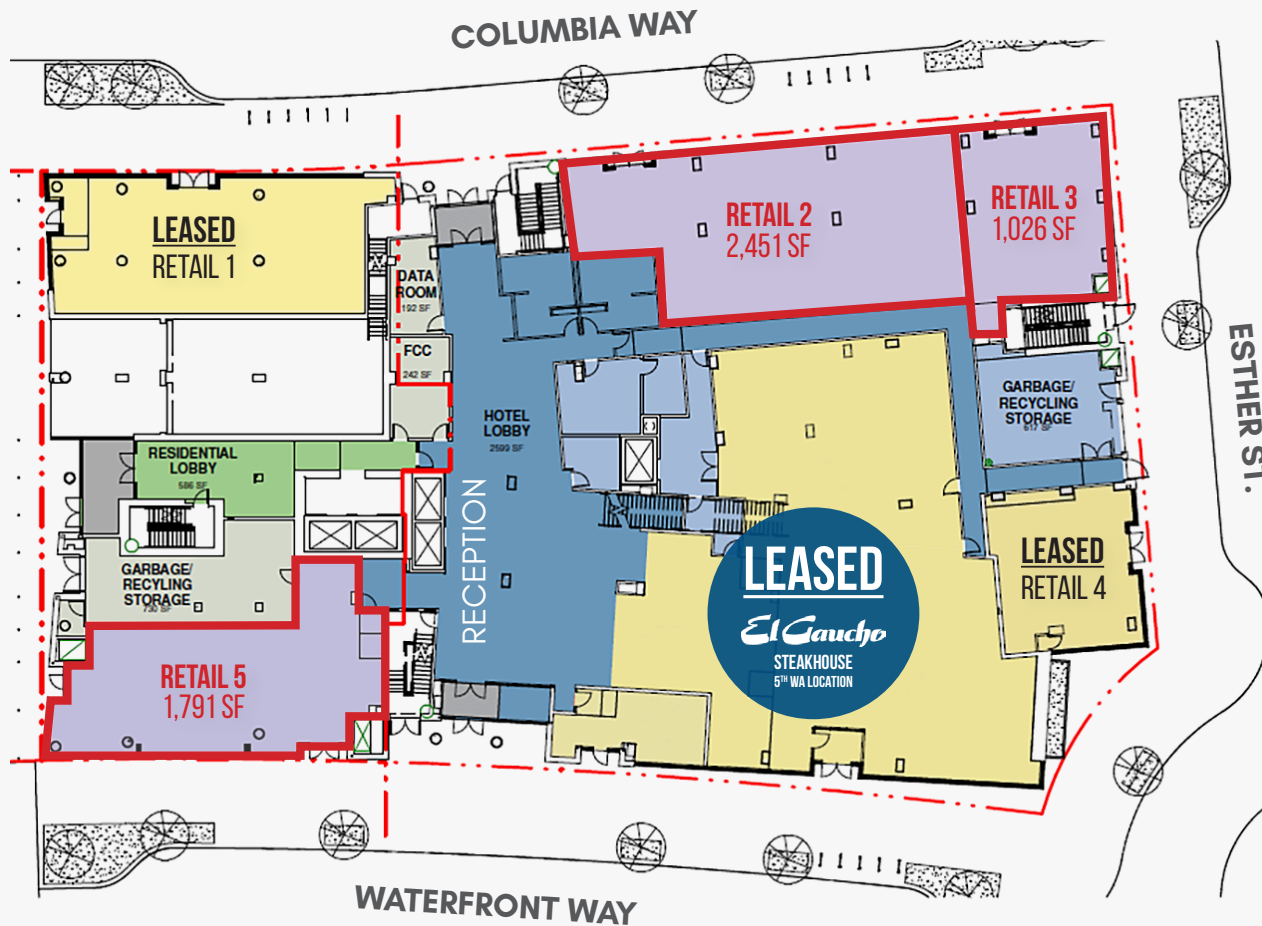

DELIVERING Q1 2020

RETAIL 1	1,791 SF	LEASED
RETAIL 2	2,451 SF	COMBINABLE
RETAIL 3	1,026 SF	
RETAIL 4	1,791 SF	LEASED
RETAIL 5	1,791 SF	
AVAILABLE: 5,268 SF		

HOTEL INDIGO RETAIL



RETAIL FRONTAGE ALONG ESTHER ST, COLUMBIA WAY & WATERFONT WAY

SEEKING BAKERY, COFFEE SHOP, RETAIL, RESTAURANT AND SPECIALTY USES

RETAIL 4
LEASED

RETAIL 3
1,026 SF

RETAIL 2
2,451 SF

RETAIL 1
LEASED

ESTHER STREET

COLUMBIA WAY

NORTHEAST PERSPECTIVE

THE WATERFRONT

VANCOUVER, WA

32 ACRES • \$1.5 BILLION
PHASE I DELIVERED FALL 2018

A stunning new development built around Grant Street Pier coupled with the picturesque Columbia River in the backdrop. A vibrant community designed to bring nature, work, and leisure together. Creative offices and chic abodes are steps away to upscale and exciting dining venues paired with a mixture of retail shops and boutiques.

Flagship restaurant buildings nestle behind the \$35 Million Waterfront Park complete with gorgeous riverfront views and professionally-designed landscaping and art installations - steps from Hotel Indigo and the Kirkland Tower Condominiums.

This is where work and life are in perfect balance.
This is the Vancouver Waterfront.

LIVE • SHOP • DINE • WORK • STAY • PLAY



THE
WATERFRONT
VANCOUVER • WASHINGTON



KIRKLAND TOWER
LUXURY CONDOMINIUMS

hotel
INDIGO

Waterfront Park

Grant Street
Pier

WildFin
AMERICAN GRILL

El Gaucho

twigs
BISTRO AND MARTINI BAR

Marshall



HOTEL INDIGO RETAIL



VIBE
-of-
VANCOUVER

Today's Vancouver, Washington area is a delightfully progressive and cosmopolitan Pacific Northwest center located at the junction of the Wilamette and Columbia Rivers.

From its humble beginnings processing forest products, Vancouver has evolved into a bustling center for the knowledge economy. Companies like HP, Intel, and Autodesk have offices in the area, known as the Silicon Forest, and continues to grow as more businesses continue to move to the area.

In 1997, the city of Vancouver decided to dedicate the next 15–20 years to redeveloping and revitalizing the downtown core, west of I-5 and south of Evergreen Boulevard. The first projects started in the early 2000s with the construction of many tall condominium structures around Esther Short park.



ESTHER SHORT PARK



VANCOUVER CITY HALL



VANCOUVER FARMERS MARKET



VANCOUVER, WASHINGTON CITY LIBRARY

COLUMBIA RIVER RENAISSANCE TRAIL



VANCOUVER CONVENTION CENTER



ESTHER SHORT PARK



PEARSON AIR FIELD

VANCOUVER WA
 PORTLAND OR
TRADE AREA

POPULATION	CLARK CO. WASHINGTON	MULTNOMAH CO. OREGON	WASHINGTON CO. OREGON
2010	425,363	735,332	529,712
2015	459,495	790,294	574,326
% Growth	8%	7.5%	8.4%

POPULATION BY RACE	CLARK CO. WASHINGTON	MULTNOMAH CO. OREGON	WASHINGTON CO. OREGON
White	80.5%	71.5%	67.6%
Black	2.2%	5.7%	2.2%
Asian	4.6%	7.2%	9.9%
Hispanic	8.7%	11.2%	16.3%
Other	4%	4.4%	4%

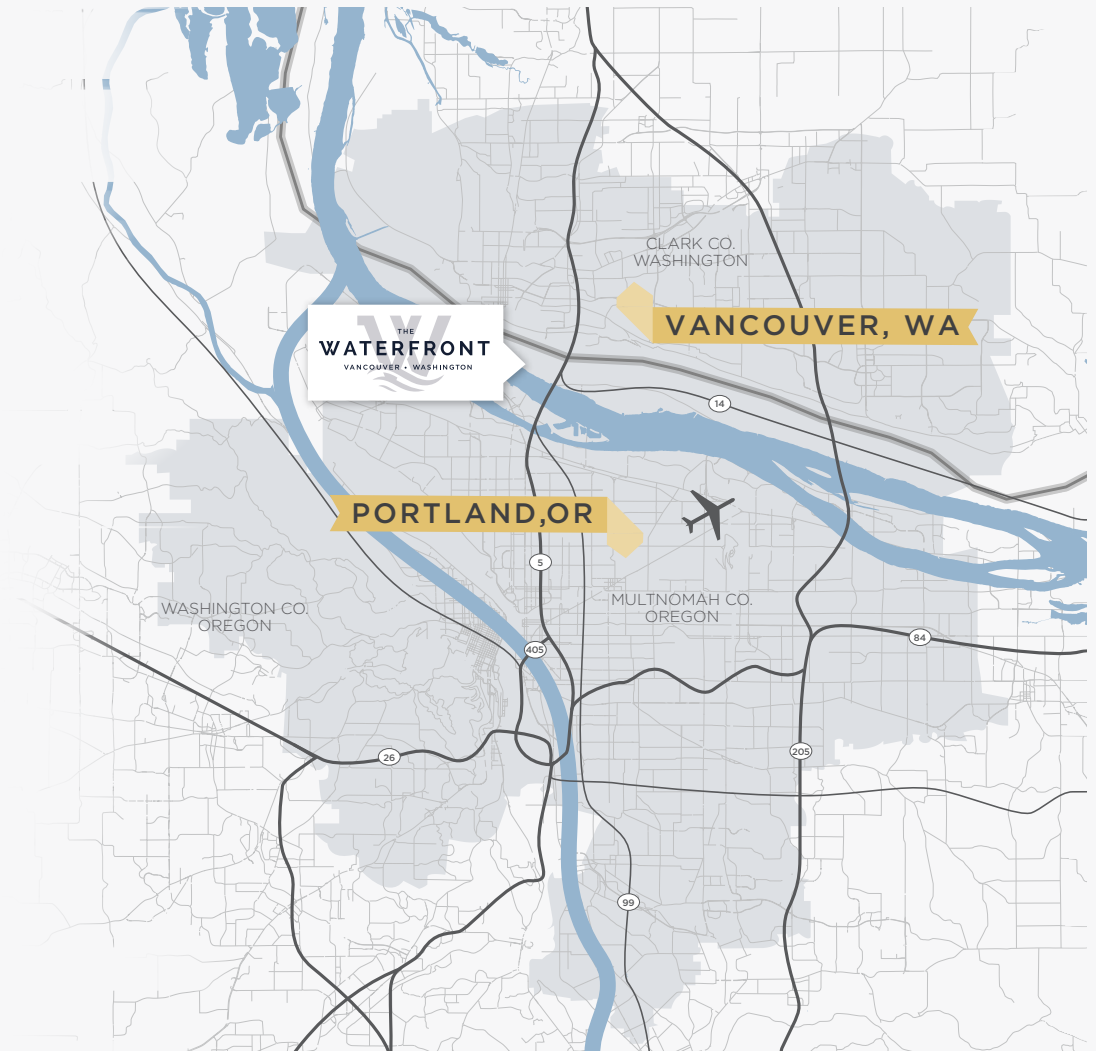

The Portland metro Area nears 2.4 million residents, growing by 41,000 last year. Newcomers continue to lead the way, with the region ranking 13th among US metro areas in the largest increase of new residents moving from elsewhere in the US. This continued growth demonstrates that our region is a desirable place to live and a competitive place to work.