

# RETAIL SPACE FOR LEASE: **PLATFORM 14**

1030 NE ORENCO STATION PKWY, HILLSBORO OR



## REAL ESTATE INVESTMENT GROUP

2839 SW 2nd Avenue  
Portland OR, 97201  
503.222.1655 (ph)  
503.274.6510 (fax)  
www.reig.com

Michelle D. Rozakis

503.222.1195  
mrozakis@reig.com

Nikki Diamond

503.946.1959  
nikki.diamond@reig.com

Licensed in the  
State of Oregon

## **ONE RETAIL/SERVICE SPACE LEFT AT PLATFORM 14!**

**1,466 SF** \$1,995 per Month, Modified Gross

### Property Features:

- Current Tenants Include: Allstate Insurance, Salam Restaurant, Orenco Taphouse, Salon 14, Ether & Stone Yoga, The Ridge Chiropractic Wellness Clinic, American Pacific Mortgage, Fitness Prometheus, Nova Process Insight
- 16,328 SF of Commercial Space + 166 Traditional Apts and 11 Live/Work Units

### Location Features:

- Close to Orenco Station and New Season's Market
- Located along Trimet MAX Line
- Located in Hillsboro, One of Oregon's Fastest Growing Cities
- Within .5 Mile of Intel Ronler Acres Campus

## REAL ESTATE INVESTMENT GROUP

02.18.2019

# RETAIL SPACE FOR LEASE: PLATFORM 14

1030 NE ORENCO STATION PKWY, HILLSBORO OR

**REAL ESTATE INVESTMENT GROUP**

2839 SW 2nd Avenue  
Portland OR, 97201  
503.222.1655 (ph)  
503.274.6510 (fax)  
www.reig.com

Michelle D. Rozakis  
503.222.1195  
mrozakis@reig.com

Nikki Diamond  
503.946.1959  
nikki.diamond@reig.com

Licensed in the State of Oregon

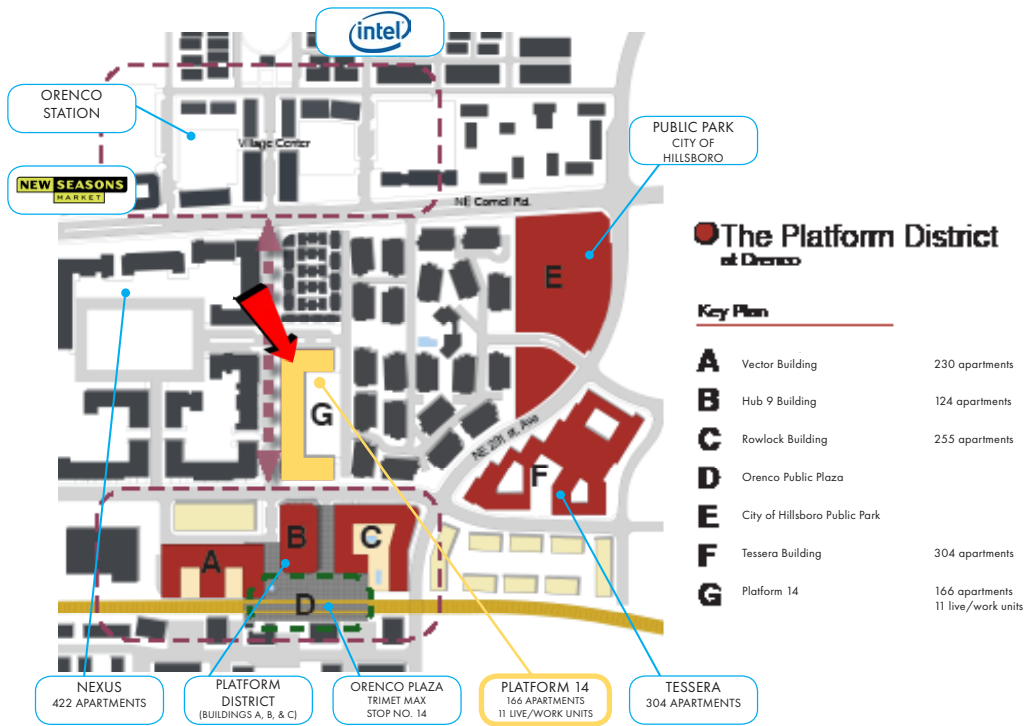

# RETAIL SPACE FOR LEASE: PLATFORM 14

1030 NE ORENCO STATION PKWY, HILLSBORO OR

**REAL ESTATE INVESTMENT GROUP**

2839 SW 2nd Avenue  
Portland OR, 97201  
503.222.1655 (ph)  
503.274.6510 (fax)  
www.reig.com

Michelle D. Rozakis  
503.222.1195  
mrozakis@reig.com

Nikki Diamond  
503.946.1959  
nikki.diamond@reig.com

Licensed in the  
State of Oregon

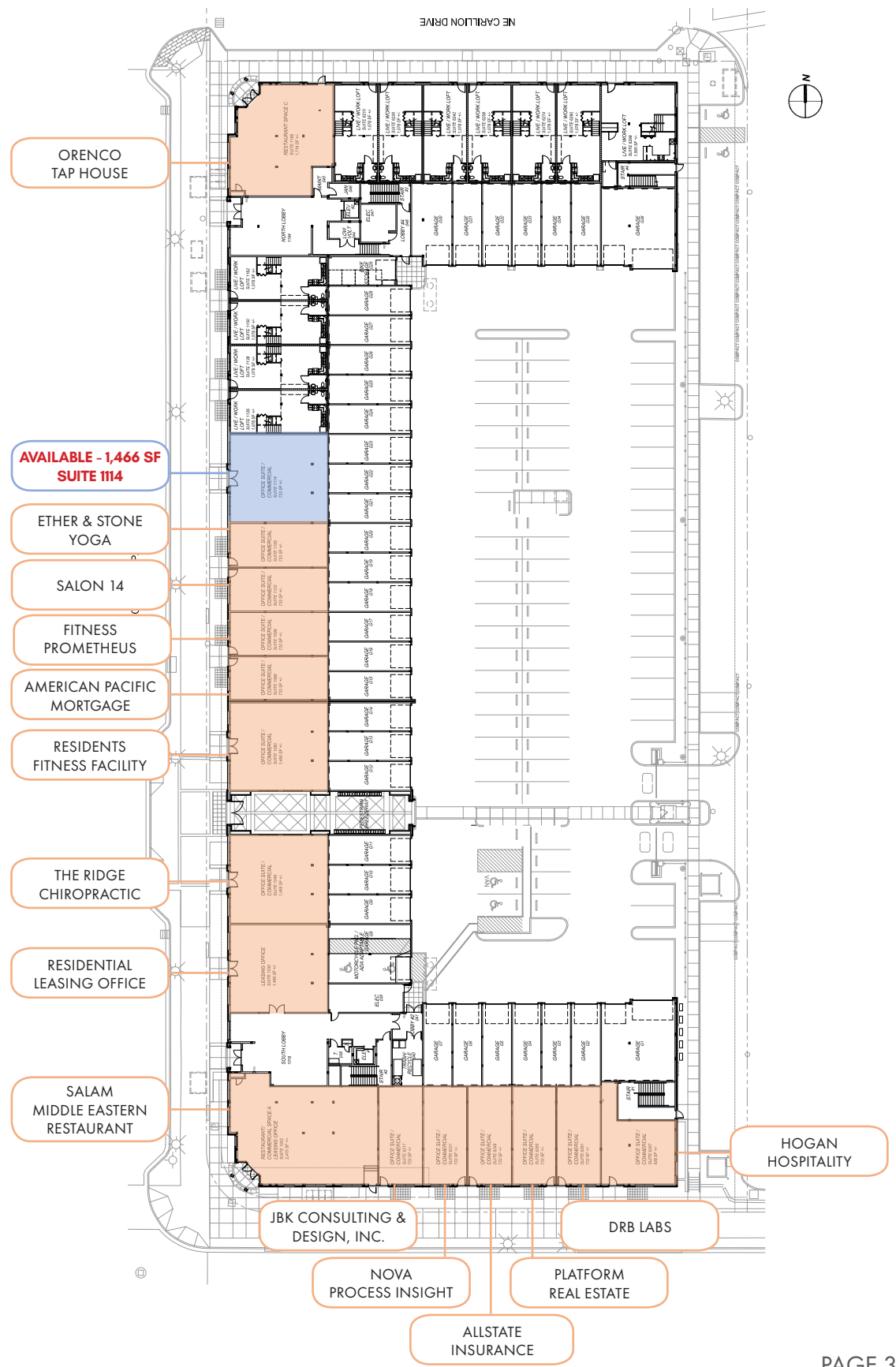
The information contained herein has been obtained from sources we deem reliable. We cannot, however, guarantee its accuracy.

# RETAIL SPACE FOR LEASE: PLATFORM 14

1030 NE ORENCO STATION PKWY, HILLSBORO OR



Platform District		1 mi radius	3 mi radius	5 mi radius
<b>Hillsboro, OR 97124-7015</b>				
2017 Estimated Population		15,439	119,989	241,843
2022 Projected Population		16,919	131,284	264,660
2010 Census Population		11,058	104,351	212,441
2000 Census Population		4,992	84,661	171,548
Projected Annual Growth 2017 to 2022		1.9%	1.9%	1.9%
Historical Annual Growth 2000 to 2017		12.3%	2.5%	2.4%
2017 Est. HH Income Under \$15,000		6.2%	5.9%	6.2%
2017 Est. Average Household Income		\$96,160	\$83,457	\$87,367
2017 Est. Median Household Income		\$92,710	\$76,987	\$80,362
2017 Est. Per Capita Income		\$43,050	\$31,380	\$32,155
2017 Est. Total Businesses		560	3,527	7,170
2017 Est. Total Employees		13,031	47,241	92,234

Demographic Information, Traffic Counts, and Merchant Locations are Provided by REGIS Online at SitesUSA.com \*

