

**FOR
LEASE**

**FREE
GARAGE PARKING
FOR CLIENTS
& CUSTOMERS**

**RETAIL / OFFICE
STOREFRONT
OPPORTUNITY**

- on -

**BURNSIDE
INNER NE
PORTLAND**

WELCOME Sharetea TO LINDEN!
E BURNSIDE ST - 23,000 VPD

**REAL ESTATE
INVESTMENT GROUP**
2839 SW 2nd Avenue
Portland OR, 97201
503.222.1655
www.reig.com

1250 E. BURNSIDE ST, PORTLAND OR:
LINDEN STOREFRONT SPACE

Michelle D. Rozakis
503.222.1195
mrozakis@reig.com

NEW RETAIL / OFFICE / SERVICE SPACE
1,750 SF @ \$25/SF/YR + NNN (GENERAL RETAIL / SERVICE)

Property Features:

- Retail / Office / Service Space in Mixed-Use Building at Major Intersection
- 132-Unit Mixed-Use Apartment Building - Inline and Corner Storefront Spaces
- Free Garage Parking Available for Retail Tenants

View Site Location
 Google Maps

Location Features:

- Intersection of E. Burnside St & Sandy Blvd
- Walking Distance to Shops, Restaurants and Amenities
- TriMet Transit Access and Over 23,000 VPD Along E Burnside St.
- Nearby Retailers Include New Life Nails, Natian Brewery, Noble Rot, Doug Fir Lounge, Voodoo Doughnut, Portland Rock Gym, Old Town Music, Columbia Art & Drafting Mt. Tabor Brewing, Lemongrass, Sizzle Pie, Triumph Coffee, Bantam Bicycle Works, The Circuit Bouldering Gym & Many More

**REAL ESTATE
INVESTMENT GROUP**

GROUND-FLOOR RETAIL / OFFICE / SERVICE SPACE

LINDEN STOREFRONT SPACE

1250 E. BURNSIDE ST, PORTLAND OR

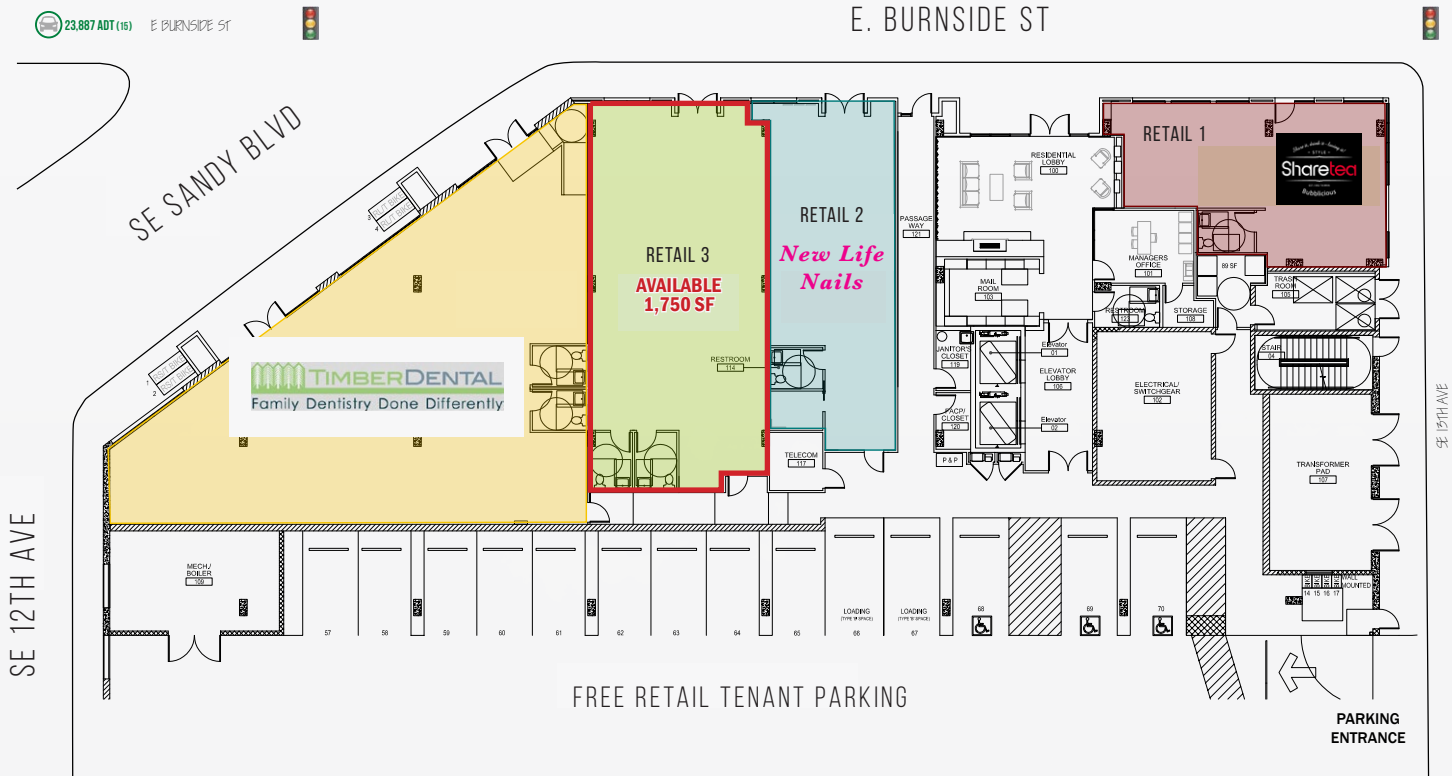

RETAIL 3 - 1,750 SF

- SERVICE**
- FITNESS**
- BAKERY**
- BEAUTY**
- MEDICAL**
- COFFEE**
- BEER/WINE**

GROUND FLOOR SPACE - MIXED-USE BUILDING

GROUND-FLOOR RETAIL / OFFICE / SERVICE SPACE

LINDEN STOREFRONT SPACE

1250 E. BURNSIDE ST, PORTLAND OR



GROUND FLOOR SPACE - MIXED-USE BUILDING

GROUND-FLOOR RETAIL / OFFICE / SERVICE SPACE

LINDEN STOREFRONT SPACE

1250 E. BURNSIDE ST, PORTLAND OR

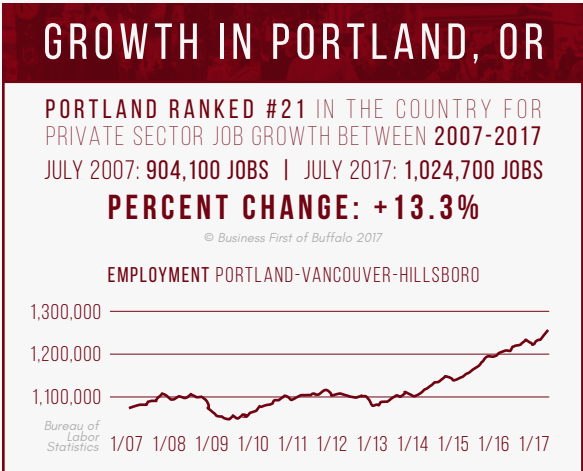

1250 E. Burnside St Portland, OR 97232		1 mi radius	3 mi radius	5 mi radius
AREA DEMOGRAPHICS	2017 Estimated Population	27,843	231,953	445,340
	2022 Projected Population	29,947	248,938	477,126
	2010 Census Population	22,918	200,735	398,491
	2000 Census Population	21,552	183,663	371,731
	Projected Annual Growth 2017 to 2022	1.5%	1.5%	1.4%
	Historical Annual Growth 2000 to 2017	1.7%	1.5%	1.2%
	2017 Est. HH Income Under \$15,000	12.1%	11.6%	10.4%
	2017 Est. Average Household Income	\$69,281	\$97,759	\$96,486
	2017 Est. Median Household Income	\$56,179	\$74,568	\$74,263
	2017 Est. Per Capita Income	\$39,076	\$48,912	\$43,972
2017 Est. Total Businesses	4,457	24,563	33,900	
2017 Est. Total Employees	47,150	281,859	375,215	

**Demographic Information, Traffic Counts, and Merchant Locations are Provided by REGIS Online at SitesUSA.com*

