



Installation Instructions

ROXOR Hardtop Instructions

Part Numbers
0101DUA00011N

▲WARNING

- To protect bystanders and the service technician(s), shut vehicle off, remove the key, place the vehicle in gear and apply the parking brake to prevent the vehicle from rolling.
- Do not attempt this procedure if you do not have proper tools and ROXOR training.

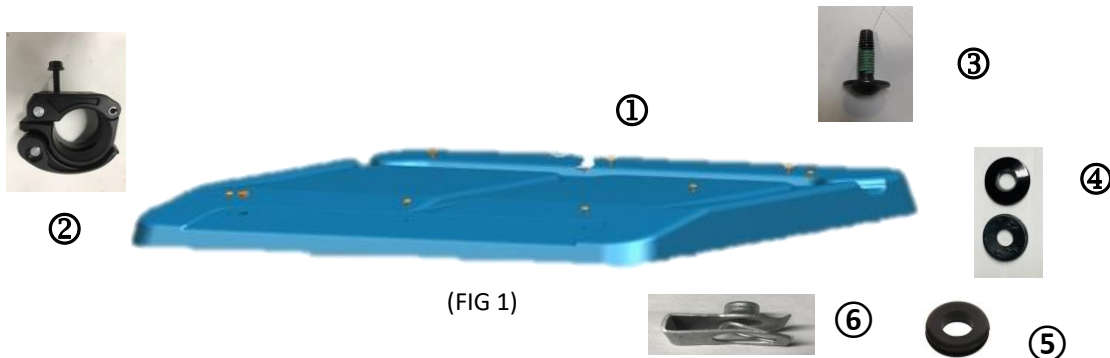

①	Qty. (1)	Hard Top	④	Qty. (10)	20mm OD x 6mm ID Rubberized Seal
②	Qty. (10)	Cam Clamps	⑤	Qty. (1)	25mm OD. Rubber Grommet
③	Qty. (10)	6mm Torx bolts	⑥	Qty. (1)	6 mm U-Clip
			⑦	Qty. (1)	Windshield Support Bracket

Tools Required

Safety Eyewear



Torque wrench

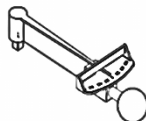

M6 Torx bolt ¼" PH-3 driver & ratchet

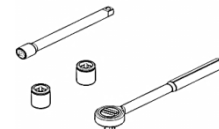

**Tighten all fasteners with a torque wrench to:
M6 bolts 7.5 ± 1 N•m (66 ± 9 lbf•in)**

▲WARNING

Make sure all fasteners are torqued and properly tightened. Failure to do so could result in dislodged hitch and/or loss of control of the vehicle.

© 2018 Mahindra Vehicle Sales and Service, Inc	Sheet 1 of 3	09/04/2018	0003AUA00610N	All Rights Reserved ROXOR is a registered trademark of Mahindra Vehicle Sales and Service, Inc.
--	--------------	------------	---------------	--



Installation Instructions

ROXOR Hardtop Instructions

Part Numbers
0101DUA00011N

⚠WARNING

- To protect bystanders and the service technician(s), shut vehicle off, remove the key, place the vehicle in gear and apply the parking brake to prevent the vehicle from rolling.
- Do not attempt this procedure if you do not have proper tools and ROXOR training.

⚠WARNING

- To protect bystanders and the service technician(s), shut vehicle off, remove the key, place the vehicle in gear and apply the parking brake to prevent the vehicle from rolling.
1. Loosely Install the (10) cam clamps around the upper ROPS tube bar, two on each side, three along the rear ROPS tube, and three along the front ROPS Tube. Set the hardtop on top of the ROPS bars and align the holes in the hardtop with the attaching holes in the cam clamps. Now hand tighten the (10) 6mm torx and rubber seal to the side, rear and front cam clamps. Once everything is aligned and centered, torque the (10) 6mm bolts to torque spec $7.5 \pm 1 \text{ N}\cdot\text{m}$ ($66 \pm 9 \text{ lbf}\cdot\text{in}$) as indicated on page one. Insert the 25 mm OD rubber grommet and you are done.

Tighten fasteners to specification using torque wrench (See torque specs. at bottom of first page).

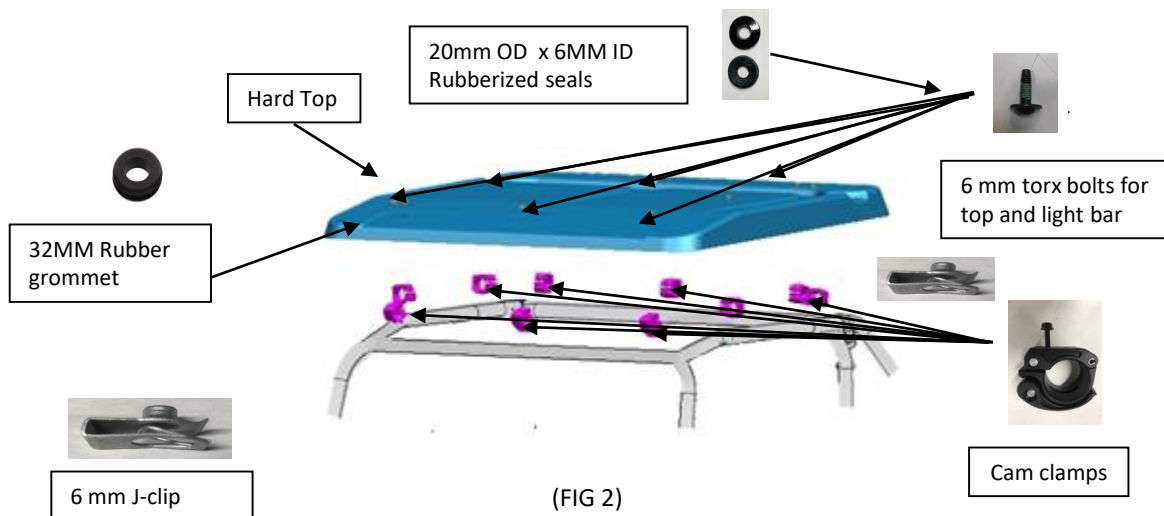

⚠WARNING

Make sure all fasteners are torqued and properly tightened. Failure to do so could result in dislodged hitch and/or loss of control of the vehicle.

© 2018 Mahindra Vehicle Sales and Service, Inc	Sheet 2 of 3	09/04/2018	0003AUA00610N	All Rights Reserved ROXOR is a registered trademark of Mahindra Vehicle Sales and Service, Inc.
--	--------------	------------	---------------	--

Hardtop Installation with Windshield

If your ROXOR has the windshield option you will have to install the center windshield support bracket (see Fig. 3 below). Attach the 6mm J-Clip to the bracket in (Fig 3) take the 6mm torx bolt and attach the support bracket to the center windshield frame hole, torque (**M6** bolts to $7.5 \pm 1 \text{ N}\cdot\text{m}$)

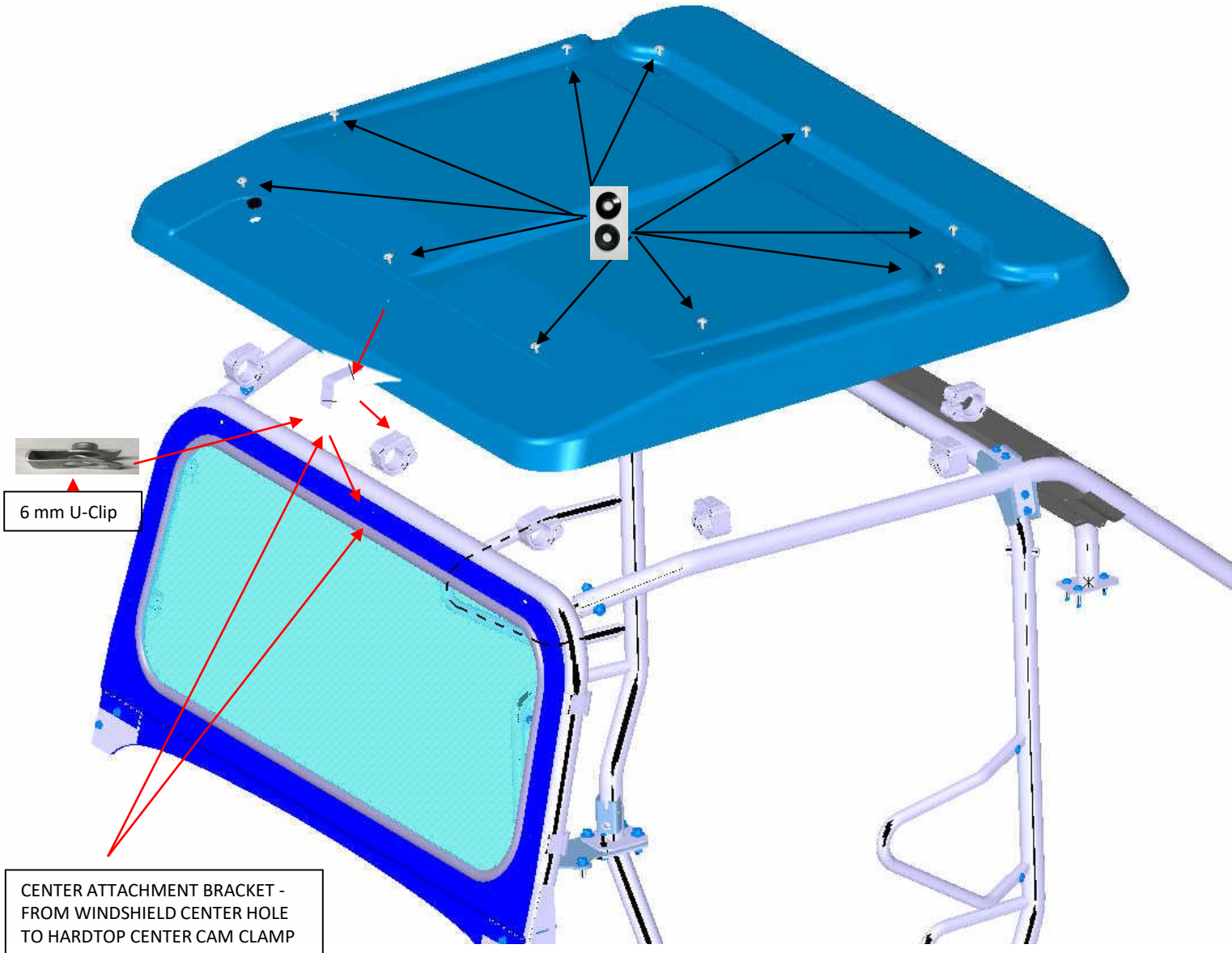

(FIG 3)