

# Shore Ramp PWC-50 (and PWC-SU)

## Assembly & Use Instructions

Lakeside Recreation LLC

[www.lakesiderecreation.com](http://www.lakesiderecreation.com)

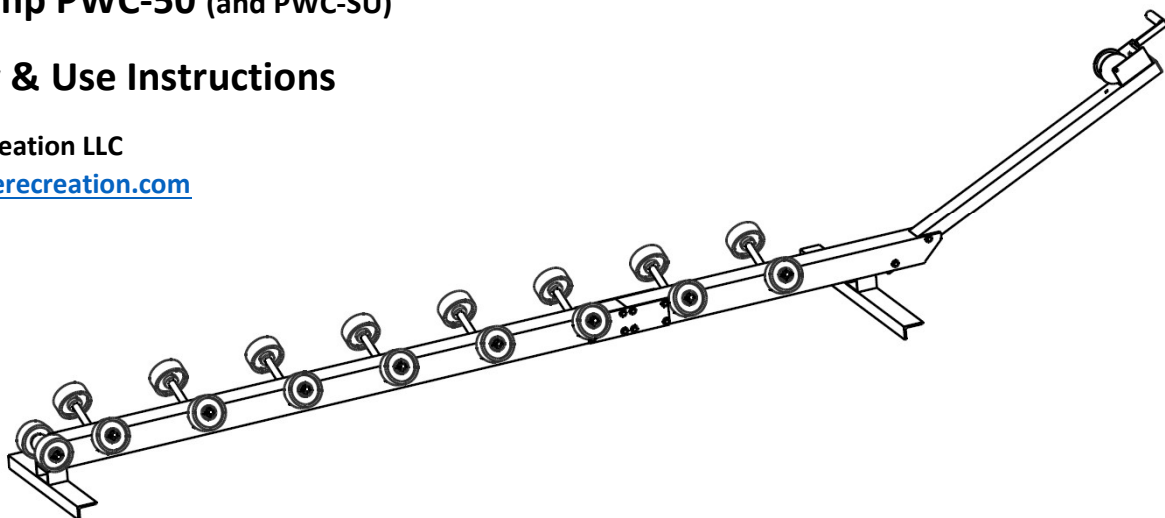

### IMPORTANT NOTE ABOUT STAINLESS FASTENERS

Stainless fasteners may gall and seize up (cold weld) if assembled without lubrication. Be sure to apply a dab of the supplied anti-seize compound to the threads of each stainless bolt prior to assembling the nut.

### Assembly

Note: If adding the Extension Kit, consult those instructions before beginning assembly.

1. Unpack the box and confirm that all the parts are present according to the parts list.
2. Lay the Keel Beam and Front Beam on a flat surface end to end, with the bottom access openings facing up. Assemble them together using the 2 Connector Plates, and 16 sets of 1.00" 3/8-16 bolts, washers, and nuts. Get all the bolts inserted and the nuts started before tightening any of them. Tighten all 16 sets of fasteners firmly.

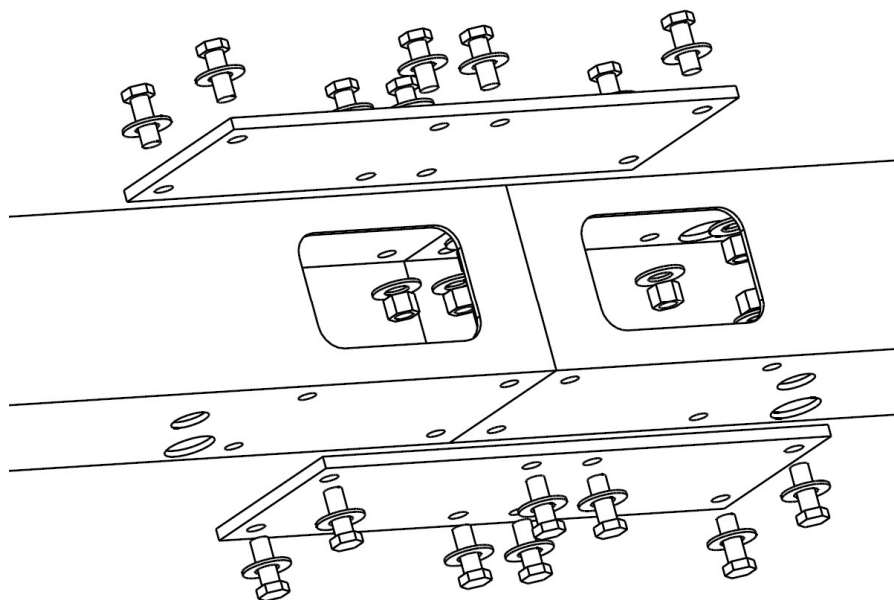

3. Assemble the 24" Rear Foot and Spacer to the Keel Beam using 2 sets of 3.25" 3/8-16 bolts, washer, and nuts.

4. Assemble the 36" Front Foot and Spacer to the Front Beam using 2 sets of 3.25" 3/8-16 bolts, washers, and nuts.

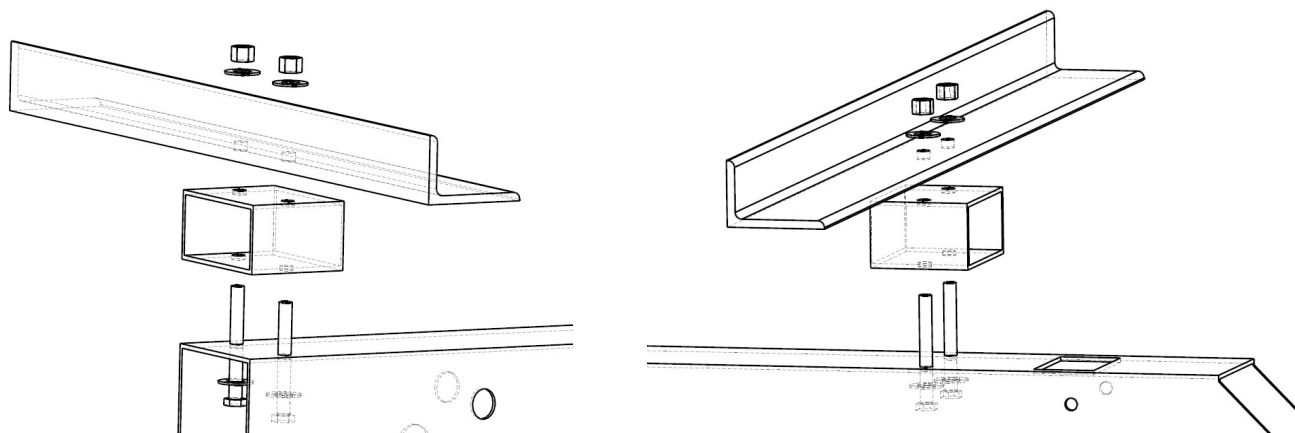

5. Assemble the rear set of 2 Wheels using the Short Axle through the Keel Beam with the 2.5" Roller in the center. After placing two 3/4" washers on the outboard side of the wheels, secure by inserting the cotter pins and bending.

6. Assemble the 16 Axle Shafts to the Keel Beam and Front Beam by sliding them through the 1" dia. holes on each side with the short 3/4" dia. section protruding out the other side. Secure by inserting the cotter pins and bending.

7. Slide 16 Wheels onto the Axle Shafts. Secure by inserting the cotter pins and bending.

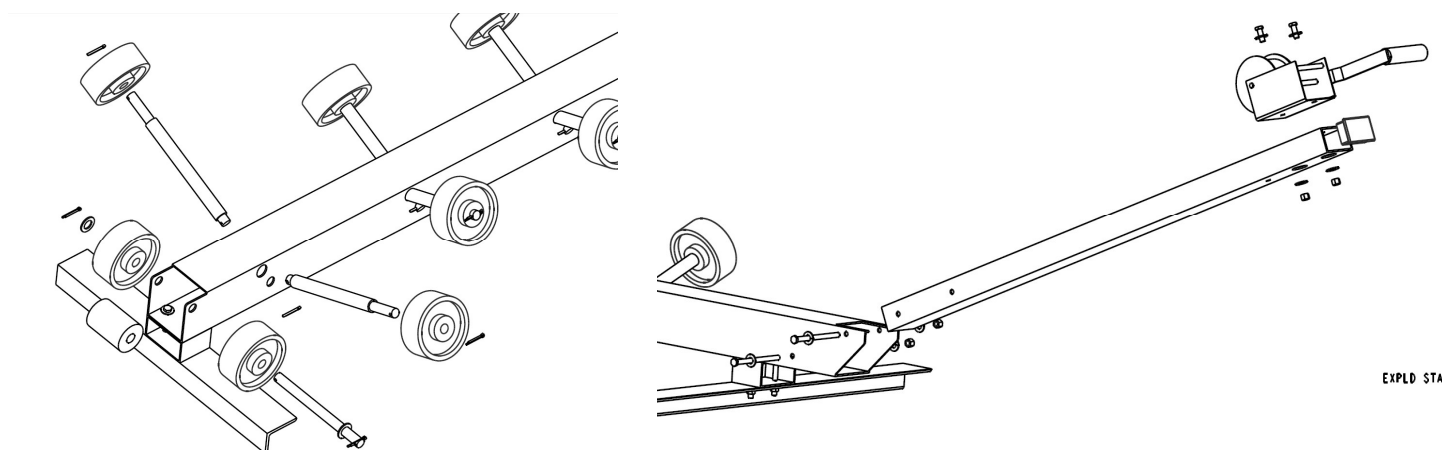

8. Assemble the Winch Strut to the Front Beam by inserting it into the front notch and aligning the holes. Aligning the holes in the two parts and inserting the 5.0" long 3/8-16 bolts may take some "persuasion". Do not tighten either bolt until both are inserted fully. Tighten lightly to avoid crushing the Front Beam tube.

9. Assemble the Winch to the Winch Strut using 2 sets of 1.00" long 3/8-16 bolts, washers, and nuts. It may be helpful to unwind some of the strap from the winch to access the bolts during assembly. Assemble the Handle to the Winch.

10. Insert the Cap Plug into the Winch Strut and tap into place.

## **Installation**

The Shore Ramp PWC-50 is intended for the storage of personal watercraft on gently sloping firm sand, soil, or turf.

Place the Shore Ramp with the Rear Foot just in the water so that the rear set of rollers is just submerged. This should allow the watercraft to be easily floated up to the first rollers and then winched up and onto the ramp. Some experimentation and adjustment may be required to determine the optimal location.

The edge of the Rear Foot of the Shore Ramp must be firmly embedded into the lakebed to prevent any back-sliding. The Front Foot must be supported on firm soil, level across its entire width to prevent any side tipping.

**CAUTION: Do not use the PWC ramp on loose rock or any unstable ground where it may slide down or tip to the side.**

## **Loading a watercraft onto the Shore Ramp:**

Manually unwind the strap until the hook can reach a couple of feet past the end of the ramp.

Float the watercraft by hand to the front of the ramp. Attach the winch strap to the bow loop.

Engage the winch control such that it is ratcheting in the wind-up direction.

Wind the winch, pulling the front of the watercraft to the first set of rollers. Guide the watercraft so that it remains centered and aligned with the ramp (in windy conditions this may be easier with two people).

As the watercraft comes up and over the first roller, confirm the watercraft is not rubbing on the Shore Ramp.

Wind the winch until the watercraft is pulled all the way up the ramp.

**IMPORTANT: Do not operate your watercraft in the shallows or attempt to power it up the ramp as the PWC's impeller will be damaged by sand and rocks pulled in from the bottom. Always float your watercraft to and from deeper water by hand. Consult your PWC owner's manual for the minimum safe operating depth.**

**IMPORTANT: Always ensure the winch ratchet is engaged to hold the load before releasing the handle.**

**CAUTION: Do not exceed the weight and size capacity of the Shore Ramp PWC-50 (1200 lbs or 54" wide).**

**CAUTION: Do not use the Shore Ramp if any part of the ramp, winch, or winch strap is damaged, worn, or malfunctioning.**

## **Launching a watercraft from the Shore Ramp:**

Take up the load on the winch by grasping the handle.

While staying in control of the load, disengage the ratchet control to allow the winch to unwind.

Slowly unwind the winch, staying at all times in control of the load by firm hold of the winch handle.

When the watercraft is completely off the ramp and floating in the water with slack in the strap, unhook the strap.

Float your watercraft by hand to the minimum safe operating depth before starting the engine.

**CAUTION: Should the winch handle be released under load, keep clear of the rapidly spinning handle. Although not ideal, it is safest to then just allow the winch to unwind until the PWC comes to rest in the water.**

## Parts List

Part Number	Qty	Description
100001	18	Wheel, 5 x 2 Polyolefin
100002	1	Which with Strap
200015_A	1	Keel Beam M4
200016_A	1	Front Beam M4
200017_A	2	Connector Plate M4
200010_F	16	Axle Shaft (200020_A Axle Shaft 11.50 for PWC-SU)
200003_C	1	Front Foot
200005_C	1	Rear Foot
200006_B	2	Spacer
200018_D	1	Winch Strut M4
200011_B	1	Short Axle Shaft
600002	1	Roller, 2.5 x 3.75, Rubber
300022	1	Cap-Plug 2.00 x 3.00
300001	34	Cotter Pin, 5/32 x 1.25 Stainless
300005	4	Bolt, 3/8-16 x 3.25 Stainless
300018	2	Bolt, 3/8-16 x 5.0 Stainless
300007	18	Bolt, 3/8-16 x 1.00 Stainless
300008	24	Nut 3/8-16 Nylock, Stainless, Waxed
300009	48	Washer 3/8 Stainless
300013	2	Washer ¾ AN Stainless
300021	1	Anti-Seize Packet
300014_A	1	Nameplate PWC-50 (affixed to Winch Strut)
400005	1	Instructions for Shore Ramp PWC-50 M4, Printed
400004	1	Label for Box for Shore Ramp PWC-50 M4, Printed
300023	1	Shipping Box M4

## One Year Limited Warranty

LAKESIDE RECREATION products are warranted to be free from defects in materials or workmanship for one (1) year from the date of purchase. Within this period we will provide a replacement for any component that fails in normal use. Such replacement will be made at no charge to you, provided that you shall be responsible for any shipping charges and labor for replacement of the component. Replacement products or components may be new or refurbished at the sole discretion of LAKESIDE RECREATION.

This warranty does not apply to: (a) cosmetic condition, such as (but not limited to) scratches, markings, discoloration, nicks, dirt, oil, stains, surface corrosion, and dents; (b) damage or loss caused by accident, abuse, misuse, or other acts of nature or external causes; (c) damage or failure due to improper assembly, improper installation, overloading beyond rated capacity, or use for purposes not intended; (d) damage to a product resulting from modification or alteration. Determination of defects in material or workmanship which are covered under this warranty shall be at the sole discretion of LAKESIDE RECREATION.

To make a warranty claim, contact LAKESIDE RECREATION via the warranty claim link on [www.lakesiderecreation.com](http://www.lakesiderecreation.com) and provide a description of the failed component and your contact and shipping information. LAKESIDE RECREATION at its sole discretion may require photographic documentation of the failed component; require the failed component to be returned for inspection; and/or require the failed component to be returned in exchange for the replacement component. Returned components shall become the property of LAKESIDE RECREATION when a replacement component is provided. Please do not return any products or components without prior authorization. LAKESIDE RECREATION shall not be responsible for any shipping charges for any component or product returned to us, nor for any shipping charges to return back to you any component or product.

THE WARRANTIES AND REMEDIES CONTAINED HEREIN ARE EXCLUSIVE AND IN LIEU OF ALL OTHER WARRANTIES EXPRESS, IMPLIED, OR STATUTORY, INCLUDING ANY LIABILITY ARISING UNDER ANY WARRANTY OF MERCHANTABILITY OR FITNESS FOR A PARTICULAR PURPOSE, STATUTORY OR OTHERWISE. Subject to applicable law, in no event shall our liability exceed the purchase price of the product.