

**TYPICAL SECTION (CONT.)**  
 STA. C 13+02.43 TO STA. C 15+59.52

HORIZONTAL SCALE 0 25' 50' 100'  
 VERTICAL SCALE 0 10' 20'

**GENERAL NOTES:**

1. PROVIDE RIPRAP AND BEDDING WITHIN LIMITS INDICATED ON SHEET CS402 AND SHEET CS201.
2. SEE SHEET CS201 FOR CHANNEL PROFILE AND RT DAM EMBANKMENT PROFILE.
3. SEE STRUCTURE SHEETS FOR FOUNDATION SLAB DETAILS.
4. SEE SHEET CS505 FOR SLOPE PAVING DETAILS.

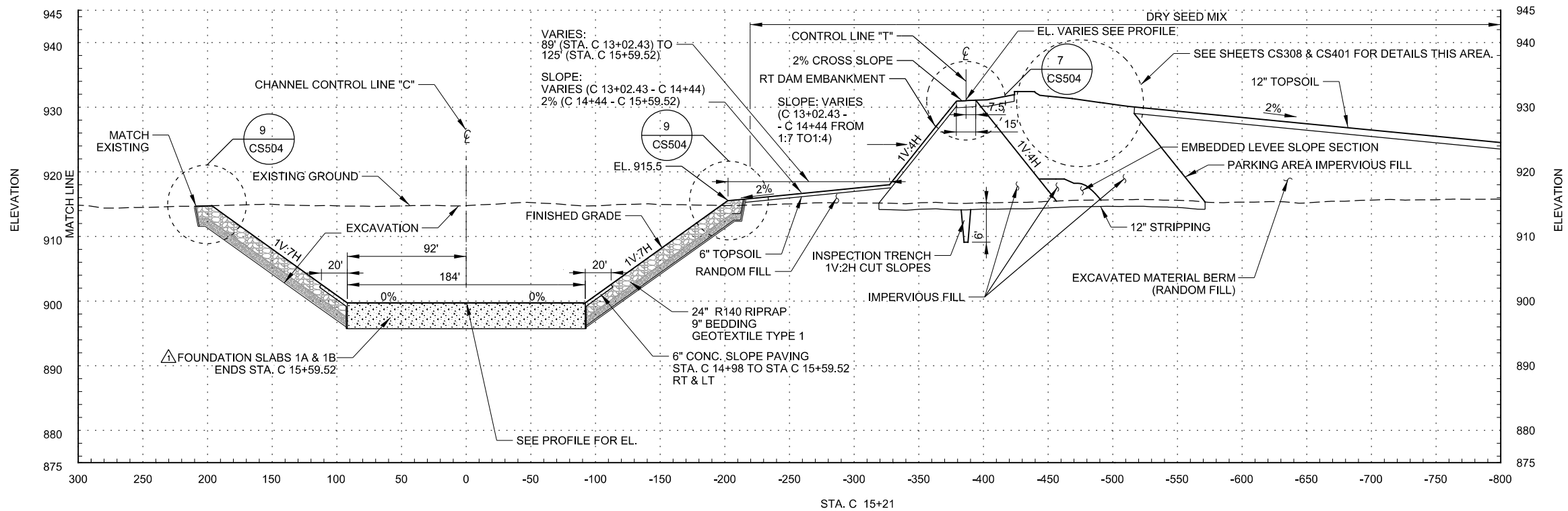

**TYPICAL SECTION**  
 STA. C 13+02.43 TO STA. C 15+59.52

HORIZONTAL SCALE 0 25' 50' 100'  
 VERTICAL SCALE 0 10' 20'

ELEVATION DATUM (VERTICAL CONTROL): COORDINATE SYSTEM (HORIZONTAL CONTROL):  
 NAVD 88 NAD 83 (2011)  
 GEOID12A ND SPCS, SOUTH ZONE-U.S. SURVEY FT.  
 COMBINED FACTOR (CF): 0.999956276



| MARK | DESCRIPTION                         | DATE      | APPR. MARK |
|------|-------------------------------------|-----------|------------|
| 1    | DWG REVISION WITH AMENDMENT NO. 003 | JULY 2016 |            |

| DATE      | DESIGNED BY:                 | CHECKED BY: | CONTRACT NO.: |
|-----------|------------------------------|-------------|---------------|
| 7/26/2016 | U.S. ARMY CORPS OF ENGINEERS | CS504       |               |
|           | ST. PAUL DISTRICT            |             |               |
|           | ST. PAUL, MINNESOTA          |             |               |

FMM DIVERSION INLET STRUCTURE  
 RED RIVER OF THE NORTH RIVER BASIN  
 FARGO-MOORHEAD FLOOD RISK MANAGEMENT  
 FARGO, ND  
 TYPICAL SECTIONS  
 4 OF 10

Sheet ID  
**CS304**