



All Seasons

**Tilt Double-Hung Windows
and Sash Replacement Kits**

All Seasons Windows

The All Seasons window collection has the design and appeal of a traditional wood double-hung window, without the maintenance headaches.

Our moisture-resistant exterior frame parts are far superior to natural wood's moisture-absorbing properties. Frame components that are exposed to the weather are made of non-rot vinyl and manufactured to the profiles of a true wood window. Rain and sun are the enemies of wood window frames.

The All Seasons frame has been designed to avoid rotting, warping, cracking, and swelling that is common with wood.

And, our factory finish surfaces will require less maintenance—saving you time and money.

Two sash options are available in the All Seasons window. Select a

wood sash that has a primed exterior and clear pine interior when you desire to finish your window with custom paints or stains.

Or, select an all extruded **PVC sash** that has the same details as a wood sash, but never requires painting. Our vinyl sash is built strong to last long. Both sash systems offer the popular features of tilt-to-clean, high performing Low-E glass, and smooth operation.

Need to upgrade existing sash?

Our replacement sash kits are a quick, easy, and a cost-efficient way to convert poor performing windows into almost like new condition.

All Seasons Windows is the right choice through every season.

DOUBLE HUNG WINDOW

Sash Opening	Rough Opening (inches)	Overall Dimensions	Standard Grille Layout
SASH SIZES			
1-8 x 3-2	22 x 42	24 x 42.25	4/4
x 3-10	22 x 50	24 x 50.25	4/4
x 4-6	22 x 58	24 x 58.25	4/4
x 5-2	22 x 66	24 x 66.25	4/4
x 5-6 E	22 x 70	24 x 70.25	4/4
x 6-2	22 x 78	24 x 78.25	6/6
2-0 x 3-2	26 x 42	28 x 42.25	4/4
x 3-10	26 x 50	28 x 50.25	4/4
x 4-6	26 x 58	28 x 58.25	4/4
x 5-2	26 x 66	28 x 66.25	4/4
x 5-6 E	26 x 70	28 x 70.25	4/4
x 6-2	26 x 78	28 x 78.25	6/6
2-4 x 3-2	30 x 42	32 x 42.25	6/6
x 3-10	30 x 50	32 x 50.25	6/6
x 4-6	30 x 58	32 x 58.25	6/6
x 5-2	30 x 66	32 x 66.25	6/6
x 5-6 E	30 x 70	32 x 70.25	6/6
x 6-2	30 x 78	32 x 78.25	9/9
2-8 x 3-2	34 x 42	36 x 42.25	6/6
x 3-10	34 x 50	36 x 50.25	6/6
x 4-6	34 x 58	36 x 58.25	6/6
x 5-2	34 x 66	36 x 66.25	6/6
x 5-6 E	34 x 70	36 x 70.25	6/6
x 6-2	34 x 78	36 x 78.25	9/9
3-0 x 3-2	38 x 42	40 x 42.25	6/6
x 3-10	38 x 50	40 x 50.25	6/6
x 4-6	38 x 58	40 x 58.25	6/6
x 5-2	38 x 66	40 x 66.25	6/6
x 5-6 E	38 x 70	40 x 70.25	6/6
x 6-2	38 x 78	40 x 78.25	9/9

Rough Openings on Multiples:

- Twin Unit – Single rough opening width x 2 minus 1/2"
- Triple Unit – Single rough opening width x 3 minus 1"

Typical Double-Hung Layout



Wood Double Hung—Vertical

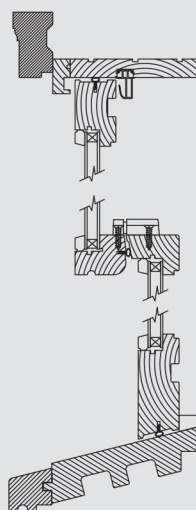

Wood Double Hung—Horizontal

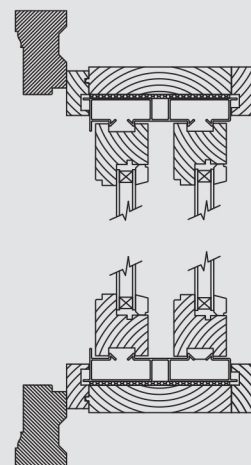

PVC Double Hung—Vertical

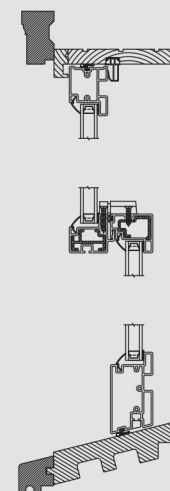

PVC Double Hung—Horizontal

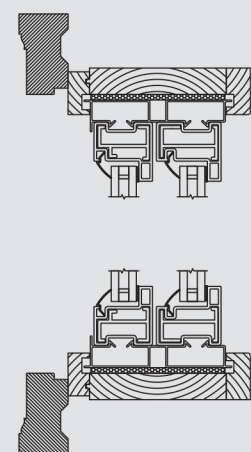

All Seasons Options

Frame Options

- Standard 4-9/16" jamb with extensions up to 6-9/16"
- Exterior casing: 180 BM, 5/4 x 4 flat, or S4S w/backband
- Available in single, twin, or triple units
- Mulled half-round or transoms

Glazing Options

- 7/8" flat GBG
- Simulated divided lite in 7/8" or 1-1/8" widths
- Tempered or obscure glass available
- Custom grille patterns available

FIXED WINDOW

Sash Opening	Rough Opening (inches)	Overall Dimensions	Standard Grille Layout
SASH SIZES			
4-0 x 3-2	50 x 42	52 x 42.25	4W 4H
x 3-10	50 x 50	52 x 50.25	4W 4H
x 4-6	50 x 58	52 x 58.25	4W 4H
x 5-2	50 x 66	52 x 66.25	4W 4H
x 5-6	50 x 70	52 x 70.25	4W 6H
x 6-2	50 x 78	52 x 78.25	4W 6H
5-0 x 3-2	62 x 42	64 x 42.25	5W 4H
x 3-10	62 x 50	64 x 50.25	5W 4H
x 4-6	62 x 58	64 x 58.25	5W 4H
x 5-2	62 x 66	64 x 66.25	5W 4H
x 5-6	62 x 70	64 x 70.25	5W 6H
x 6-2	62 x 78	64 x 78.25	5W 6H
6-0 x 3-2	74 x 42	76 x 42.25	6W 4H
x 3-10	74 x 50	76 x 50.25	6W 4H
x 4-6	74 x 58	76 x 58.25	6W 4H
x 5-2	74 x 66	76 x 66.25	6W 4H
x 5-6	74 x 70	76 x 70.25	6W 6H
x 6-2	74 x 78	76 x 78.25	6W 6H
Rough Openings on Multiples: - Twin Unit – Single rough opening width x 2 minus 1/2" - Triple Unit – Single rough opening width x 3 minus 1"			

Typical Fixed Layout



Wood Fixed–Vertical

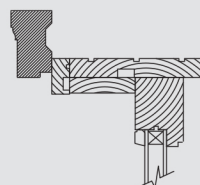

Wood Fixed–Horizontal

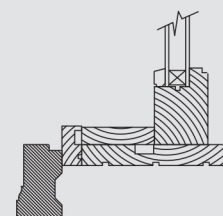
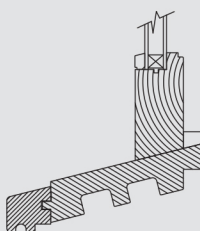
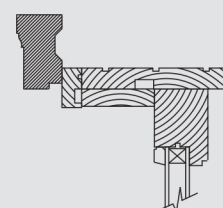

PVC Fixed–Vertical

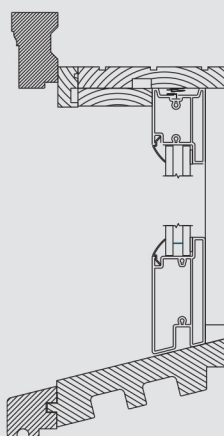

PVC Fixed–Horizontal

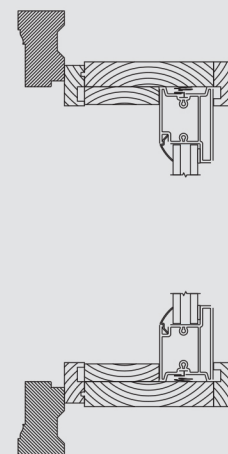

INSTALLING THE WINDOW

NOTE: For flashing instructions, follow all local building codes applicable to the construction applications.

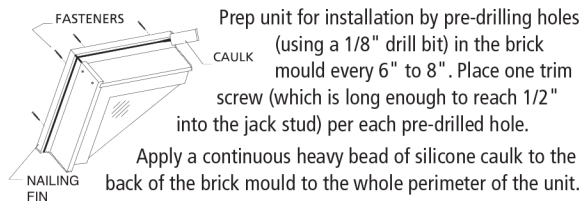

Place and center the unit into the rough opening, making sure that the unit does not have more than 1/2" between the jambs and the rough framing. Also, make sure that the brick mould is pressed completely against the sheathing and caulk.

Place a level on the window's sill and shim the unit under the side jamb leg only until the level reads true. Attach the unit in one of the top corners through the brick mould.

Adjust the unit left or right at the sill until the unit is square. Check the unit to ensure it is level again, then fasten all four corners of the unit. Verify that the unit is square by measuring diagonally from opposite corners of the window frame.

Place a 4' or 6' level against the outside edge of the brick mould and adjust any bows out by prying in on the interior part of the jamb until the brick mould is true with the level. Once the brick mould is true with the level, fasten the brick mould at the checkrail. Finish fastening the unit by placing the fasteners about every 8" and ensure that the window is pulled tightly to the exterior sheathing.

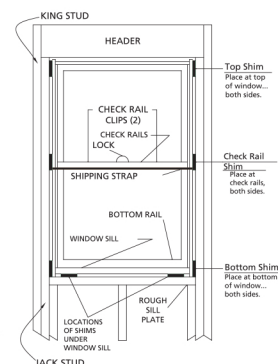

All Seasons Sash Replacement Kits

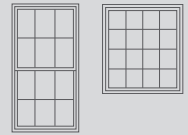

Double Hung and Fixed Layout.

Traditional double-hung wood window appearance

- Plowed finger lifts in top and bottom of sash for easy use
- Matching sash for fixed, flanker, or transom sash
- Heavy duty, double action sash lock and keeper applied
- Tilting sash for easier cleaning
- Fully weather-stripped at all horizontal rails
- Premium vinyl jamb liners available for replacement sash kit operation
- Energy-efficient Low-E glass
- 10-year warranty on insulated glass

Standard features

Wood Sash

- Primed exterior surfaces
- Stain-grade interior wood for decorative stains or paint
- One-year warranty on materials and workmanship

PVC Sash

- No painting of exterior and interior surfaces
- Aluminum reinforced check rails for additional strength
- Custom widths and height available

New Sash
Traditional Look



Old Sash



Available in PVC or Wood

How to remove old sash and install replacement sash

- For existing non-tilting window sash, carefully remove the inside stops. If the existing window has tilting sash, removing the inside stops is not necessary
- Remove any fasteners that may be holding the old jamb liners in place and move the top and bottom sash to the center of the opening
- Grasp the sash and rotate the jamb liners along with both sash to the inside of the house from the opening
- Inspect the exposed window frame and remove any fasteners that may have been left once the old sash is discarded
- Insert the jamb liners into the side jambs with the bottom touching the window sill and the jamb liner pressed against the outside blind stop of the window frame
- Hold the jamb liner in place and drive screws through the pre-punched holes until the head of the screw is flush with the liner
- Install the upper sash into the opening by inserting the tilt pins into the carriage of the jamb liner. Tilt the upper sash into the proper channel by slightly depressing the jamb liner. Slide the upper sash into the closed position
- Insert and tilt-in the lower sash in the same method. Move the lower sash to the very bottom of the frame and lock the sash
- Adjust the screws holding the jamb liner so that it makes contact with the sash stiles
- Reinstall the inside stops and the operation is complete

The replacement sash kit includes:

- Pair of double hung tilt sash
- Sash Lock and tilt pins installed
- Pair of screw mount, tilting jamb liners
- #6 x 1-1/2", flat head wood screws
- Two head gaskets for top of the jamb liners
- Installation instructions

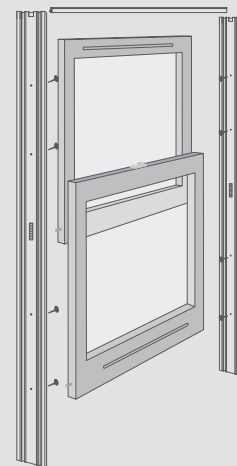

| 9815 Brookford St., Charlotte NC 28241 |
| Tel: 800-264-3953, 704-588-3635 | Fax: 800-264-7102 | www.dykeind.com |

