

Models:

NS5, NS5H - 5" Diameter

NS6, NS6H, NS6V - 6" Diameter

Dynabrade Nitro Series™

Random Orbital Sander, 12,000 RPM

Complete Assembly

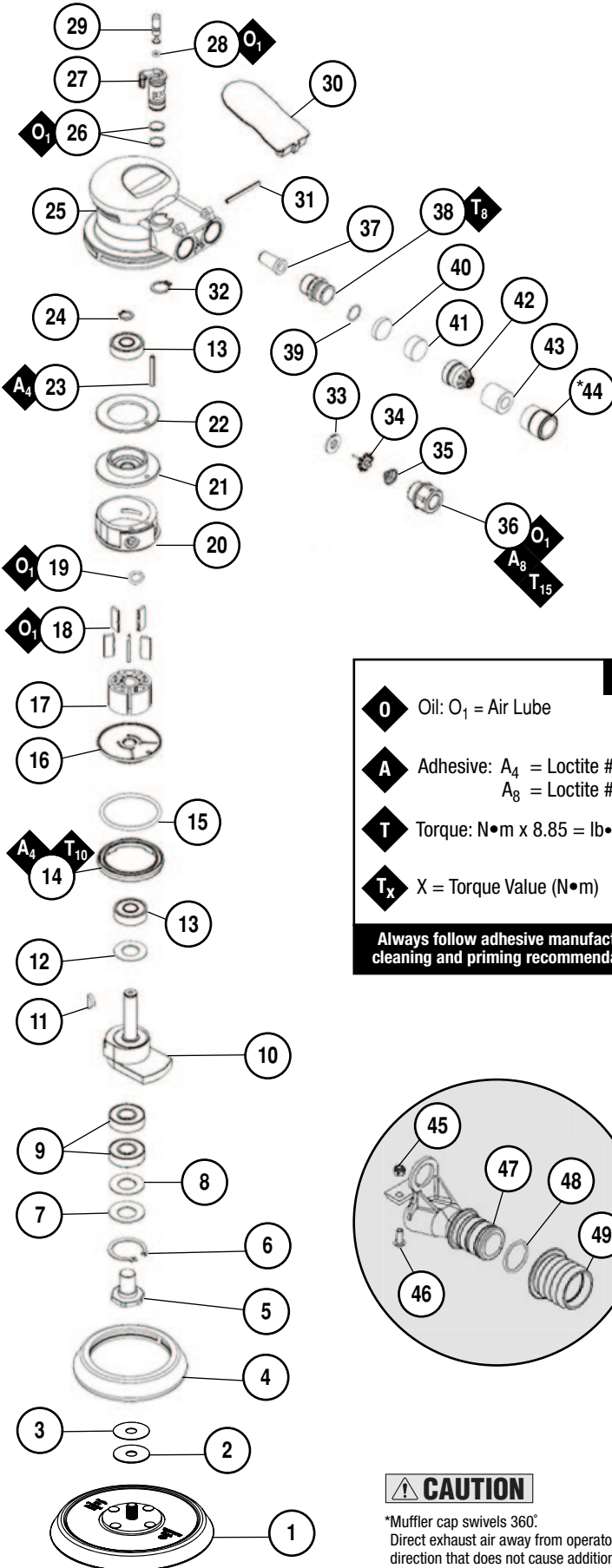

KEY

- O** Oil: O₁ = Air Lube
- A** Adhesive: A₄ = Loctite #680
A₈ = Loctite #567
- T** Torque: N•m x 8.85 = lb•in.
- T_x** X = Torque Value (N•m)

Always follow adhesive manufacturers cleaning and priming recommendations.

CAUTION

*Muffler cap swivels 360°. Direct exhaust air away from operator, and in a direction that does not cause additional hazards.

ITEM	P/N	DESCRIPTION	QTY.
1	NP5	BACKUP PAD	1
	NP5H	PAD - MODEL # NS5	
	NP6	PAD - MODEL # NS5H	
	NP6H	PAD - MODEL # NS6	
	NP6V	PAD - MODEL # NS6H PAD - MODEL # NS6V	
2	95858	WASHER (INCLUDED WITH PAD)	1
3	95859	WASHER (INCLUDED WITH PAD)	1
4	59810	SHROUD - MODEL # NS5, NS5H, NS6, NS6H	1
	59867	VACUUM SHROUD - MODEL # NS6V	
5	59811	BALANCER SHAFT	1
6	59812	RETAINER RING	1
7	59813	WASHER	1
8	59814	BEARING SEAL	1
9	59815	BEARING	2
10	59816	SHAFT BALANCER	1
	59859	5" - 3/16" ORBIT 6" - 3/16" ORBIT	
11	59817	KEY	1
12	59818	WASHER	1
13	59819	BEARING	2
14	59820	LOCKWASHER	1
15	59821	O-RING	1
16	59822	FRONT BEARING PLATE	1
17	59823	ROTOR	1
18	59824	VANE (5/PKG.)	1
19	59825	O-RING	1
20	59826	CYLINDER	1
21	59827	REAR BEARING PLATE	1
22	59828	GASKET	1
23	59829	PIN	1
24	59830	RETAINING RING	1
25	59831	HOUSING ASSEMBLY	1
	59860	HOUSING - MODEL # NS5, NS5H	
	59862	HOUSING - MODEL # NS6, NS6H HOUSING - MODEL # NS6V	
26	59833	O-RING	2
27	59832	SPEED REGULATOR	1
28	59834	O-RING	1
29	59835	VALVE STEM	1
30	59836	THROTTLE LEVER - 3/16" ORBIT	1
31	59837	PIN	1
32	59838	RETAINER RING	1
33	59839	SEAL	1
34	59840	TIP VALVE	1
35	59841	SPRING	1
36	59842	INLET BUSHING	1
37	59843	SILENCER	1
38	59844	MUFFLER BODY	1
39	59845	O-RING	1
40	59846	MUFFLER INSERT (DARK)	1
41	59847	MUFFLER INSERT (WHITE)	1
42	59848	ASPERATOR	1
43	59849	MUFFLER INSERT	1
*44	59850	MUFFLER CAP	1
FOR VACUUM MODELS: NS6V			
45	59868	NUT	1
46	59869	SCREW	1
47	59870	VACUUM ADAPTER	1
48	59871	O-RING	1
49	59872	CUFF CONNECTOR - 1-1/4" SWIVEL	1
50	59852	21mm OPEN END WRENCH	1