

DIMENSIONS ARE IN INCHES
 TOLERANCES: (UNLESS NOTED)
 3 PLACE DECIMAL = ± 0.005
 2 PLACE DECIMAL = ± 0.015
 1 PLACE DECIMAL = ± 0.050
 DIMENSIONS IN INCHES
 DRAWING NOT TO SCALE

PROPRIETARY AND CONFIDENTIAL
 THE INFORMATION CONTAINED IN THIS
 DRAWING IS THE SOLE PROPERTY OF
 AUTOMATION COMPONENTS INC. ANY
 REPRODUCTION IN PART OR AS A WHOLE
 WITHOUT THE WRITTEN PERMISSION OF
 AUTOMATION COMPONENTS INC. IS
 PROHIBITED.



ITEM NUMBER:
 A/GP(0-XXX)-XX-N4

DEBURR AND BREAK
 SHARP EDGES

DESCRIPTION:
 GAUGE PRESSURE TRANSMITTERS, NEAM 4 ENCLOSURE

DWG. NO.
 10000352

REV
 1

MATERIAL:

DATE:
 11/28/2016

DRAWN BY:
 TEQ

APPROVED BY:
 TJD

SCALE: 1:2

DO NOT SCALE DRAWING SHEET 1 OF 2

ITEM NO.	ITEM NUMBER	DESCRIPTION	QTY.
1	ACI GP NEMA 4	HOUSING, NEMA 4 ENCLOSURE	1
2	7/8" HOLE PLUG	HARDWARE, 7/8" HOLE PLUG	1
3	GP (0-XXX)-XX	GP (0-XXX)-XX	1
4	GP FITTING SS	FITTING, GP STAINLESS STEEL	1
5	13/16" SSWASH TH	WASHER, 13/16" STAINLESS TEEL	1
6	IMMERSION WASH	WASHER, NEMA HOUSING IMMERSION	1
7	1/2" LOCKNUT	NUT, 1/2" LOCKNUT	1

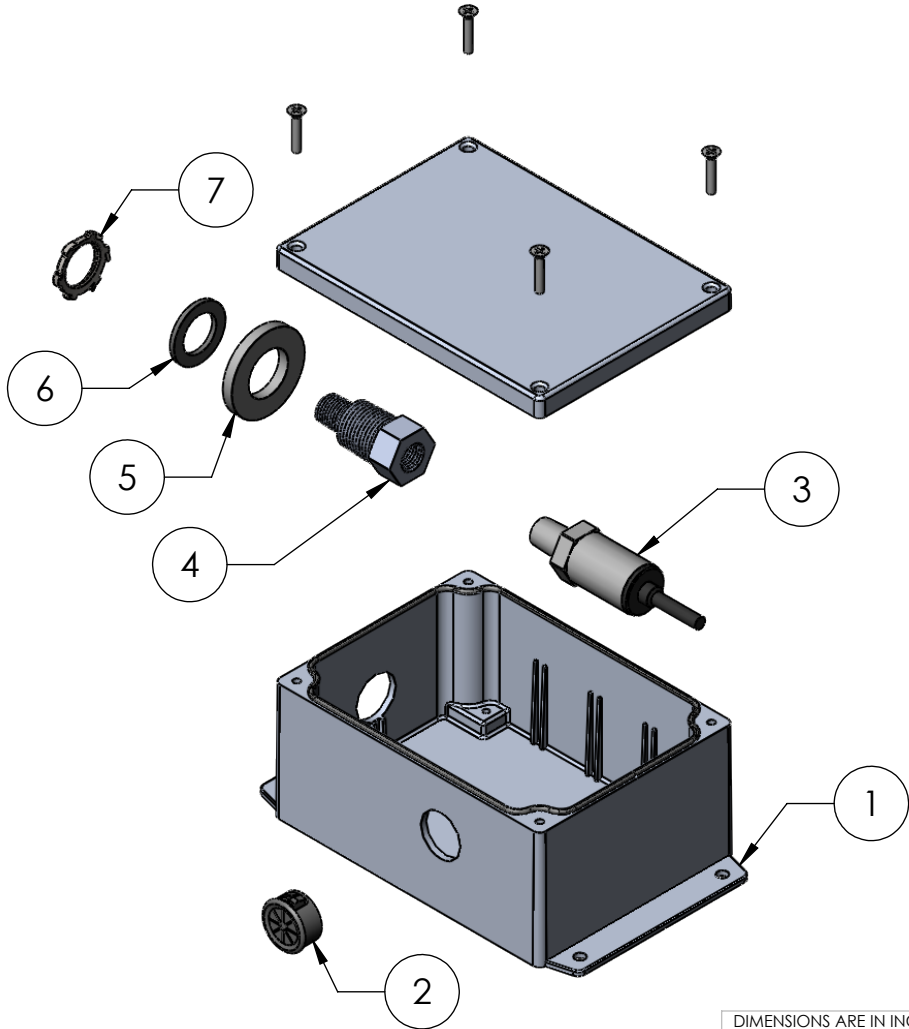

NOTES:

- 1.) ALL PRESSURE SENSORS ARE COMPATIBLE WITH ANY GASES OR LIQUIDS COMPATIBLE WITH 17-4PH STAINLESS STEEL. **NOTE: HYDROGEN NOT RECOMMENDED FOR USE WITH 17-4PH STAINLESS STEEL.**
- 2.) ALL 1/4" MNPT FITTINGS ARE TO BE MADE OF 304 OR 316 SERIES STAINLESS STEEL.
- 3.) ALL UNITS ARE TO BE MOUNTED IN A NEMA 4 RATED ENCLOSURE WITH (1) 1/2" NPT KNOCKOUT.
- 4.) EACH UNIT WILL HAVE A 2.00' ±6.00" CABLE FOR MAKING ALL CONNECTIONS. THE 4-20 mA OUTPUT VERSIONS WILL HAVE (2) WIRES AND THE SHIELD, WHEREAS THE VOLTAGE OUTPUT VERSIONS WILL HAVE (3) WIRES AND THE SHIELD.
- 5.) **LABELING: PACKAGE LABELING:** 3" X 2" WHITE POLY LABEL WITH PART NUMBER, DESCRIPTION, BATCH NUMBER, DATE CODE AND TECH. SUPPORT INFORMATION. LABEL TO BE PRINTED IN BLACK INK.
PRODUCT LABEL: 2" X 1" WHITE POLY LABEL WITH PART NUMBER, DESCRIPTION, BATCH NUMBER, DATE CODE AND TECH. SUPPORT INFORMATION. LABEL TO BE PRINTED IN BLACK INK.
- 6.) **PACKAGING:** EACH UNIT WILL BE INDIVIDUALLY BAGGED. A PACKAGE LABEL WILL ALSO BE PLACED ON THE OUTSIDE OF EACH BAG.
- 7.) ALL UNITS ARE TO INCLUDE A DESSICANT PACK INSIDE OF THE ENCLOSURE.
- 8.) ALL UNITS TO BE BUILT PER THE MANUFACTURING PLAN CALLED OUT ON SHOP ORDER.

DIMENSIONS ARE IN INCHES
TOLERANCES: (UNLESS NOTED)
3 PLACE DECIMAL = ±0.005
2 PLACE DECIMAL = ±0.015
1 PLACE DECIMAL = ±0.050
DIMENSIONS IN INCHES
DRAWING NOT TO SCALE

PROPRIETARY AND CONFIDENTIAL
THE INFORMATION CONTAINED IN THIS DRAWING IS THE SOLE PROPERTY OF AUTOMATION COMPONENTS INC. ANY REPRODUCTION IN PART OR AS A WHOLE WITHOUT THE WRITTEN PERMISSION OF AUTOMATION COMPONENTS INC. IS PROHIBITED.



ITEM NUMBER:
A/GP(0-XXX)-XX-N4

DEBURR AND BREAK SHARP EDGES

DESCRIPTION:
GAUGE PRESSURE TRANSMITTER, NEMA 4 ENCLOSURE

DWG. NO.
10000352

REV
1

MATERIAL:

DATE:
11/28/2016

DRAWN BY:
TEQ

APPROVED BY:
TJD

SCALE: 1:2

DO NOT SCALE DRAWING

SHEET 2 OF 2