

1 NEW FOOTING

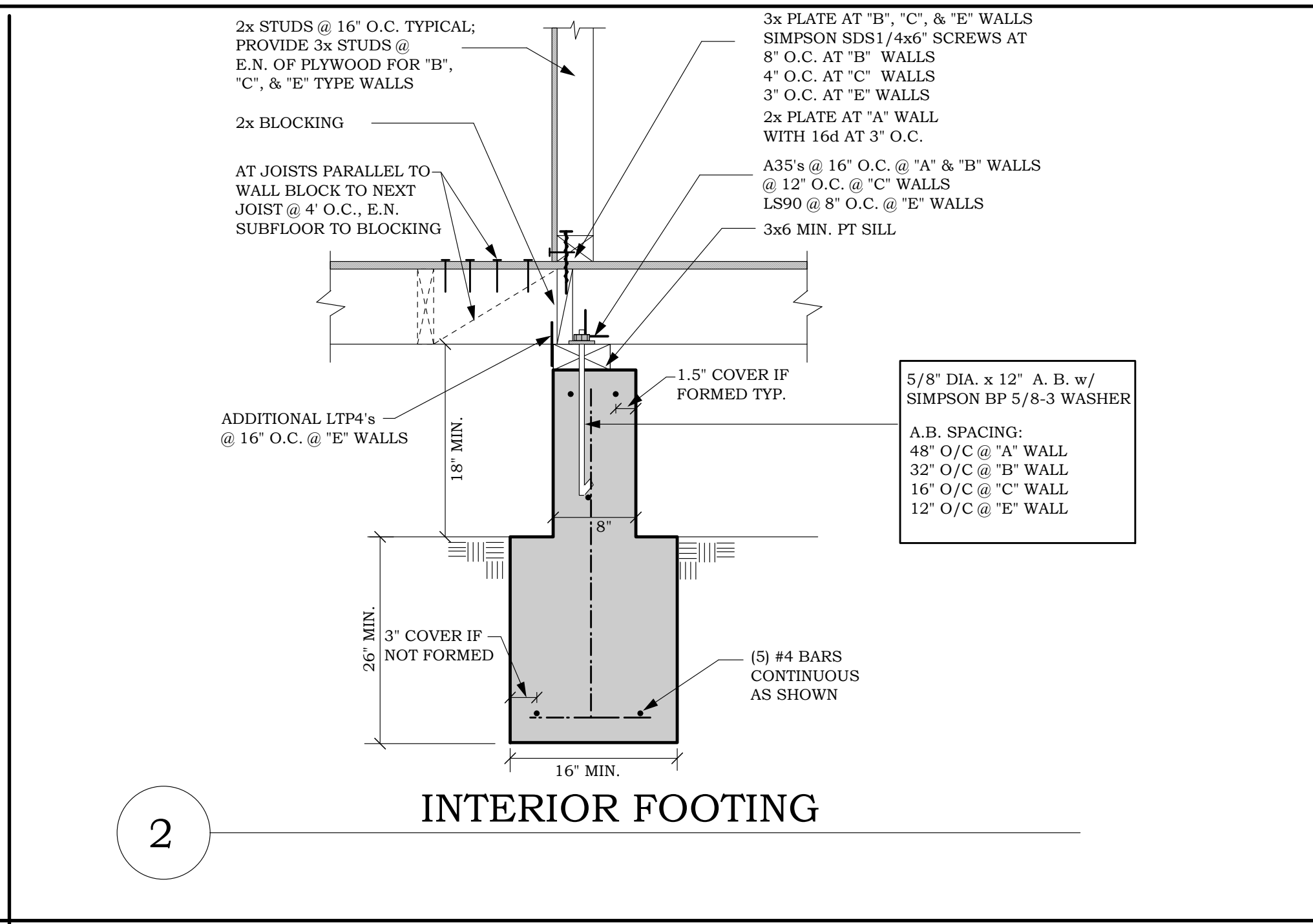

2 INTERIOR FOOTING

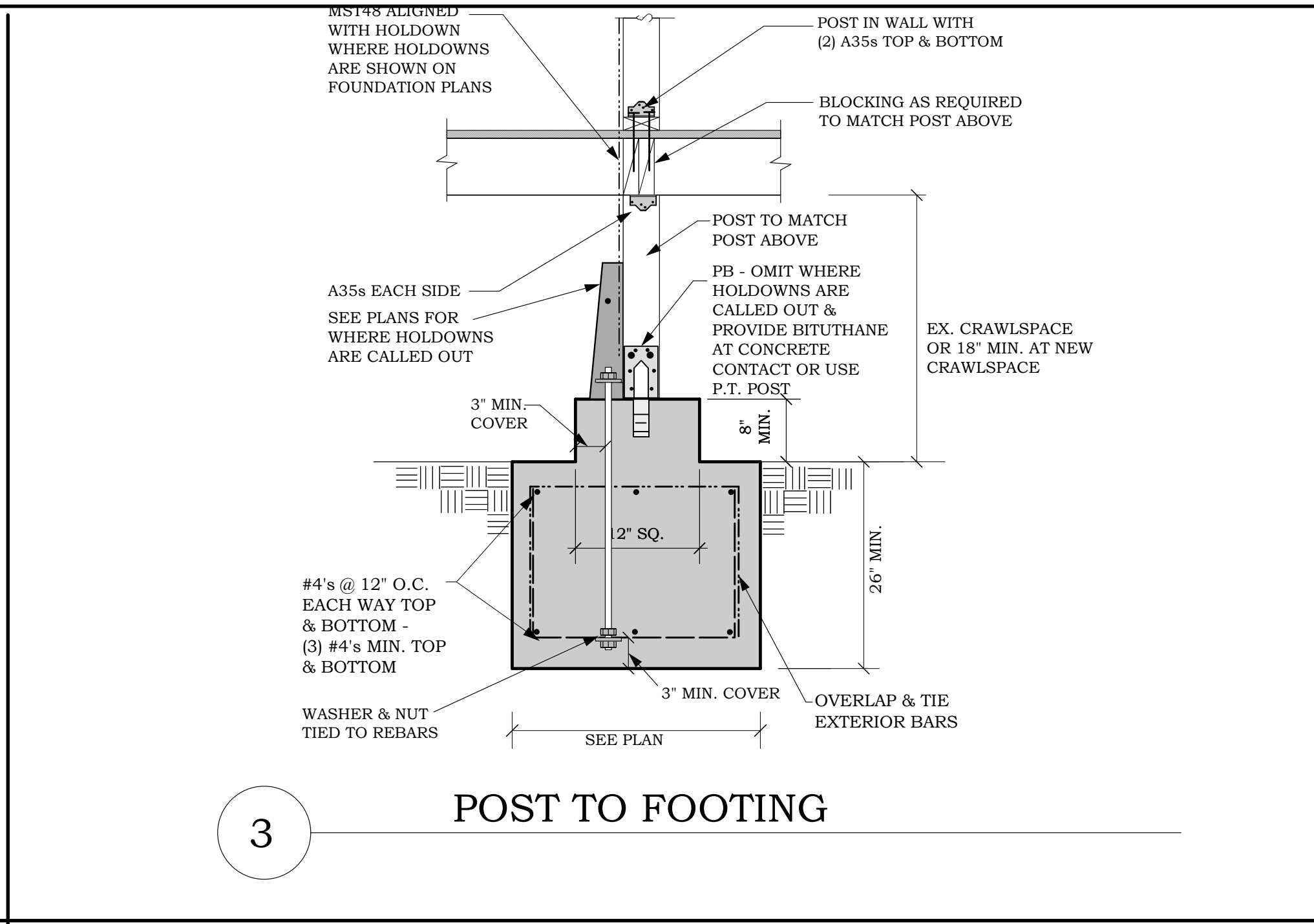

3 POST TO FOOTING

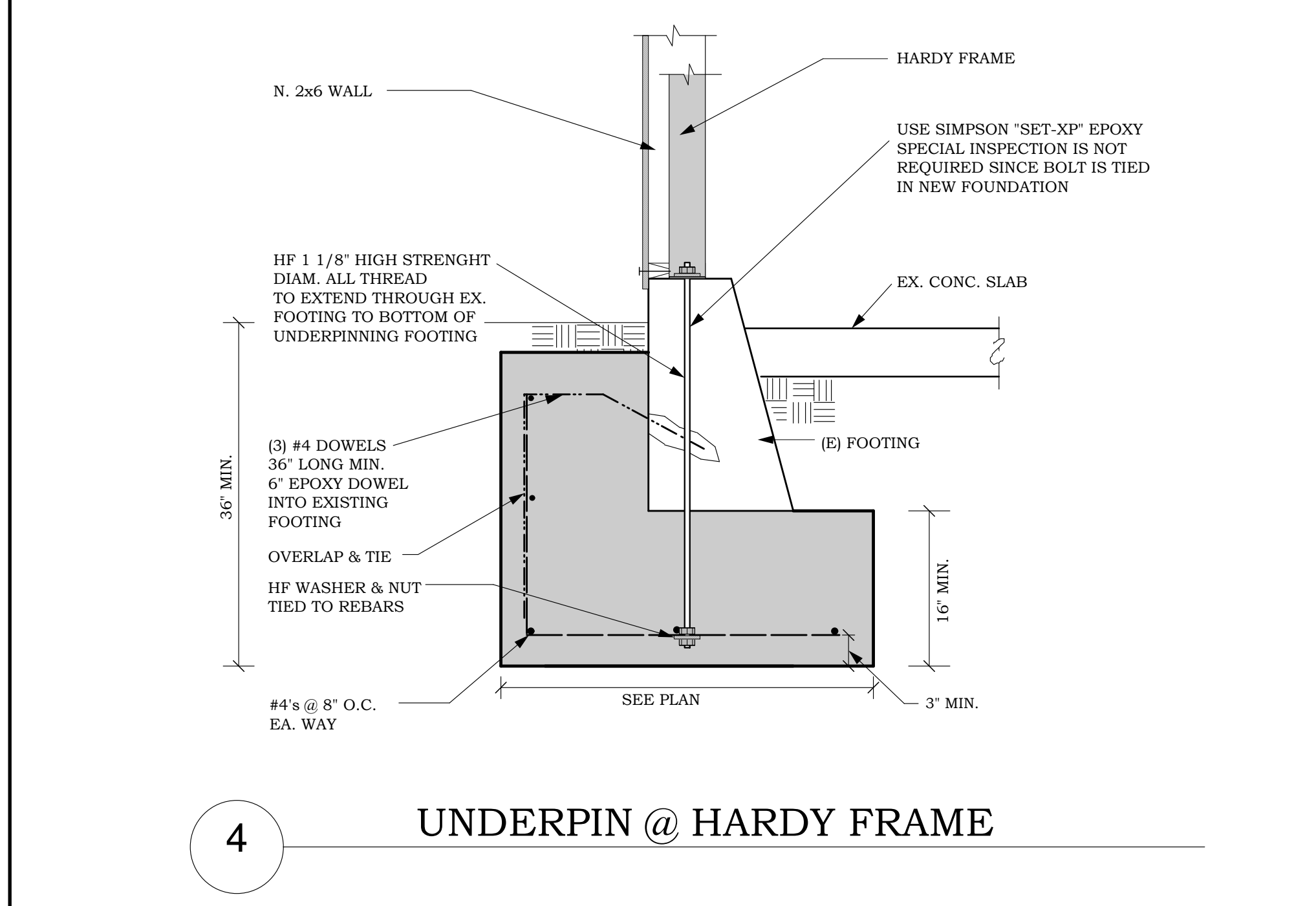

4 UNDERPIN @ HARDY FRAME

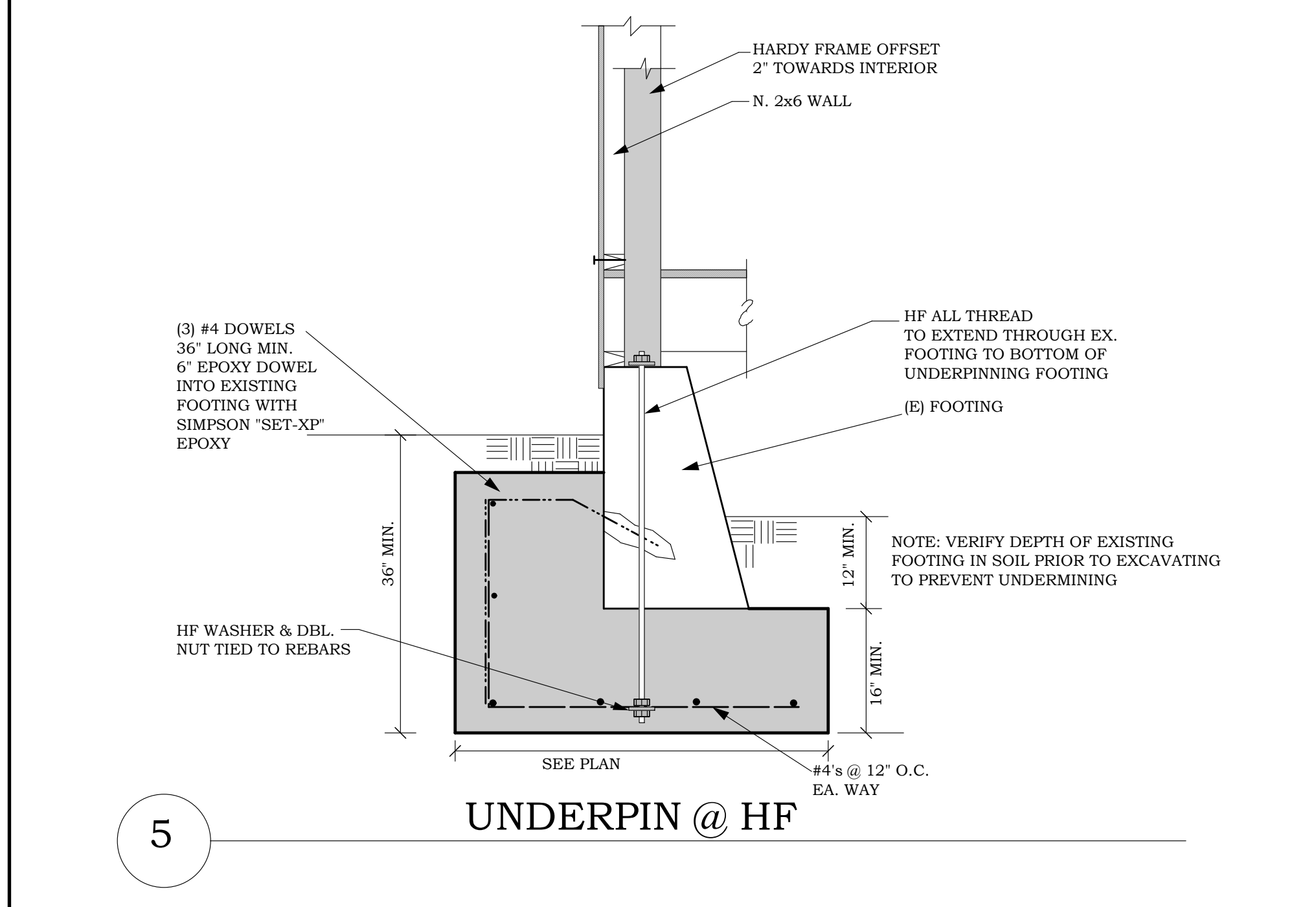

5 UNDERPIN @ HF

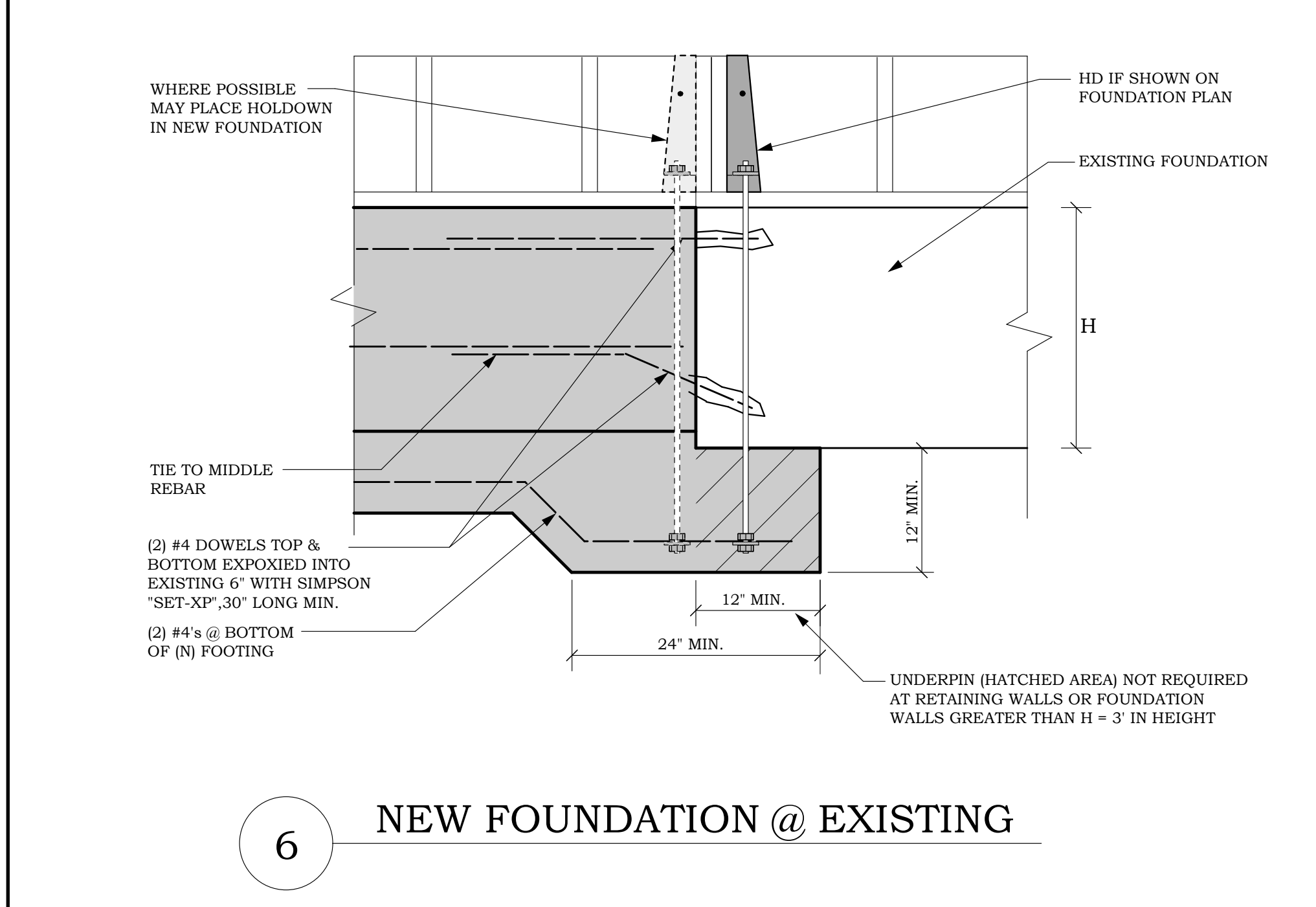

6 NEW FOUNDATION @ EXISTING

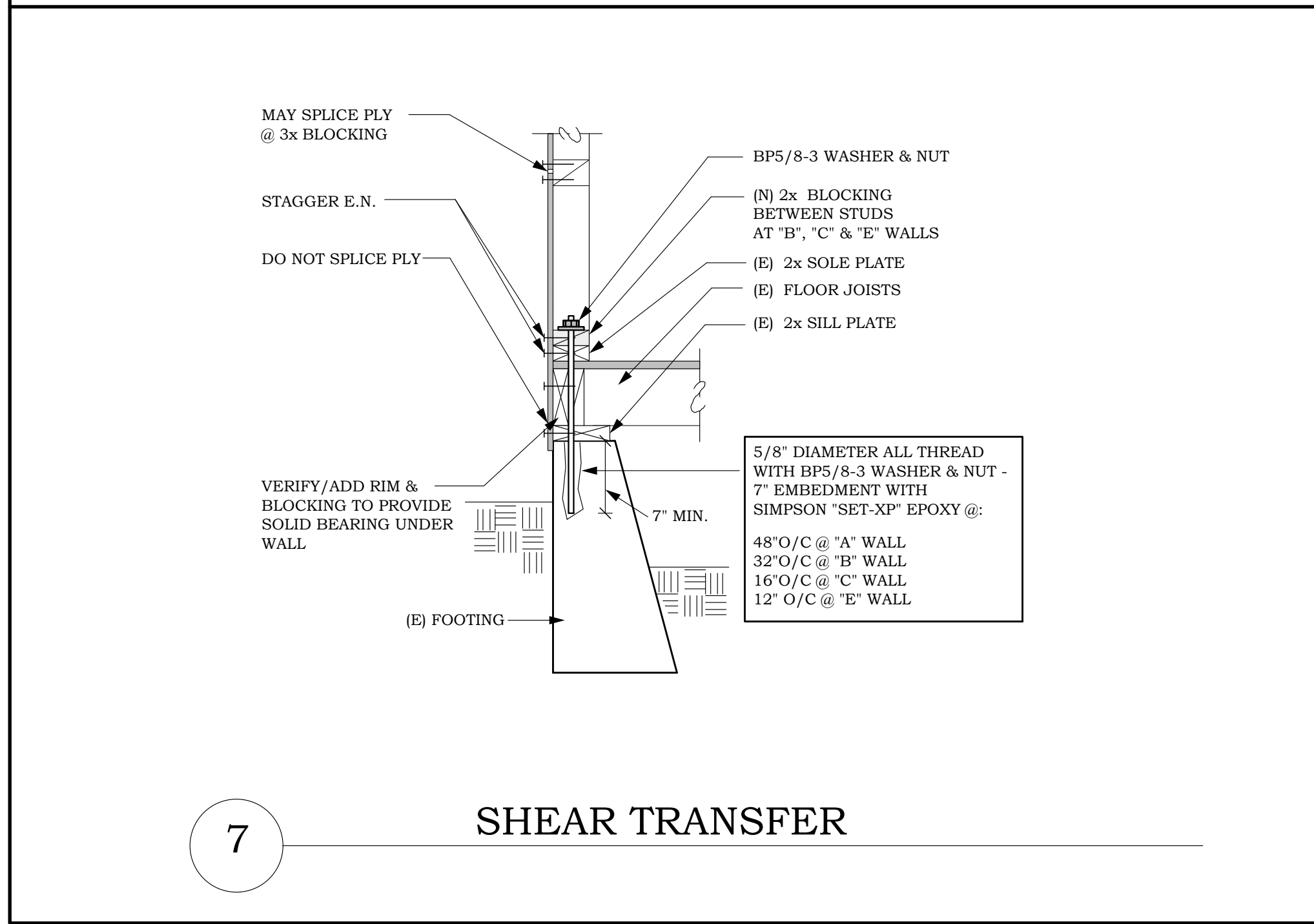

7 SHEAR TRANSFER

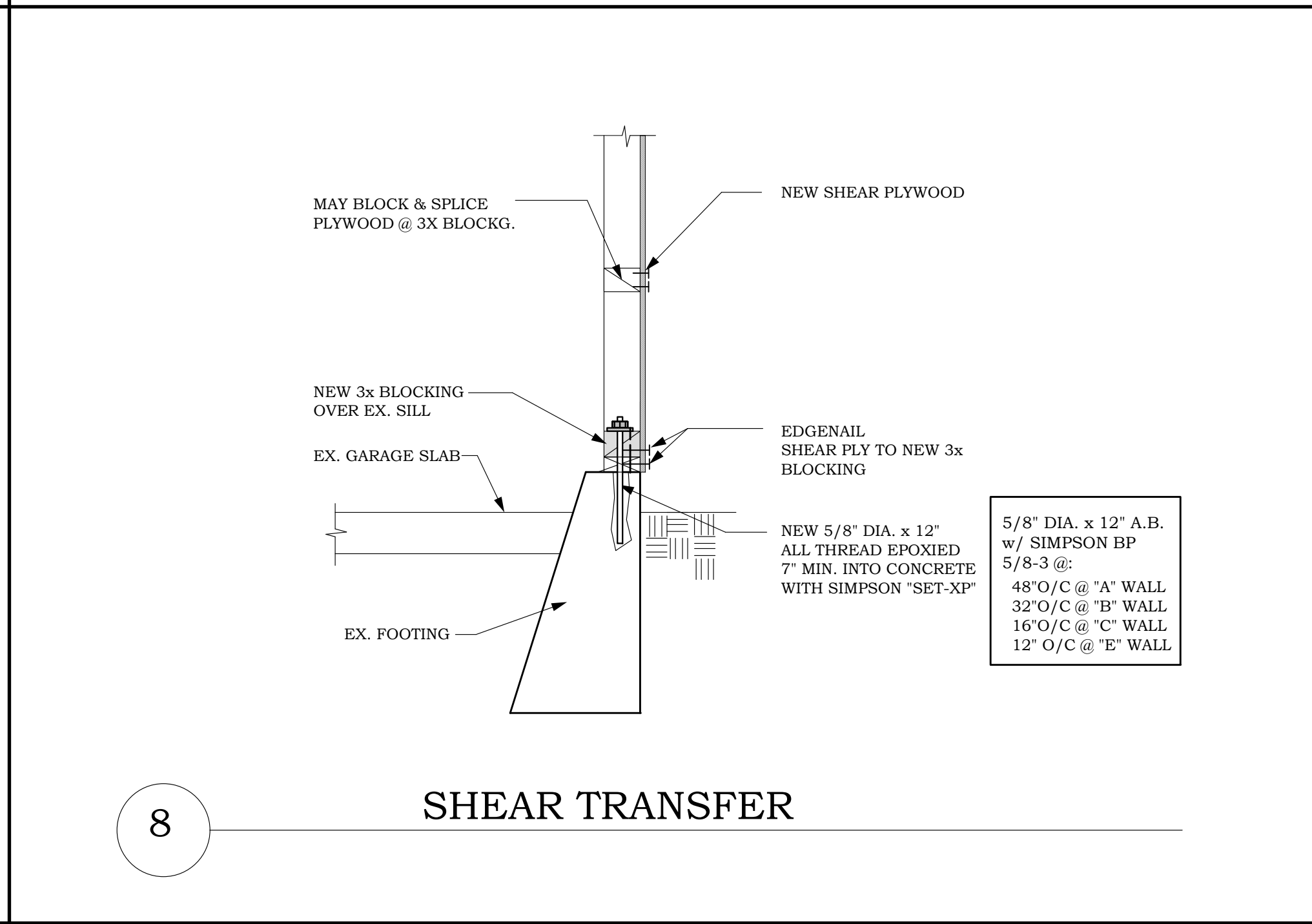

8 SHEAR TRANSFER

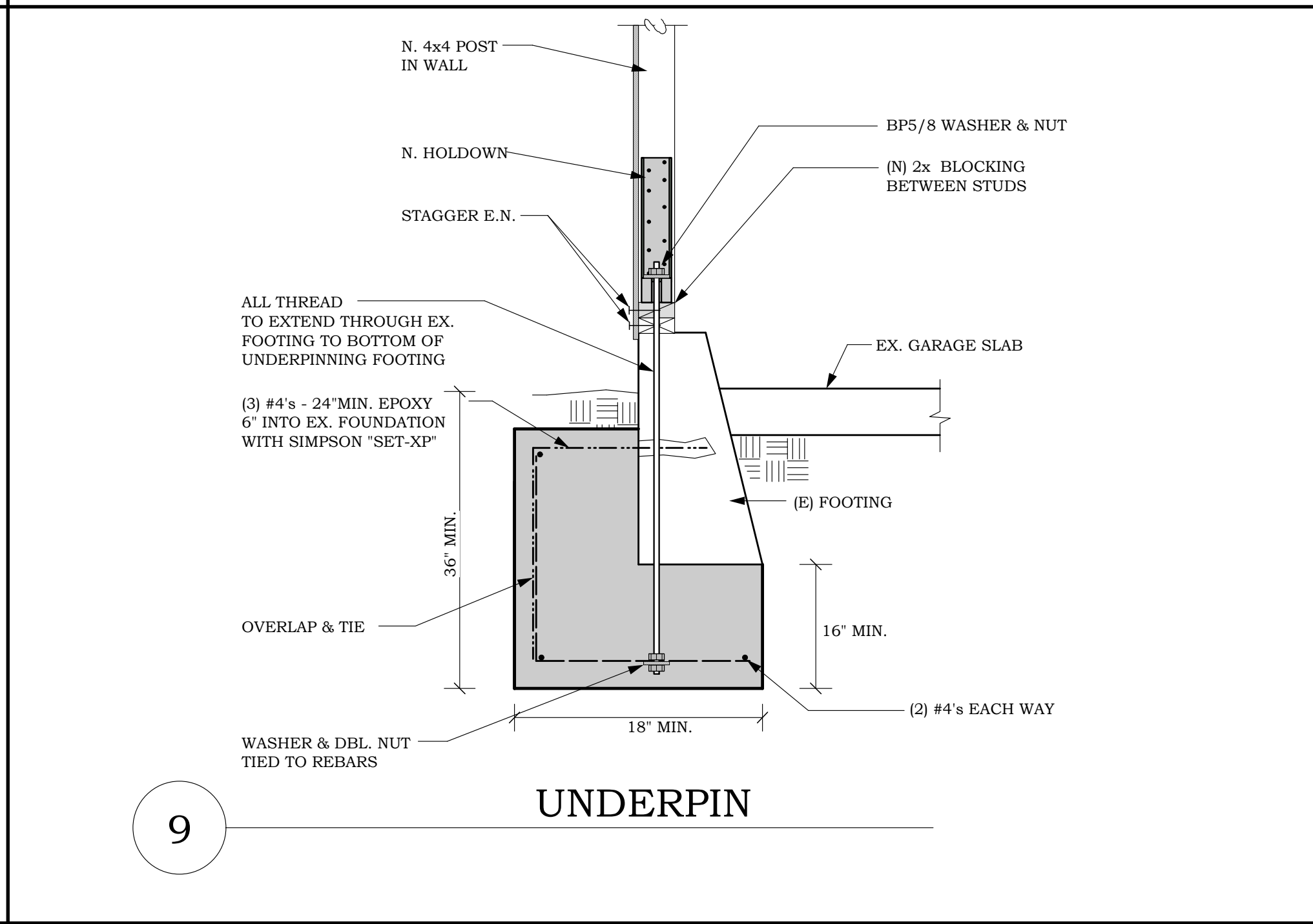

9 UNDERPIN