

CHRIS RIDGWAY ARCHITECT, INC.
 610 POPULAR STREET, HALF MOON BAY, CA 94019
 PH: 650.622.6201 WEB: CRARCHITECT.NET
 EMAIL: CRARCHITECT@COASTSIDE.NET

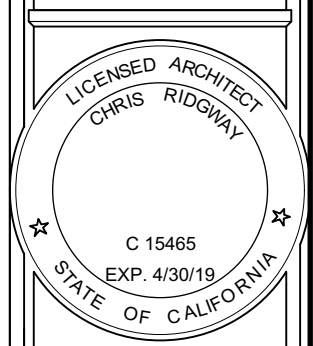

NEW ADDITION & REMODEL FOR:
RICK & HELEN DALTON
 ADDRESS: 3900 CHRISTIAN DR., BELMONT, CA 94002

JOB # 1704
 SCALE AS NOTED
 DATE 2/14/18
 SHEET LSI

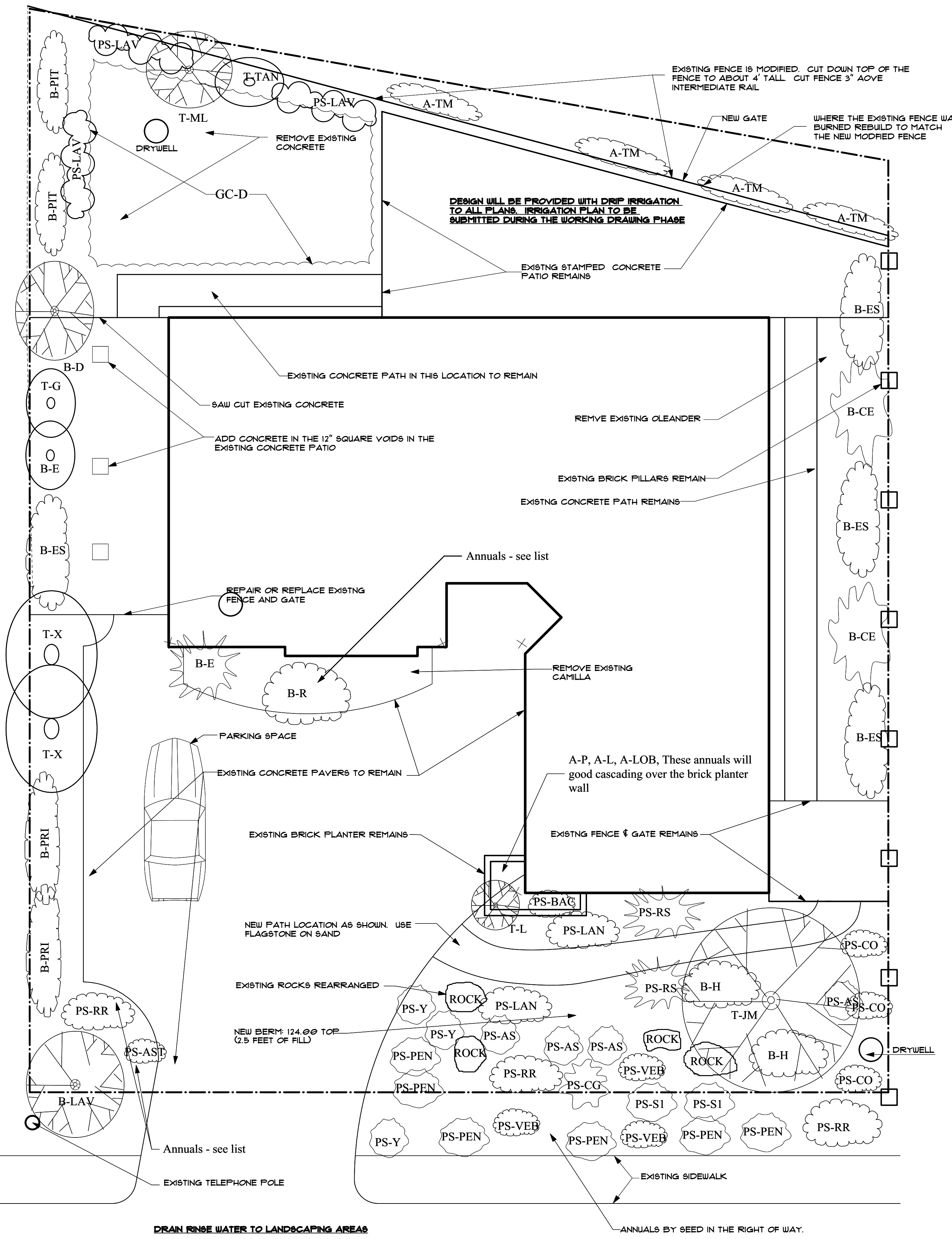

ANNUALS

- A-TM **Tropaeolum majus**, NASTURTIUM. Annuals, but freely reseed themselves. Plant by seeds sown. These plants will clamber up the low fence. Plant nasturtiums in the existing throtf edge of the patio. Also plant on the opposite side.
- A-P **Petunia x hybrid** Sun.
- A-L **Lobulara**, SWEET ALYSSUM.
- A-BB **Centaurea cyanus**, BACHELOR BUTTONS. Full sun. Little water. Sew seeds in winter.
- A-LOB **Lobelia erinus**

PERENNIALS

- PS-AS **Aster 'Monch'**, 2' wide and tall. Drought tolerant. Lavender Blue flowers. Blooms June to September.H
- PS-Y **Achillea millefolium**, COMMON YAROW tall. Drought tolerant. Attracts butterflies.
- Perovskia atriplicifolia**, 'Blue Spire', RUSSIAN SAGE Silvery foliage and plumes of violet-purple blooms. Not only is it heat and drought resistant, but deer, rabbits, and most other pests steer clear of it. To 6 feet tall. 1 gallon
- PS-RS **Salvia greggii** 2-3 feet tall. Drought tolerant. Flowers cherry red and blooms late summer and fall. Aromatic.
- PS-S1 **Salvia purpurea**, 'Purpleicious', 2 feet tall. Drought tolerant. Purple spikes of flowers in summer into fall
- PS-VER **Veronica 'purpleicious'**, 2 feet tall. Drought tolerant. Purple spikes of flowers in summer into fall
- PS-BH **Existing Coleonema album**, WHITE BREATH OF HEAVEN. Full sun to light shade. Moderate to regular water. Heather like leaves. Moderate to Regular water. 1 gallon. Avail. @ HMB Nursery.

BUSHES

- B-CE **Ceanothus**, 'Ray Hartman'. 12 - 20 feet and 15 - 20 feet wide. Can be trained as a small tree. 1 gallon. Attracts bees and butterflies. Plants live 5 - 10 years.
- B-ES **Escalonia rubra**. 12 'tall. Clusters of small pink flowers. Regular water. Available @ HMB Nursery.
- B-E **Existing Echim candicans**, PRIDE OF MADERA. Drought tolerant. Deer tolerant. Poisonous. Spikes of 12" tall cones of purple flowers. 4' - 6' tall and up to 8 feet wide. Needs to be dead headed.
- B-PIT **Pittosporum tobira**. Grows 6' tall. 1 gallon. Available @ HMB Nursery.
- B-LAV **Lavatera assurgentiflora**, TREE MALLOW Evergreen Shrub Native to Southern California Channel Island. Full sun. This variety needs little to moderate water. 1 gallon.
- B-PRI **Existing Ligustrum**, PRIVET
- B-D **Dodonaea viscosa 'Purpurea'** HOP BUSH Fast growing shrub 10-15 feet tall.
- B-R **Existing Rhampholepis indica**, INDIAN HAWTHORN. 4'to5' tall and 5'-6' wide. White flowers tinged with pink. Blooms mid winter to spring.
- B-H **Hydrangea macrophylla**, GARDEN HYDRANGEA Partial of full shade. Moderate growth to 4-8 feet high and wide. Regular water.
- B-E **Eugenia Myrtifolia Compacta**, COMPACT BRUSH CHERRY

GROUND COVER

- GC-D **Dymondia 'Silver Carpet'**. Ground cover, grass substitute. Drought tolerant.

TREES

- T-JM **Existing Acer palmatum**, JAPANESE MAPLE. Deciduous. Shrub or tree. Slow growing to 20' Good patio tree. Full sun to part shade. Moderate to regular water. Needs a location sheltered from the wind. Available at Bongard's Nursery. 15 gallon
- T-ML **Existing Citrus Lemon, Meyer Lemon**. Full sun little water. It is about the only lemon that grows on the coast. Available at Bongard's Nursery. 15 gallon
- T-L **Existing Leptospermum scoparium**, NEW ZEALAND TEA TREE. Full sun. Little water. 15 gallon
- T-X **Exylosma Congestum** Evedgreen or deciduous shrub or tree. 8 feet tall and as wide.
- T-G **Existing Guava Tree**
- T-TAN **Existing Tangerine tree**

- PS-BAC **Sutera cordata 'Snowstorm Pink'** SNOWSTORM PINK BACOPA Height: 8 inches. Spacing: 30 inches. Covered in stunning shell pink star-shaped flowers with harvest gold eyes and pink centers along the stems from mid spring to late fall.